

**Benchmarks:**

BM #1: Small RR spike in 2nd PP north of K-42 Highway, west side of Maize  
Elev. = 143.61 (City Datum)

BM #2: Small RR spike in PP east of East 1/4 Corner (G)  
Elev. = 147.00 (City Datum)

BM #3: "□" Top Headwall southeast corner K-42 Highway and Maize (County BM with City Datum)  
Elev. = 144.04 (City Datum)

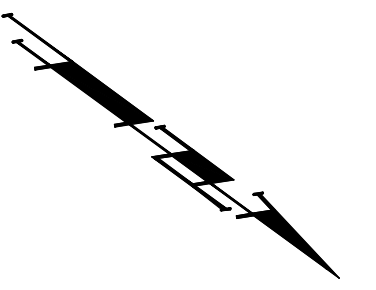

Scale: 1" = 20'  
• = Iron

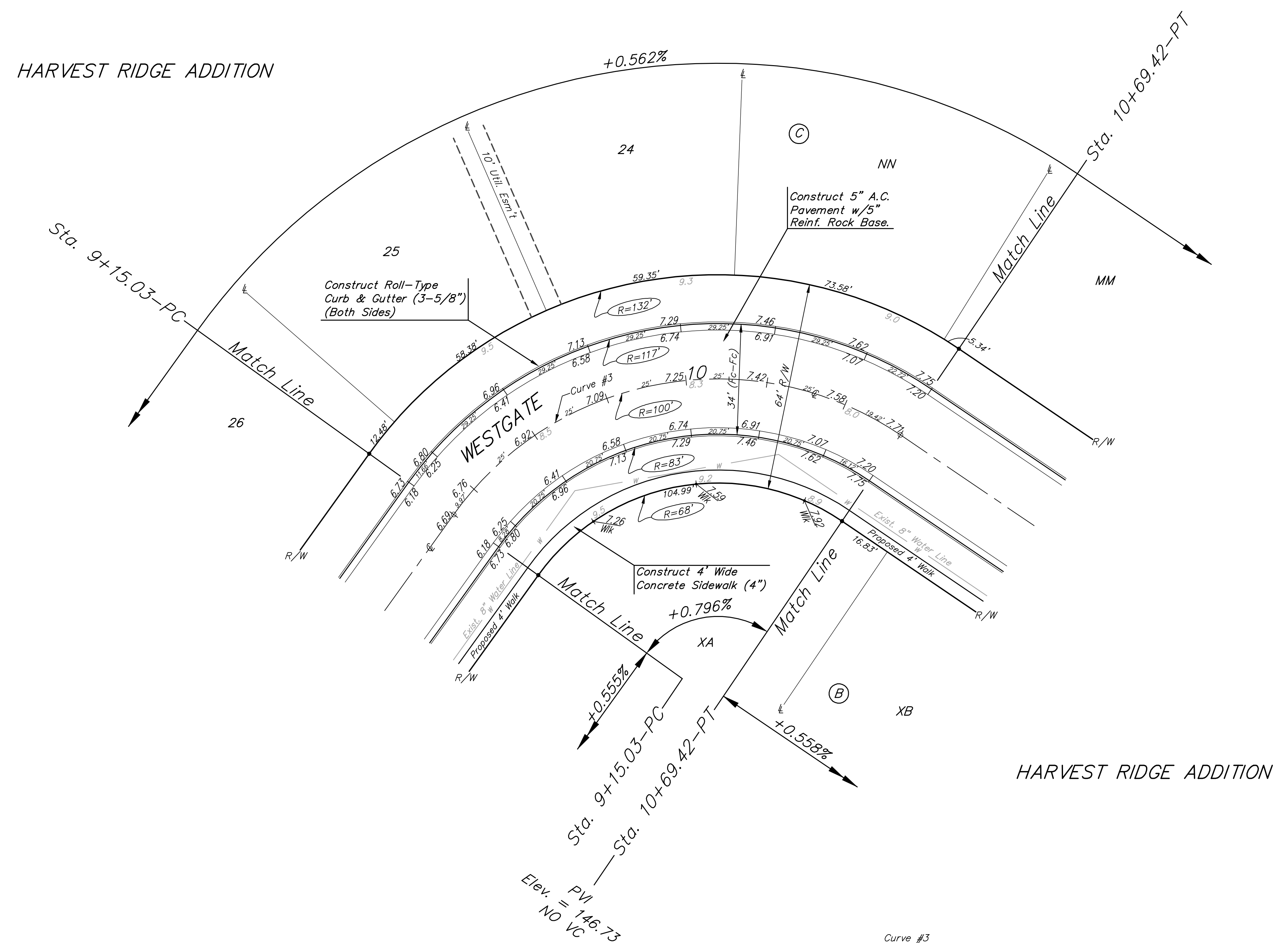

**Subdivision Bench Marks**

Street & Station	Location Description	Elevation
Westgate 0+70.00, 17.29' Rt.	Adjacent to Fire Hydrant at N. End of E. Curb Return of Westgate & K-42 Drive	
Westgate 7+19.16, 17.25' Rt.	Adjacent to Fire Hydrant near common lot corner of Lots 42 & YY, Block B	
34th Street South 0+40.58, 17.25' Rt.	Adjacent to Fire Hydrant 5' N. of End of E. Curb Return of Westgate & 34th Street South	

**Curve #3  
Curve Data Based on Centerline**

Rad. = 100' Delta = 88° 27' 37" Tangent = 97.35'  
Arc = 154.39' L.C. = 139.51' Def/Ft. = 17.18899 Min.

Station	FACE CHORD LENGTHS		Defl.	T. Defl.
	8' Lt.	8' Rt.		
9+15.03	-	-	0'00"00"	0'00"00"
9+25.00	9.97'	12.46'	7.47"	2'51"22"
9+50.00	25.00'	31.17'	18.70"	10'01"06"
9+75.00	25.00'	31.17'	18.70"	17'10"49"
10+00.00	25.00'	31.17'	18.70"	24'20"33"
10+25.00	25.00'	31.17'	18.70"	31'30"16"
10+50.00	25.00'	31.17'	18.70"	38'40"00"
10+69.42	19.42'	24.24'	14.54"	44'13"49"

Roll type curb & gutter to be constructed on the pavement on this sheet.  
Top of curb elevation are given for full height curb.

<b>Baughman WESTGATE</b>	
Harvest Ridge Addition - Phase II STA. 9+15.03 STA. 10+69.42	
Baughman Company, P.A. 315 Ellis St. Wichita, KS 67211 P 316262-7271 F 316262-0149 ENGINEERING   SURVEYING   PLANNING   LANDSCAPE ARCHITECTURE	
PROJECT NUMBER 472-83805	DESIGN MWS/JAK
APPROVED MWS	DRAWN JAK
REVISIONS:	DATE 4/12/06
SCALE Noted	
<b>8 OF 34</b>	
E:\Eng\Harvest Ridge\Phase 2\Str4	