

Benchmarks:

BM #1: Small RR spike in 2nd PP north of K-42 Highway, west side of Maize
Elev. = 143.61 (City Datum)

BM #2: Small RR spike in PP east of East 1/4 Corner (G)
Elev. = 147.00 (City Datum)

BM #3: "□" Top Headwall southeast corner K-42 Highway and Maize (County BM with City Datum)
Elev. = 144.04 (City Datum)



Scale: 1" = 20'

• = Iron

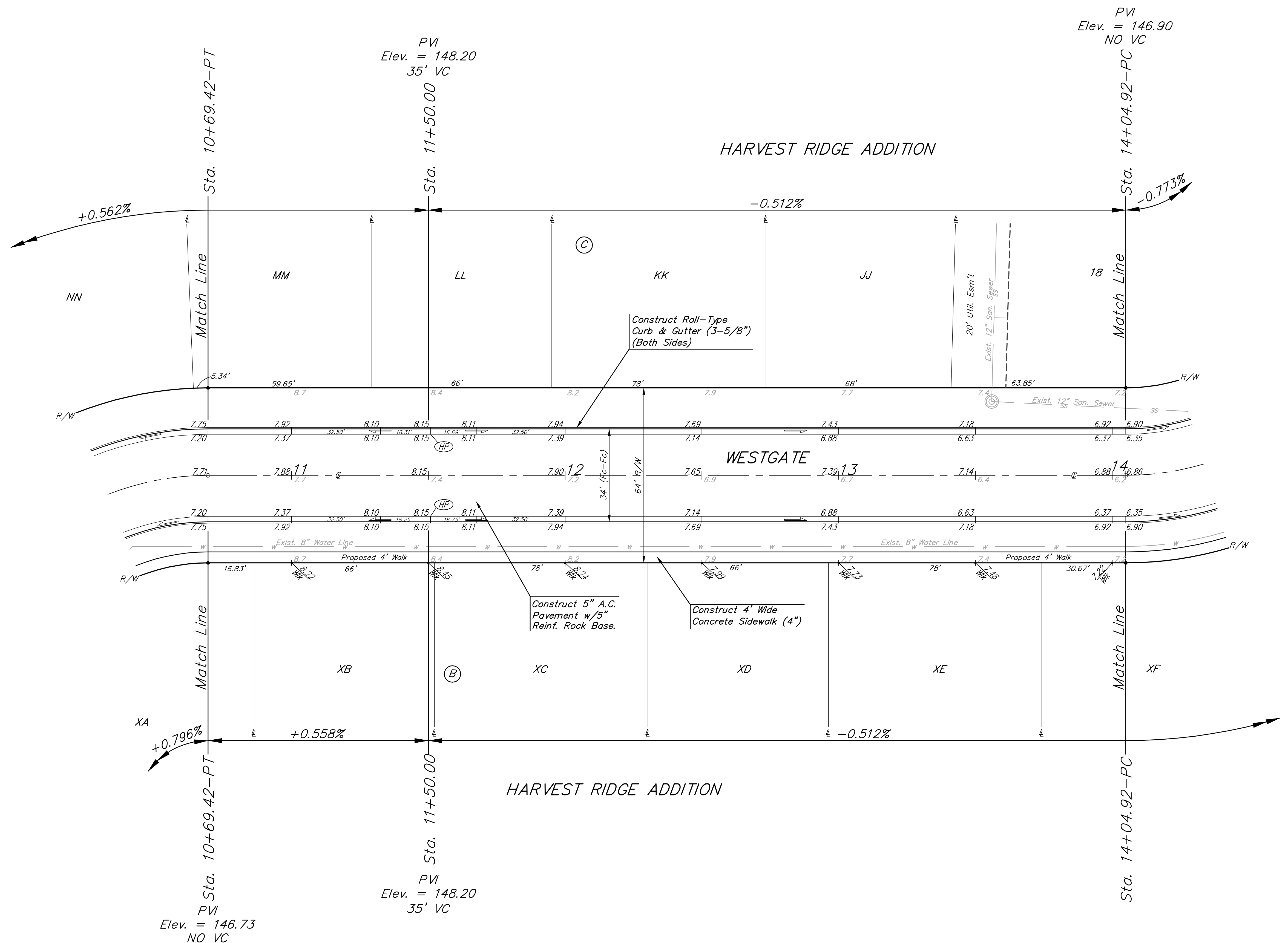

		WESTGATE Harvest Ridge Addition - Phase II STA. 10+69.42 STA. 14+04.92	
Baughman Company, P.A. 315 Ellis St. Wichita, KS 67211 P 316262-7271 F 316262-0149 ENGINEERING SURVEYING PLANNING LANDSCAPE ARCHITECTURE			
PROJECT NUMBER 472-83805	DESIGN MWS/JAK	DRAWN JAK	DATE 4/12/06
REVISIONS:	APPROVED MWS	SCALE Noted	SHEET 9 OF 24