

Benchmarks:

BM #1: Small RR spike in 2nd PP north of K-42 Highway, west side of Maize
Elev. = 143.61 (City Datum)

BM #2: Small RR spike in PP east of East 1/4 Corner (G)
Elev. = 147.00 (City Datum)

BM #3: "□" Top Headwall southeast corner K-42 Highway and Maize (County BM with City Datum)
Elev. = 144.04 (City Datum)

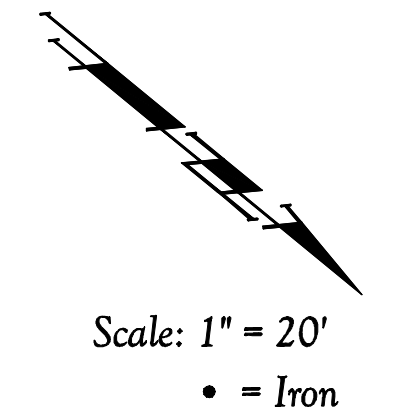

HARVEST RIDGE ADDITION

HARVEST RIDGE ADDITION

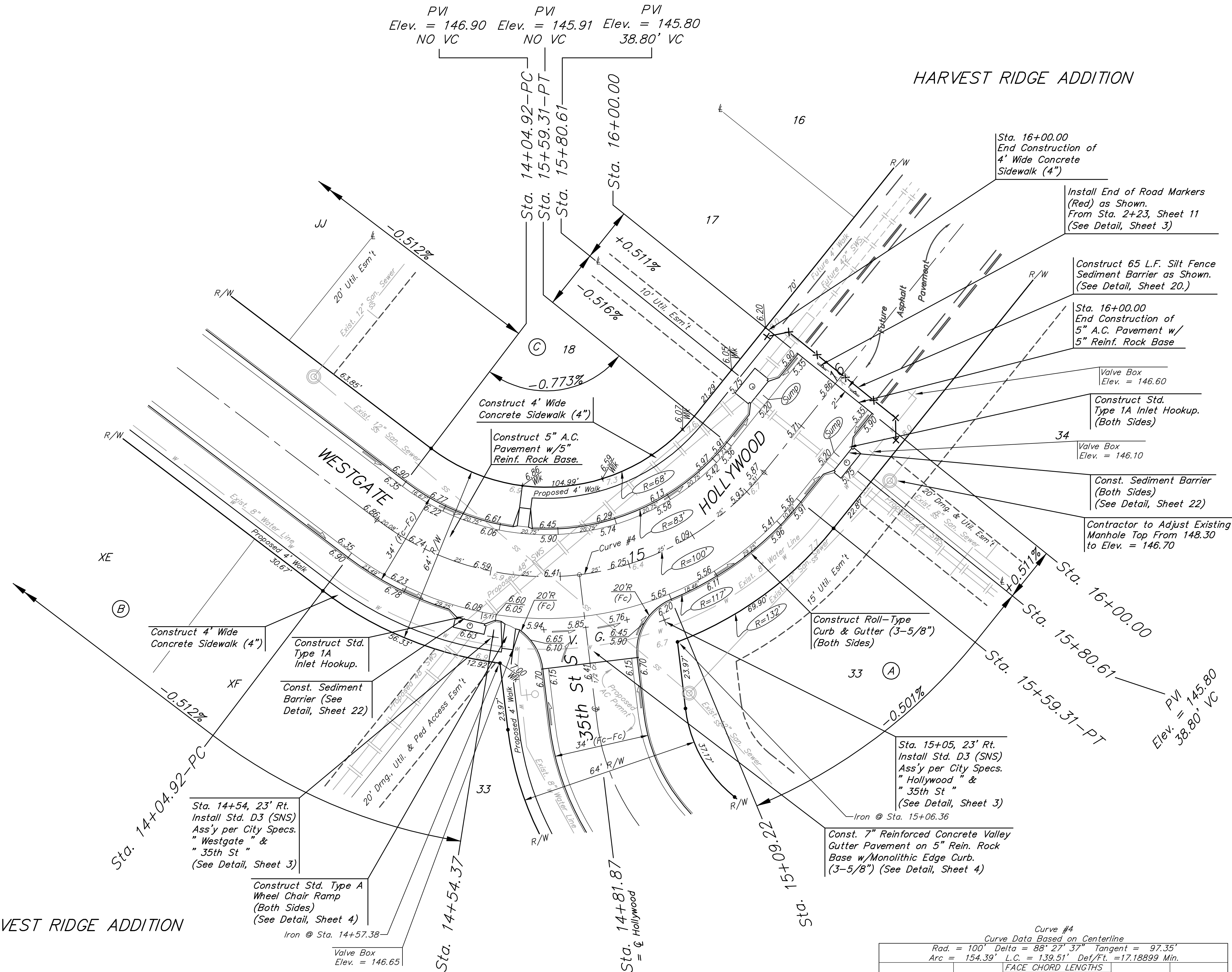

Curve #4
Curve Data Based on Centerline
Rad. = 100', Delta = 88° 27' 37", Tangent = 97.35'
Arc = 154.39', L.C. = 139.51', Def/Ft. = 17.18899 Min.

Station	Arc	FACE CHORD LENGTHS		Defl.	T. Defl.
		8' Lt.	8' Rt.		
14+04.92	-	-	-	0'00'00"	0'00'00"
14+25.00	20.08'	15.03'	25.06'	5'45'09"	5'45'09"
14+50.00	25.00'	18.70'	31.17'	7'09'44"	12'54'53"
14+54.37	4.37'	3.28'	5.46'	1'15'07"	14'10'00"
14+75.00	20.63'	15.45'	25.74'	5'54'36"	20'04'36"
15+00.00	25.00'	18.70'	31.17'	7'09'47"	27'14'20"
15+09.22	9.22'	6.91'	11.52'	2'38'29"	29'52'49"
15+25.00	15.78'	11.82'	19.70'	4'31'14"	34'24'03"
15+50.00	25.00'	18.70'	31.17'	7'09'44"	41'33'47"
15+59.31	9.31'	6.98'	11.63'	2'40'02"	44'13'49"

Roll type curb & gutter to be constructed on the pavement on this sheet. Top of curb elevation are given for full height curb.

PROJECT NUMBER
472-83805

REVISIONS:

Harvest Ridge Addition - Phase II
WESTGATE / HOLLYWOOD
STA. 10+69.42 STA. 14+04.92

Baughman Company, P.A. 315 Ellis St. Wichita, KS 67211 P 3162627271 F 3162620149
ENGINEERING | SURVEYING | PLANNING | LANDSCAPE ARCHITECTURE

DESIGN MWS/JAK	DRAWN JAK
APPROVED MWS	DATE 4/12/06

SCALE
Noted

SHEET
10 OF 34