

**Benchmarks:**

"□" Cut Top of Curb North End of Northwest Return at Highland Springs & Hardtner Elev. = 178.72 (City Datum)

"□" Cut Top of Curb West Side of Kentucky Lane ±20' South of End of Existing pavement. Elev. = 182.16 (City Datum)

**HIGHLAND SPRINGS 3RD ADDITION**

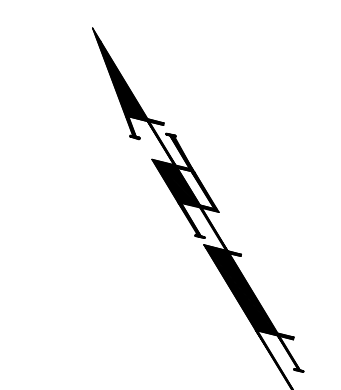

Scale: 1" = 20'

• = Iron

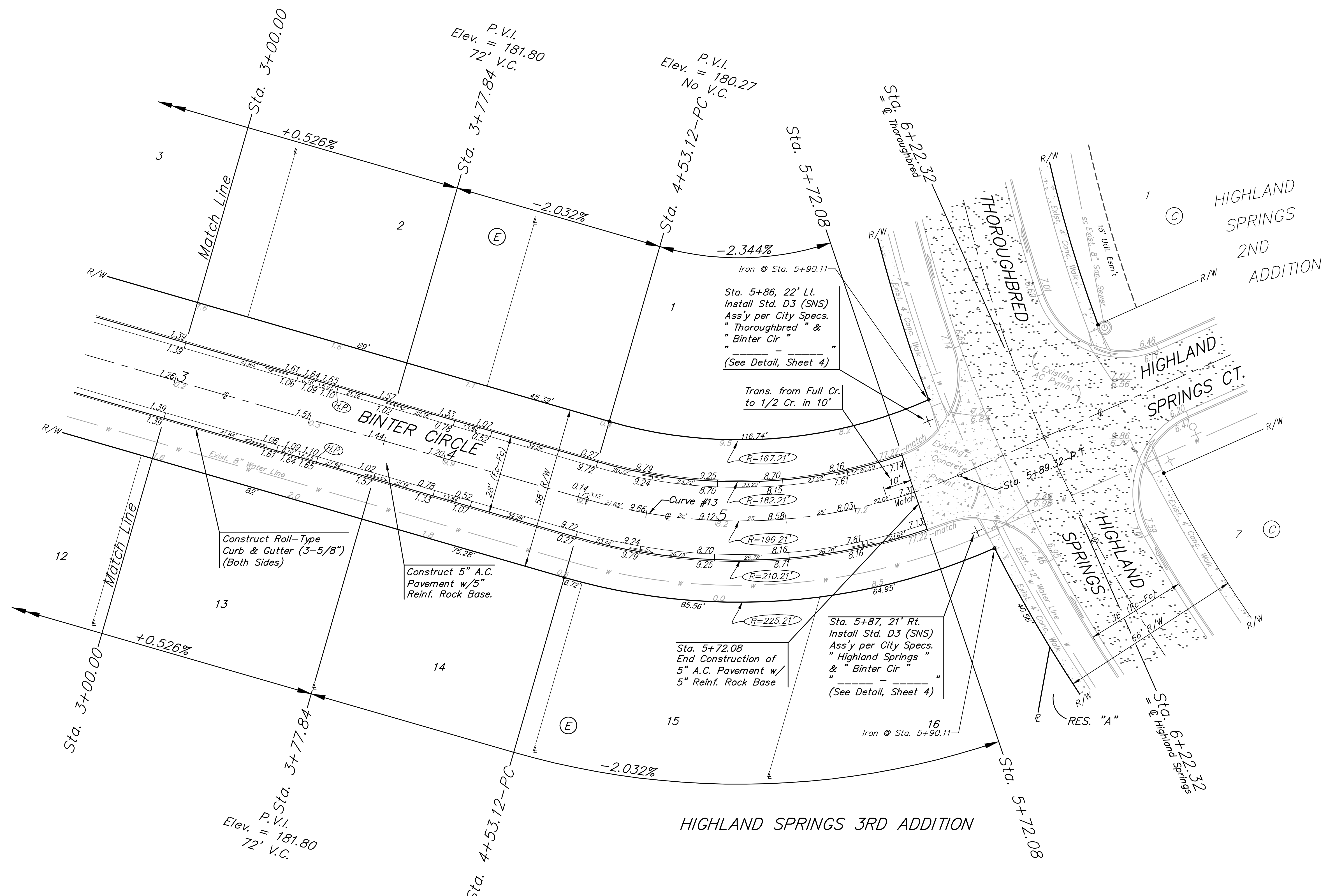

**HIGHLAND SPRINGS 3RD ADDITION**

Roll type curb & gutter to be constructed on the pavement on this sheet. Top of curb elevation are given for full height curb.

Curve #13  
Curve Data Based on Centerline  
Rad. = 196.21' Delta = 39° 46' 18" Tangent = 70.97'  
Arc = 136.20' L.C. = 133.48' Def Ft. = 8.76028 Min.

Station	Arc	FACE CHORD LENGTHS		Defl.	T. Defl.
		8' Lt.	8' Rt.		
4+53.12				0'00.00"	0'00.00"
4+75.00	21.88'	19.42'	24.32'	3'11.40"	3'11.40"
5+00.00	25.00'	22.18'	27.78'	3'39.01"	6'50.41"
5+25.00	25.00'	22.18'	27.78'	3'39.00"	10'29.41"
5+50.00	25.00'	22.18'	27.78'	3'39.01"	14'08.42"
5+72.08	22.08'	19.59'	24.54'	3'13.25"	17'22.07"
5+75.00	2.92'	2.59'	3.25'	0'25.35"	17'47.42"
5+89.32	14.32'	12.71'	15.92'	2'05.27"	19'53.09"

**Baughman** highland Springs 3rd Addition - Phase III  
**BINTER CIR.**  
STA. 3+00 - STA. 5+72.08

PROJECT NUMBER: 472-83780  
DESIGN: NBW/JAK  
DRAWN: TMS/JAK  
APPROVED: [Signature]  
DATE: 6/21/06

SCALE: Noted  
SHEET: 12 OF 32