

COUNTRY HOLLOW ADDITION

CURVE TABLE (C4)					
$\Delta = 20^{\circ}24'29''$ R = 300.00' T = 54.00' L = 106.86' LC = 106.29'					
CURVE DATA BASED ON CENTERLINE $\Delta / 2 = 10^{\circ}12'15''$					
STATION	ARC	CHORD LENGTH		DEFLECTION	TOTAL DEFLECTION
		8' Off LtCb	8' Off RtCb		
28+37.55	-	-	-	00°00'00"	00°00'00"
28+50.00	12.45'	13.36'	11.54'	01°11'20"	01°11'20"
28+75.00	25.00'	26.83'	23.16'	02°23'14"	03°34'34"
29+00.00	25.00'	26.83'	23.16'	02°23'14"	05°57'49"
29+25.00	25.00'	26.83'	23.16'	02°23'14"	08°21'03"
29+44.41	19.41'	20.83'	17.98'	01°51'11"	10°12'14"
Def/Ft = 5.72958 Min.					

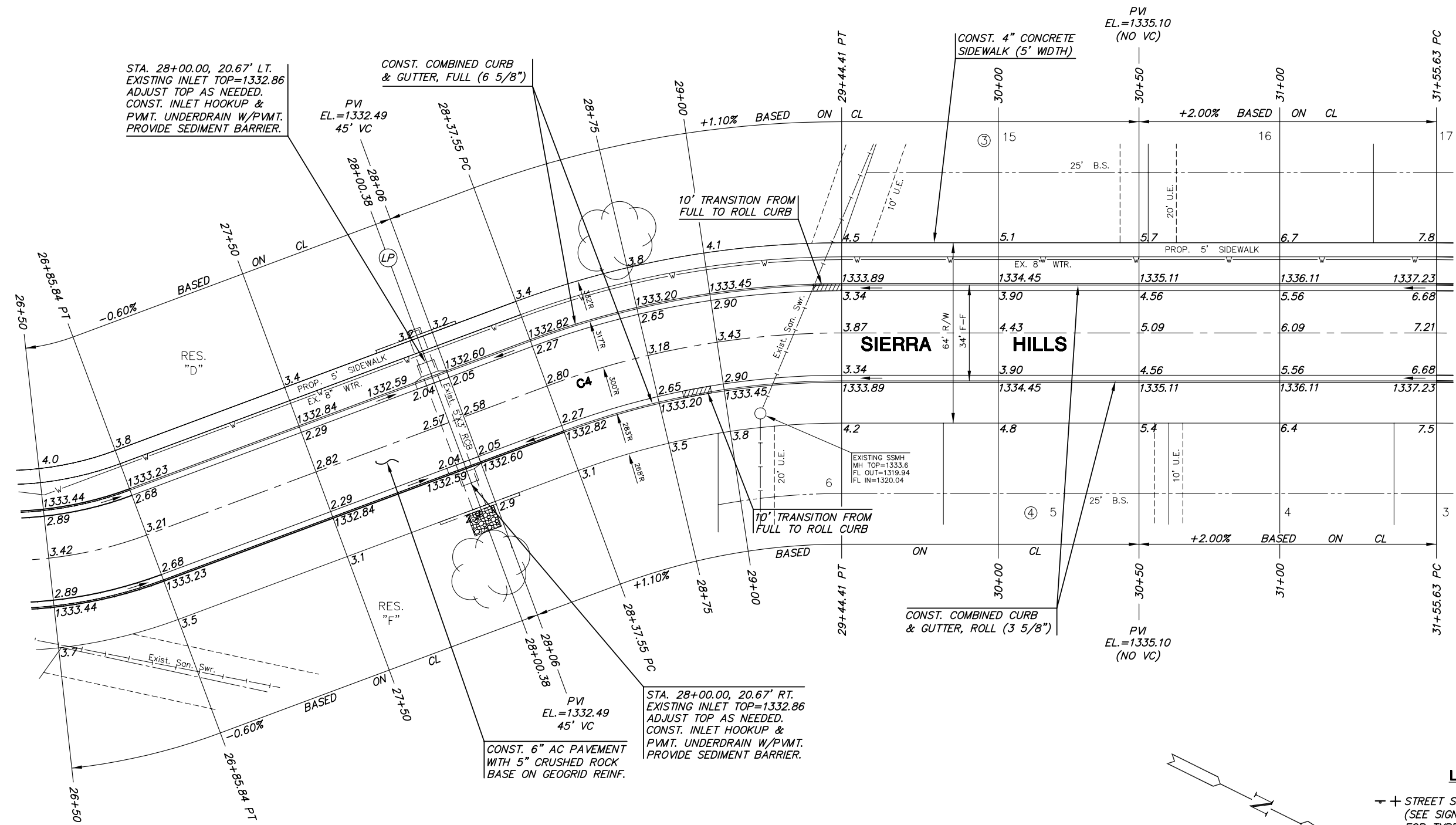

PAVING PLANS  
**COUNTRY HOLLOW**  
PHASE 1

**SIERRA HILLS**  
SHEET TITLE  
472-84328  
PROJECT NUMBER

DFL  
DESIGN BY  
MUK/DMU  
DRAWN BY  
GJA  
CHECKED BY

ISSUED  
MARCH 2006  
REVISED

SHEET NO.  
11 of 29

**LEGEND**

+ STREET SIGN & SIGN LOCATION  
(SEE SIGN ASSEMBLY TABLE  
FOR TYPE & STATION OF SIGN)

NOTE:  
TOP OF CURB ELEVATIONS SHOWN  
ARE FOR FULL CURB. CONSTRUCT  
CURB AND GUTTER AS NOTED.

