

STA. 22+32.92, 14.5' LT., CHURCHILL ST.
INSTALL SUBDIVISION BENCHMARK
(NO. 8134-08, KANSAS BLUE PRINT CO.)

P.V.I.
ELEV. = 1363.76
V.C. = 150'

PROP. CURB INLET TOP=1364.97
CONST. INLET HOOKUP W/ PVMT.
UNDERDRAIN. INSTALL SEDIMENT
BARRIER.

P.V.I.
ELEV. = 1369.09
V.C. = 40'

REED'S COVE
FOURTH ADDITION

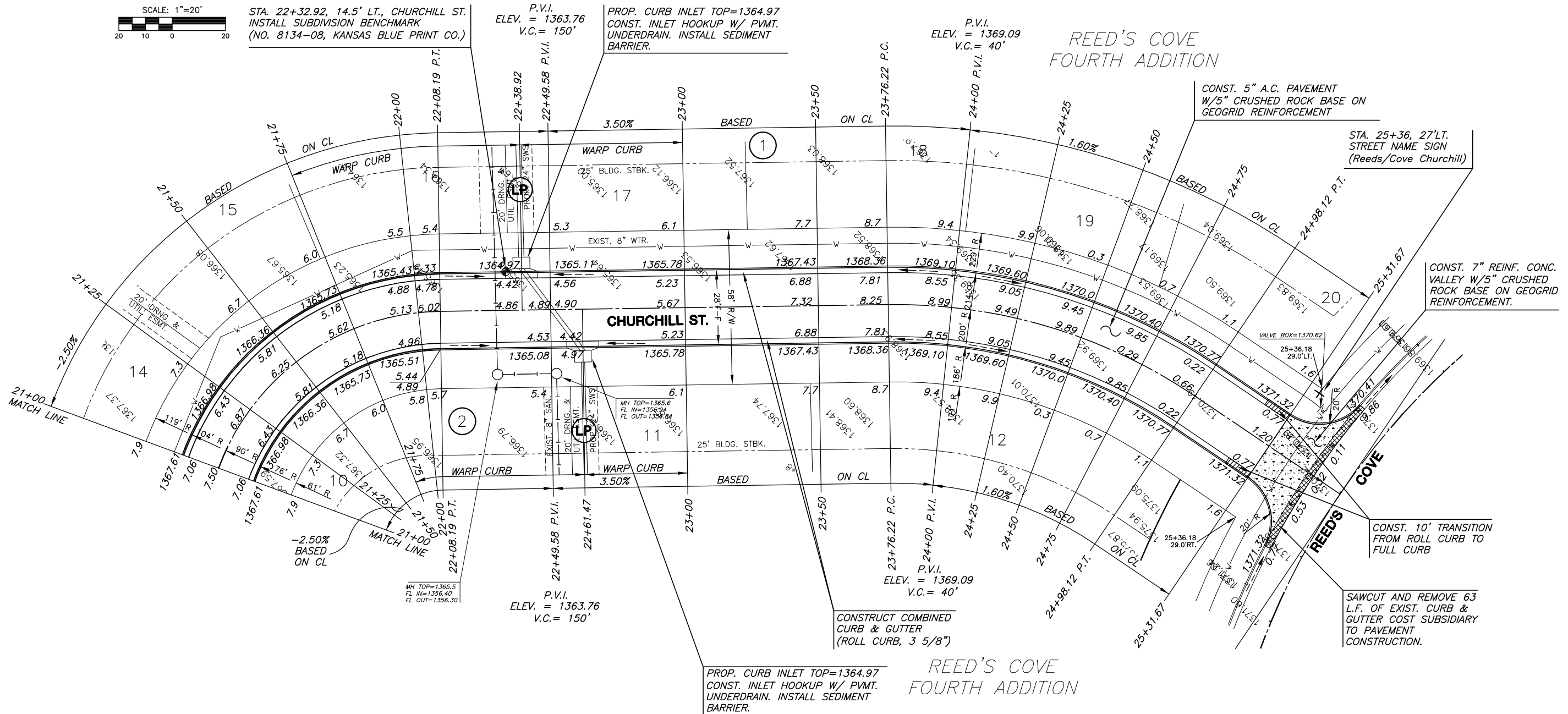

CONST. 5" A.C. PAVEMENT
W/5" CRUSHED ROCK BASE ON
GEOGRID REINFORCEMENT

STA. 25+36, 27'LT.
STREET NAME SIGN
(Reeds/Cove Churchill)

CONST. 7" REINF. CONC.
VALLEY W/5" CRUSHED
ROCK BASE ON GEOGRID
REINFORCEMENT.

CONST. 10' TRANSITION
FROM ROLL CURB TO
FULL CURB

SAWCUT AND REMOVE 63
L.F. OF EXIST. CURB &
GUTTER COST SUBSIDIARY
TO PAVEMENT
CONSTRUCTION.

CONSTRUCT COMBINED
CURB & GUTTER
(ROLL CURB, 3 5/8")

REED'S COVE
FOURTH ADDITION

PROP. CURB INLET TOP=1364.97
CONST. INLET HOOKUP W/ PVMT.
UNDERDRAIN. INSTALL SEDIMENT
BARRIER.

NO.	STREET AND STATION	FROM CL	DESCRIPTION	ELEVATIONS
1	CHURCHILL ST., STA. 13+21.79	12.0' RT	TOP OF CURB AT END OF INLET, CHURCHILL ST.	

NOTE: CONTRACTOR SHALL INSTALL SUBDIVISION BENCH MARKS ("FLAT SURVEY MARKERS NO. 8134-08 3" TOP DIAMETER" PROVIDED BY KANSAS BLUE PRINT CO., INC.) COSTS TO BE CONSIDERED SUBSIDIARY TO CONSTRUCTION OF COMBINED CURB AND GUTTER.

CURVE TABLE					
$\Delta = 34^{\circ}55'26''$ R = 200.00' T = 62.91' L = 121.91' LC = 120.03'					
CURVE DATA BASED ON CENTERLINE $\Delta/2 = 17^{\circ}27'43''$					
CHORD LENGTH					
STATION	ARC	8'Off LtCb	8'Off RtCb	DEFLECTION	TOTAL DEFLECTION
23+76.22	-	-	-	00'00'00"	00'00'00"
24+00.00	23.78'	26.38'	21.15'	03'24'22"	03'24'22"
24+25.00	25.00'	27.73'	22.24'	03'34'52"	06'59'14"
24+50.00	25.00'	27.73'	22.24'	03'34'52"	10'34'06"
24+75.00	25.00'	27.73'	22.24'	03'34'52"	14'08'57"
24+98.13	23.13'	25.66'	20.57'	03'18'46"	17'27'43"

Def/Ft = 8.59437 Min.

LEGEND
+ STREET SIGN & SIGN LOCATION
(SEE SIGN ASSEMBLY TABLE
FOR TYPE & STATION OF SIGN)

[Symbol] = VALLEY GUTTER

PAVING STREETS AND INCIDENTAL DRAINAGE
**REEDS COVE
FOURTH ADDITION**

**CHURCHILL ST.
PAVING PLAN**

PROJECT NUMBER
472-84385

DESIGN BY: SRS
DRAWN BY: BFL
CHECKED BY: GJA

ISSUED
MARCH 2006

SHEET NO.
8 of 33