

BENCHMARK:
 BM #1: "□" Cut in middle of
 N headwall of RCBC on 21st
 St. North. 1004.3' W & 22.1'
 N of SE Cor., SE1/4, Sec. 2,
 T-27-S, R-2-E.
 Elev. = 173.23 City Datum

BM #2: "□" Cut at the SE
 corner of the intersection of
 Castle Rock & Castle Rock Ct.,
 Krug North Addition.
 Elev. = 183.50 City Datum

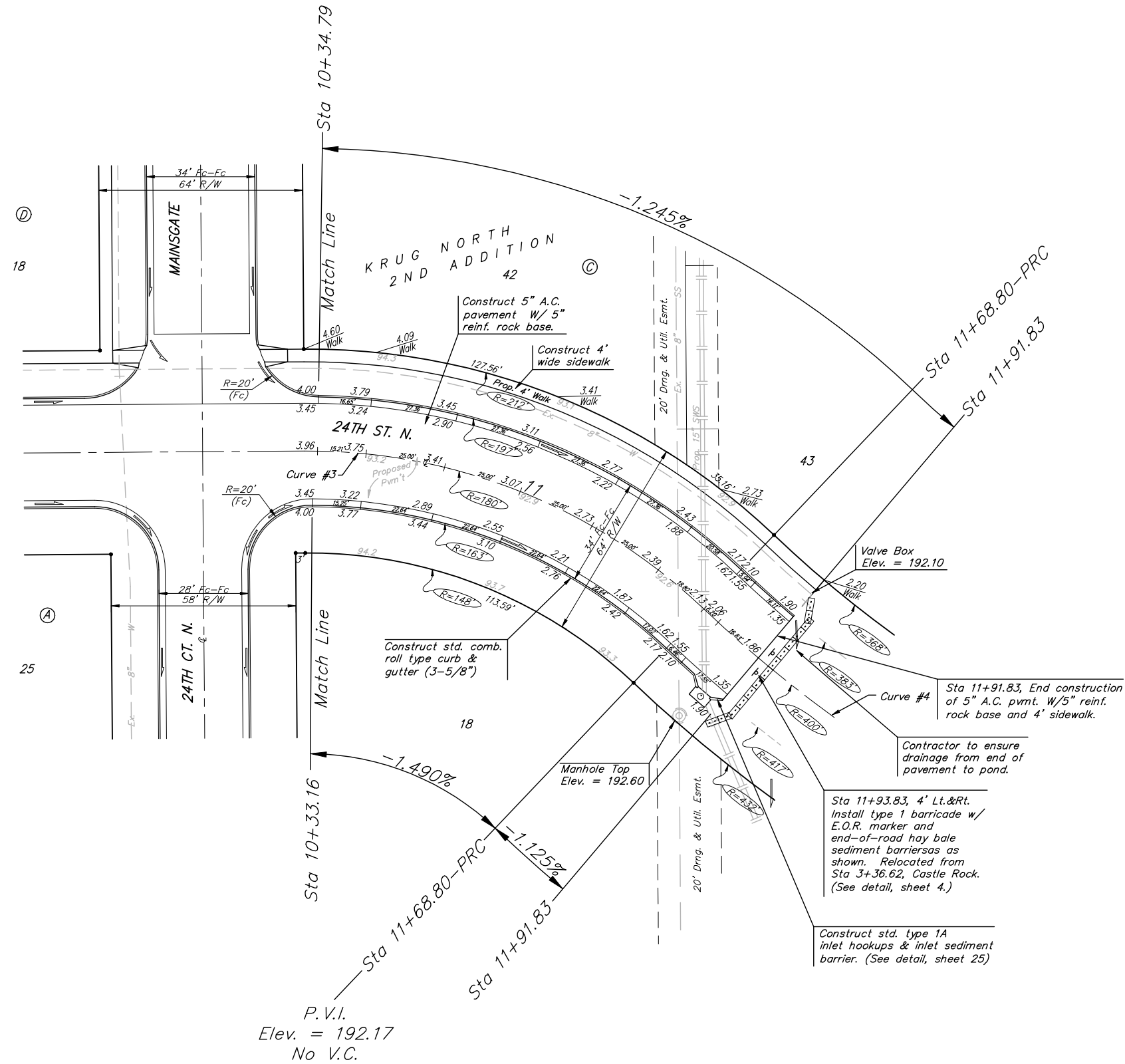
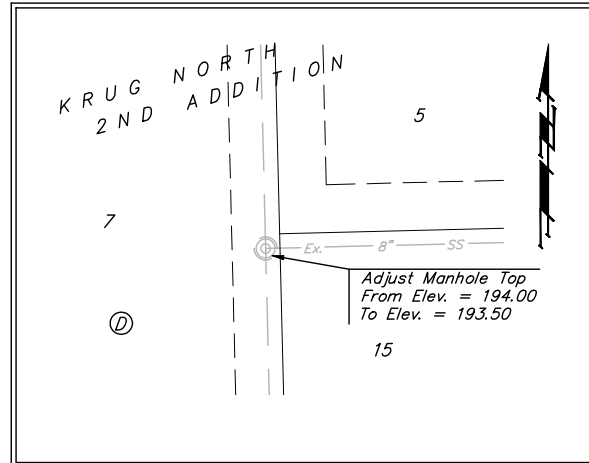
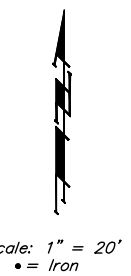

Curve #3
 Curve Data Based on Centerline
 Rad. = 180' Delta = 43° 58' 33" Tangent = 72.68'
 Arc = 138.15' L.C. = 134.79' Def/Ft. = 9.54958 Min.

Station	Arc	FACE CHORD LENGTHS		Defl.	T. Defl.
		8' Lt.	8' Rt.		
10+30.65	-	-	-	0'00'00"	0'00'00"
10+33.16	2.51'	2.86'	2.16'	0'23'58"	0'23'58"
10+34.79	1.63'	1.86'	1.40'	0'15'34"	0'39'32"
10+50.00	15.21'	17.32'	13.09'	2'25'15"	3'04'47"
10+75.00	25.00'	28.45'	21.51'	3'58'44"	7'03'31"
11+00.00	25.00'	28.45'	21.51'	3'58'44"	11'02'16"
11+25.00	25.00'	28.45'	21.51'	3'58'44"	15'01'00"
11+50.00	25.00'	28.45'	21.51'	3'58'44"	18'59'44"
11+68.80	18.80'	21.40'	16.18'	2'59'32"	21'59'16"

Curve #4
 Curve Data Based on Centerline
 Rad. = 400' Delta = 3° 17' 55" Tangent = 11.52'
 Arc = 23.03' L.C. = 23.03' Def/Ft. = 4.29693 Min.

Station	Arc	FACE CHORD LENGTHS		Defl.	T. Defl.
		8' Lt.	8' Rt.		
11+68.80	-	-	-	0'00'00"	0'00'00"
11+75.00	6.20'	5.81'	6.59'	0'26'38"	0'26'38"
11+91.83	16.83'	15.78'	17.88'	1'12'19"	1'38'57"

NOTE:
 ROLL TYPE CURB & GUTTER TO
 BE CONSTRUCTED ON THE
 PAVEMENT SHOWN ON THIS SHEET.
 TOP OF CURB ELEVATIONS ARE
 GIVEN FOR FULL HEIGHT CURB.

	KRUG NORTH 2ND ADD. - PH. III	
	24TH ST. N. STA 10+34.79 TO STA 11+91.83	
Baughman Company, P.A. 315 Elm St. W. 3rd Fl. Philadelphia, PA 19106 ENGINEERING SURVEYING PLANNING LANDSCAPE ARCHITECTURE		
PROJECT NUMBER 472-842-49	DESIGN ATD	DRAWN TMS
REVISIONS:	APPROVED	DATE 01/06
	SCALE Noted	SHEET
	8 OF 39	
KrugNorth2nd/PhaseIII/Sec3		05-09-E368