

BENCHMARK:
 BM #1: "□" Cut in middle of N headwall of RCBC on 21st St. North. 1004.3' W & 22.1' N of SE Cor., SE1/4, Sec. 2, T-27-S, R-2-E.
 Elev. = 173.23 City Datum

BM #2: "□" Cut at the SE corner of the intersection of Castle Rock & Castle Rock Ct., Krug North Addition.
 Elev. = 183.50 City Datum

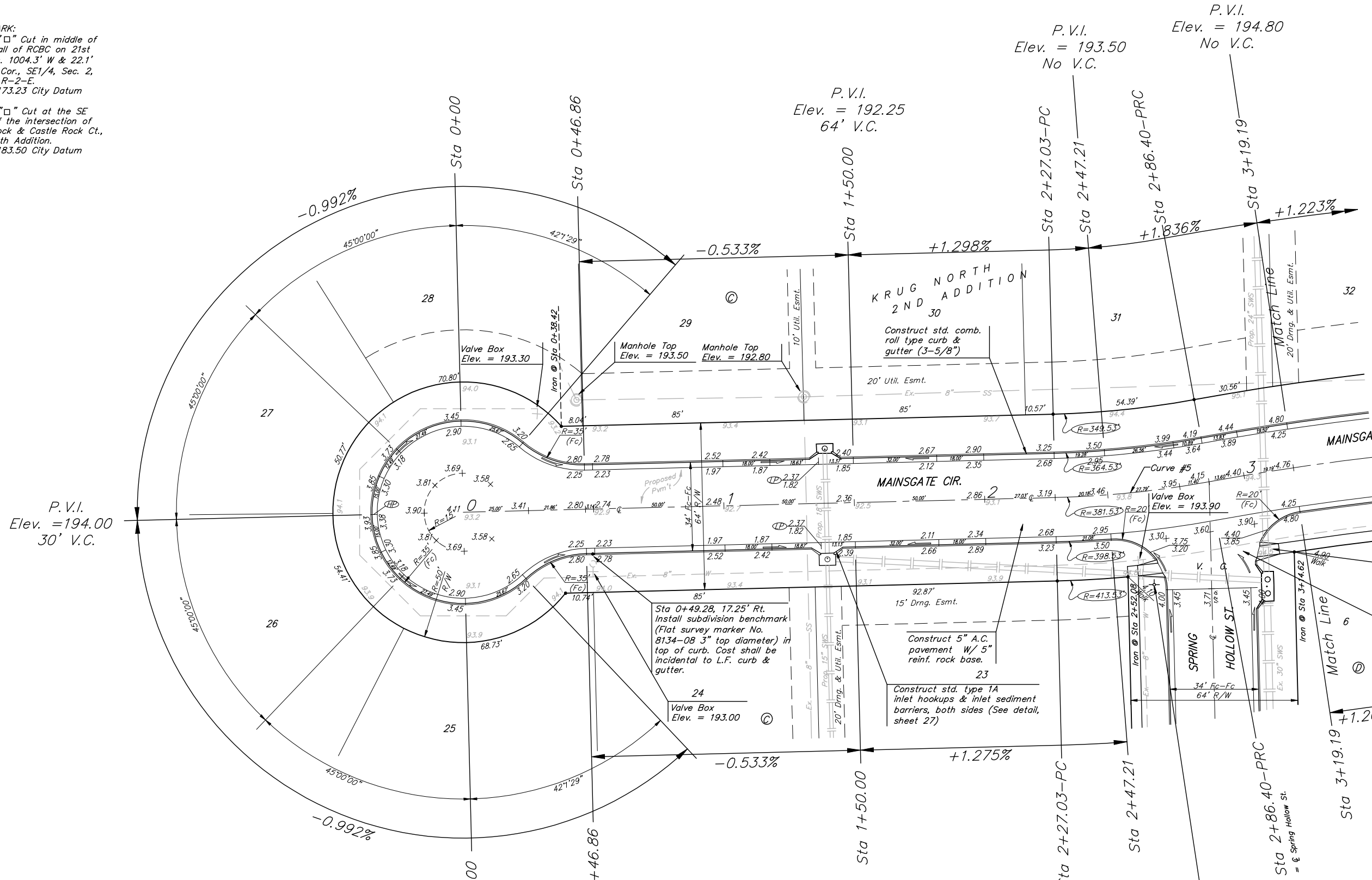
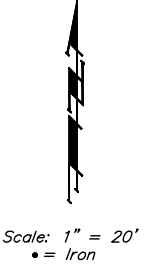

P.V.I.
 Elev. = 194.00
 30' V.C.

P.V.I.
 Elev. = 192.25
 64' V.C.

P.V.I.
 Elev. = 193.50
 No V.C.

P.V.I.
 Elev. = 194.80
 No V.C.

P.V.I.
 Elev. = 192.25
 64' V.C.

Curve #5
 Curve Data Based on Centerline
 Rad. = 381.53' Delta = 8° 54' 55" Tangent = 29.74'
 Arc = 59.37' L.C. = 59.31' Def/Ft. = 4.50494 Min.

Station	Arc	FACE CHORD LENGTHS		Defl.	T. Defl.
		8' Lt.	8' Rt.		
2+27.03	-	-	-	0°00'00"	0°00'00"
2+47.21	20.18'	18.85'	21.50'	1°30'54"	1°30'54"
2+50.00	2.79'	2.61'	2.97'	0°12'34"	1°43'29"
2+75.00	25.00'	23.36'	26.63'	1°52'37"	3°36'06"
2+86.40	11.40'	10.65'	12.15'	0°51'21"	4°27'27"

NOTE:
 ROLL TYPE CURB & GUTTER TO BE CONSTRUCTED ON THE PAVEMENT SHOWN ON THIS SHEET. TOP OF CURB ELEVATIONS ARE GIVEN FOR FULL HEIGHT CURB.

		KRUG NORTH 2ND ADD. - PH. III MAINSGATE CIR. STA 0+00 TO STA 3+19.19	
		<small>Baughman Company, P.A. 315 Elm St. Wichita, KS 67211 P 3162627771 F 3162620149 ENGINEERING SURVEYING PLANNING LANDSCAPE ARCHITECTURE</small>	
PROJECT NUMBER 472-84249	DESIGN ATD	DRAWN TMS	DATE 01/06
REVISIONS:	APPROVED Noted	SCALE Noted	SHEET 9 OF 39
<small>KrugNorth2nd/PhaseIII/Std</small>		<small>05-09-E368</small>	