

BENCHMARK:
 BM #1: "□" Cut in middle of N headwall of RCBC on 21st St. North. 1004.3' W & 22.1' N of SE Cor., SE1/4, Sec. 2, T-27-S, R-2-E.
 Elev. = 173.23 City Datum

BM #2: "□" Cut at the SE corner of the intersection of Castle Rock & Castle Rock Ct., Krug North Addition.
 Elev. = 183.50 City Datum

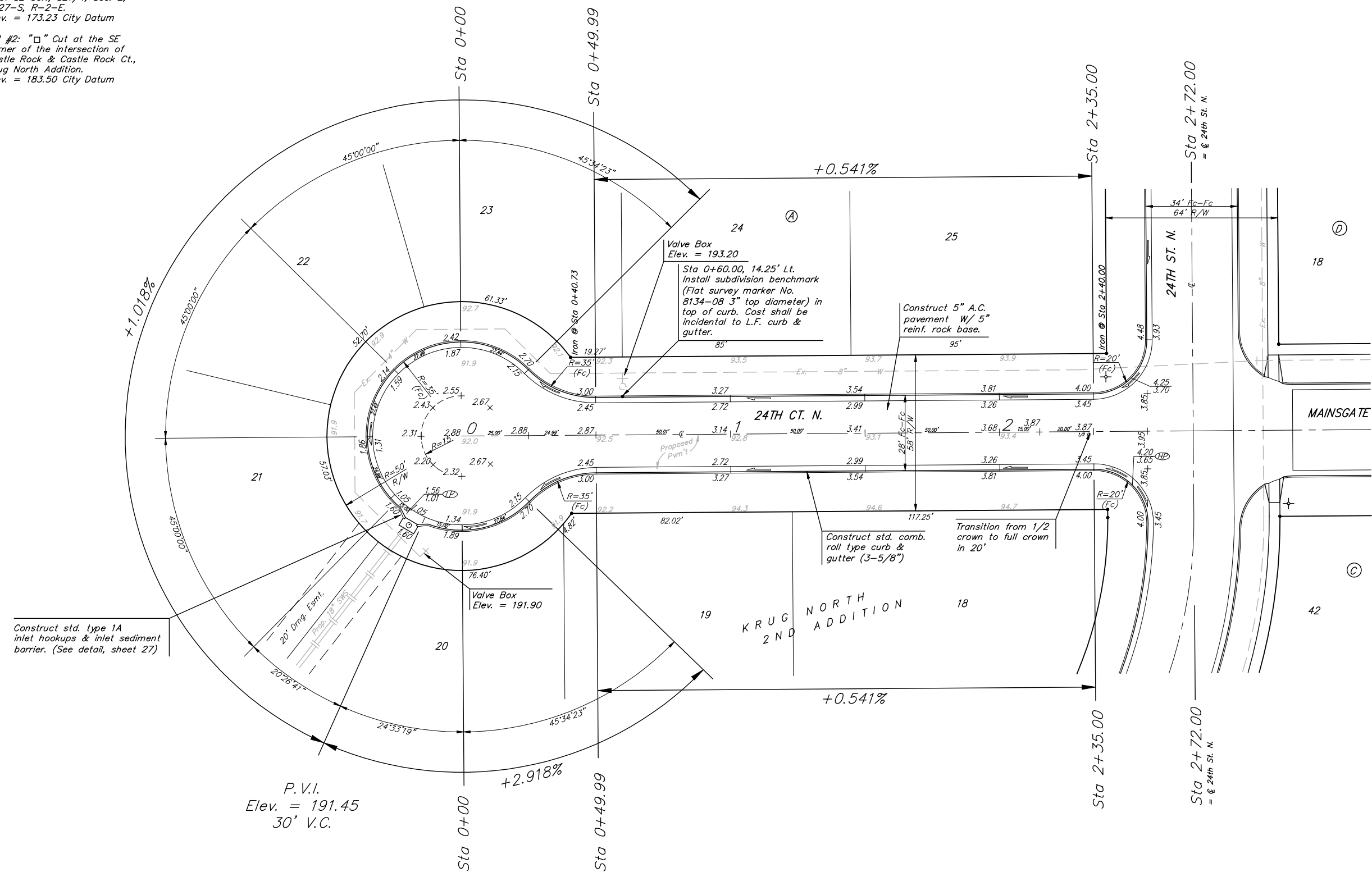

Scale: 1" = 20'
 • = Iron



NOTE: ROLL TYPE CURB & GUTTER TO BE CONSTRUCTED ON THE PAVEMENT SHOWN ON THIS SHEET. TOP OF CURB ELEVATIONS ARE GIVEN FOR FULL HEIGHT CURB.

		KRUG NORTH 2ND ADD. - PH. III 24TH CT. N. STA 0+00 TO STA 2+72.00	
		<small>Baughman Company, P.A. 315 8th St. W. Minn. 55 0711 P 3162627771 F 3162620149 ENGINEERING SURVEYING PLANNING LANDSCAPE ARCHITECTURE</small>	
PROJECT NUMBER 472-84249	DESIGN ATD	DRAWN TMS	DATE 01/06
REVISIONS:	APPROVED	SCALE Noted	SHEET 12 OF 39
<small>KrugNorth2nd/PhaseIII/Sec7</small>		<small>05-09-E368</small>	