

**BENCHMARKS:**  
 BM #1: "□" CL face of catch basin, west side of Lot 4, Block 5, Falcon Falls Addition. Elev. = 1352.47 MSL

BM #2: "□" south end of the south curb return at Kite and Peregrine, Falcon Falls Addition. Elev. = 1359.85 MSL

P.V.I.  
 Elev. = 1369.50  
 No V.C.

P.V.I.  
 Elev. = 1368.60  
 No V.C.

P.V.I.  
 Elev. = 1364.75  
 No V.C.

Scale: 1" = 20'  
 • = Iron

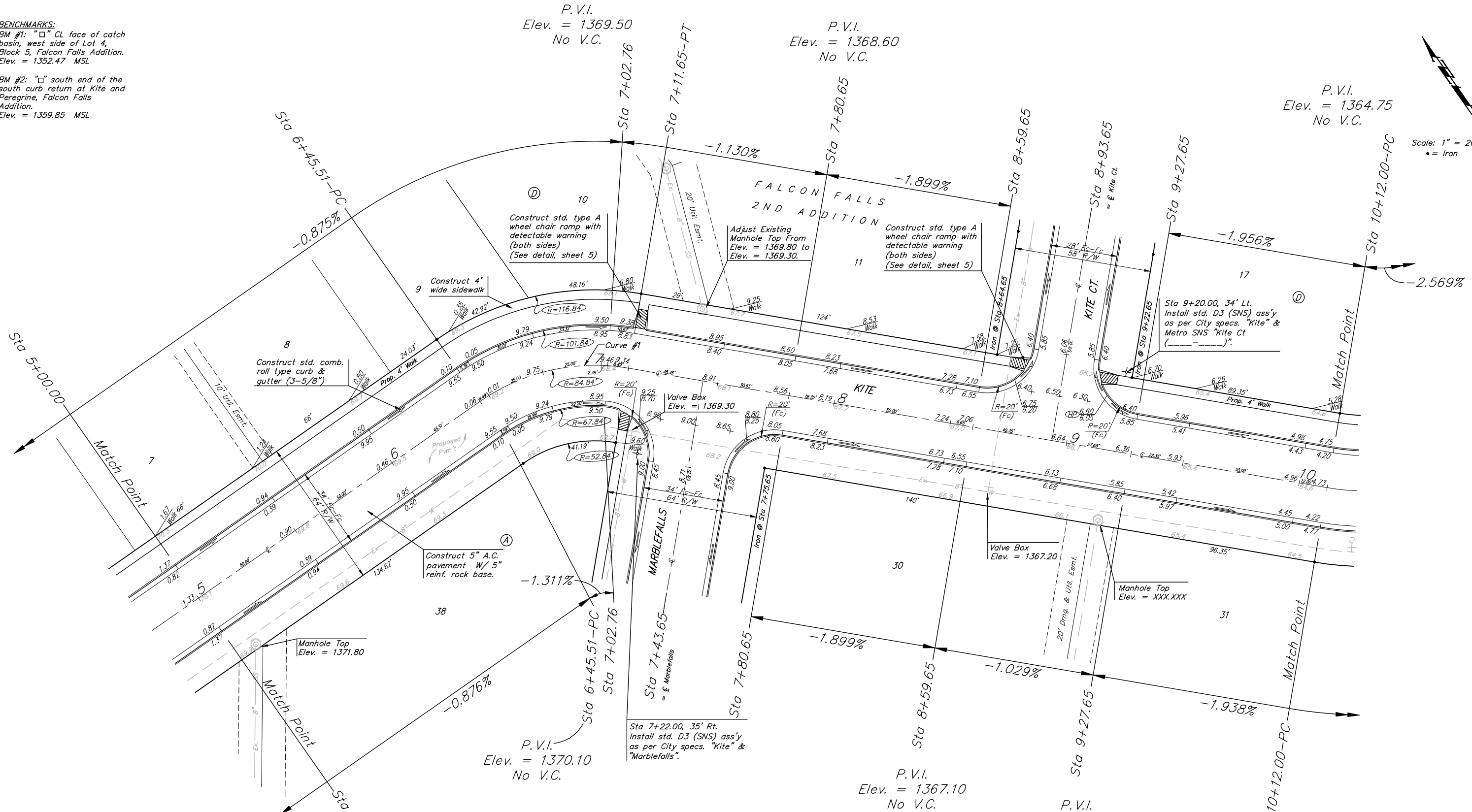

Curve #1  
 Curve Data Based on Centerline  
 Rad. = 84.84' Delta = 44° 39' 45" Tangent = 34.85'  
 Arc = 66.14' L.C. = 64.47' Def/Ft. = 20.25816 Min.

Station	FACE CHORD LENGTHS		Defl.	T. Defl.
	8' Lt.	8' Rt.		
6+45.51	-	-	0'00'00"	0'00'00"
6+50.00	4.49'	5.81'	1'30'57"	1'30'57"
6+75.00	25.00'	32.25'	8'26'27"	9'57'25"
7+00.00	25.00'	32.25'	8'26'27"	18'23'52"
7+02.76	2.76'	3.57'	0'55'55"	19'19'47"
7+11.65	8.89'	11.50'	6.27'	22'19'52"

NOTE: ROLL TYPE CURB & GUTTER TO BE CONSTRUCTED ON THE PAVEMENT SHOWN ON THIS SHEET. TOP OF CURB ELEVATIONS ARE GIVEN FOR FULL HEIGHT CURB.

	FALCON FALLS 2ND ADD. - PH. I		
	KITE		
STA 5+00.00 TO STA 10+12.00			
Baughman Company, P.A. 315 Elm St. Waltham, MA 02151 P 3162627771 F 3162620149			
ENGINEERING   SURVEYING   PLANNING   LANDSCAPE ARCHITECTURE			
PROJECT NUMBER 472-84264	DESIGN TJW	DRAWN TMS	
REVISIONS:	APPROVED AEG	DATE 01/06	
	SCALE Noted	SHEET	
			<b>7 OF 44</b>
FalconFalls2nd/PhI/Sheet2			05-10-E376