

BENCHMARKS:
 BM #1: "□" CL face of catch basin, west side of Lot 4, Block 5, Falcon Falls Addition. Elev. = 1352.47 MSL

BM #2: "□" south end of the south curb return at Kite and Peregrine, Falcon Falls Addition. Elev. = 1359.85 MSL

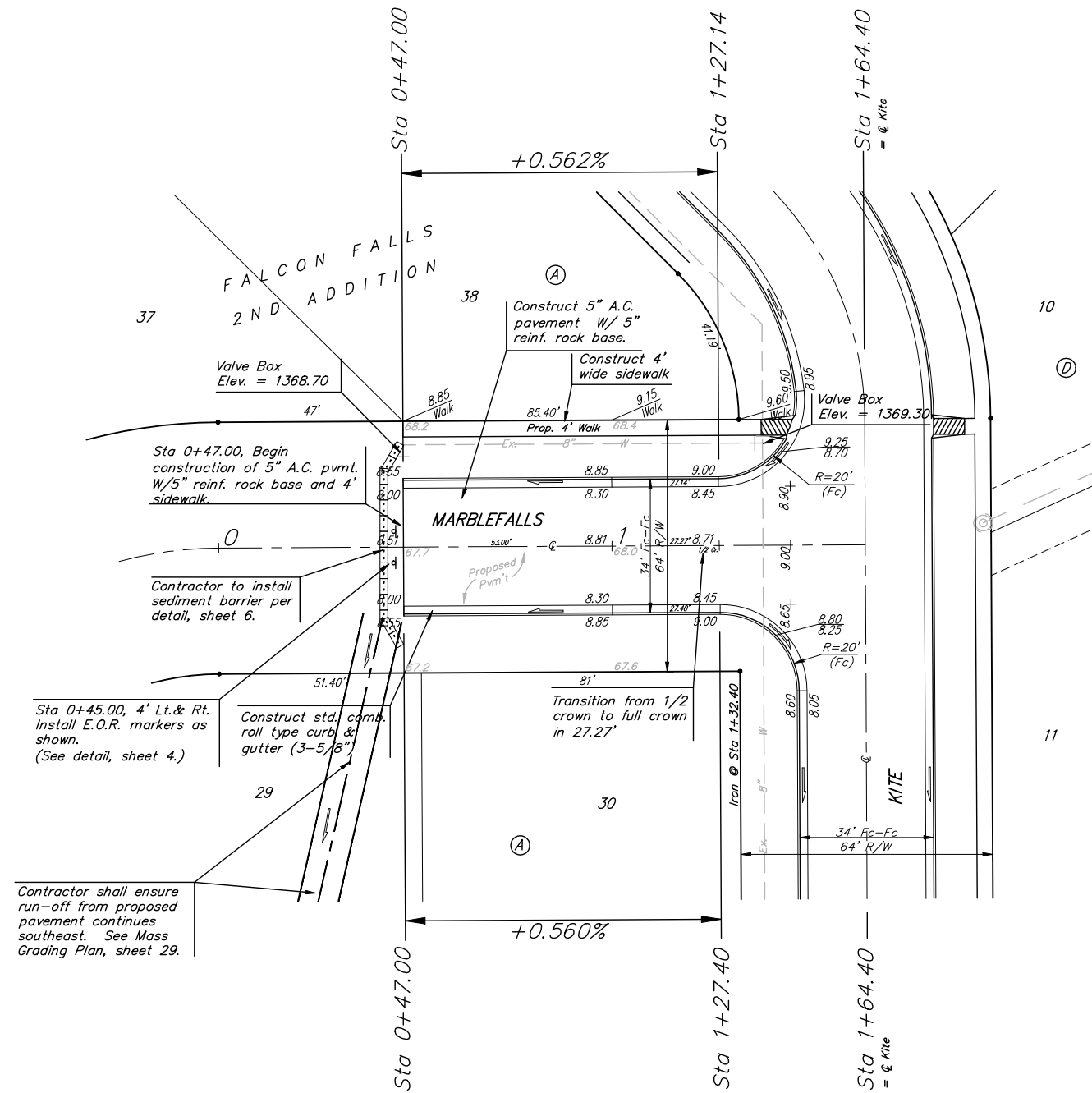
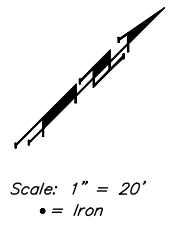

NOTE: ROLL TYPE CURB & GUTTER TO BE CONSTRUCTED ON THE PAVEMENT SHOWN ON THIS SHEET. TOP OF CURB ELEVATIONS ARE GIVEN FOR FULL HEIGHT CURB.

Baughman		FALCON FALLS 2ND ADD. - PH. I	
		MARBLEFALLS	
		STA 0+47.00 TO STA 1+64.40	
Baughman Company, P.A. 315 Ellis St. Wichita, KS 67211 P 316-262-7271 F 316-262-0149			
ENGINEERING SURVEYING PLANNING LANDSCAPE ARCHITECTURE			
PROJECT NUMBER 472-64264	DESIGN TJW	DRAWN TMS	
REVISIONS:	APPROVED AEG	DATE 01/06	
	SCALE Noted	SHEET	
			10 OF 44
FalconFalls2nd/Pln/Std		05-10-E376	