

BENCHMARKS:
 BM #1: "□" Cut on T.C., 12' west of east end of N curb return on the north drive entrance of the Church of the Magdalen.
 Elev. = 190.48 (City Datum)
 BM #2: RR spike on the west face of PP on the east side of 127th Street East, adjacent to the south line of The Fairmont Addition.
 Elev. = 187.25 (City Datum)
 BM #3: RR spike on the east face of PP on the west side of 127th Street East, 37' N and 13' E of the NE corner of Lot 1, Block H, The Fairmont Addition.
 Elev. = 189.19 (City Datum)

P.V.I.
 Elev. = 204.50
 26.60' V.C.

Scale: 1" = 20'
 • = Iron

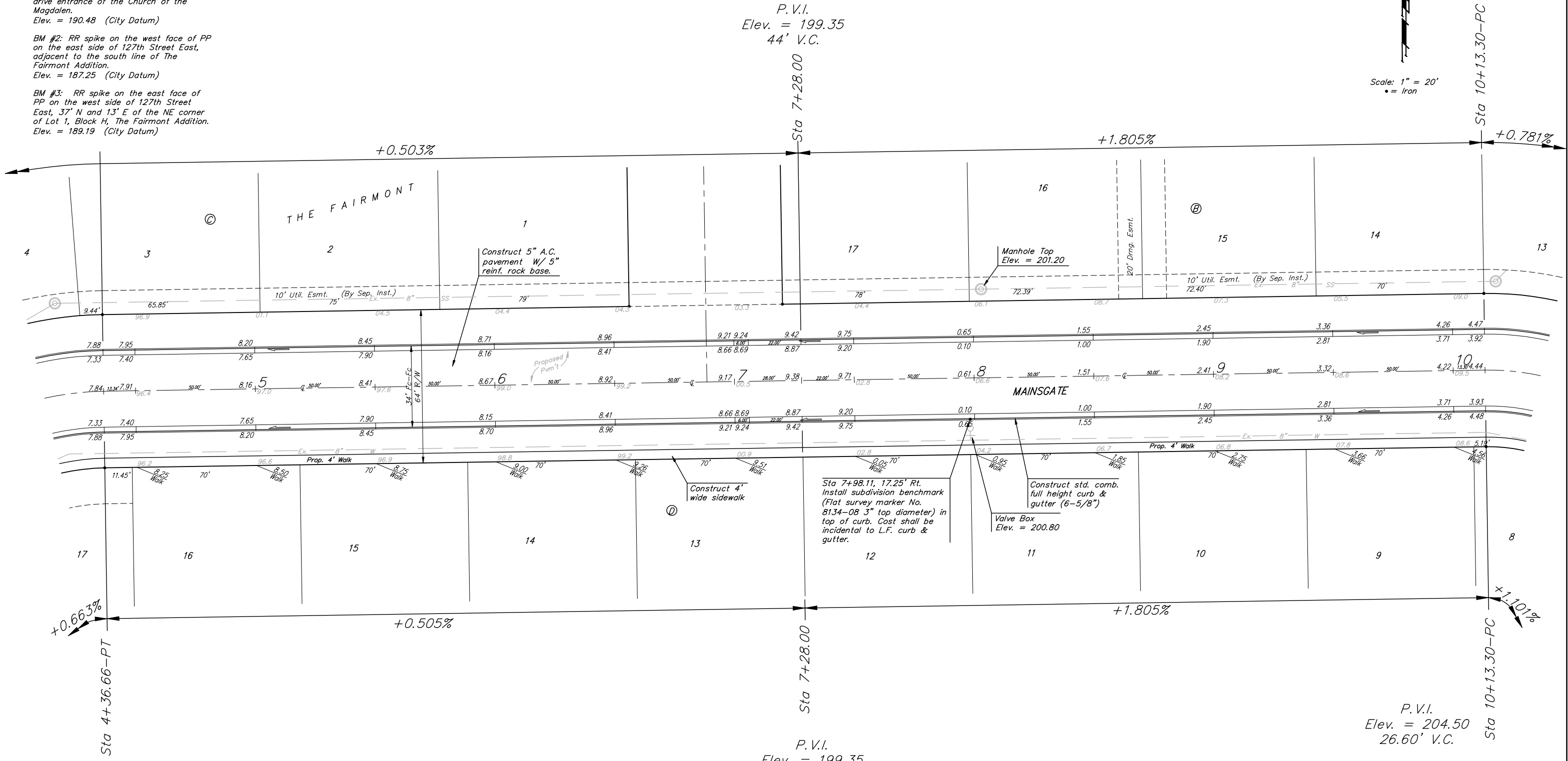

P.V.I.
 Elev. = 197.88
 No V.C.

P.V.I.
 Elev. = 199.35
 44' V.C.

P.V.I.
 Elev. = 204.50
 26.60' V.C.

Baughman		THE FAIRMONT - PHASE III	
		MAINSGATE	
		STA 4+36.66 TO STA 10+13.30	
Baughman Company, P.A. 315 Elm St. Wichita, KS 67211 P 316-262-7771 F 316-262-0149			
ENGINEERING SURVEYING PLANNING LANDSCAPE ARCHITECTURE			
PROJECT NUMBER 472-83485	DESIGN ATD	DRAWN TMS	
REVISIONS:	APPROVED	DATE 09/05	
	SCALE Noted	SHEET	
			7 OF 27
Fairmont/PhaseIII/Str1		04-04-E871	