

BENCHMARKS:
 BM #1: "□" Cut on T.C., 12' west of east end of N curb return on the north drive entrance of the Church of the Magdalen.
 Elev. = 190.48 (City Datum)
 BM #2: RR spike on the west face of PP on the east side of 127th Street East, adjacent to the south line of The Fairmont Addition.
 Elev. = 187.25 (City Datum)
 BM #3: RR spike on the east face of PP on the west side of 127th Street East, 37' N and 13' E of the NE corner of Lot 1, Block H, The Fairmont Addition.
 Elev. = 189.19 (City Datum)

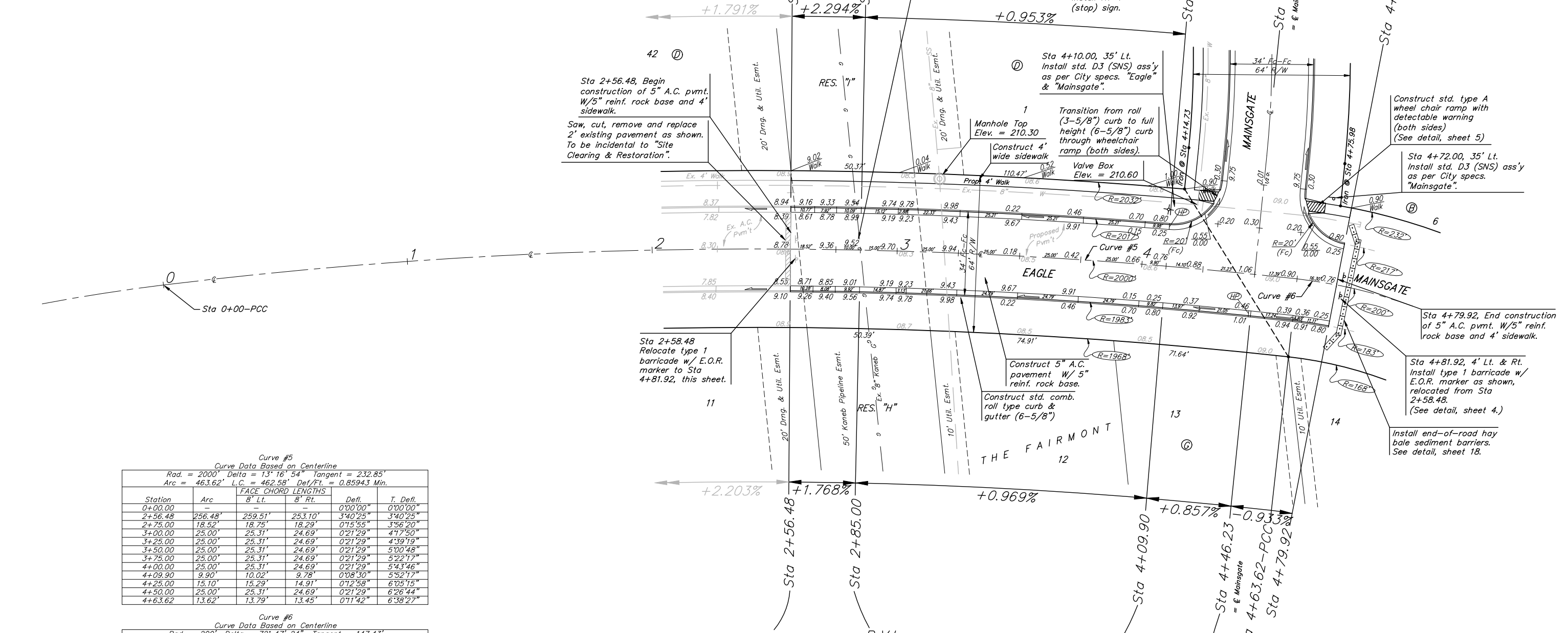
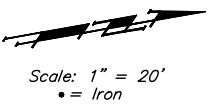

Curve #5
 Curve Data Based on Centerline
 Rad. = 2000' Delta = 13° 16' 54" Tangent = 232.85'
 Arc = 463.62' L.C. = 462.58' Def./Ft. = 0.85943 Min.

Station	Arc	FACE CHORD LENGTHS		Defl.	T. Defl.
		8' Lt.	8' Rt.		
0+00.00	-	-	-	0'00'00"	0'00'00"
2+56.48	256.48'	259.51'	253.10'	3'40'25"	3'40'25"
2+75.00	18.52'	18.75'	18.29'	0'15'55"	3'56'20"
3+00.00	25.00'	25.31'	24.69'	0'21'29"	4'17'50"
3+25.00	25.00'	25.31'	24.69'	0'21'29"	4'39'19"
3+50.00	25.00'	25.31'	24.69'	0'21'29"	5'00'48"
3+75.00	25.00'	25.31'	24.69'	0'21'29"	5'22'17"
4+00.00	25.00'	25.31'	24.69'	0'21'29"	5'43'46"
4+09.90	9.90'	10.02'	9.78'	0'08'30"	5'52'17"
4+25.00	15.10'	15.29'	14.91'	0'12'58"	6'05'15"
4+50.00	25.00'	25.31'	24.69'	0'21'29"	6'26'44"
4+63.62	13.62'	13.79'	13.45'	0'11'42"	6'38'27"

Curve #6
 Curve Data Based on Centerline
 Rad. = 200' Delta = 72° 47' 24" Tangent = 147.43'
 Arc = 254.08' L.C. = 237.34' Def./Ft. = 8.59454 Min.

Station	Arc	FACE CHORD LENGTHS		Defl.	T. Defl.
		8' Lt.	8' Rt.		
4+63.62	-	-	-	0'00'00"	0'00'00"
4+79.92	16.30'	18.33'	14.26'	2'20'05"	2'20'05"
7+17.70	237.78'	252.03'	196.02'	34'03'36"	36'23'42"

THE FAIRMONT - PHASE III
EAGLE
 STA 2+56.48 TO STA 4+79.92

Baughman
 ENGINEERING | SURVEYING | PLANNING | LANDSCAPE ARCHITECTURE

PROJECT NUMBER: 472-83485
 DESIGN: ATD
 DRAWN: TMS
 APPROVED: [Signature]
 DATE: 09/05
 SCALE: Noted
 SHEET: 10 OF 27

Fairmont/PhaseIII/Str1 04-04-E871