

BENCHMARKS:

BM #1: "□" Cut on T.C., 12' west of east end of N curb return on the north drive entrance of the Church of the Magdalen.
Elev. = 190.48 (City Datum)

BM #2: RR spike on the west face of PP on the east side of 127th Street East, adjacent to the south line of The Fairmont Addition.
Elev. = 187.25 (City Datum)

BM #3: RR spike on the east face of PP on the west side of 127th Street East, 37' N and 13' E of the NE corner of Lot 1, Block H, The Fairmont Addition.
Elev. = 189.19 (City Datum)



Scale: 1" = 20'
• = Iron

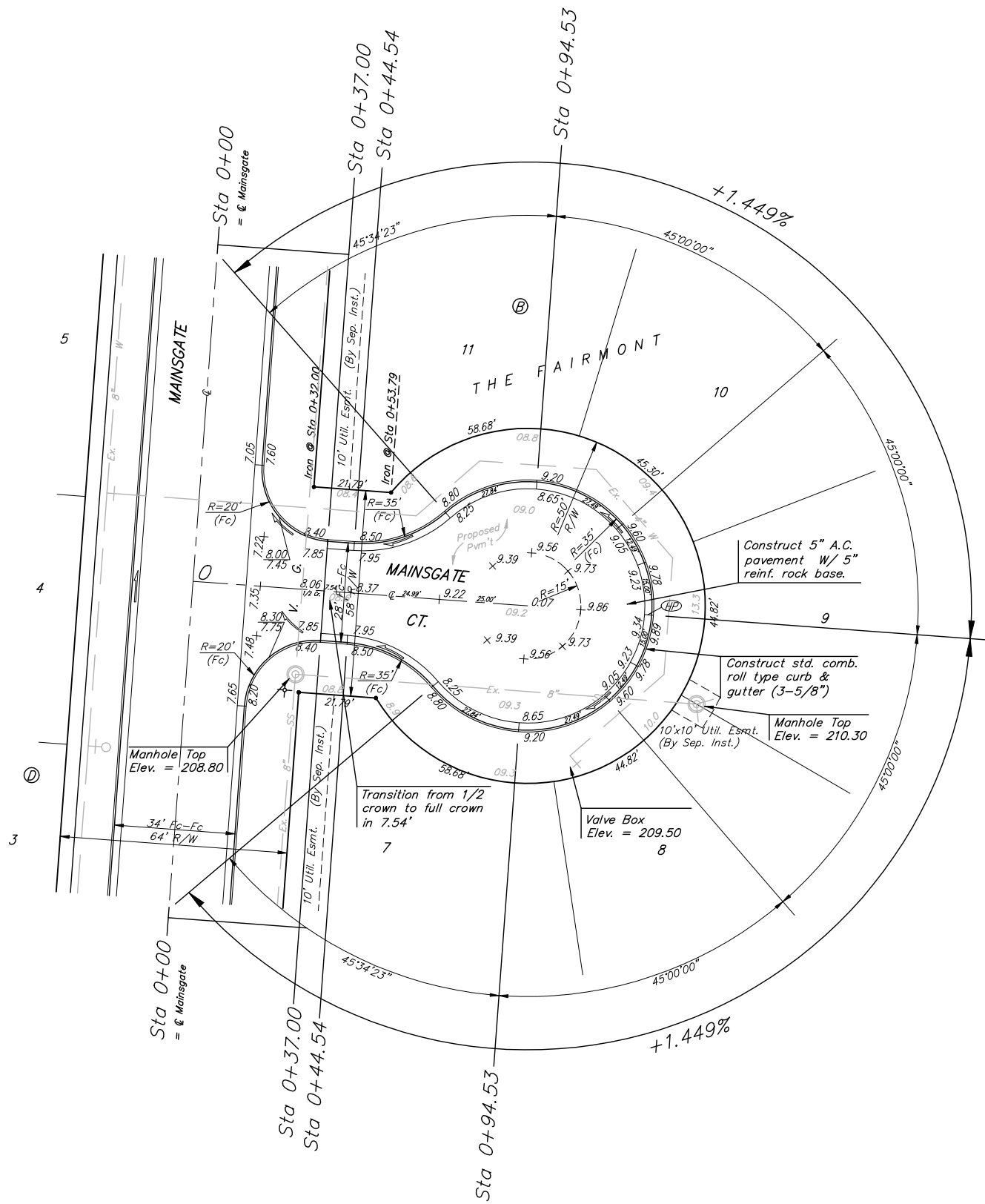

P.V.I.
Elev. = 210.00
30' V.C.

NOTE: ROLL TYPE CURB & GUTTER TO BE CONSTRUCTED ON THE PAVEMENT SHOWN ON THIS SHEET. TOP OF CURB ELEVATIONS ARE GIVEN FOR FULL HEIGHT CURB.

		THE FAIRMONT - PHASE III	
		MAINSGATE CT.	
PROJECT NUMBER 472-63485		DESIGN ATD	
REVISIONS:		DRAWN TMS	
APPROVED:		DATE 09/05	
SCALE Noted		SHEET 11 OF 27	
Fairmont/PhaseIII/Str1		04-04-E871	