

Q CURVE DATA
 $\Delta = 90^\circ 19' 33.3''$ $D = 32' 44.256''$ $R = 175.00'$ $L = 275.88'$ $T = 176.00'$ $E = 73.19'$
 CURVE DATA BASED ON Q radius $\Delta/2 = 45^\circ 9' 46.5''$

Q STATION	Q ARC LENGTH	FACE CURB LENGTH		CHORD LENGTH		DEFLECTION ANGLE	Q TOTAL DEFLECTION
		LEFT CURB	RIGHT CURB	8' OFF LEFT FACE CURB	8' OFF RIGHT FACE CURB		
64+43.31						0°00'00.0"	0°00'00.0"
64+50.00	6.69'	6.04'	7.34'	5.73'	7.65'	01°05'42.6"	01°05'42.6"
64+65.00	15.00'	13.54'	16.46'	12.85'	17.14'	02°27'19.9"	03°33'02.5"
64+75.00	10.00'	9.03'	10.97'	8.57'	11.43'	01°38'13.3"	05°11'15.8"
65+00.00	25.00'	22.57'	27.43'	21.41'	28.55'	04°05'33.2"	09°16'49.0"
65+25.00	25.00'	22.57'	27.43'	21.41'	28.55'	04°05'33.2"	13°22'22.2"
65+50.00	25.00'	22.57'	27.43'	21.41'	28.55'	04°05'33.2"	17°27'55.5"
65+61.14	11.14'	10.06'	12.22'	9.55'	12.73'	01°49'25.1"	19°17'20.6"
66+00.00	13.86'	12.51'	15.21'	11.88'	15.84'	02°16'08.1"	21°33'28.7"
66+25.00	25.00'	22.57'	27.43'	21.41'	28.55'	04°05'33.2"	25°39'01.9"
66+50.00	25.00'	22.57'	27.43'	21.41'	28.55'	04°05'33.2"	29°44'35.1"
66+75.00	25.00'	22.57'	27.43'	21.41'	28.55'	04°05'33.2"	33°50'08.3"
67+00.00	25.00'	22.57'	27.43'	21.41'	28.55'	04°05'33.2"	37°55'41.5"
67+19.19	19.19'	17.33'	21.08'	16.44'	21.93'	03°08'29.2"	45°09'46.6"
TOTAL	275.88'	249.08'	302.68'				

Defl./ft. = 9.822134 min.

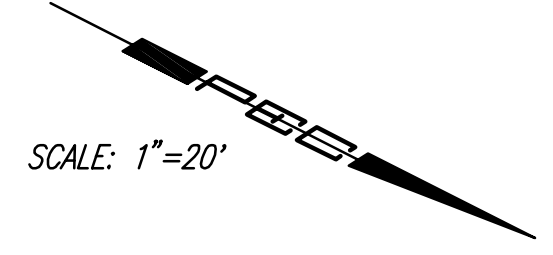

SCALE: 1"=20'

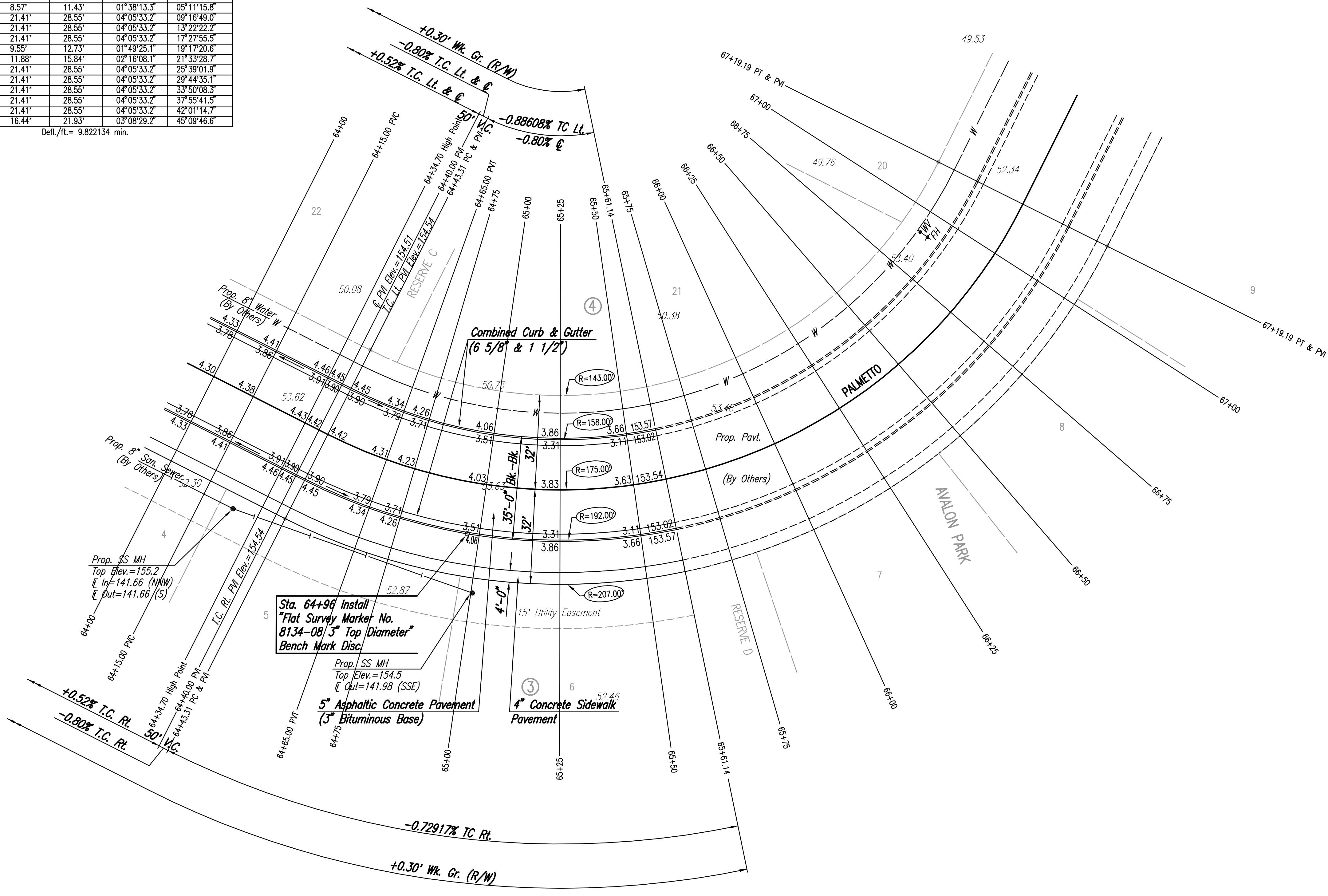

Sta. 64+96 Install
 "Flat Survey Marker No.
 8134-08/3" Top Diameter"
 Bench Mark Disc

Prop. SS MH
 Top Elev. = 154.5
 In = 141.98 (SSE)
 Out = 141.98 (SSE)

5" Asphaltic Concrete Pavement
 (3" Bituminous Base)

4" Concrete Sidewalk
 Pavement

DSNR: BLB OPER: BJS SCALE: 1"=20.00
 C:\2005\05059\000\05059-000-C-STR64-67 06-13-2005 01:37:36 pm

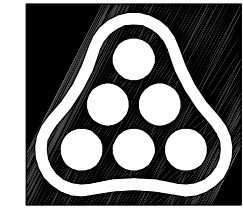

No.	Revision	By	Date
AVALON PARK-PHASE 4			
PALMETTO			
STA. 64+43.31 TO STA. 65+61.14 JAMES L. ARMOUR, P.E.-CITY ENGINEER CITY OF WICHITA PROJECT NO. 472-83838			
Professional Engineering Consultants, P.A. 303 S. TOPEKA • WICHITA, KANSAS 67202 316-262-2691 • FAX 316-262-3003			
Designed by	BDB, BLB	Job No.	35-05059-000
Drawn by	BJS	Date	February 2005
			Sht. 8 of 22