

Subdivision Bench Marks

No.	Street and Station	From CL	Description	Elevation
8	Stout Ct. Sta. 3+23.38	18' 0" Lt.	End of Curb Return Stout Ct. in front of Hydrant South curbline	

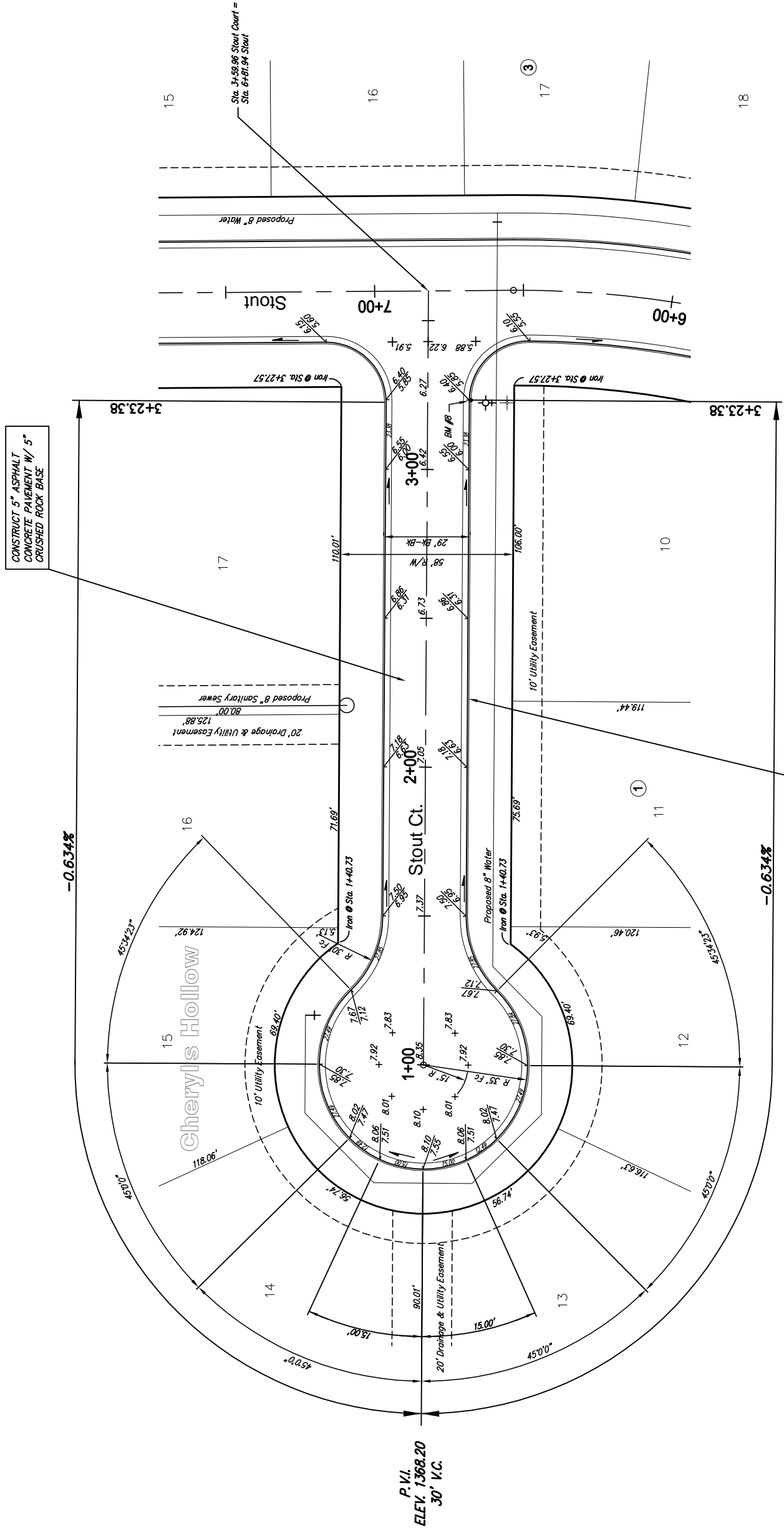

CONSTRUCT COMBINED ROLL TYPE CURB AND GUTTER (3'-5/8") BOTH SIDES

CONSTRUCT 5" ASPHALT CONCRETE PAVEMENT W/ 5" CRUSHED ROCK BASE



SCALE 1" = 20'  
IRON = •

NOTE: ROLL TYPE CURB AND GUTTER TO BE CONSTRUCTED ALONG PAVEMENT DEPICTED ON THIS SHEET

Cheryls Hollow Addition, Paving Improvements  
Stout Court  
WICHITA, KANSAS



**Ruggles & Bohm, F.A.**  
Engineering, Surveying, Land Planning  
924 North Main  
Wichita, Kansas 67203  
www.rbkansas.com  
E-mail: info@rbkansas.com