

DSNR: BLB OPER: BJS SCALE: 1"=10.00
 C:\2004\04688\000\04688-000-C-ROUNDABOUT-DETAILS_2 08-23-2005 09:08:25 am

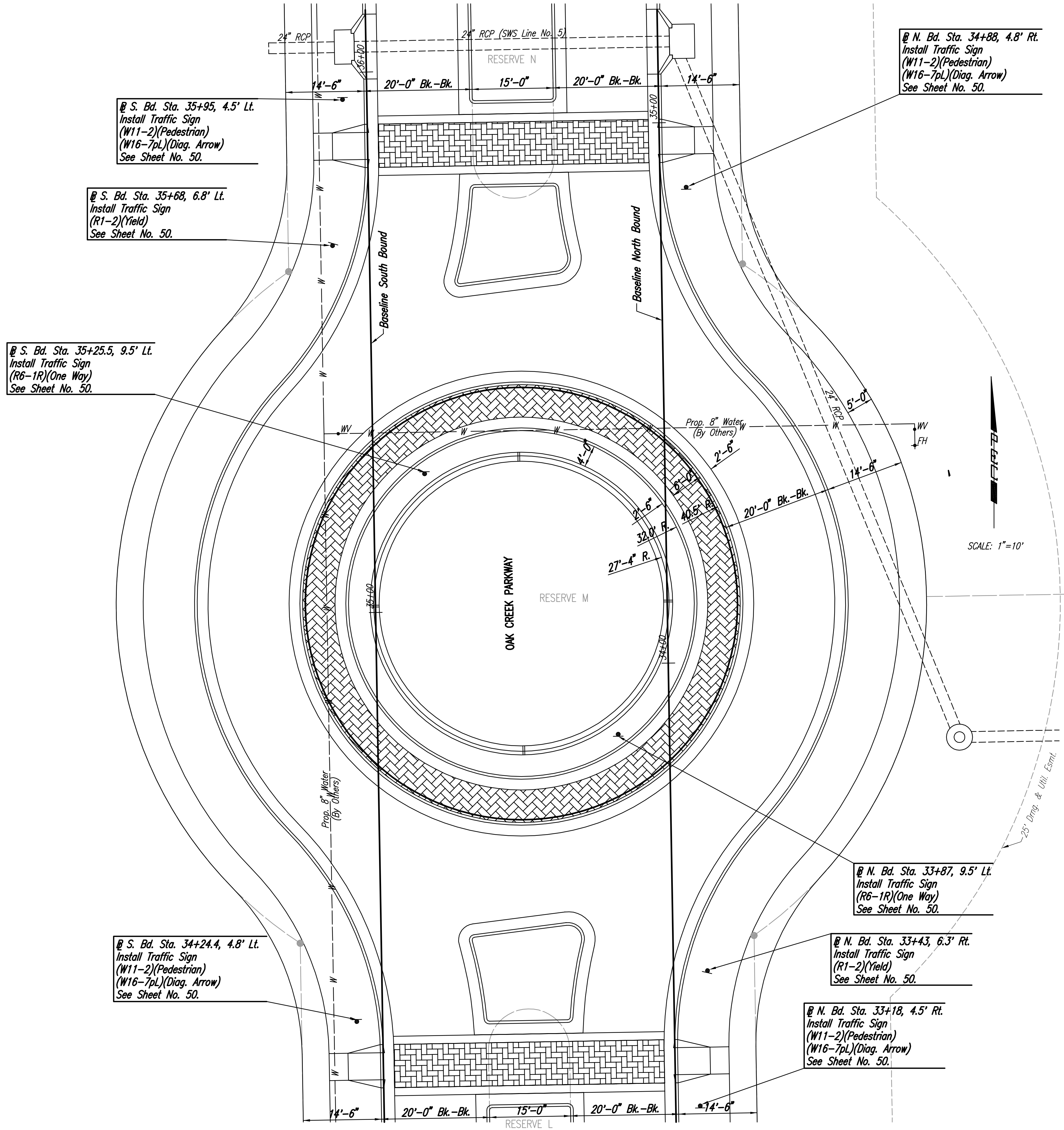

@ S. Bd. Sta. 35+95, 4.5' Lt.
 Install Traffic Sign
 (W11-2)(Pedestrian)
 (W16-7pL)(Diag. Arrow)
 See Sheet No. 50.

@ S. Bd. Sta. 35+68, 6.8' Lt.
 Install Traffic Sign
 (R1-2)(Yield)
 See Sheet No. 50.

@ S. Bd. Sta. 35+25.5, 9.5' Lt.
 Install Traffic Sign
 (R6-1R)(One Way)
 See Sheet No. 50.

@ N. Bd. Sta. 34+88, 4.8' Rt.
 Install Traffic Sign
 (W11-2)(Pedestrian)
 (W16-7pL)(Diag. Arrow)
 See Sheet No. 50.

@ N. Bd. Sta. 33+87, 9.5' Lt.
 Install Traffic Sign
 (R6-1R)(One Way)
 See Sheet No. 50.

@ N. Bd. Sta. 33+43, 6.3' Rt.
 Install Traffic Sign
 (R1-2)(Yield)
 See Sheet No. 50.

@ N. Bd. Sta. 33+18, 4.5' Rt.
 Install Traffic Sign
 (W11-2)(Pedestrian)
 (W16-7pL)(Diag. Arrow)
 See Sheet No. 50.

@ S. Bd. Sta. 34+24.4, 4.8' Lt.
 Install Traffic Sign
 (W11-2)(Pedestrian)
 (W16-7pL)(Diag. Arrow)
 See Sheet No. 50.

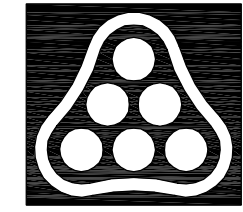
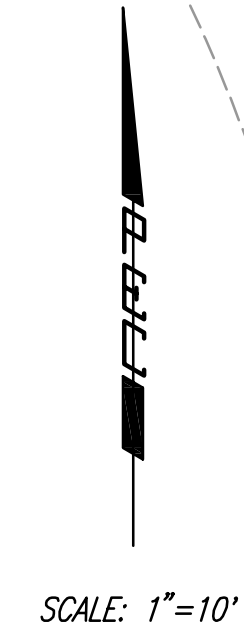

No.	Revision	By	Date
	OAK CREEK - PHASE 1		
ROUNDABOUT SIGNING PLAN			
STA. 34+00			
JAMES L. ARMOUR, P.E. - CITY ENGINEER CITY OF WICHITA PROJECT NO. 472-84209			
Professional Engineering Consultants, P.A.			
303 S. TOPEKA • WICHITA, KANSAS 67202 316-262-2691 • FAX 316-262-3003			
Designed by	BDB, BLB	Job No.	35-04688-000
Drawn by	BJS	Date	October 2004
			Sheet 18 of 86