

DATE: _____
 BY: _____
 CHECKED: _____
 PLAN

DATE: _____
 BY: _____
 CHECKED: _____
 PROFILE

DSNR, BJB OPER, BJS SCALE: 1"=20.00
 C:\2004\04688\000\04688-000-C-SWSLINE6 08-23-2005 09:00:00 am

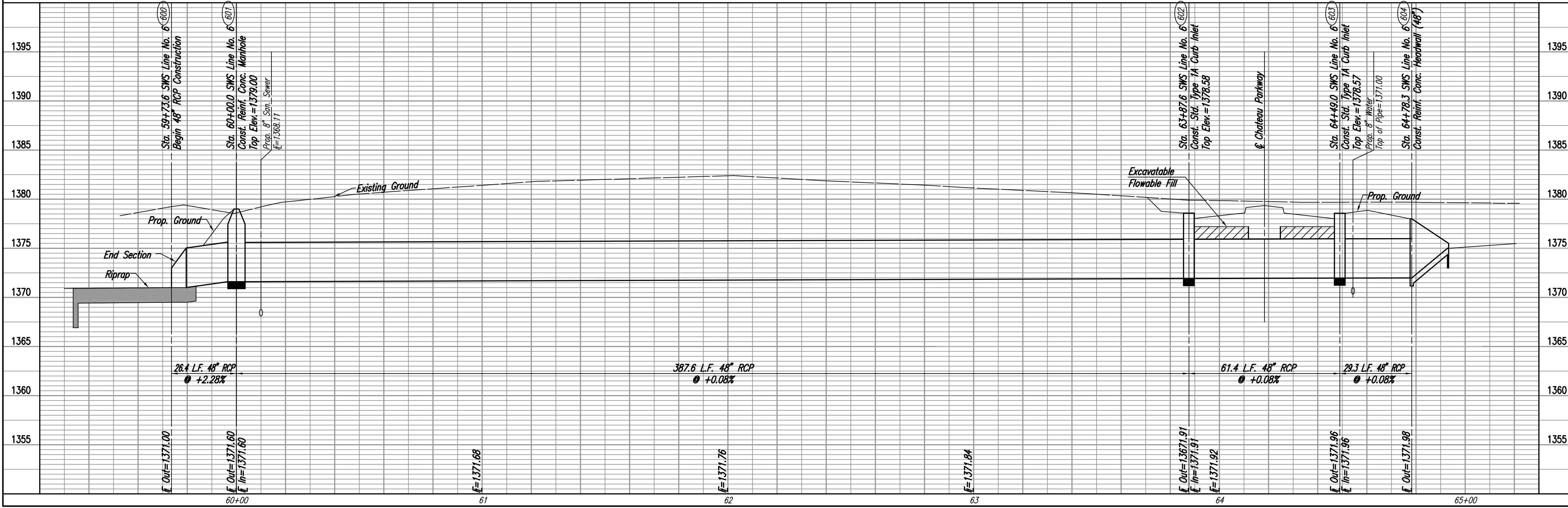

OAK CREEK - PHASE 1
SWS LINE NO. 6
 Professional Engineering Consultants, P.A.
 303 S. TORREY, WICHITA, KANSAS 67202
 316-262-2291 • FAX 316-262-3003
 Designed By: BDB, BJB
 Job No.: 35-04688-000
 Date: October 2004
 Drawn By: BJS
 Sheet 27 of 86

Sta. 59+73.6 SWS Line No. 6
 Begin 48" RCP Construction
 Install 26.4 L.F. 48" RCP (NW)
 (Including End Section)

Sta. 60+00.0 SWS Line No. 6
 Const. Reinf. Conc. Manhole
 L=8'-6", W=7'-0"
 Top Elev.=1379.00
 Install 387.6 L.F. 48" RCP (W)
 See Sheet No. 36.

Sta. 63+87.6 SWS Line No. 6=
 @ N. Bd. Chateau Parkway Sta. 52+70.13, 3.67' Rt.
 Const. Std. Type 1A Curb Inlet ⊕
 L=10'-0", W=3'-0"
 Top Elev.=1378.58
 Install 61.4 L.F. 48" RCP (SW)
 See Sheet No. 33.

Sta. 64+49.0 SWS Line No. 6=
 @ S. Bd. Chateau Parkway Sta. 52+73.66, 3.67' Lt.
 Const. Std. Type 1A Curb Inlet ⊕
 L=10'-0", W=3'-0"
 Top Elev.=1378.57
 Install 29.3 L.F. 48" RCP (SW)
 See Sheet No. 33.

Sta. 64+78.3 SWS Line No. 6
 Const. Reinf. Conc. Headwall (48")
 w/Grate
 See Sheet No. 34.

COORDINATE LIST		
POINT	NORTH	EAST
600	386,581.9143	2,372,582.7248
601	386,602.7070	2,372,566.5276
602	386,597.4622	2,372,178.9283
603	386,572.5223	2,372,122.8859
604	386,554.8690	2,372,099.3879

⊕ = COORDINATE POINT NO.
 SEE SHEET NO. 3 FOR PLAT COORDINATES

CAUTION !!!
 Proposed 8" Water
 City of Wichita

SCALE: 1"=20'

