

FOX RIDGE ADDITION

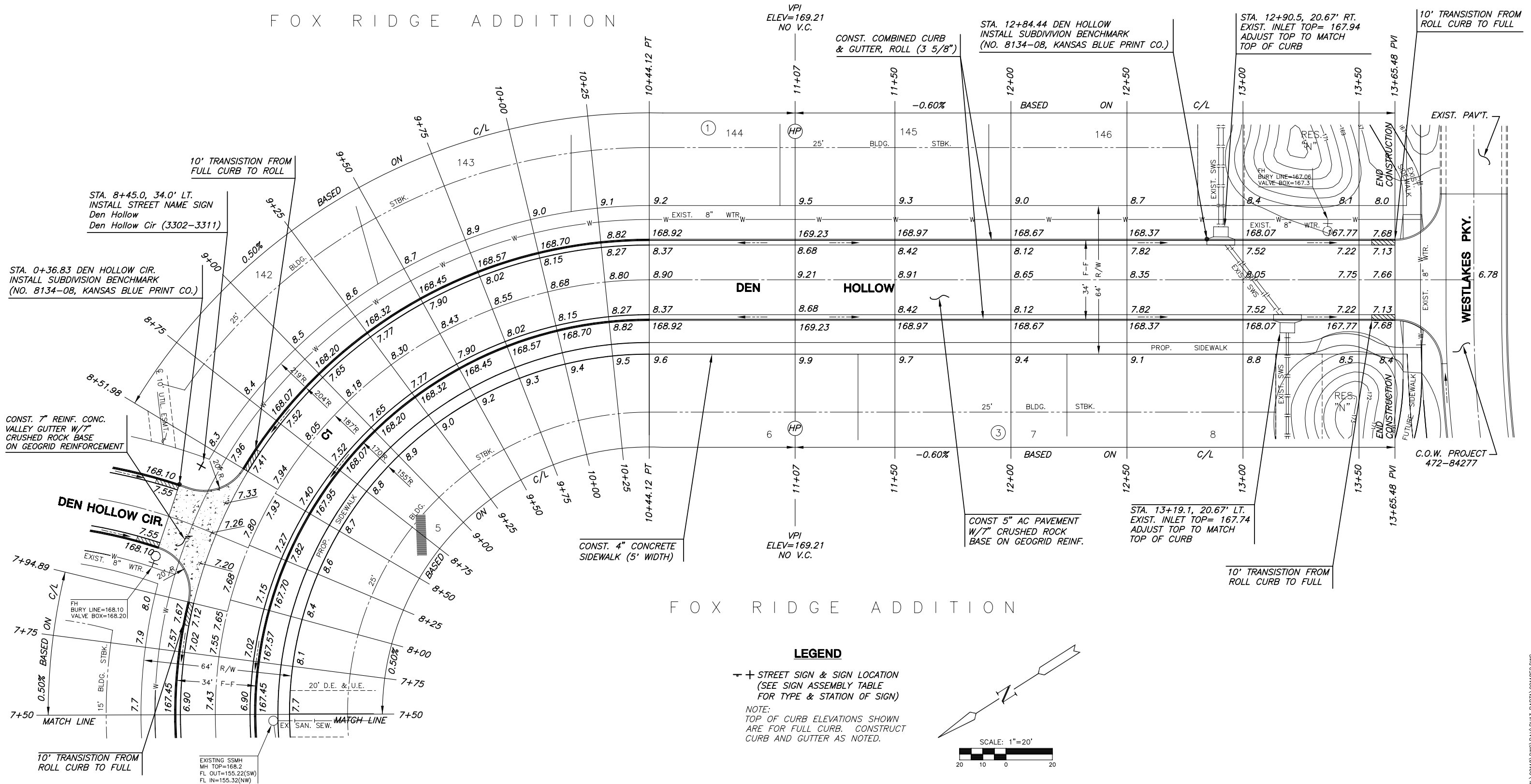

FOX RIDGE ADDITION

LEGEND

— + STREET SIGN & SIGN LOCATION
(SEE SIGN ASSEMBLY TABLE
FOR TYPE & STATION OF SIGN)

NOTE:
TOP OF CURB ELEVATIONS SHOWN
ARE FOR FULL CURB. CONSTRUCT
CURB AND GUTTER AS NOTED.

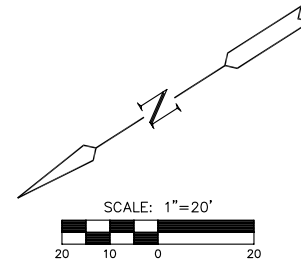

SUBDIVISION BENCH MARKS

NO.	STREET AND STATION	FROM CL	DESCRIPTION	ELEVATIONS
1	WILD THICKET CT. STA 0+34.98	14.5' RT.	TOP OF CURB AT S. END OF N. RETURN, INTERSECTION OF WILD THICKET	168.16
2	DEN HOLLOW CIR. STA 0+36.83	14.5' RT.	TOP OF CURB AT S.W. END OF N.E. RETURN, INTERSECTION OF DEN HOLLOW	168.10
3	DEN HOLLOW CIR. STA 5+95.86	26.9' RT.	TOP OF CURB AT E. CORNER OF SWS INLET	168.75
4	DEN HOLLOW STA 12+84.44	17.5' LT.	TOP OF CURB AT E. CORNER OF SWS INLET	167.99

NOTE: CONTRACTOR SHALL INSTALL SUBDIVISION BENCH MARKS ("FLAT SURVEY MARKERS NO. 8134-08 3" TOP DIAMETER" PROVIDED BY KANSAS BLUE PRINT CO., INC.) COSTS TO BE CONSIDERED SUBSIDIARY TO CONSTRUCTION OF COMBINED RB AND GUTTER.

MKEC
ENGINEERING
CONSULTANTS
411 N. WEBB ROAD
WICHITA, KS. 67206
316-684-9600

FOX RIDGE ADDITION - PHASE 13 - PART 1
PROJECT NAME

WILD THICKET PAVING
SHEET TITLE

DFL DESIGN BY:	MKRK DRAWN BY:	GJA CHECKED BY:
SEPTEMBER 2005 DATE	99118 JOB NO.	8 / 22 SHEET/OF