

CATCH BASIN SCHEDULE

C.B. #	MANUFACTURER'S #	MANUFACTURER	SIZE
1	R-1818-A3G	NEENAH	18X18
2	R-1818-A5G	NEENAH	22X22
3	R-1818-A5G	NEENAH	22X22

HDPE - HIGH DENSITY POLYETHYLENE PIPE.
 HI-Q - HANGOR COMPANY, 1-800-841-6900
 N-12 - ADVANCED DRAINAGE SYSTEMS, 1-800-133-4964
 NEENAH CONSTRUCTION CASTINGS, 1-800-558-5015

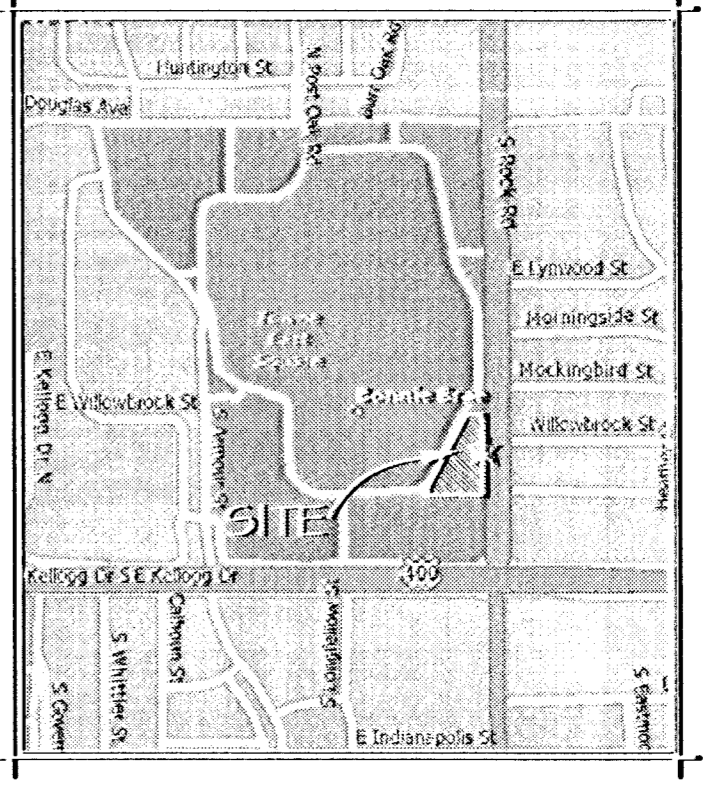
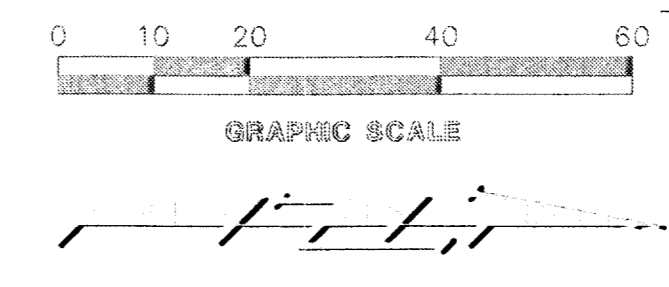

DESIGN
and
ENGINEERING

PLC ARCHITECTS
STRUCTURAL AND CIVIL ENGINEERS

5105 Maryland Way Suite 200
 Brentwood, Tennessee 37027
 615-370-1777 Fax: 615-370-9108
 www.dandesign.us

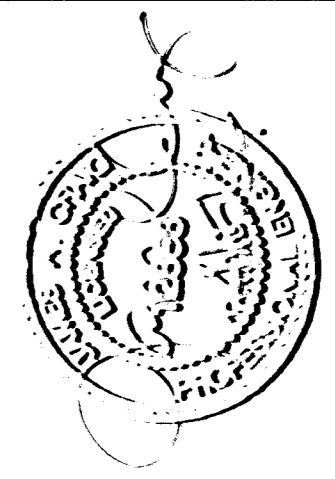

5011 Arroyo Dr., Suite 500
 Nashville, Tennessee 37204
 Phone: (615) 885-4056

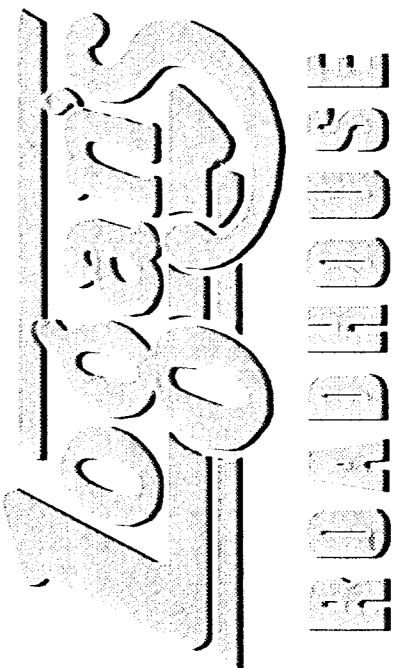

Location:
 ROCK ROAD
 HIGHWAY
 (EAST)

Job Number:
 40-0484-1DG
Revision:
 1/22/08 PER CITY OF NASHVILLE PERMITTED 11/1/08
 2/28/08 PER CITY OF NASHVILLE PERMITTED 11/1/08
 3/10/08 PER PERM AND PPS

2/4

STORM PROFILES
DATE: 09, 2008
PROJECT:

NOTES

- A. OWNER: LOGAN'S ROADHOUSE, INC.
5011 ARROYO DRIVE
NASHVILLE, TENNESSEE 37204
TELEPHONE: (615) 885-4056
 - B. BOUNDARY INFORMATION TAKEN FROM TOPOGRAPHIC SURVEY BY:
BAUGMAN COMPANY, P.A.
315 ELLIS ST. NASHVILLE, TN 37203
DATED: JULY 11, 2006
 - C. TOTAL AREA OF SITE: 1.98 ACRES
 - D. PARKING SUMMARY:
118 PARKING SPACES FOR CARS
3 HANDICAP PARKING SPACES
121 TOTAL PARKING SPACES
 - E. BUILDING: 1259 SQUARE FEET
 - F. THE CONTRACTOR SHALL DO AND PERFORM THE WORK IN ACCORDANCE WITH ALL LOCAL, STATE AND NATIONAL CODES AND THE REQUIREMENTS OF THE LOCAL UTILITY COMPANY.
 - G. PERSONS USING THIS DRAWING SHOULD CONTACT LOCAL UTILITY COMPANIES FOR EXACT LOCATIONS OF UNDERGROUND UTILITIES.
 - H. ALL DIMENSIONS ARE TO FACE OF CURB, UNLESS OTHERWISE NOTED.
 - I. UNLESS NOTED OTHERWISE, CURB RADIUS 30'.
 - J. DO NOT SCALE THIS DRAWING AS IT IS A REPRODUCTION AND SUBJECT TO DISTORTION.
 - K. REMOVE ALL FOUNDATIONS, UNDERGROUND TANKS, PAVING, BASE ETC. IF REMAINING, BEFORE BEGINNING CONSTRUCTION.
 - L. FILL ALL PLANTERS/ISLANDS TO TOP OF CONCRETE CURB WITH TOPSOIL. TOPSOIL TO BE CLEAN AND FREE OF DEBRIS, ETC.
 - M. THESE PLANS, PREPARED BY DESIGN AND ENGINEERING, DO NOT EXTEND TO OR INCLUDE SYSTEMS PERTAINING TO THE SAFETY OF THE CONSTRUCTION CONTRACTOR OR ITS EMPLOYEES, AGENTS OR REPRESENTATIVES IN THE PERFORMANCE OF THE WORK. THE SEAL OF DESIGN AND ENGINEERING'S REGISTERED PROFESSIONAL ENGINEER PERSON DOES NOT EXTEND TO ANY SUCH SAFETY SYSTEMS THAT MAY NOW OR HEREAFTER BE INCORPORATED INTO THESE PLANS. THE CONSTRUCTION CONTRACTOR SHALL PREPARE OR OBTAIN THE APPROPRIATE SAFETY SYSTEMS WHICH MAY BE REQUIRED BY U.S. OCCUPATIONAL SAFETY AND HEALTH ADMINISTRATION (OSHA) AND/OR LOCAL REGULATIONS.
 - N. IN THE CASE OF CONFLICT BETWEEN THIS DRAWING AND ANY OTHER DRAWING AND/OR THE SPECIFICATIONS, THE ENGINEER SHALL BE IMMEDIATELY NOTIFIED FOR CLARIFICATION.
 - O. THE GEOTECHNICAL REPORT, PREPARED BY OTHERS, IS INCORPORATED BY REFERENCE AND MADE A PART OF THE CONTRACT DOCUMENTS. IT IS INTENDED THAT THE RECOMMENDATIONS IN THE GEOTECHNICAL REPORT BE FOLLOWED. IN THE EVENT OF CONFLICT BETWEEN THE DRAWINGS AND THE GEOTECHNICAL REPORT, MAKE NO ASSUMPTIONS. THE ENGINEER SHALL BE IMMEDIATELY NOTIFIED FOR CLARIFICATION BEFORE ANY WORK IS BEGUN.
 - P. THE GENERAL CONTRACTOR SHALL PROTECT ALL GRADED SURFACES, ON AND OFF SITE, UNTIL SUCH TIME AS THE FINISH SURFACES ARE APPLIED.
- GRADING NOTES:**
- A. GRADE ALL LANDSCAPE AREAS TO DRAIN. NO PONDING WILL BE ALLOWED.
 - B. STRIP ALL TOPSOIL AND OTHER DELETERIOUS MATERIALS AS PER SOIL CONSULTANTS, GEOTECHNICAL REPORT. TO ACCOMPLISH GRADING AS INDICATED ON THE PLANS, STOCKPILE TOPSOIL IN AREA(S) DESIGNATED BY THE OWNER FOR REUSE IN LANDSCAPE AREAS.
 - C. AFTER DEMOLITION IS COMPLETE, PROOF-ROLL THE EXPOSED SUBGRADE TO DETECT ANY LOOSE OR SOFT AREAS. ANY YIELDING MATERIAL SHOULD BE UNDERGUT AND RECOMPACTED AS NOTED BELOW.
 - D. FILL MATERIAL SHALL MEET THE FOLLOWING REQUIREMENTS:
 LIQUID LIMIT - LESS THAN 40
 PLASTICITY INDEX BETWEEN 10 AND 20
 PARTICLE SIZE #10 MAXIMUM
 MAXIMUM GRAVEL CONTENT - 30% RETAINED ON 3/4" SIEVE
 MAXIMUM ALLOWABLE ORGANIC CONTENT - 3% BY WEIGHT (NO LARGE ROOTS)
 PROVIDE THE OWNER WITH TEST RESULTS OF OFF-SITE BORROW MATERIAL FOR APPROVAL PRIOR TO BRINGING SUCH MATERIAL ON-SITE.
 - E. COMPACT ALL FILL TO A MINIMUM OF 98% OF THE MAXIMUM STANDARD PROCTOR DRY DENSITY. THE MOISTURE CONTENT AT TIME OF COMPACTION SHALL BE WITHIN ±2% OF THE OPTIMUM MOISTURE. MAXIMUM LOOSE LIFT THICKNESS SHALL BE 8 INCHES WITH DENSITY TESTING - 1 PER 2500 TO 5000 FOR EACH LIFT, (ACTUAL FREQUENCY PER ASITE GEOTECHNICAL).
 - F. SEE LANDSCAPE PLANS FOR TREES AND SHRUBS TO REMAIN.

10" PVC PIPE
 23' E TO EXISTING LINE
 Grout Well and
 Break sewer &
 Make connection E.W.

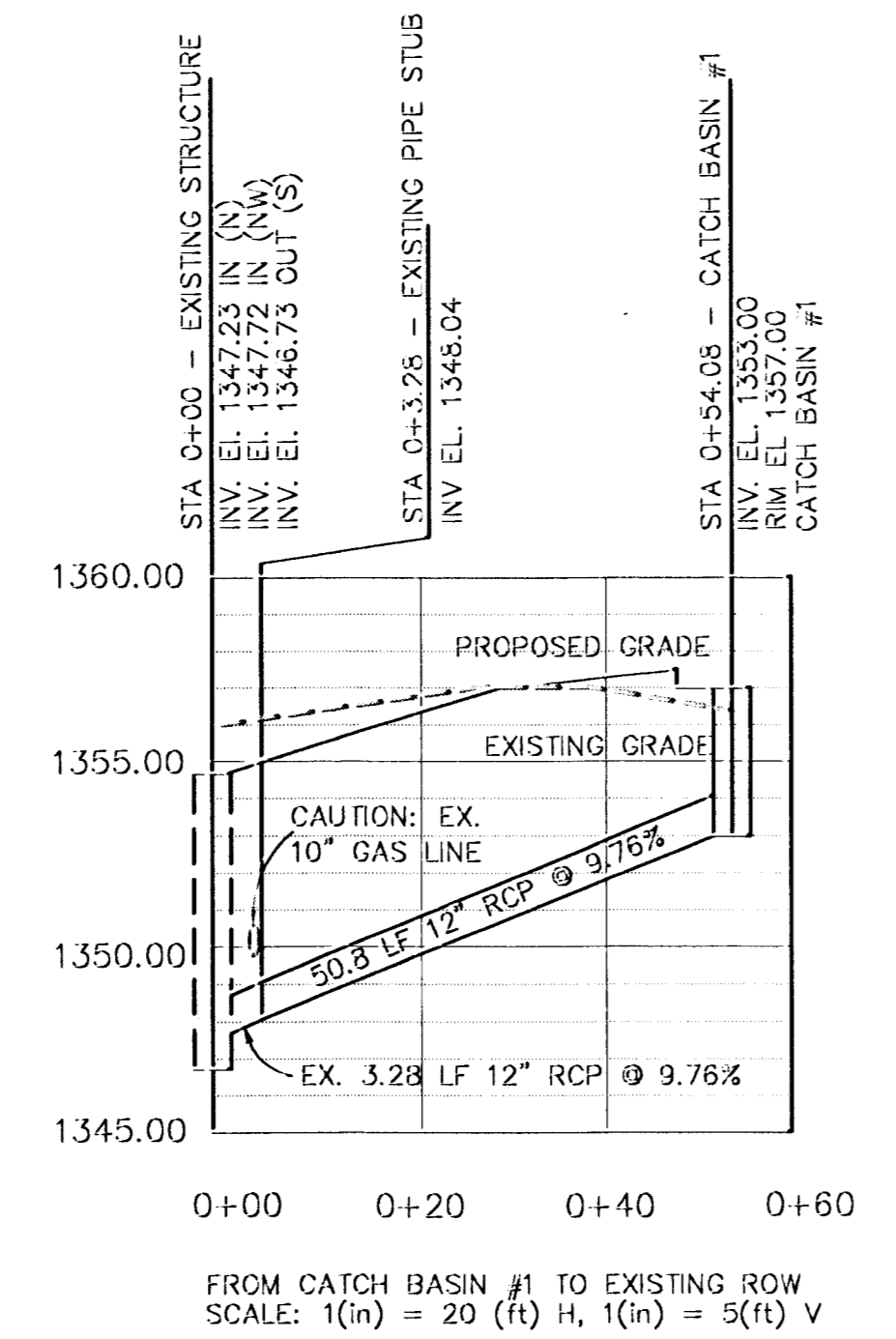
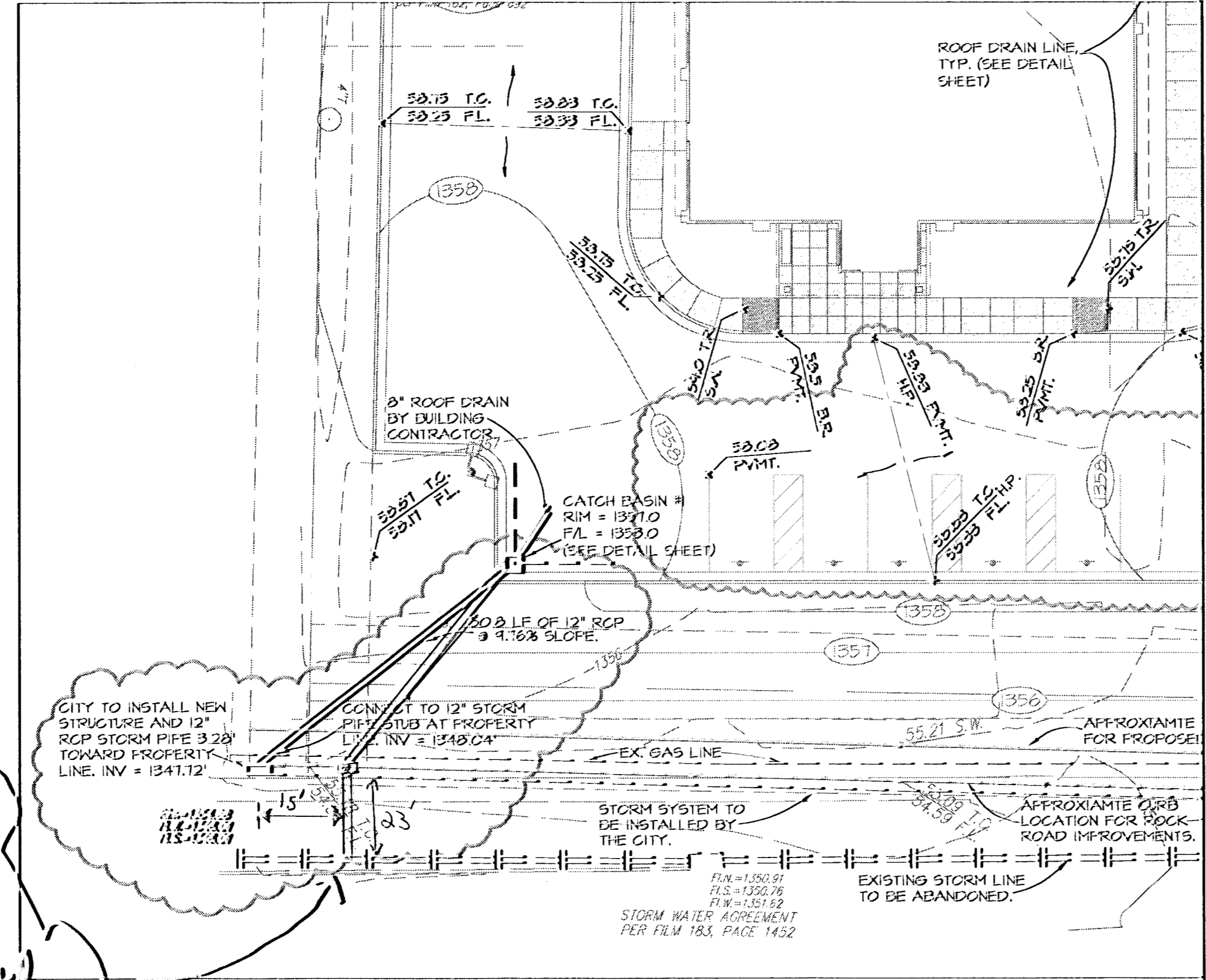

AS BUILT PLANS

8/27/2007

Jag

These design documents are the exclusive property of Design and Engineering, P.C. The information shown may not be used or reproduced without written permission of Design and Engineering, P.C.