

**BENCHMARK:**  
 BM #7 - Small RR Spike in the South Face of the 1st Power Pole East of Keith on the North Side of 29th Street North.  
 Sta. 2+063.40, 14.84m Lt.  
 Elev. 411.437 SI Units (1349.86 MSL)

**FOX RIDGE ADDITION**  
 Reserve G

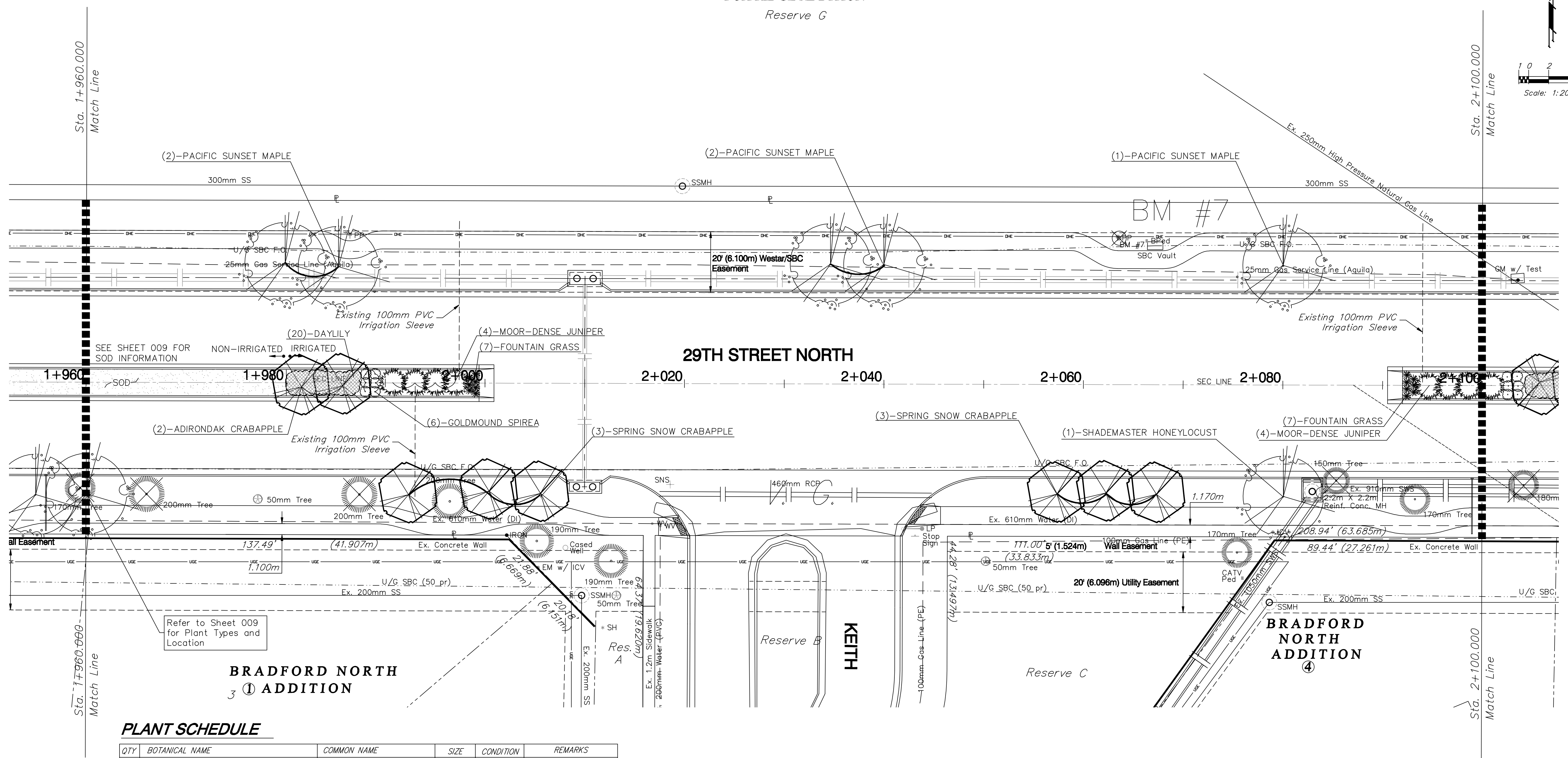
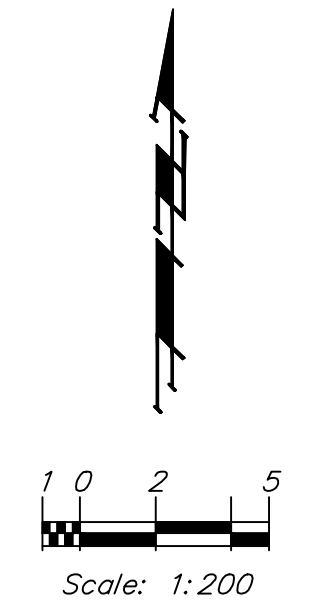

**BRADFORD NORTH  
 3 ① ADDITION**

**PLANT SCHEDULE**

QTY	BOTANICAL NAME	COMMON NAME	SIZE	CONDITION	REMARKS
5	<i>Acer truncatum</i> x <i>A. platanoides</i> 'Warrenred'	Pacific Sunset Maple	2" Cal.	B&B	Single Stem Only
1	<i>Gleditsia triacanthos</i> 'Shademaker'	Shademaker Honeylocust	2" Cal.	B&B	Single Stem Only
2	<i>Malus 'Adirondak'</i>	Adirondak Crabapple	2" Cal.	B&B	Single Stem Only
6	<i>Malus 'Spring Snow'</i>	Spring Snow Crabapple	2" Cal.	B&B	Single Stem Only
8	<i>Juniperus sabina</i> 'Monard'	Moor-Dense Juniper	2-Gal.	Container	Full & Healthy
6	<i>Spirea japonica</i> 'Goldmound'	Goldmound Spirea	2-Gal.	Container	Full & Healthy
20	<i>Hemerocallis 'Stella de Oro'</i>	Stella De Oro Daylily	1-Gal.	Container	Full & Healthy
14	<i>Pennisetum alopecuroides</i> 'Hamel'	Dwf. Hameln Fountain Grass	1-Gal.	Container	Full & Healthy

PROJECT NUMBER <b>472-83863a</b>		SHEET NAME LS10		ENGINEERING DIRECTORY E:\29th - Tyler to Maize Lscape\		CAPITAL IMPROVEMENT PROJECT 29TH STREET NORTH PAVING Sta. 1+950.000 to Sta. 2+100.000		<b>BAUGHMAN COMPANY, P.C.</b> ENGINEERING, SURVEYING, & PLANNING 316-282-7271 • 315 ELLIS • WICHITA, KANSAS 67211	SHEET A.10 OF 18
DESIGN NLS	DRAWN NLS	APPROVED BDT	DATE April 07	SCALE Noted	BAUGHMAN NO 02-02-E232		29TH STREET NORTH - MAIZE ROAD TO TYLER ROAD		