

1988 SANITARY SEWER RECONSTRUCTION PROGRAM (PHASE 2)

PROJ. NO. 468-81886 INDEX NO. 600817

CITY OF WICHITA, KANSAS

M. E. LINDEBAK, CITY ENGINEER

GENERAL NOTES

1. ALL CONSTRUCTION AND MATERIALS TO COMPLY WITH CITY OF WICHITA SPECIFICATIONS AND STANDARDS.
2. AT LEAST 48 HOURS PRIOR TO BEGINNING EXCAVATION, IF REQUIRED, (EXCLUDING WEEKENDS AND HOLIDAYS), THE CONTRACTOR SHALL CONTACT THE KANSAS ONE-CALL SYSTEM, A UTILITY LOCATION SERVICE, AT (316) 697-2479 TO REQUEST THE FOLLOWING UTILITY COMPANIES TO LOCATE ANY EXISTING LINES WITHIN THE PROJECT AREA: GAS SERVICE COMPANY, K.G. & E., THE WICHITA WATER DEPARTMENT, AND AIR CAPITAL CABLEVISION.
3. THE CONTRACTOR MUST ALSO NOTIFY THE TELEPHONE COMPANY AT (316) 571-2116, 48 HOURS PRIOR TO BEGINNING EXCAVATION, IF REQUIRED, AND REQUEST THAT ANY LINES WITHIN THE PROJECT AREA BE FLAGGED.
4. THE CONTRACTOR SHALL RESTORE ALL DITCHES, SHALES, ROAD SHOULDERS, ENTRANCES, AND MARK LINES TO THEIR ORIGINAL SLOPES AND GRADES EXCEPT AS SHOWN OTHERWISE.
5. THE CONTRACTOR SHALL BE RESPONSIBLE FOR PRESERVING PROPERTY IRONS. THE CONTRACTOR SHALL BE REQUIRED TO RE-ESTABLISH ANY PROPERTY IRONS WHICH ARE DAMAGED OR DESTROYED BY HIS CONSTRUCTION OPERATIONS. SUCH IRONS SHALL BE RE-ESTABLISHED BY A LICENSED LAND SURVEYOR OR A LICENSED PROFESSIONAL ENGINEER IN ACCORDANCE WITH STATE LAWS. ALL COSTS FOR THIS WORK SHALL BE SUBSIDIARY TO THE OTHER ITEMS OF WORK.
6. CONTRACTOR WILL BE REQUIRED TO GIVE ALL PROPERTY OWNERS AND/OR TENANTS DIRECTLY AFFECTED BY THE CONSTRUCTION OF THIS PROJECT A MINIMUM ADVANCE NOTICE OF SEVEN DAYS PRIOR TO STARTING CONSTRUCTION. THE CONTRACTOR SHALL AGAIN NOTIFY RESIDENTS IMMEDIATELY PRIOR TO BEGINNING WORK, THAT SEWER SERVICE WILL BE DISRUPTED.
7. TREES OR SHRUBS LOCATED WITHIN THE UTILITY EASEMENT SHALL NOT BE REMOVED WITHOUT PRIOR APPROVAL BY THE ENGINEER. TREES OR SHRUBS OUTSIDE OF THE UTILITY EASEMENT SHALL NOT BE REMOVED.
8. NO BUILDING SERVICE CONNECTION SHALL BE WITHOUT SANITARY SEWER SERVICE FOR MORE THAN 24 HOURS. ANY SERVICE LINE NOT IN A CONDITION WHICH WOULD PERMIT RECONNECTING SHALL BE REPLACED AT NO EXTRA COST TO THE CONTRACTOR.
9. ONLY ACTIVE BUILDING SEWER LINES WHICH CONNECT ACTUAL BUILDINGS TO THE SEWER SYSTEM ARE TO BE RECONNECTED TO THE NEW SEWER CONSTRUCTION. BUILDING SEWER LINES AND/OR CONNECTIONS WHICH HAVE BEEN ABANDONED ARE NOT TO BE RECONNECTED TO THE NEW SEWER CONSTRUCTION. IT WILL BE THE SOLE RESPONSIBILITY OF THE CONTRACTOR TO ASCERTAIN WHICH BUILDING SEWER LINES AND/OR CONNECTIONS ARE ACTIVE AND WHICH SEWERS AND/OR CONNECTIONS HAVE BEEN ABANDONED. ALL WORK INVOLVED WITH BUILDING SEWER LINE CONSTRUCTION AND/OR BUILDING SEWER CONNECTIONS SHALL CONFORM TO THE APPLICABLE SECTION OF THE STANDARD SPECIFICATIONS.
10. THE CONTRACTOR SHALL BE RESPONSIBLE FOR MAINTAINING CONTINUOUS FLOW OF SEWAGE THROUGH CONSTRUCTION. CONTRACTOR'S PROPOSED METHOD FOR MAINTAINING SEWAGE FLOW SHALL BE APPROVED BY THE ENGINEER. COST OF MAINTAINING FLOW OF SEWAGE THROUGH CONSTRUCTION WILL NOT BE PAID FOR DIRECTLY AND THIS COST SHALL BE CONSIDERED AS SUBSIDIARY TO THE OTHER PAY ITEMS OF WORK.
11. ANY FENCE REMOVED FOR CONSTRUCTION SHALL BE REPAIRED IN A CONDITION EQUAL TO, OR BETTER THAN ORIGINAL, AT NO ADDITIONAL COST TO THE OWNER.
12. THE CONTRACTOR SHALL BE RESPONSIBLE FOR THE ACQUISITION OF ANY ADDITIONAL RIGHTS-OF-WAY OR EASEMENTS NECESSARY TO COMPLETE THE WORK.
13. THE CONTRACTOR SHALL PROVIDE PROPER SIGNING AND BARRICADE TO ROUTE TRAFFIC EITHER THROUGH OR AROUND CONSTRUCTION AS OUTLINED IN THE SPECIFICATIONS. TRAFFIC ROUTING SHALL BE APPROVED BY THE ENGINEER.
14. FREQUENTLY PLANS, SPECIFICATIONS, AND/OR SPECIAL PROVISIONS WILL IDENTIFY SPECIFIC ITEMS OF WORK TO BE COMPLETED BY THE CONTRACTOR FOR WHICH THE PROPOSAL DOES NOT INCLUDE A PAY ITEM. IT SHALL BE PERCEIVED IN THESE CASES THAT SUCH WORK WILL BE COMPLETED BY THE CONTRACTOR AND ALL COSTS FOR SUCH WORK SHALL BE CONSIDERED AS SUBSIDIARY TO THE OTHER PAY ITEMS OF WORK IN THE PROPOSAL. NO CLAIM FROM THE CONTRACTOR WILL BE ALLOWED FOR PAYMENT OF SUCH WORK AS EXTRA WORK.

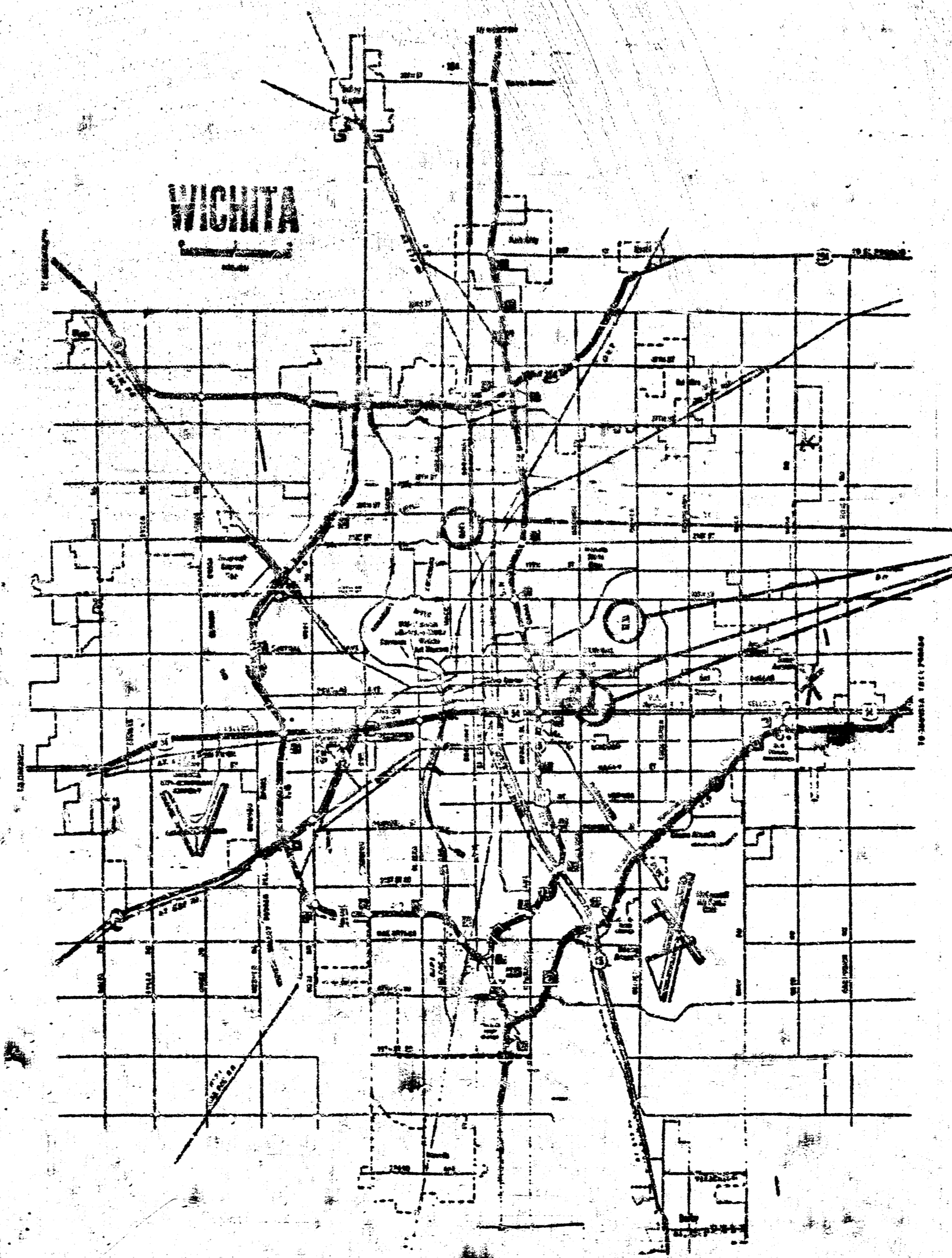

PROJECT SITES

*Build Per Plan
RDC
5290*

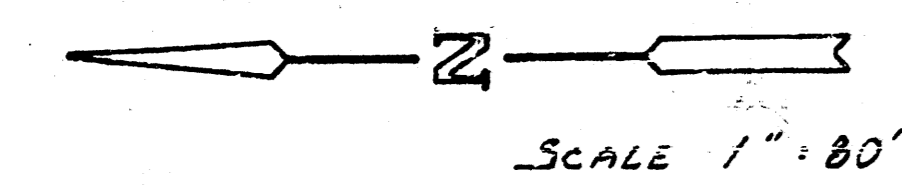

NOTE: CONTRACTOR MUST RECONSTRUCT THIS SEWER LINE FIRST.

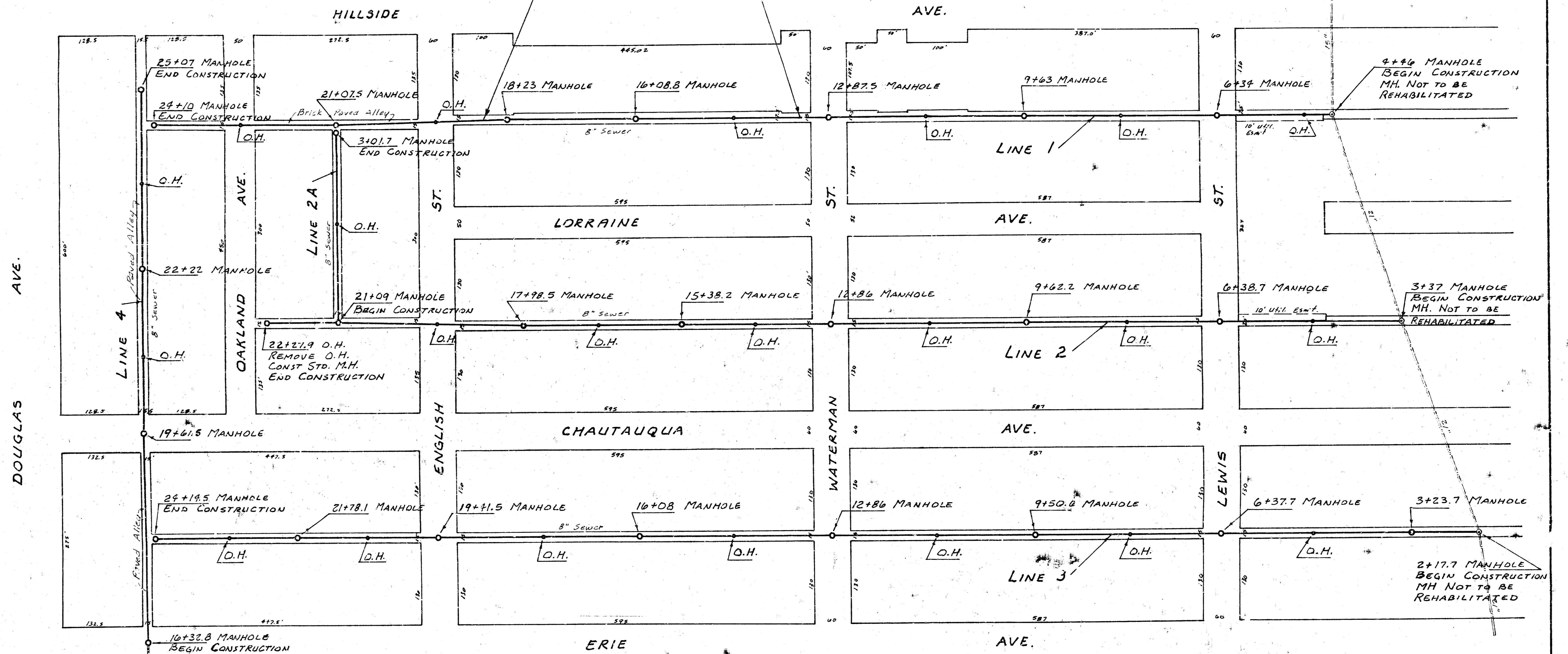

NOTE: SEWERS ON THIS SHEET ARE FROM 5 TO 11 FEET DEEP.

NOTE: All Observation Holes shall be Removed or Abandoned.

NOTE: All Manholes are to be Rehabilitated unless otherwise noted

PROJECT DESCRIPTION
1988 SANITARY SEWER RECONSTRUCTION
 PROGRAM (PHASE 2)
 PROJECT NUMBER
PROJ. NO. 488-81886 INDEX NO. 509317

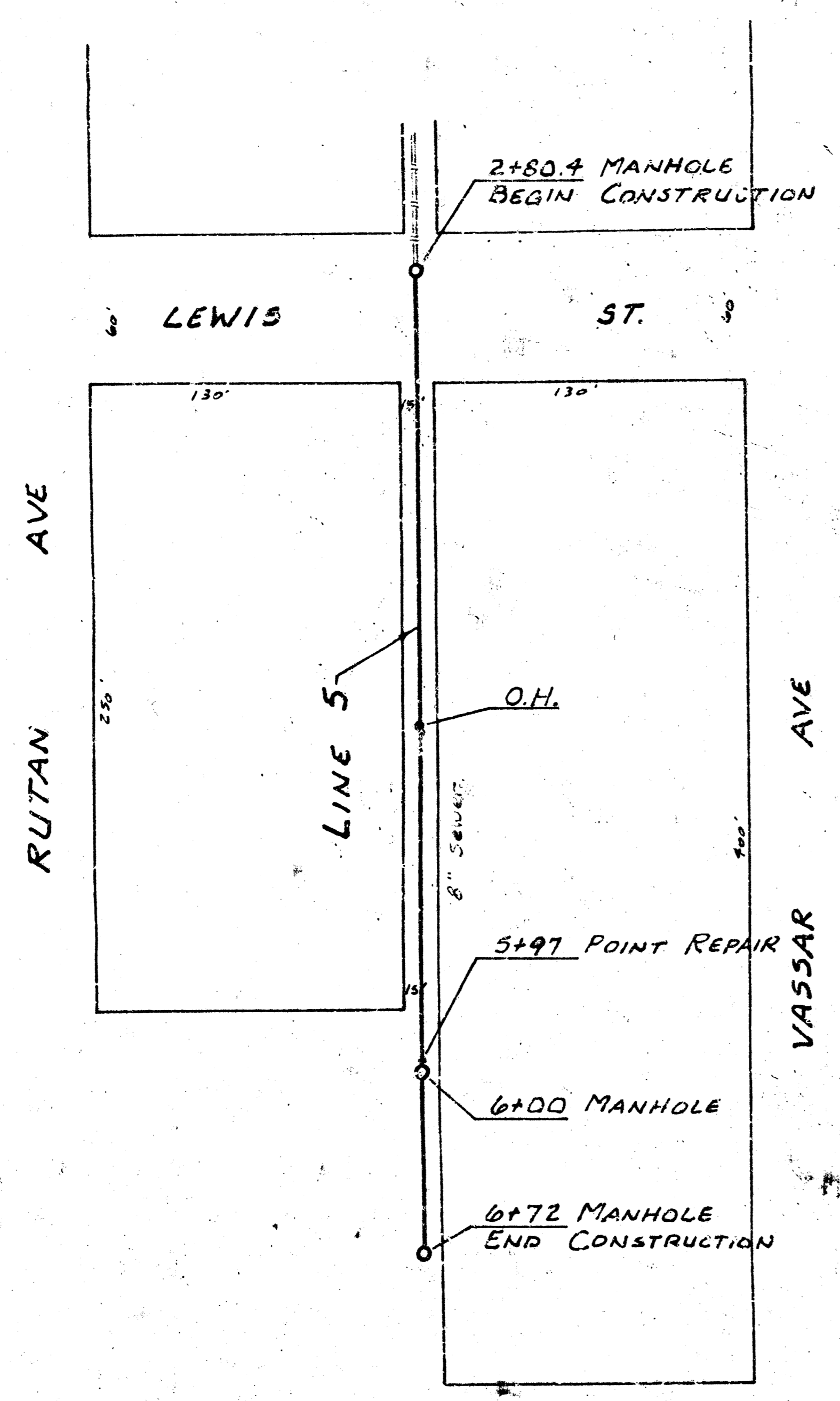
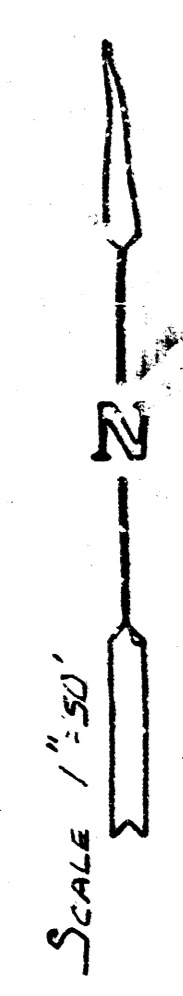

NOTE: SEWER IS FROM 7 FT. TO 11 FT. DEEP

NOTE: All Manholes are to be Rehabilitated unless otherwise noted.

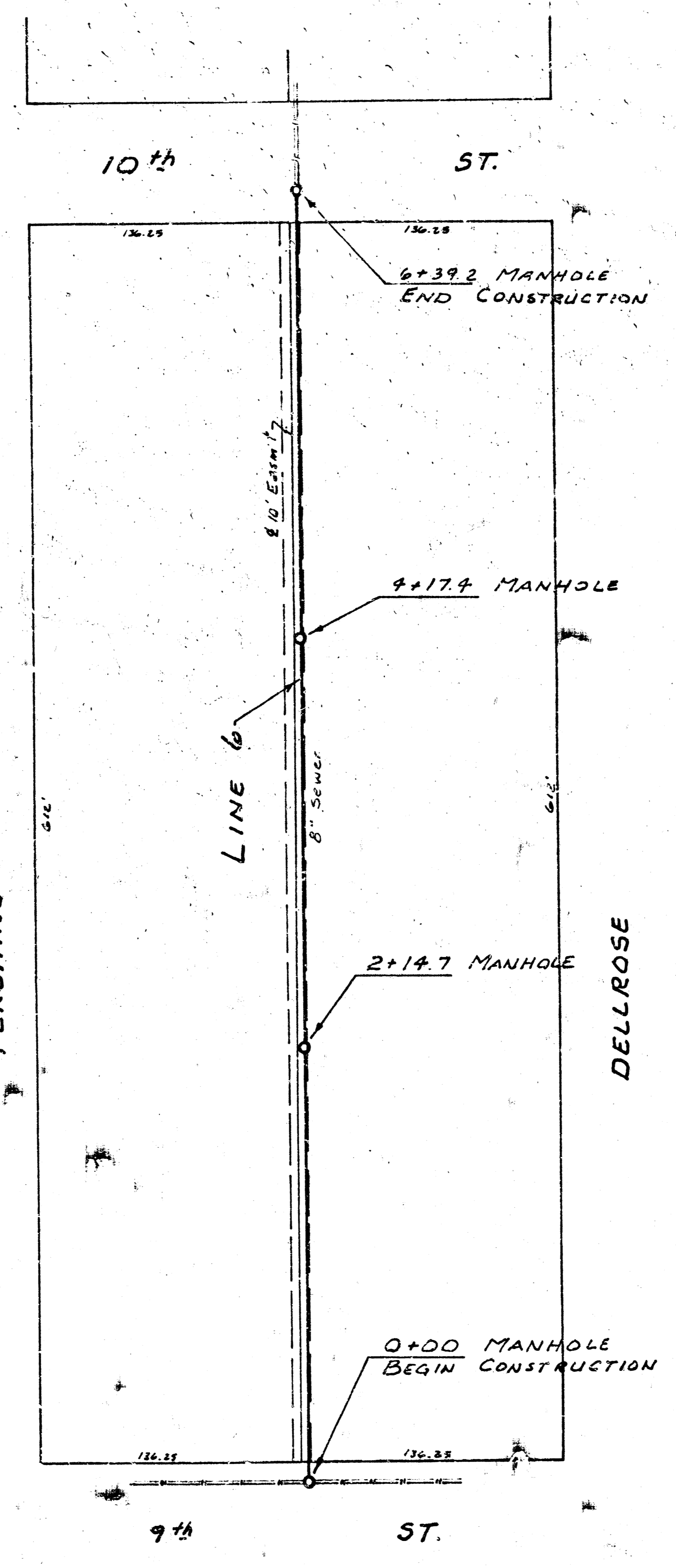

NOTE: SEWER IS 10 FT. TO 12 FT. DEEP

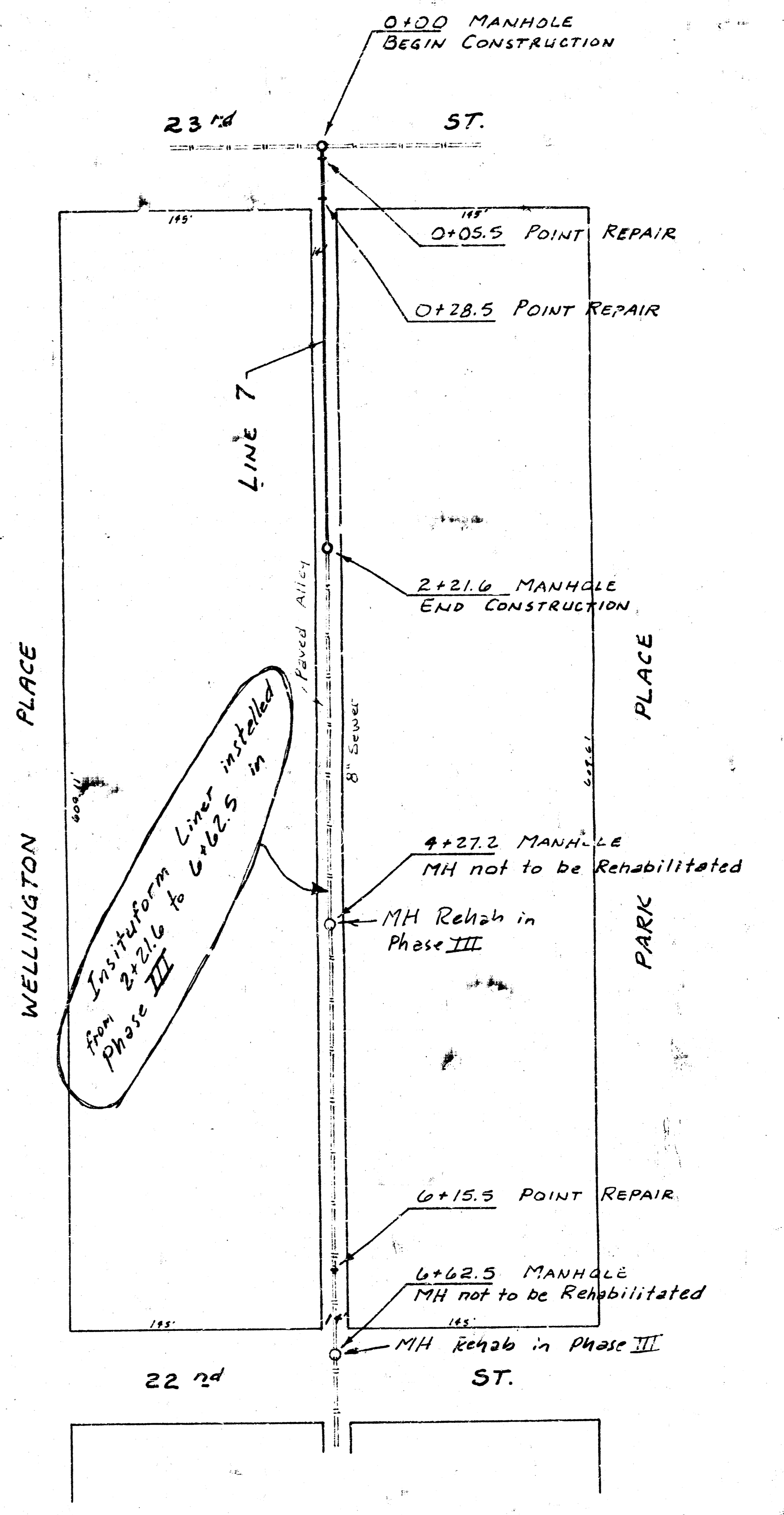

NOTE: SEWER IS 7 FT TO 10 FT. DEEP

PROJECT DESCRIPTION
1988 SANITARY SEWER RECONSTRUCTION
 PROGRAM (PHASE 2)
 PROJECT NUMBER
 PROJ. NO. 488-91886 INDEX NO. 600017

10 5 1 2