

SCALE PLAN 1"=50'
PROFILE 1"=50' HORIZ.
1"=5' VERT.

NOTE: CONTRACTOR TO MAINTAIN MINIMUM OF TWO-WAY ONE LANE TRAFFIC ON MAPLE AND HYDRAULIC.

NOTE: ARKLA GAS LINE - 2" IN E PARKING HYDRAULIC - 1 1/2" PLASTIC GOING E. IN ALLEY - CHANGES TO 4" STEEL AND TERMINATES AT W.L. KANSAS.

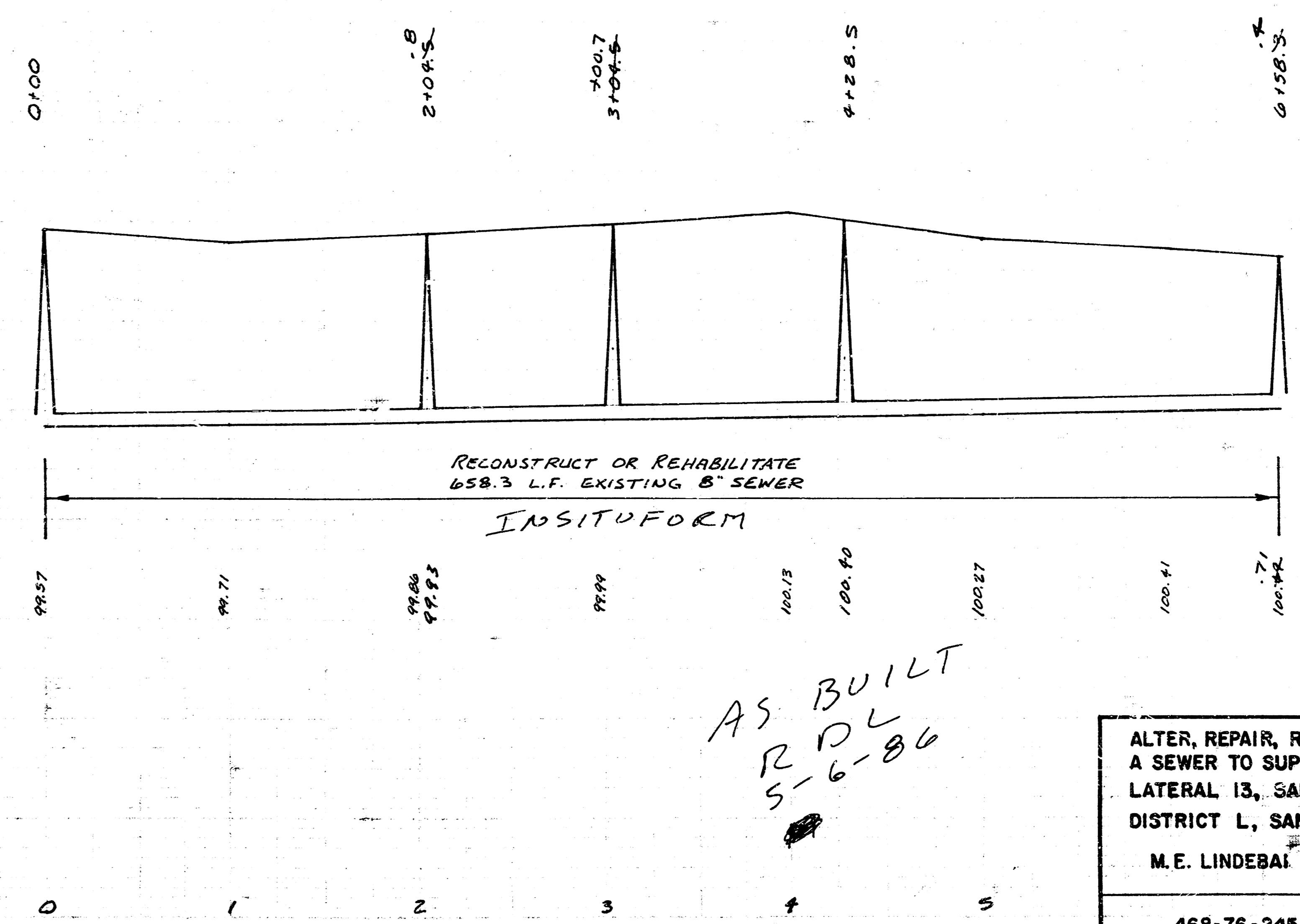
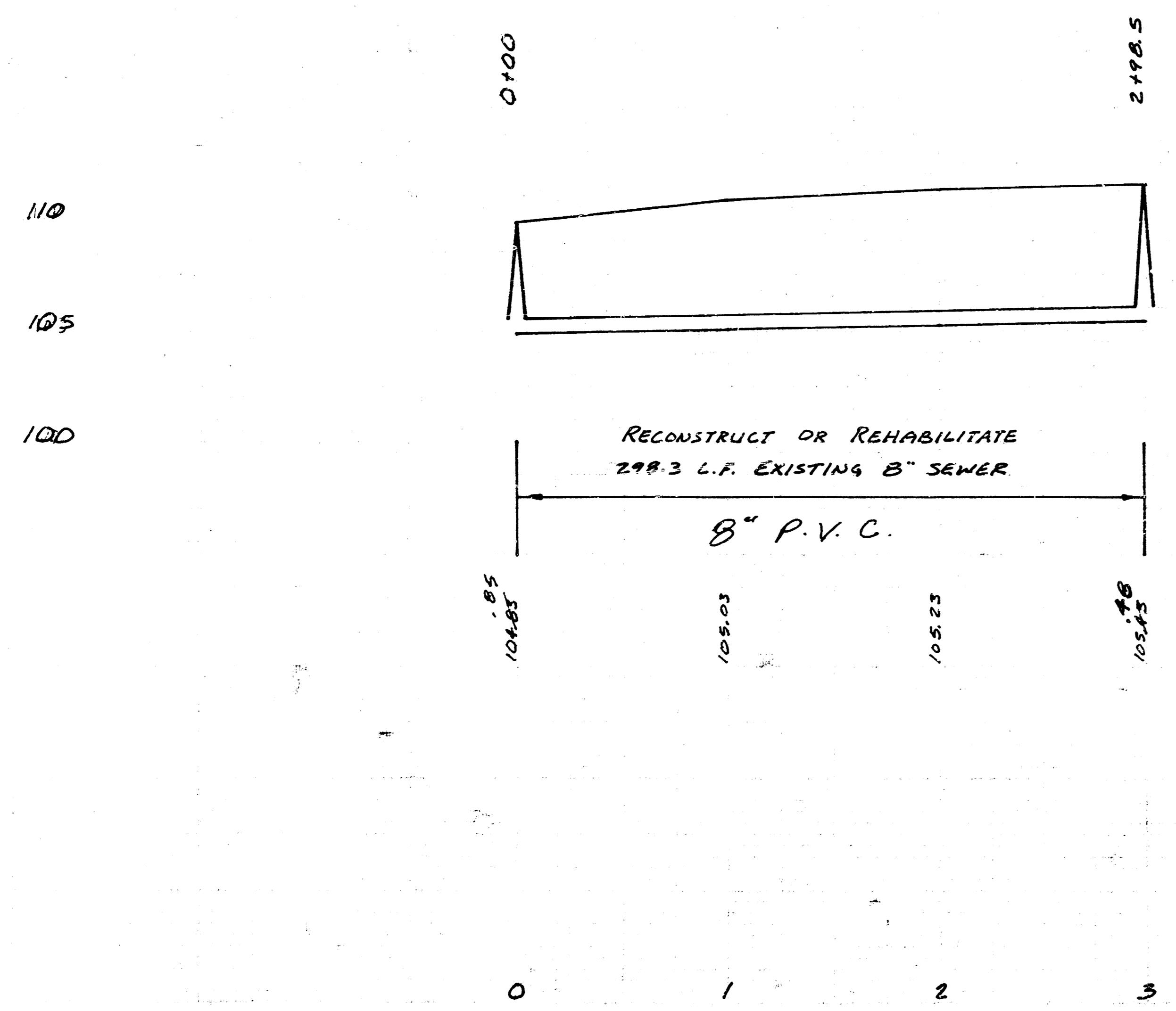

AS BUILT
R.D.L.
5-6-86

ALTER, REPAIR, RECONSTRUCT OR CONSTRUCT A SEWER TO SUPPLEMENT A PORTION OF LATERAL 13, SANITARY SEWER NO. 8 DISTRICT L, SANITARY SEWER NO. 20
M.E. LINDEBAI - CITY ENGINEER
PROJECT NUMBER
468-76-245-81541-000-000-001

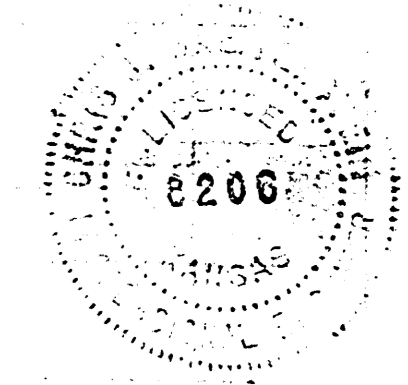

10 2 3 8 1/3

FILMED FROM THE BEST AVAILABLE COPY

FEMA REGION NO.	STATE	PROJECT NO.	FISCAL YEAR	SHEET NO.	TOTAL SHEETS
7	KANSAS		1985	2 of 3	

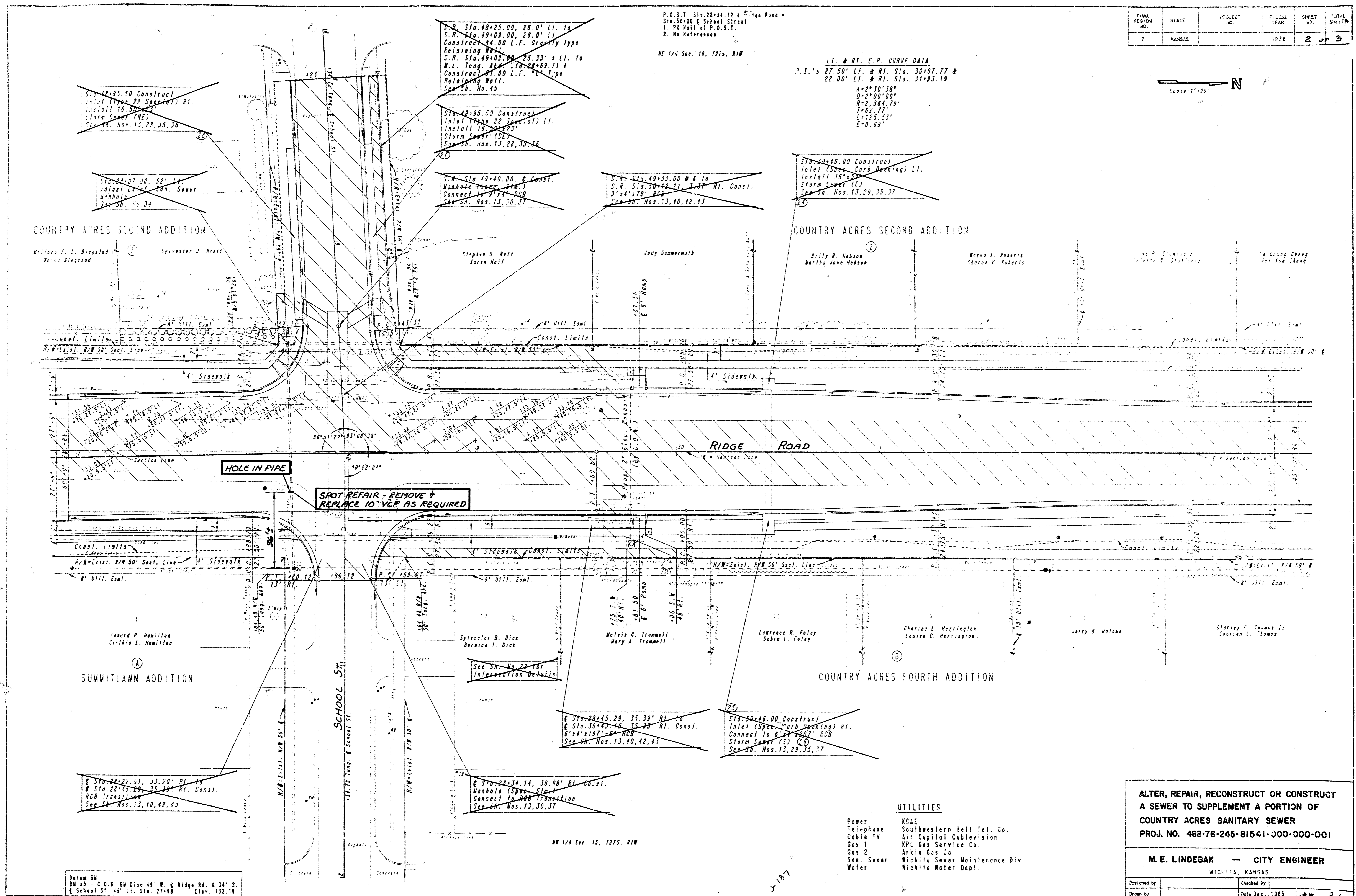

P.O.S.T. Sta. 28+34.72 @ Ridge Road +
 Sta. 59+00 @ School Street
 1. PK Nail at P.O.S.T.
 2. No Reference

NE 1/4 Sec. 16, T27S, R1W

LT. & RT. E.P. CURVE DATA
 P.I.'s 27.50' Lt. & Rt. Sta. 30+87.77 &
 22.00' Lt. & Rt. Sta. 31+85.19
 A=2°30'38"
 D=2°00'00"
 R=2,864.79'
 T=62.77'
 L=125.53'
 E=0.69'

~~Sta. 48+95.50 Construct
 Inlet (Type 22 Special) Rt.
 Install 18" x 18" RCB
 Storm Sewer (NE)
 See Sh. Nos. 13, 29, 35, 36~~

~~Sta. 48+25.00, 26.0' Lt. to
 S.R. Sta. 49+09.00, 26.0' Lt.
 Construct 48.00 L.F. Gravity Type
 Retaining Wall.
 S.R. Sta. 49+09.00, 25.33' a Lt. to
 M.L. Tong. Add. Sta. 48+69.71 +
 Construct 41.00 L.F. Type
 Retaining Wall.
 See Sh. No. 45~~

~~Sta. 48+95.50 Construct
 Inlet (Type 22 Special) Lt.
 Install 18" x 18" RCB
 Storm Sewer (SE)
 See Sh. Nos. 13, 29, 35, 36~~

~~S.R. Sta. 49+40.00, R Const.
 Manhole (Spec. Sta.)
 Connect to 8" x 8" RCB
 See Sh. Nos. 13, 30, 37~~

~~S.R. Sta. 49+33.00 @ & to
 S.R. Sta. 50+12.11, 7.31' Rt. Const.
 9" x 4" x 79" RCB
 See Sh. Nos. 13, 40, 42, 43~~

~~Sta. 40+46.00 Construct
 Inlet (Spec. Curb Opening) Lt.
 Install 36" x 36"
 Storm Sewer (E)
 See Sh. Nos. 13, 29, 35, 37~~

~~Sta. 22+07.00, 52' Lt.
 Adjust 2" x 4" Sewer
 Manhole
 See Sh. No. 34~~

COUNTRY ACRES SECOND ADDITION

COUNTRY ACRES SECOND ADDITION

Willford S. L. Biegstad
 Sylvester J. Breit
 Stephen D. Neff
 Karen Neff
 Judy Dummermark
 Billy R. Hobson
 Marike Jane Hobson
 Marva E. Roberts
 Sharon K. Roberts
 De P. Stankovic
 Celeste S. Stankovic
 Lu-Sung Cheng
 Wei Yoo Cheng

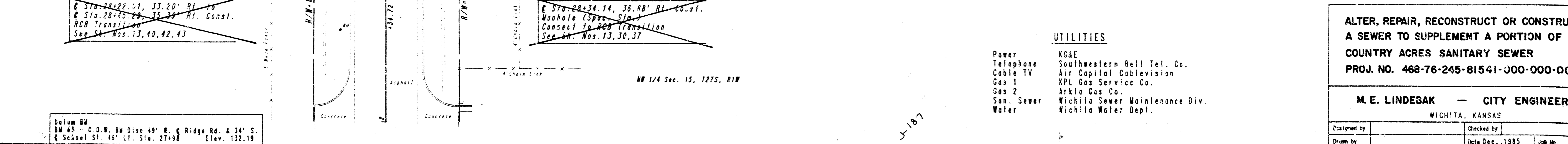
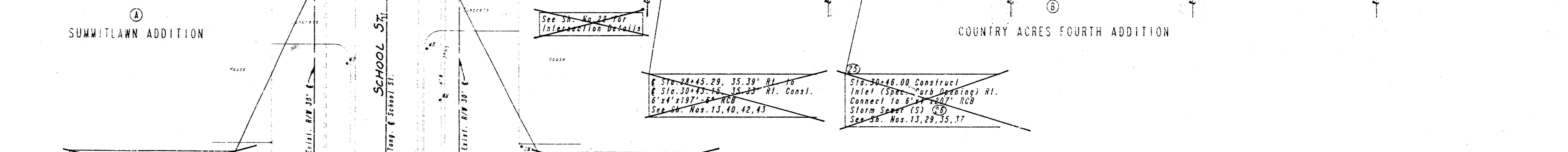
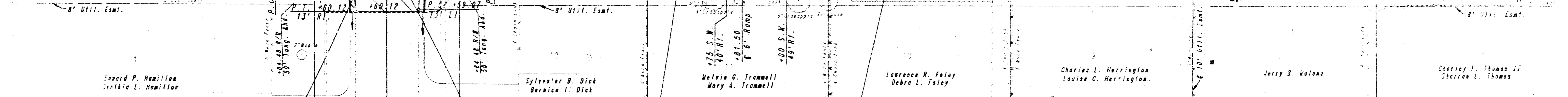
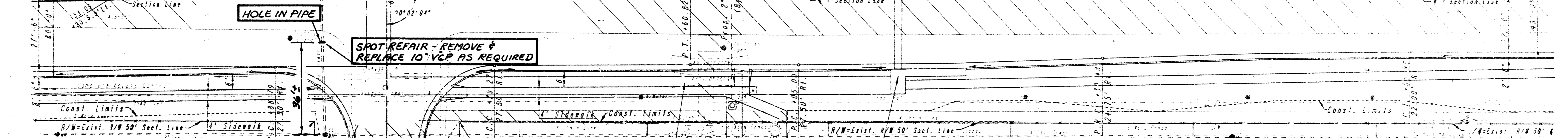
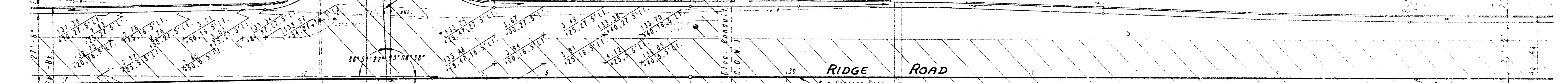
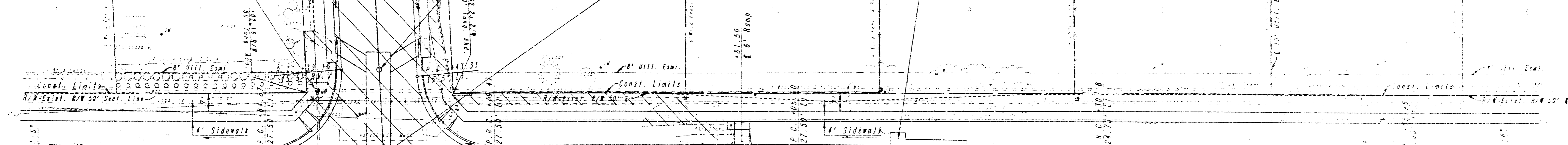

Datum BM
 BM 45 - C.O.W. BM Disc 49' W. & Ridge Rd. & 34' S.
 @ School St. 46' Lt. Sta. 27+98 Elev. 132.19

- UTILITIES**
- Power: KG&E
 - Telephone: Southwestern Bell Tel. Co.
 - Cable TV: Air Capital Cablevision
 - Gas 1: XPL Gas Service Co.
 - Gas 2: Arkla Gas Co.
 - San. Sewer: Wichita Sewer Maintenance Div.
 - Water: Wichita Water Dept.

ALTER, REPAIR, RECONSTRUCT OR CONSTRUCT
 A SEWER TO SUPPLEMENT A PORTION OF
 COUNTRY ACRES SANITARY SEWER
 PROJ. NO. 468-76-245-81541-000-0001

M. E. LINDEGAK — CITY ENGINEER
 WICHITA, KANSAS

Designed by: _____
 Drawn by: _____
 Checked by: _____
 Date Dec., 1985 Job No. 2/13

FILMED FROM THE BEST
 AVAILABLE COPY

FEMA REGION NO.	STATE	PROJECT NO.	FISCAL YEAR	SHEET NO.	TOTAL SHEETS
7	KANSAS		1988	3 of 3	3

RT E.P. CURVE DATA
P.I. 19.93' Lt. & Sta. 45+58.78
A=7°26'58"
D=2°00'00"
R=2,864.79'
T=61.23'
L=122.44'
E=0.65'

NE 1/4 Sec. 16, T27S, R1W

COUNTRY ACRES THIRD ADDITION

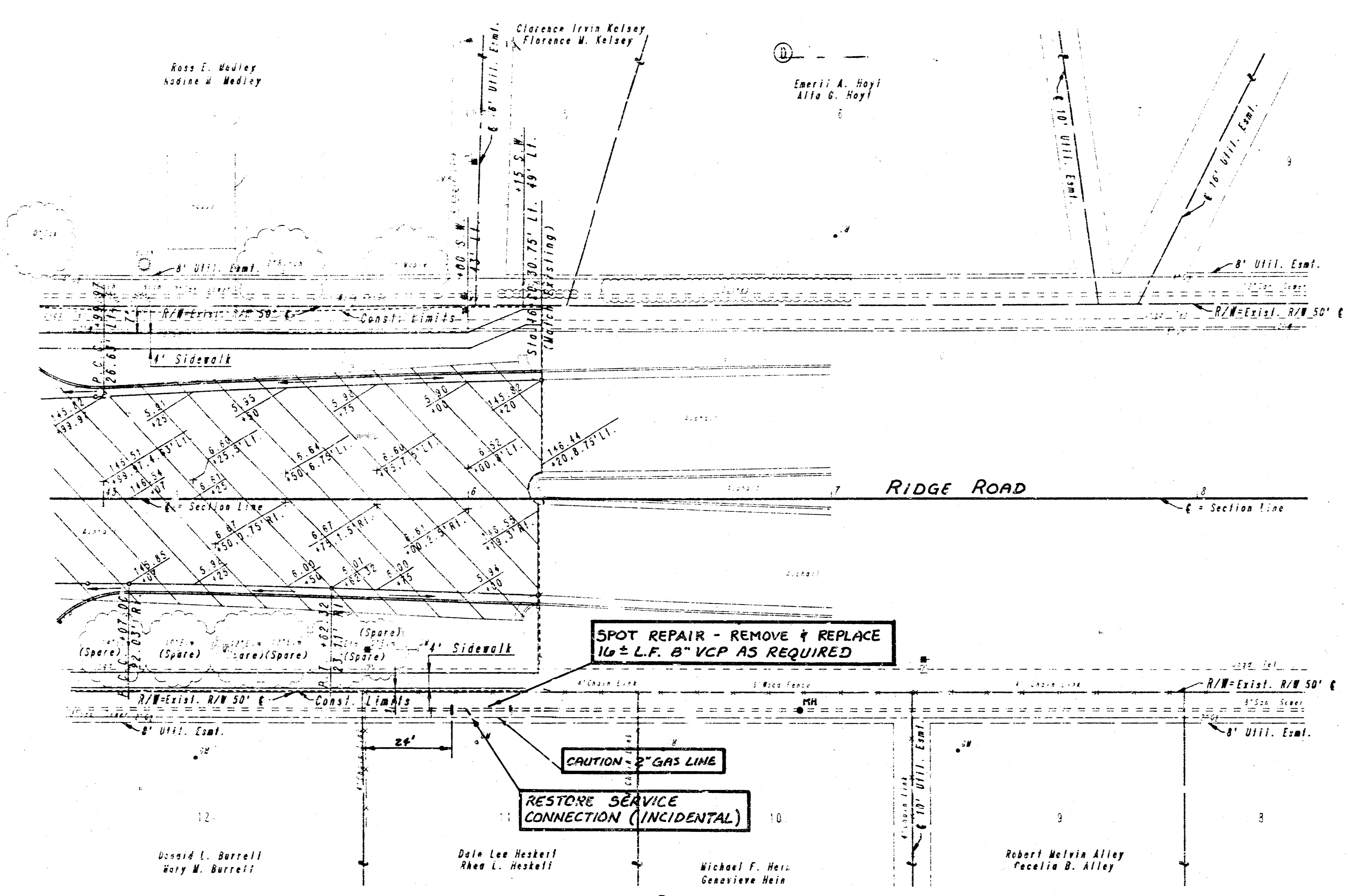
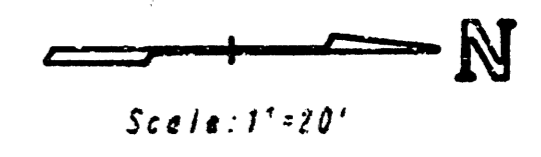

RT E.P. CURVE DATA
P.I. 22.00' Rt. & Sta. 45+29.00
A=1°54'33"
D=2°51'53"
R=2,000.00'
T=33.32'
L=66.64'
E=0.28'

NW 1/4 Sec. 15, T27S, R1W

COUNTRY ACRES FOURTH ADDITION

STA 46+20.00 END
Proj. No. 87-0-1037-01 =
Ridge Road Sta 46+40.30 on
Proj. No. 87S-SU-1374(1)

- UTILITIES**
- Power: KCAE
 - Telephone: Southwestern Bell Tel. Co.
 - Cable TV: Air Capital Cablevision
 - Gas 1: CPL Gas Service Co.
 - Gas 2: Arkla Gas Co.
 - San. Sewer: Wichita Sewer Maintenance Div.
 - Water: Wichita Water Dept.

BM 87 - Chis. "0" Back W. Median Curb of P.O. of
Back Curb. 4.5' Lt. Sta. 46+20. Elev. 147.12

ALTER, REPAIR, RECONSTRUCT OR CONSTRUCT
A SEWER TO SUPPLEMENT A PORTION OF
COUNTRY ACRES SANITARY SEWER
PROJ. NO. 488-76-245-81541-000-000-001

M.E. LINDEBAK -- CITY ENGINEER
WICHITA, KANSAS

Designed by: _____ Checked by: _____
Drawn by: _____ Date Dec. 1985

FILMED FROM THE BEST
AVAILABLE COPY