

LEGEND

PROPOSED EXISTING (TO REMAIN)

SANITARY SEWER ————

MANHOLE ○

PROJECT BOUNDARY - - - - -

**PROPOSED
SANITARY SEWERS**

CIVIC CENTER

URBAN RENEWAL AGENCY of the
WICHITA, KANSAS METROPOLITAN
AREA

PROJECT KANS. R - 19

JUNE 26, 1964
CODE R 224
SHEET 1 OF 1

200 0 200 400
SCALE IN FEET

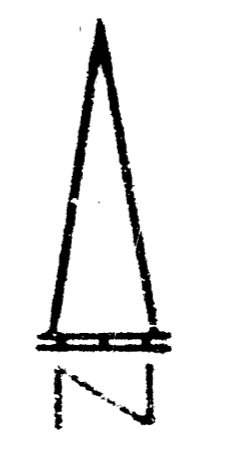

IX

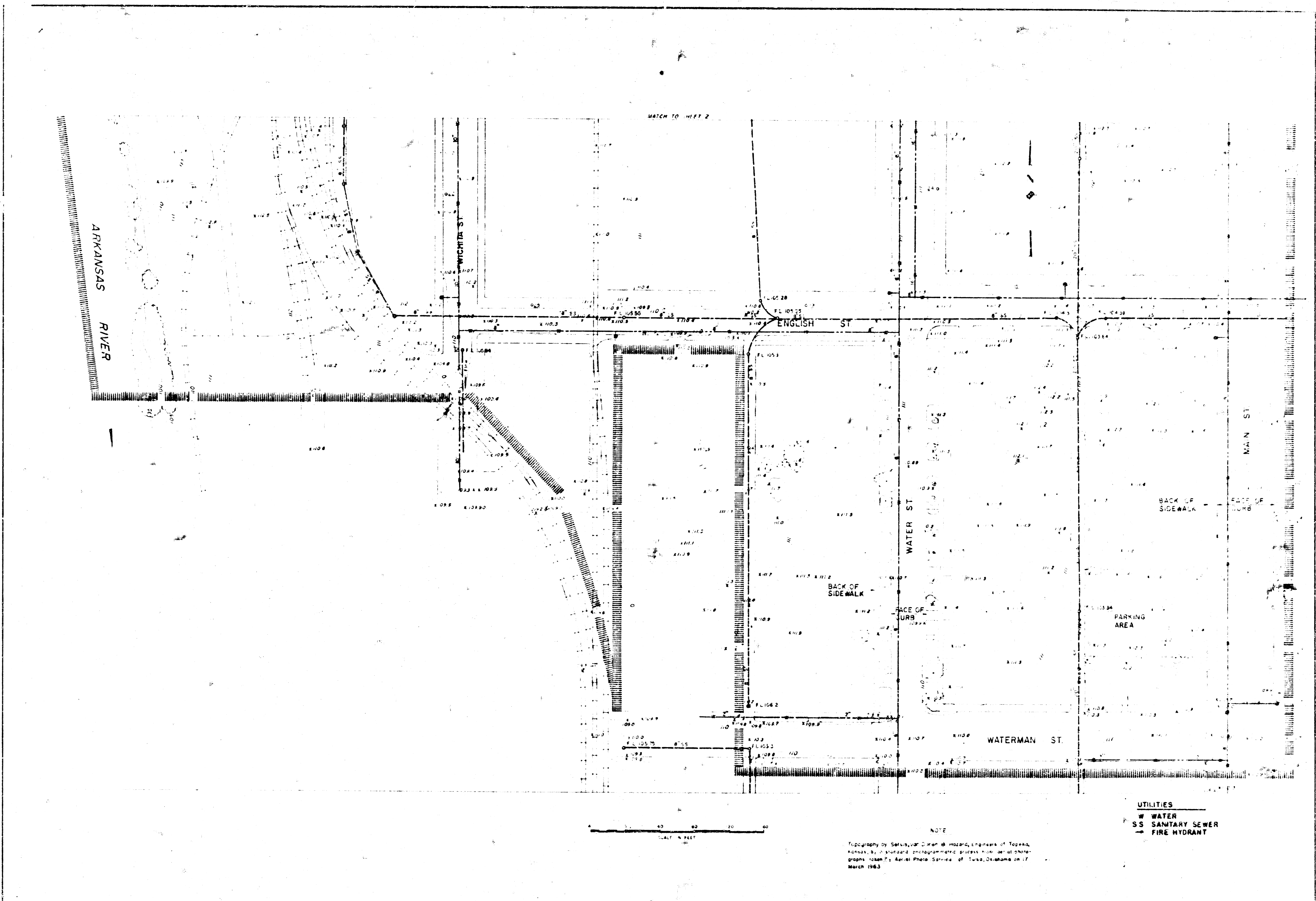

UTILITIES
 W WATER
 SS SANITARY SEWER
 FH FIRE HYDRANT

EXISTING UTILITIES
 CIVIC CENTER
 FOR THE
 URBAN RENEWAL AGENCY OF THE WICHITA, KANSAS
 METROPOLITAN AREA PROJECT KANS 1019
 K.O. TAYLOR, P.E. MAY, 1963 SHEET 3

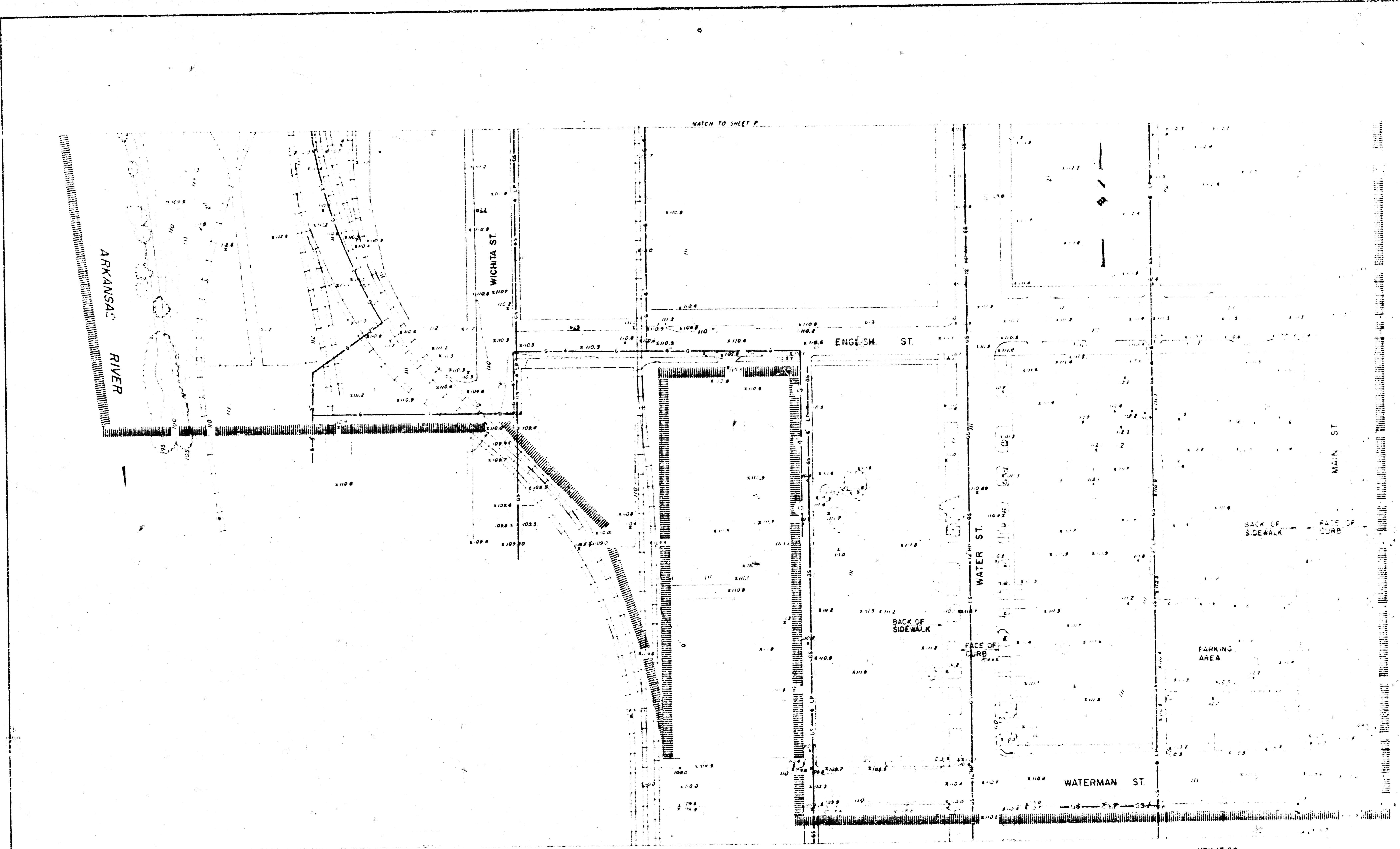

MATCH TO SHEET P

ARKANSAS RIVER

WICHITA ST.

ENGLISH ST.

WATER ST.

MAIN ST.

WATERMAN ST.

BACK OF SIDEWALK

BACK OF SIDEWALK

FACE OF CURB

PARKING AREA

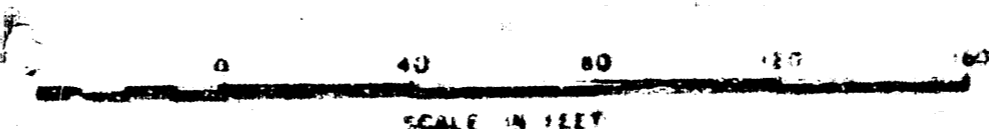

NOTE
 Topography by Servis, Van Doren & Hazard, Engineers of Topeka, Kansas, by a standard photogrammetric process from aerial photo-grams taken by Aerial Photo Service of Tulsa, Oklahoma on 17 March 1963.

NOTE
 ALL ARKLA GAS LINES SHOWN ON THIS SHEET ARE HIGH PRESSURE

UTILITIES
 GAS LINES
 GS = GAS SERVICE COMPANY
 G = ARKLA GAS COMPANY

EXISTING UTILITIES
CIVIC CENTER
 FOR THE
 URBAN RENEWAL AGENCY OF THE WICHITA, KANSAS
 METROPOLITAN AREA PROJECT KANS II-19
 K.O. TAYLOR, P.E. MAY, 1963 SHEET 3

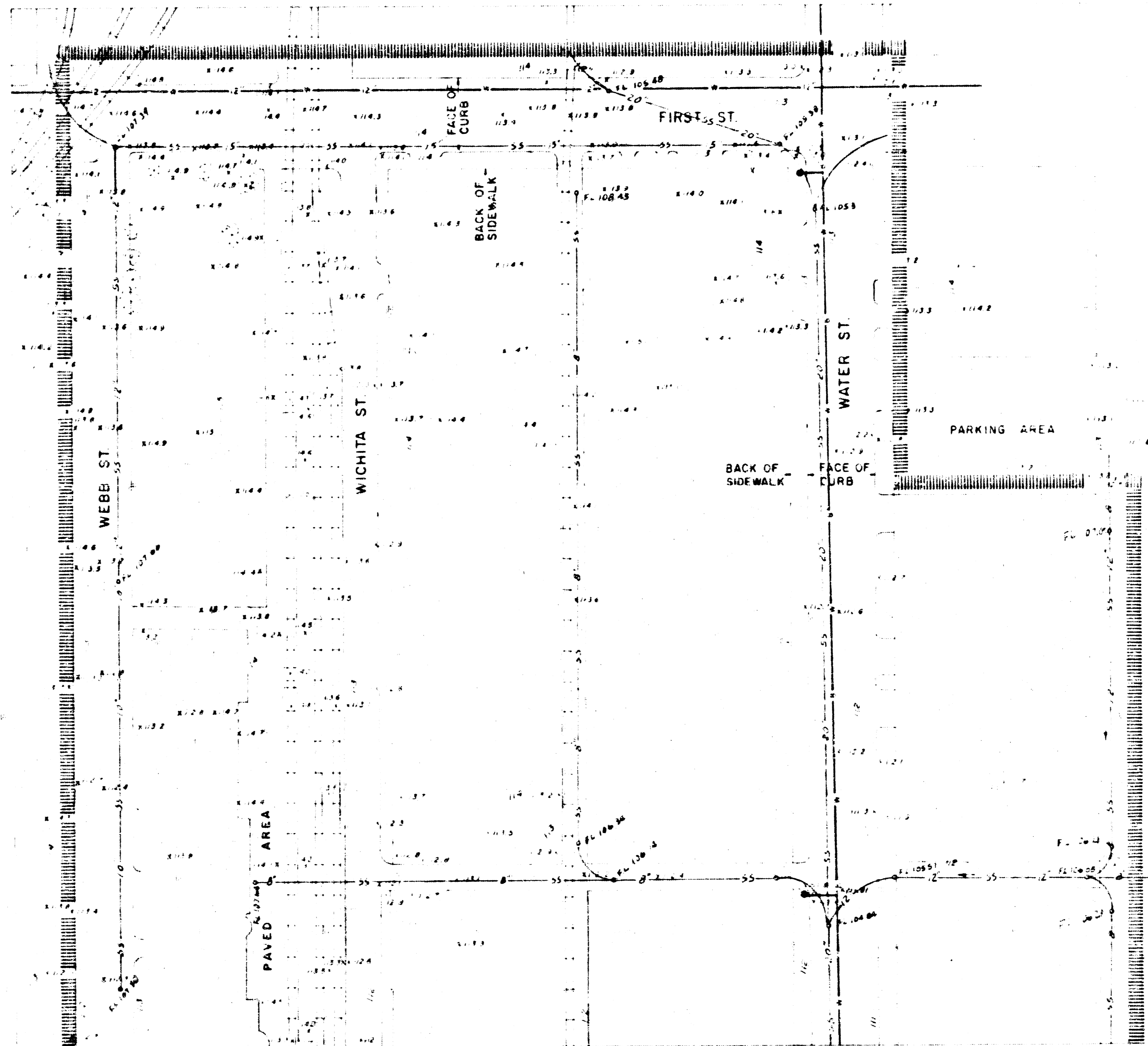

WATCH TO SHEET 2

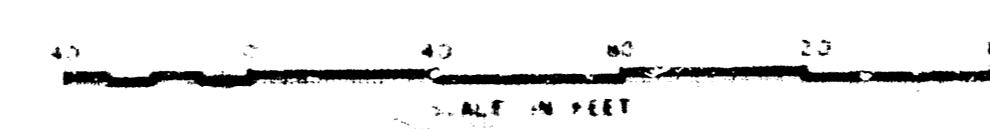

UTILITIES
 SS SANITARY SEWER
 W WATER
 → FIRE HYDRANT

NOTE:
 Topography by Gerrit van Doren & Howard, Engineers of Topeka, Kansas, by a standard photogrammetric process from aerial photographs taken by State Photo Service of Topeka, Oklahoma on 17 March 1963.

**EXISTING UTILITIES
 CIVIC CENTER**
 FOR THE
 URBAN RENEWAL AGENCY OF THE WICHITA, KANSAS
 METROPOLITAN AREA PROJECT KANS R-19
 K.O. TAYLOR, P.E. MAY, 1963 SHEET 1

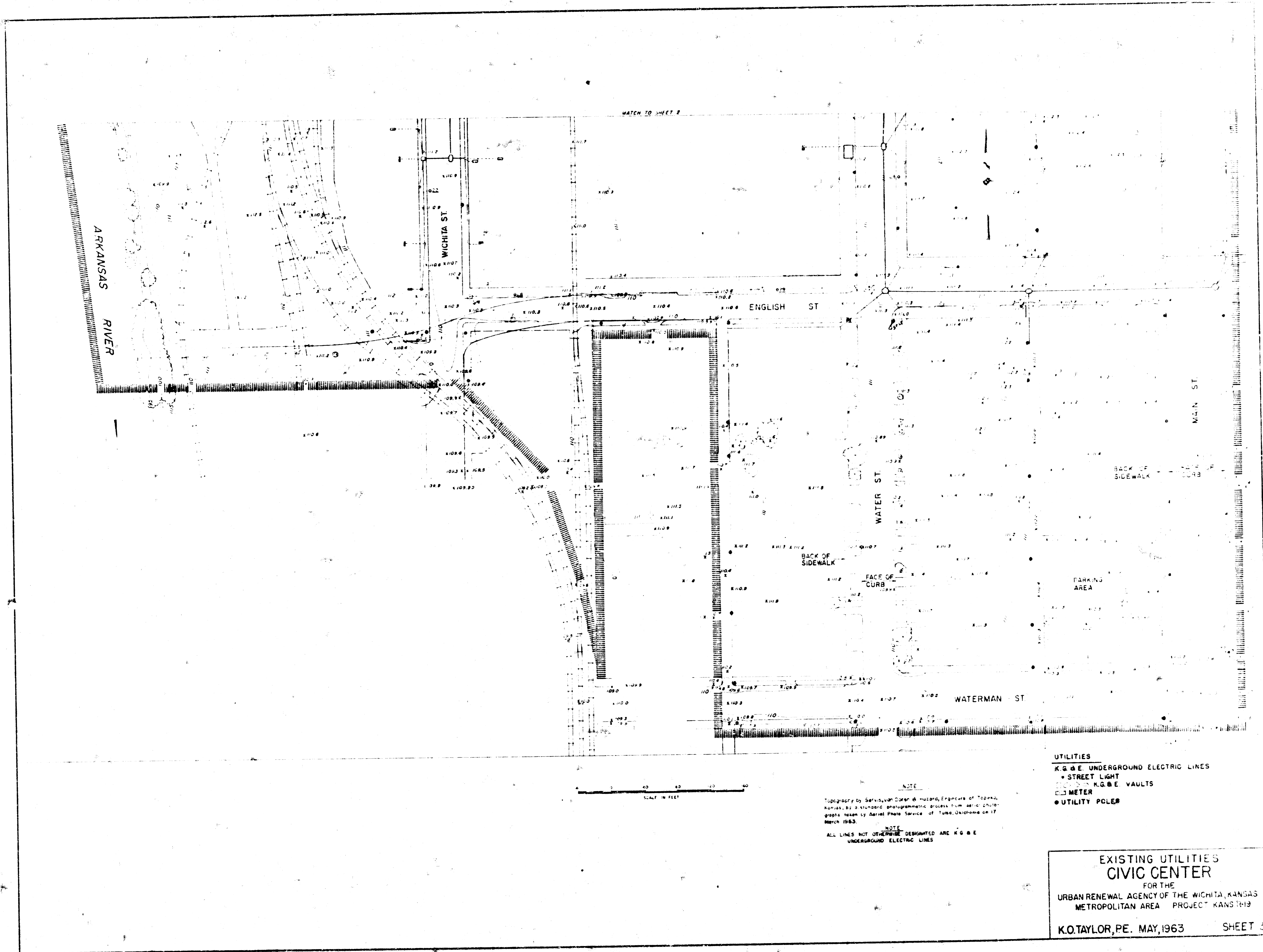

WATCH TO SHEET 2

ARKANSAS RIVER

WICHITA ST

ENGLISH ST

WATER ST

MAIN ST

WATERMAN ST

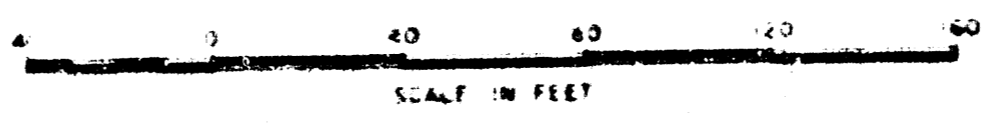

- UTILITIES
- X.G.B.E. UNDERGROUND ELECTRIC LINES
 - STREET LIGHT
 - K.G.B.E. VAULTS
 - METER
 - UTILITY POLES

NOTE
 Topography by Serviss, Van Doren & Mustard, Engineers of Topeka, Kansas, by a standard photogrammetric process from aerial photographs taken by Aerial Photo Service of Tulsa, Oklahoma on 17 March 1963.
 NOTE
 ALL LINES NOT OTHERWISE DESIGNATED ARE K.G.B.E. UNDERGROUND ELECTRIC LINES

**EXISTING UTILITIES
 CIVIC CENTER**
 FOR THE
 URBAN RENEWAL AGENCY OF THE WICHITA, KANSAS
 METROPOLITAN AREA PROJECT KANS 1119
 K.O. TAYLOR, P.E. MAY, 1963 SHEET 3

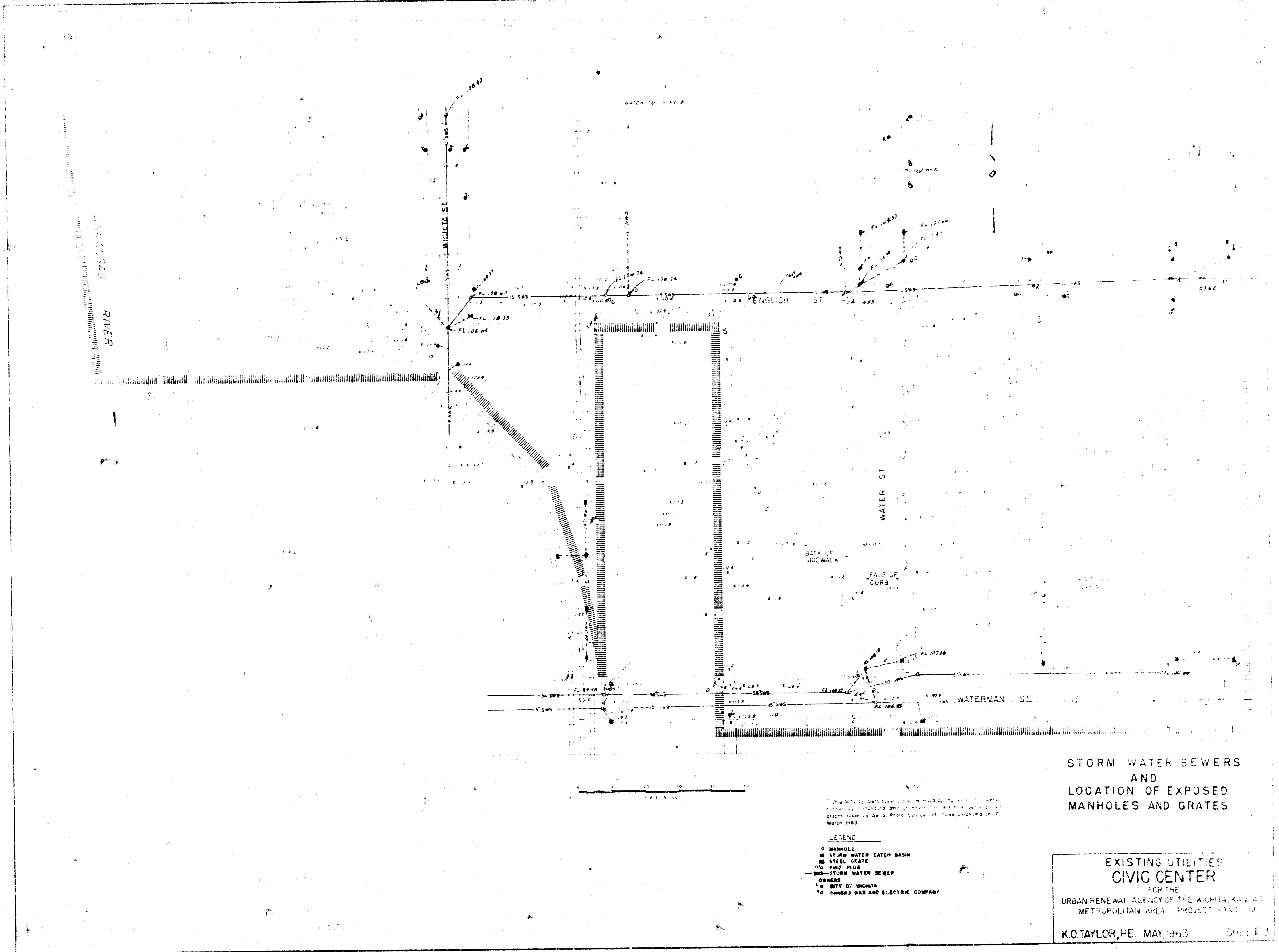

STORM WATER SEWERS
AND
LOCATION OF EXPOSED
MANHOLES AND GRATES

Original data furnished by the City of Wichita, Kansas, by a planimetric photograph of the area, taken by Aerial Photo Service of Tulsa, Oklahoma on March 1963.

- LEGEND
- MANHOLE
 - STORM WATER CATCH BASIN
 - STEEL GRATE
 - ⊕ FIRE PLUG
 - STORM WATER SEWER
 - OWNERS
 - CITY OF WICHITA
 - KANSAS GAS AND ELECTRIC COMPANY

EXISTING UTILITIES
CIVIC CENTER
FOR THE
URBAN RENOVATION AGENCY OF THE WICHITA, KANSAS
METROPOLITAN AREA - PROJECT KANS 109
K.O. TAYLOR, P.E. MAY 1963

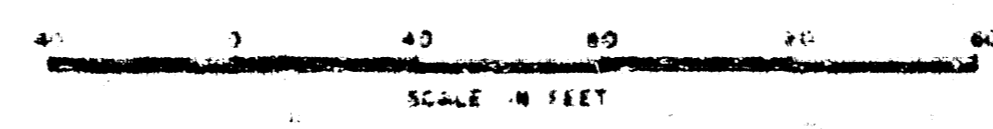
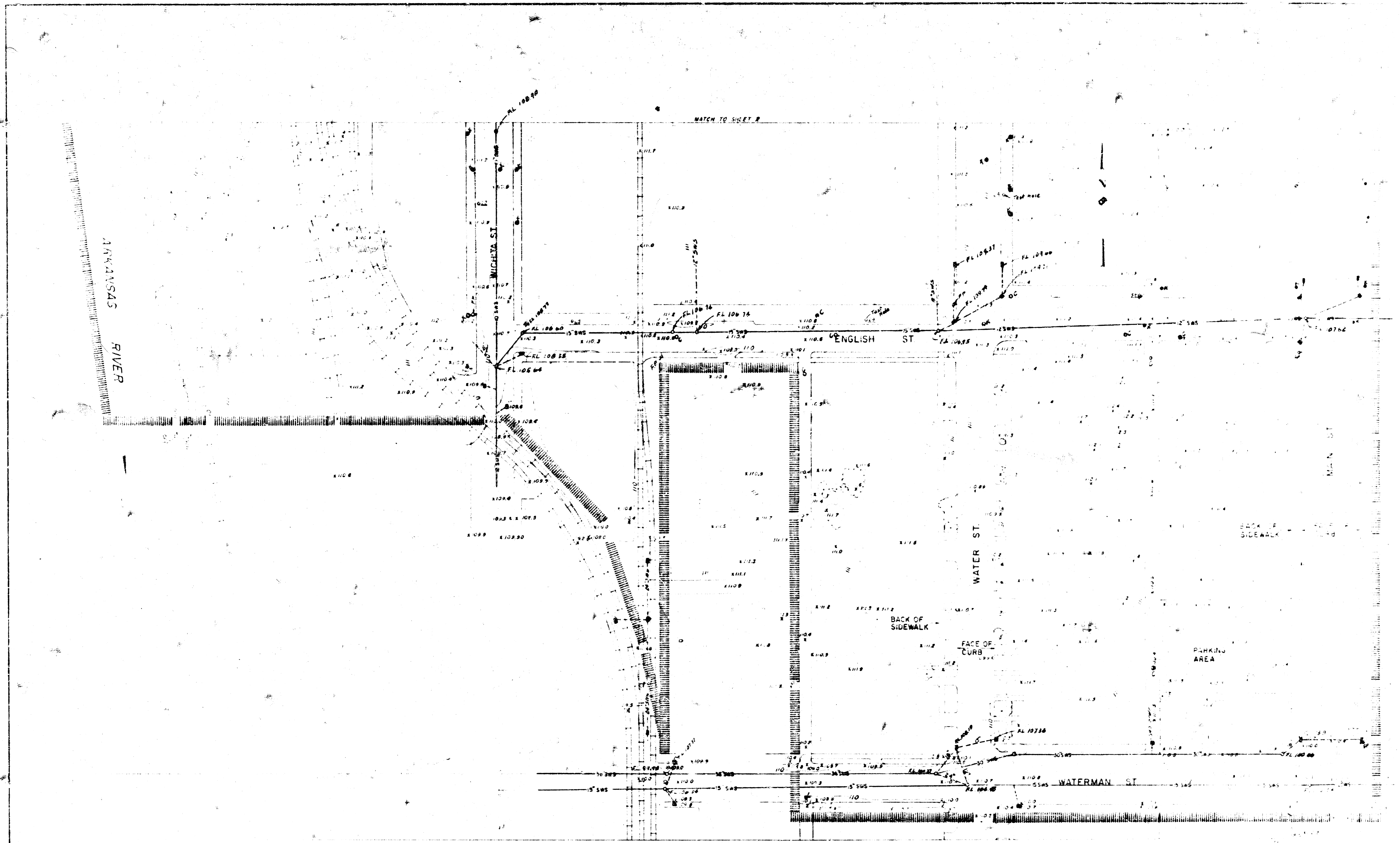

NOTE
 Topography by Serviss, Dorn & Hazard, Engineers of Topeka, Kansas, by a standard photogrammetric process from aerial photographs taken by Aerial Photo Service of Tulsa, Oklahoma on 17 March 1963.

- LEGEND
- MANHOLE
 - STORM WATER CATCH BASIN
 - ▣ STEEL GRATE
 - FIRE PLUG
 - STORM WATER SEWER
 - OWNERS
 - CITY OF WICHITA
 - KANSAS GAS AND ELECTRIC COMPANY

STORM WATER SEWERS
 AND
 LOCATION OF EXPOSED
 MANHOLES AND GRATES

EXIST'
 CI'
 URBAN RENEWAL
 METROPOLITAN
 K.O. TAYLOR, P.E. 1