

B. M. 113.58 SE cor. conc. base R. R. Signal light  
N. W. cor. Central and Wichita.

**NOTE TO CONTRACTOR:**

Contractor is to give the Mr. Pac. & Texas Pac. R. R. Co. an advanced notification of 48 hours prior to beginning construction near R. R. Tracks in Wichita, Kan.

**NOTIFY:** The Roadmaster  
Mo. Pacific and Texas Pacific R. R. Co.  
1410 East 25th St. No.  
Ph. No. 838-8911

Casing pipe to be installed by boring methods using equipment that encases the hole as the earth is removed. Boring without concurrent installation of casing will not be permitted. Sewer to be accurately positioned to flow elevation in casing using creosoted wood skids. Casing pipe to be completely filled with specified sand mix concrete after installation of 8" cast iron sewer pipe.

Bid price of tunnel shall include the steel pipe, pressure grout, skids and straps.

Concrete collar constructed on storm sewer will not be paid for directly and shall be considered as subsidiary to other items of work.

**NOTE TO CONTRACTOR AND FIELD ENGINEER:**

Contractor to excavate exist. 8" S. of Sta. 2172.0 so Field Engineer can verify Flo. Elev. prior to staking of the project.

Plan Scale 1" = 20'  
Profile Scale 1" = 5' Vert.

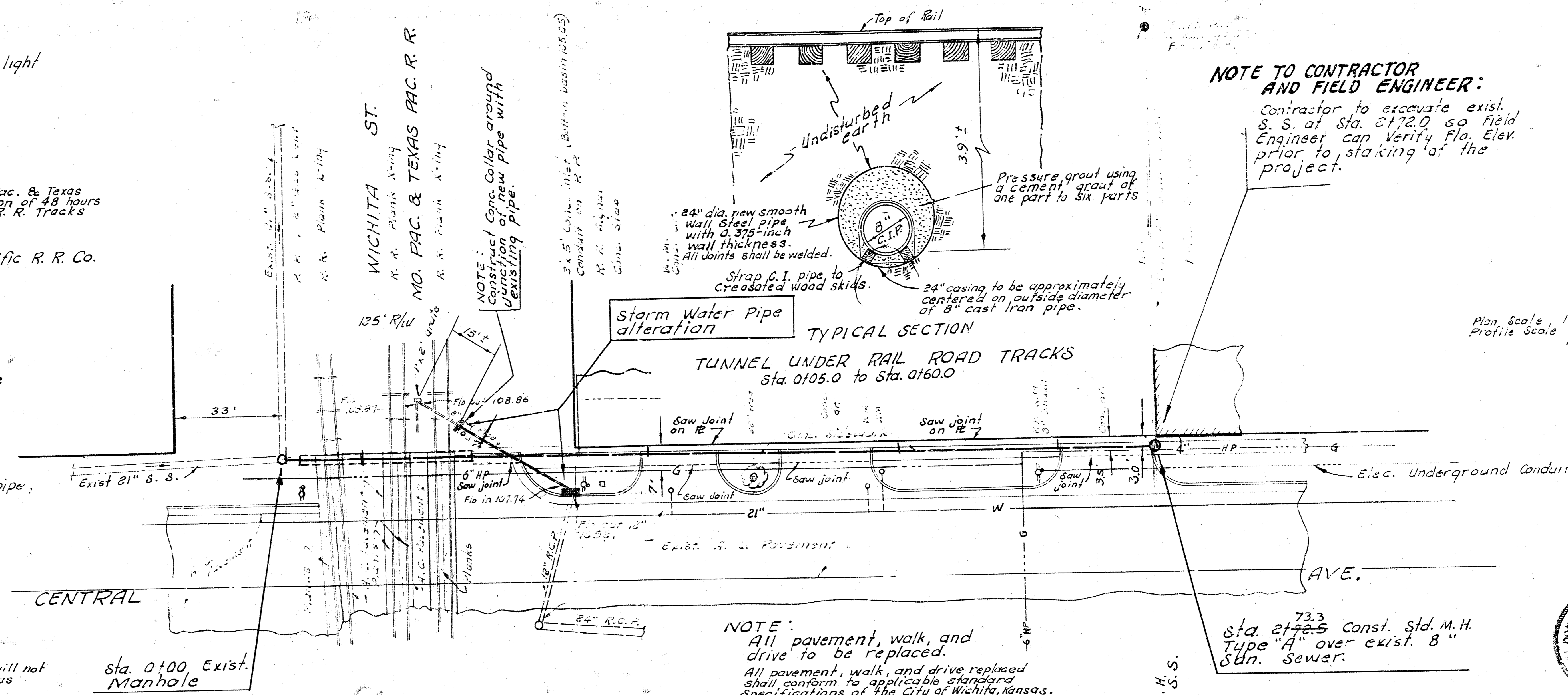

**NOTE:**  
All pavement, walk, and drive to be replaced.  
All pavement, walk, and drive replaced shall conform to applicable standard specifications of the City of Wichita, Kansas.

Sta. 2172.5 Const. Std. M.H. Type "A" over exist. 8" Sdn. Sewer.

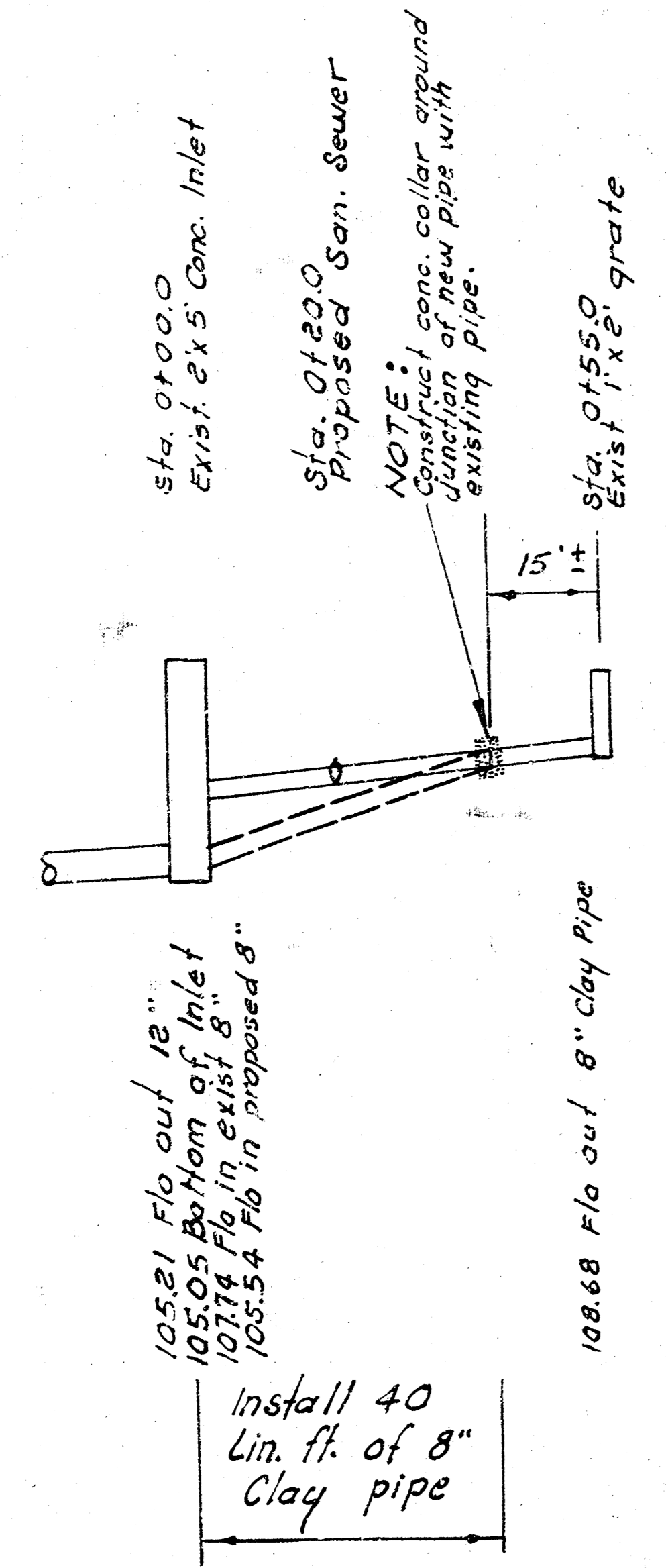

Storm Water Pipe Alteration

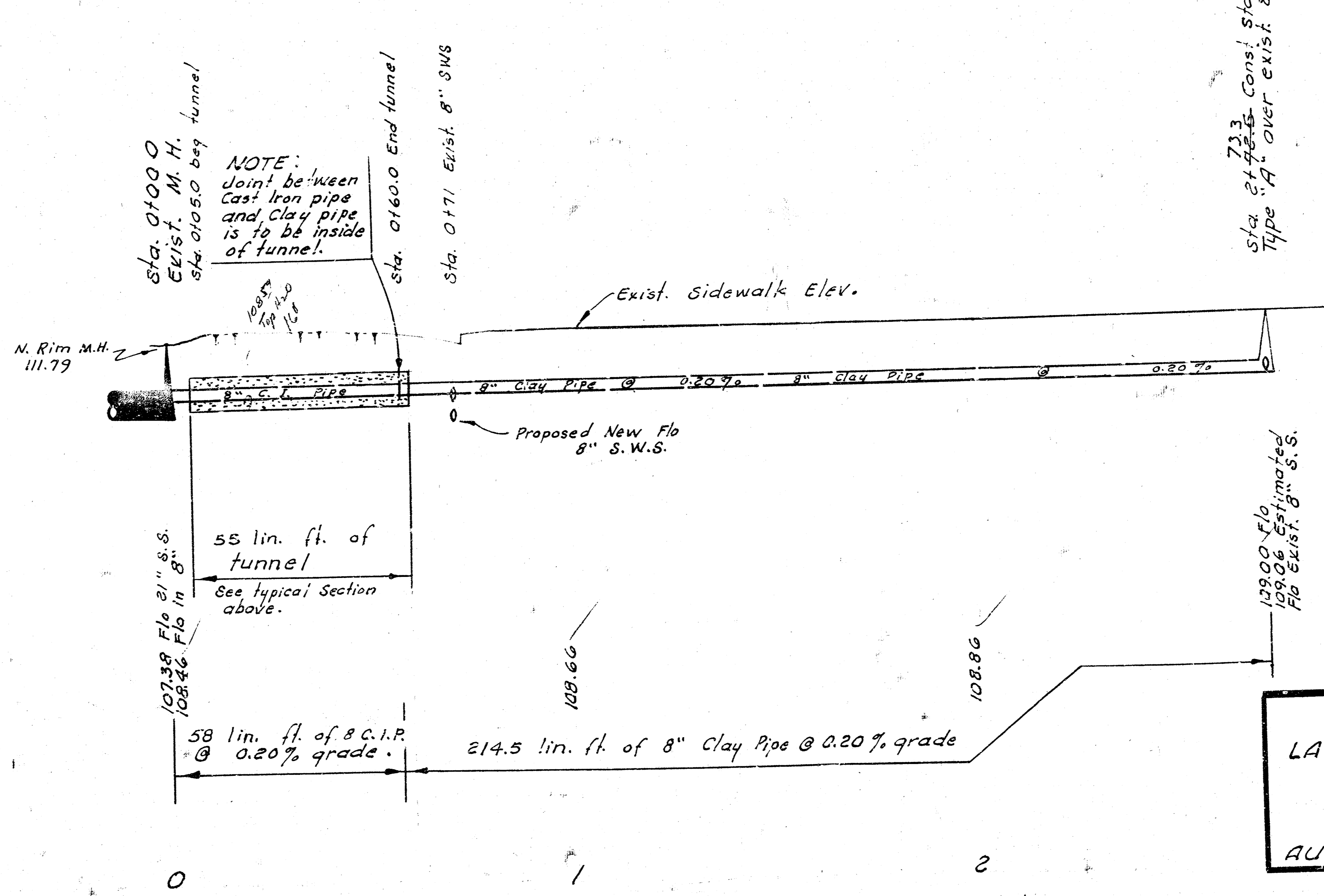

As BUILT S.S. JK-3  
RELOCATION OF A PART OF  
LAT. S, WEST SUB. A, on CENTRAL AVE., S.S. NO. 1  
CITY OF WICHITA, KANSAS  
R. W. LINN CITY ENGINEER  
AUG. 1972 PROJECT NO. KANS 4-5-3  
AKA 502026