

SCALE PLAN 1" = 40'
 PROFILE 1" = 40' HORIZ.
 1" = 5' VERT.

BROADWAY AVE.

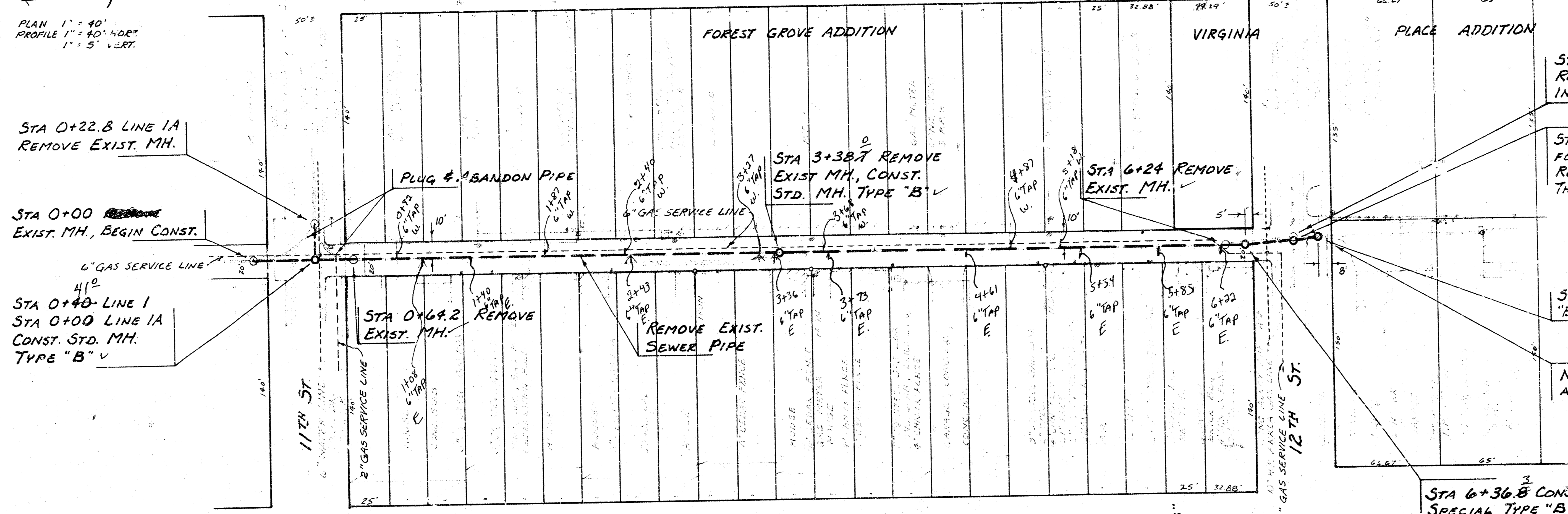

STA 6+68.4 3.0' LEFT
 REMOVE EXIST. S.W.S. MH.
 INSTALL 12" PIPE TO NEW SWS MH.

STA 6+68.7 CONST. SPECIAL TYPE "B" MH.
 FOR EXIST. 12" S.W.S. PIPE.
 RUN DUCTILE IRON SAN. SEN. PIPE
 THROUGH THE MH.

STA 6+83.8 CONST. SPECIAL TYPE
 "B" MH. OVER EXIST. 8" S.S. PIPE.

NOTE: CONTRACTOR IS TO EXCAVATE
 AND DETERMINE LOCATION OF EXIST. S.S. PIPE

BM. 117.06 R.R. SPIKE W. FACE P.P., NW COR. 12th ST.
 AND THE ALLEY BETWEEN BROADWAY & TOPEKA.
 BM. 118.44 BRIDGE SPIKE E. FACE P.P. W. SIDE ALLEY
 BETWEEN BROADWAY & TOPEKA. 4.5' P.P. N. OF 11th ST.
 BM. 118.10 "B" TOP OF CE. W. SIDE 11th ST. NO. 30' W. OF
 E. ALLEY BETWEEN BROADWAY & TOPEKA.

BM. 117.77 "D" 1.5" DIA CONG. BASE
 PARKING LIGHT POLE, NE COR.
 10th ST & BROADWAY.

TOPEKA AVE.

STA 0+00 REMOVE EXIST.
 MH., BEGIN CONST.

STA 0+40 LINE 1
 STA 0+00 LINE 1A
 CONST. STD. MH. TYPE "B"

STA 0+64.2 REMOVE
 EXIST. MH.

NOTE: SET TOP MANHOLE
 ELEV. TO MATCH EXIST.
 PAVEMENT.

STA 3+38.7 REMOVE
 EXIST. MH., CONST.
 STD. MH. TYPE "B"

STA 6+24 REMOVE
 EXIST. MH.

STA 6+83.8 CONST.
 STD. MH. TYPE "B"

STA 6+68.4 CONST. STD. MH. TYPE "B"
 FOR EXIST. 12" STORM WATER SEWER

STA 6+83.8 CONST. STD. MH.
 TYPE "B" OVER EXIST. 8" SAN SEWER

STA 0+00 LINE 1A
 STA 0+40 LINE 1
 STA 0+22.8 REMOVE
 EXIST. MH.

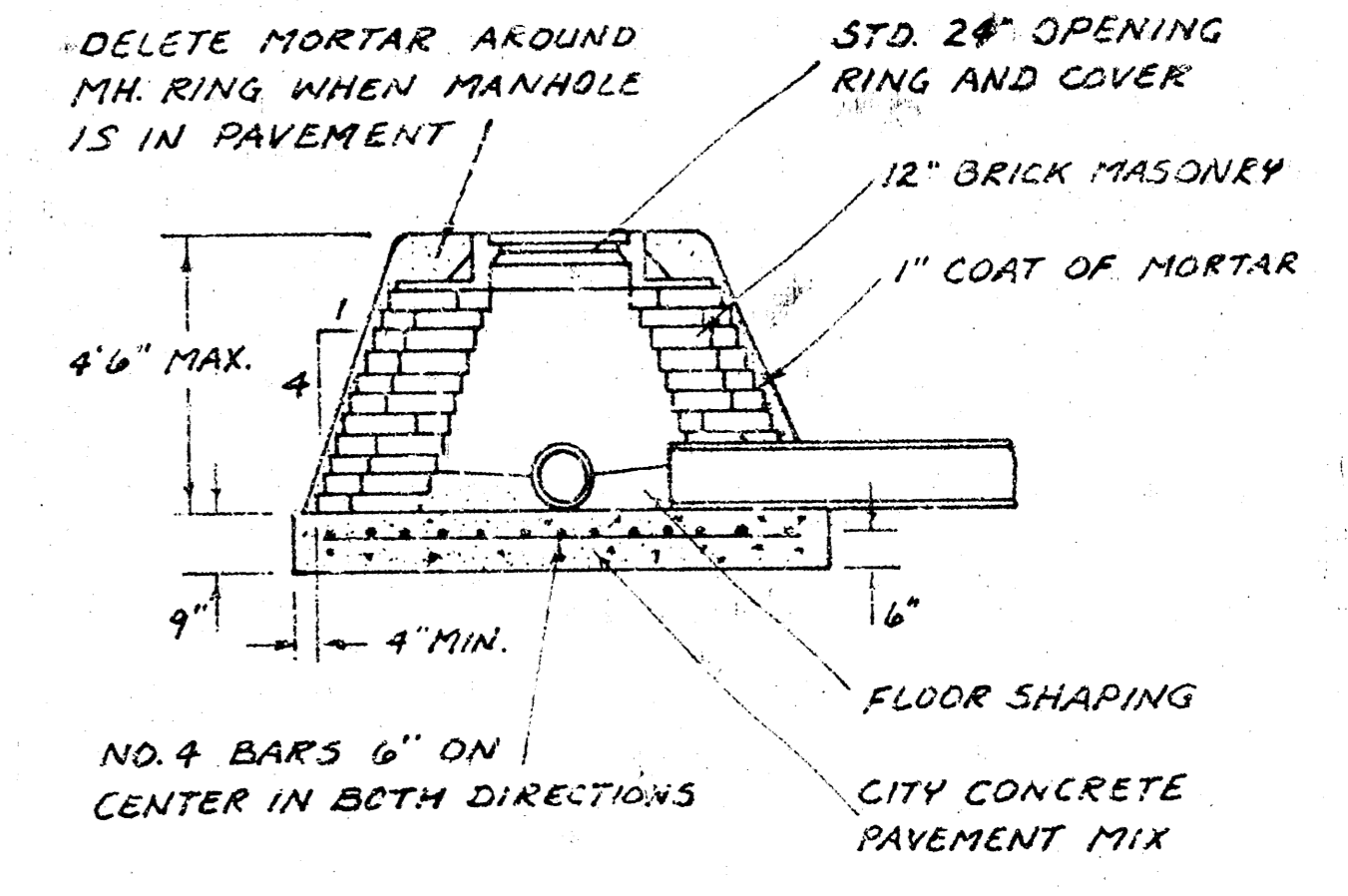

SPECIAL TYPE "B" MANHOLE DETAIL

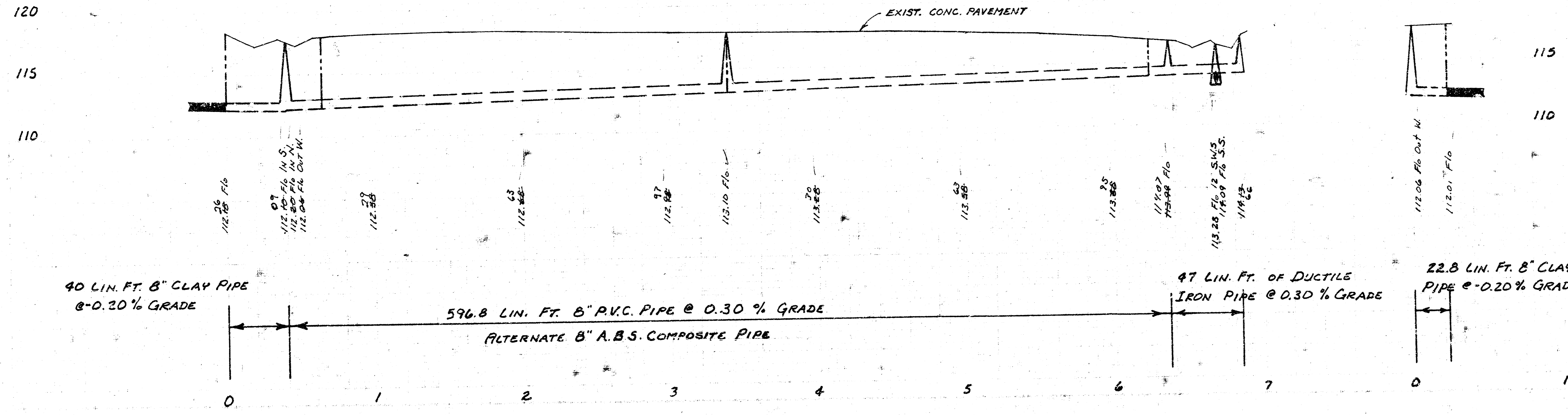

RECONSTRUCTION OF A PORTION OF EAST SUBMAIN B,
 S. S. #1 IN THE ALLEY BETWEEN BROADWAY
 AND TOPEKA FROM 11th ST. TO 12th ST.
 CITY OF WICHITA, KANSAS
 R. W. DRUGGEMAN DIRECTOR OF ENGINEERING / CITY ENGINEER
 PROJ. NO. 468-76-245-81181-000-000-601

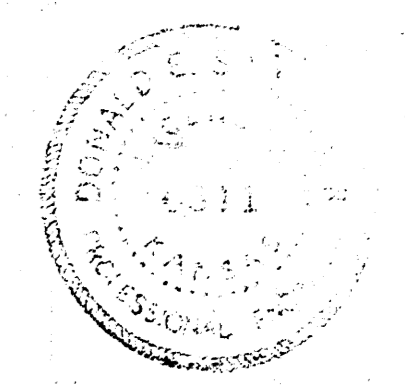

As Built
 J.L.L.
 7-82