

BM 119.86 Square Cut on North end Pump island, at S.E. Cor. 17th & Mosley
 BM 118.88 N.W. Rim M.H. at Sta 6+46.5

Plan Scale 1" = 40'
 Profile Scale 1" = 40' Horiz.
 1" = 5' Vert.

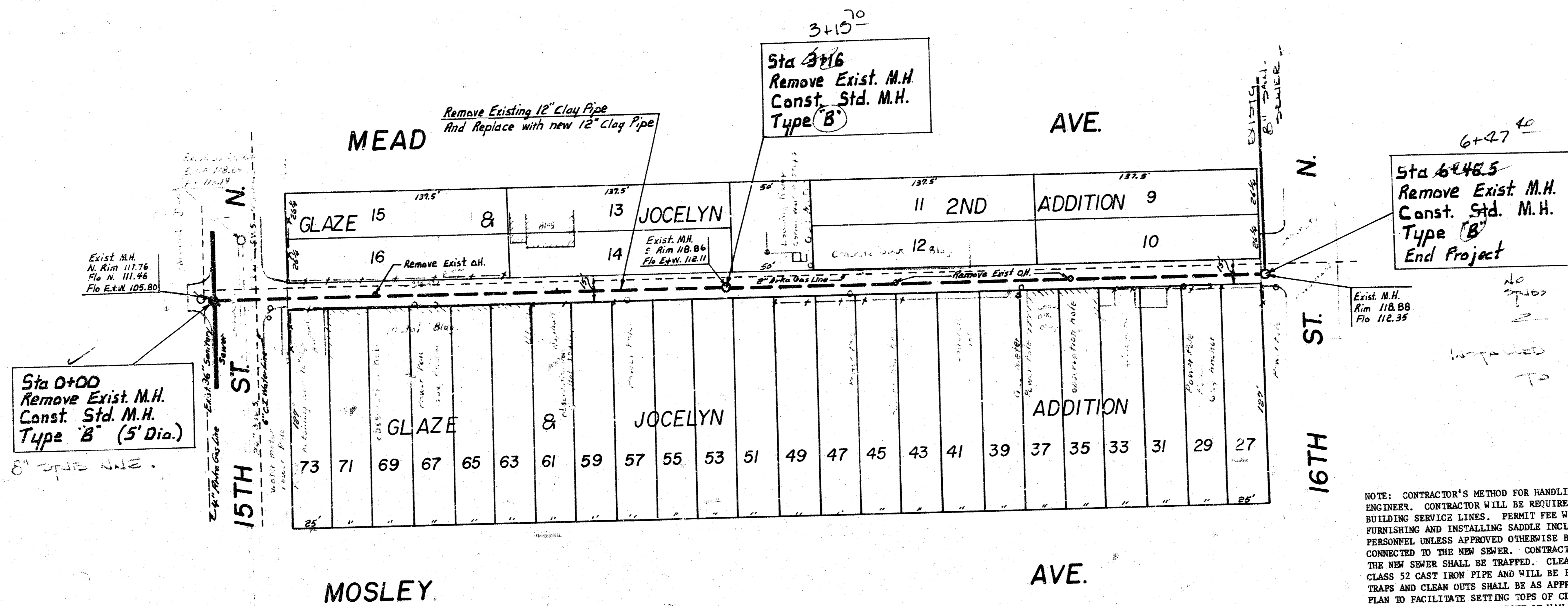

NOTE: CONTRACTOR'S METHOD FOR HANDLING SEWAGE FLOWS DURING CONSTRUCTION OF THIS PROJECT SHALL BE APPROVED BY THE ENGINEER. CONTRACTOR WILL BE REQUIRED TO OBTAIN PERMITS FROM PUBLIC WORKS ADMINISTRATION BEFORE RECONNECTING BUILDING SERVICE LINES. PERMIT FEE WILL BE WAIVED, BID ITEM FOR SERVICE CONNECTIONS SHALL COVER ALL COSTS FOR FURNISHING AND INSTALLING SADDLE INCLUDING TAPPING FEE. PIPE TAPS ARE TO BE MADE BY CITY MAINTENANCE DEPARTMENT PERSONNEL UNLESS APPROVED OTHERWISE BY THE ENGINEER. ONLY ACTIVE BUILDING SANITARY SEWER LINES ARE TO BE RECONNECTED TO THE NEW SEWER. CONTRACTOR SHALL VERIFY WHICH LINES ARE ACTIVE. EVERY BUILDING SEWER RECONNECTED TO THE NEW SEWER SHALL BE TRAPPED. CLEAN OUTS SHALL BE INSTALLED WITH THE TRAPS. TRAPS AND CLEAN OUTS SHALL BE CLASS 52 CAST IRON PIPE AND WILL BE PAID FOR AT THE UNIT PRICE BID PER LINEAL FOOT OF CAST IRON PIPE. LOCATION OF TRAPS AND CLEAN OUTS SHALL BE AS APPROVED BY THE ENGINEER. THE ALLEY PAVING PLAN SHEET HAS BEEN INCLUDED IN THIS PLAN TO FACILITATE SETTING TOPS OF CLEAN OUTS TO MATCH PAVEMENT ELEVATIONS WHERE IT MAY BE NECESSARY TO INSTALL CLEAN OUTS IN THE ALLEY RIGHT-OF-WAY. CONTRACTOR SHALL GIVE ALL PROPERTY OWNERS AND TENANTS AFFECTED BY THE CONSTRUCTION OF THIS PROJECT A MINIMUM OF 24 HOURS ADVANCE NOTICE PRIOR TO START OF CONSTRUCTION.

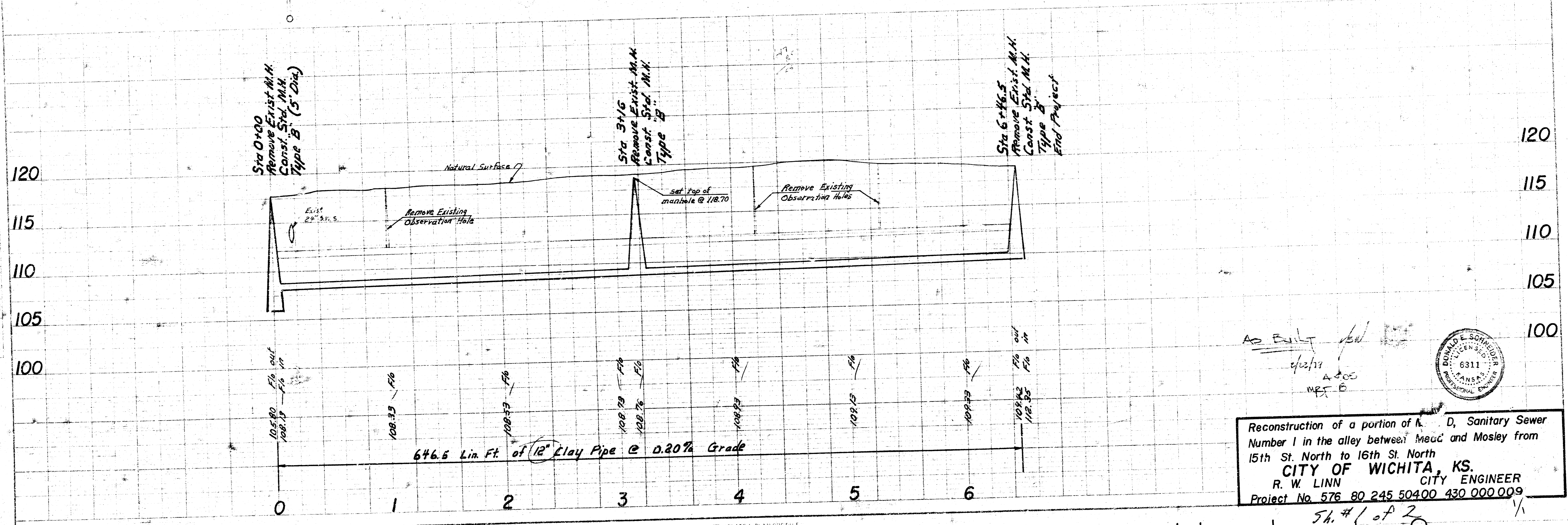

Reconstruction of a portion of R. W. Linn, D, Sanitary Sewer Number 1 in the alley between Mead and Mosley from 15th St. North to 16th St. North
CITY OF WICHITA, KS.
 R. W. LINN CITY ENGINEER
 Project No. 576 80 245 50400 430 000 009

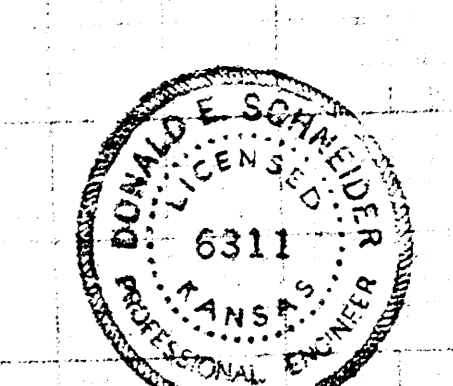

Sh. #1 of 2
 8

FILMED FROM THE BEST AVAILABLE COPY