

B. M. 113.58 SE cor. conc. base R.R. Signal light  
N.W. cor. Central and Wichita

**NOTE TO CONTRACTOR:**

Contractor is to give the Mo. Pac. & Texas  
Pac. R. R. Co. an advanced notification of 48 hours  
prior to beginning construction near R.R. Tracks  
in Wichita St.

**NOTIFY:** The Roadmaster  
Mo. Pacific and Texas Pacific R.R. Co.  
1410 East 25th St. No.  
Ph. No. 338-8311

Casing pipe to be installed by boring  
methods using equipment that encases  
the hole as the earth is removed. Boring  
without concurrent installation of casing  
will not be permitted. Sewer to be  
accurately positioned to flow elevation  
in casing using creosoted wood skids.  
Casing pipe to be completely filled  
with specified sand mix concrete after  
installation of 8" cast iron sewer pipe.

Bid price of tunnel shall include the steel pipe,  
pressure grout, skids and straps.

Concrete collar constructed on storm sewer will not  
be paid for directly and shall be considered as  
subsidiary to other items of work.

**NOTE TO CONTRACTOR  
AND FIELD ENGINEER:**

Contractor to excavate exist.  
S.S. of Sta. 2172.0 so Field  
Engineer can verify Flo. Elev.  
prior to staking of the  
project.

Plan Scale 1" = 20'  
Profile Scale 1" = 2' Vert.

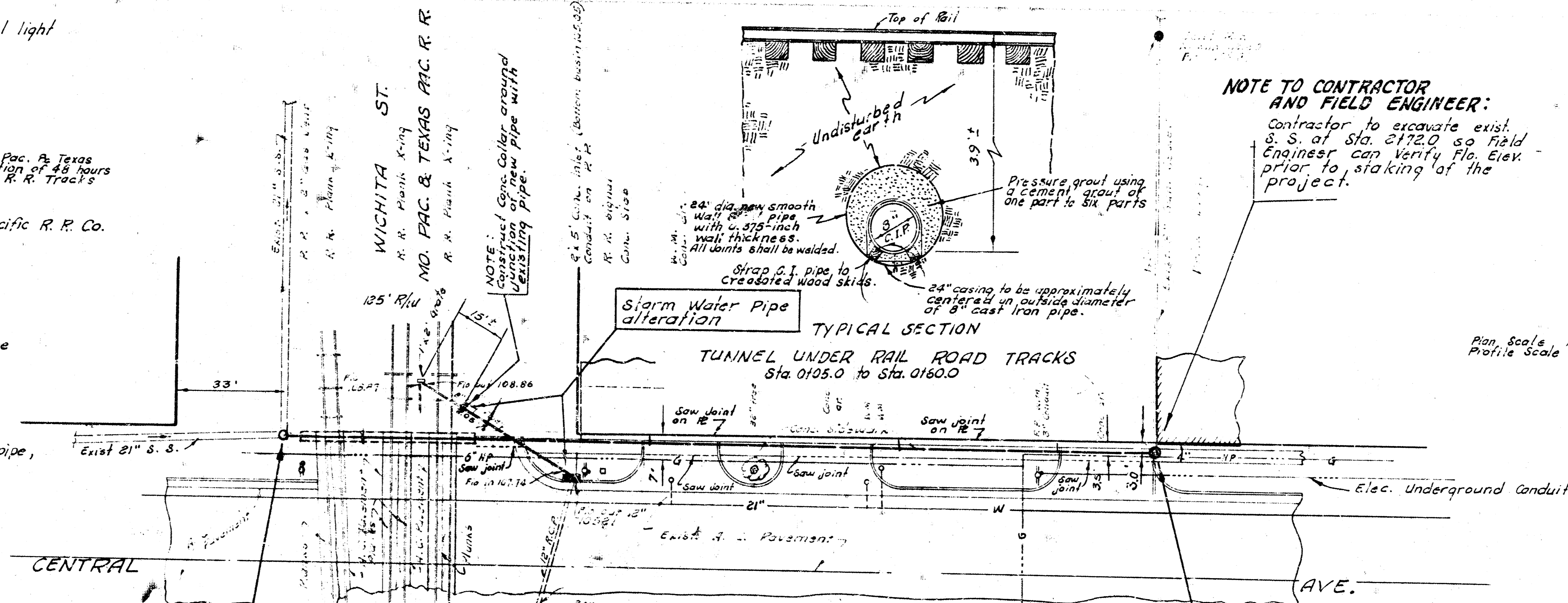

**NOTE:**  
All pavement, walk and  
drive to be replaced.  
All pavement, walk, and drive replaced  
shall conform to applicable standard  
specifications of the City of Wichita, Kansas.

Sta. 2172.3 Const. Sid. M.H.  
Type 'A' over exist. 8"  
San. Sewer.

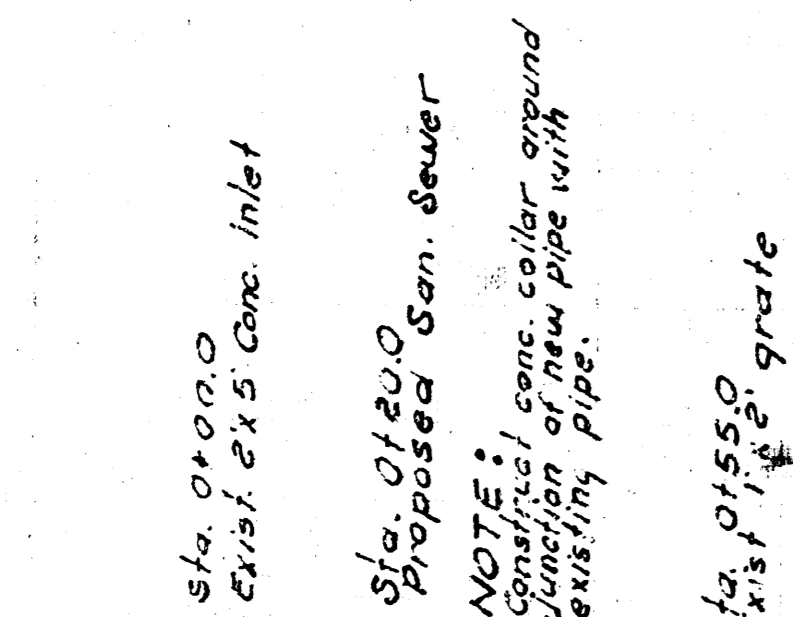

105.21 Flo out 18"  
105.05 Bottom of Inlet  
103.74 Flo in exist. 8"  
103.54 Flo in proposed 8"  
Install 40  
Lin. ft. of 8"  
Clay pipe  
Storm Water Pipe Alteration

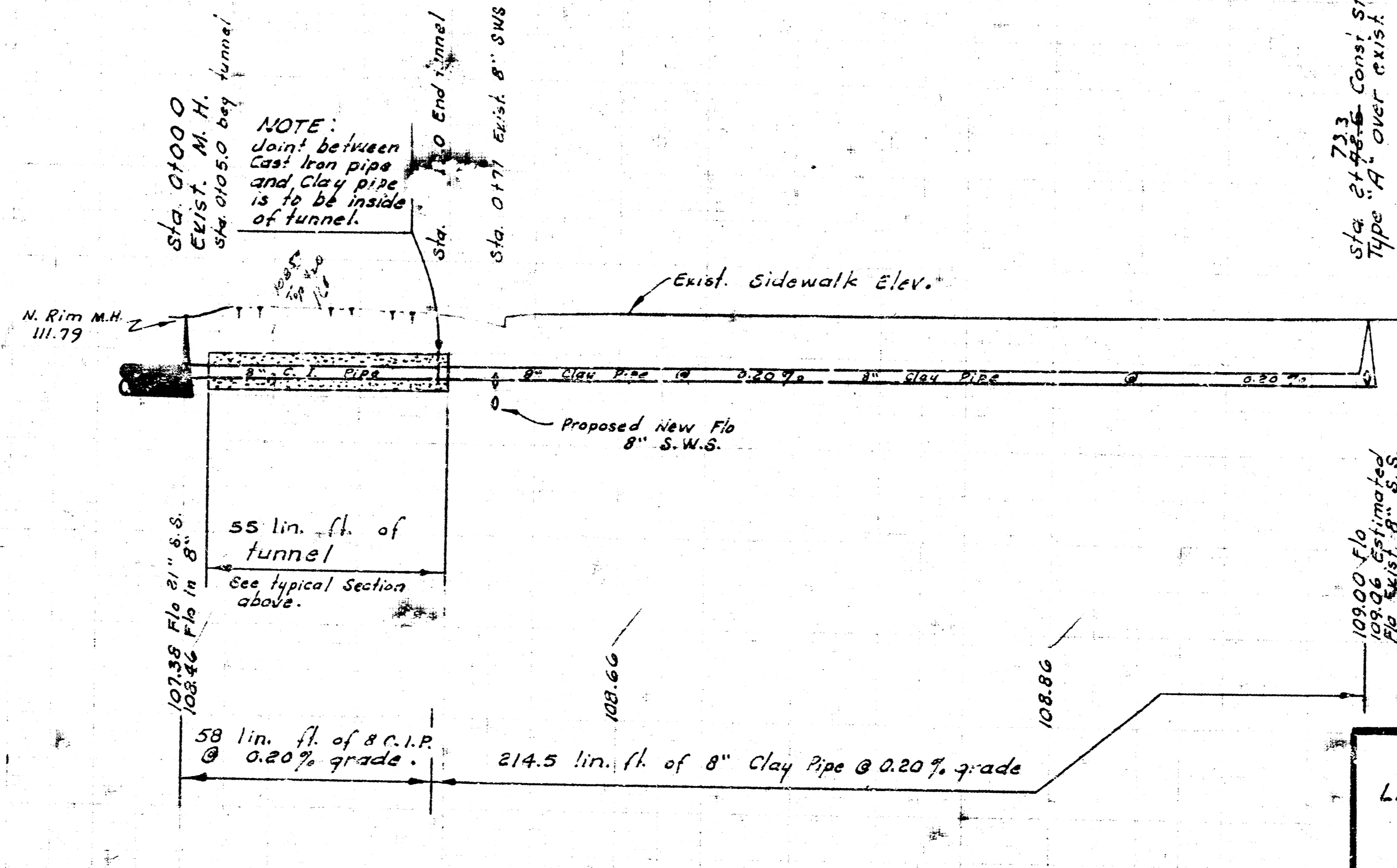

As Built S.S. 1k\*3  
RELOCATION OF A PART OF  
LAT. 5, WEST SUB. A, on CENTRAL AVE., S.S. NO. 1  
CITY OF WICHITA, KANSAS  
R. W. LINN CITY ENGINEER  
AUG. 1972 PROJECT NO. KANS 9-5-3  
AKB 552026

