

A. M. 10.28 SE. cor. 1st Step GRAMM APT'S 812 E. Dewey.  
 B. M. 108.83 "2" in Ritchie & W.H. E. 1st fl. E. of E. cb Alley N. @ 2nd's bst. Emporia & Topeka.

U.S.A. Survey

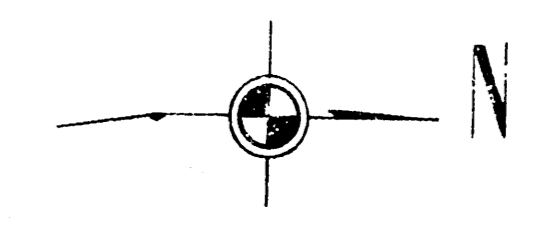
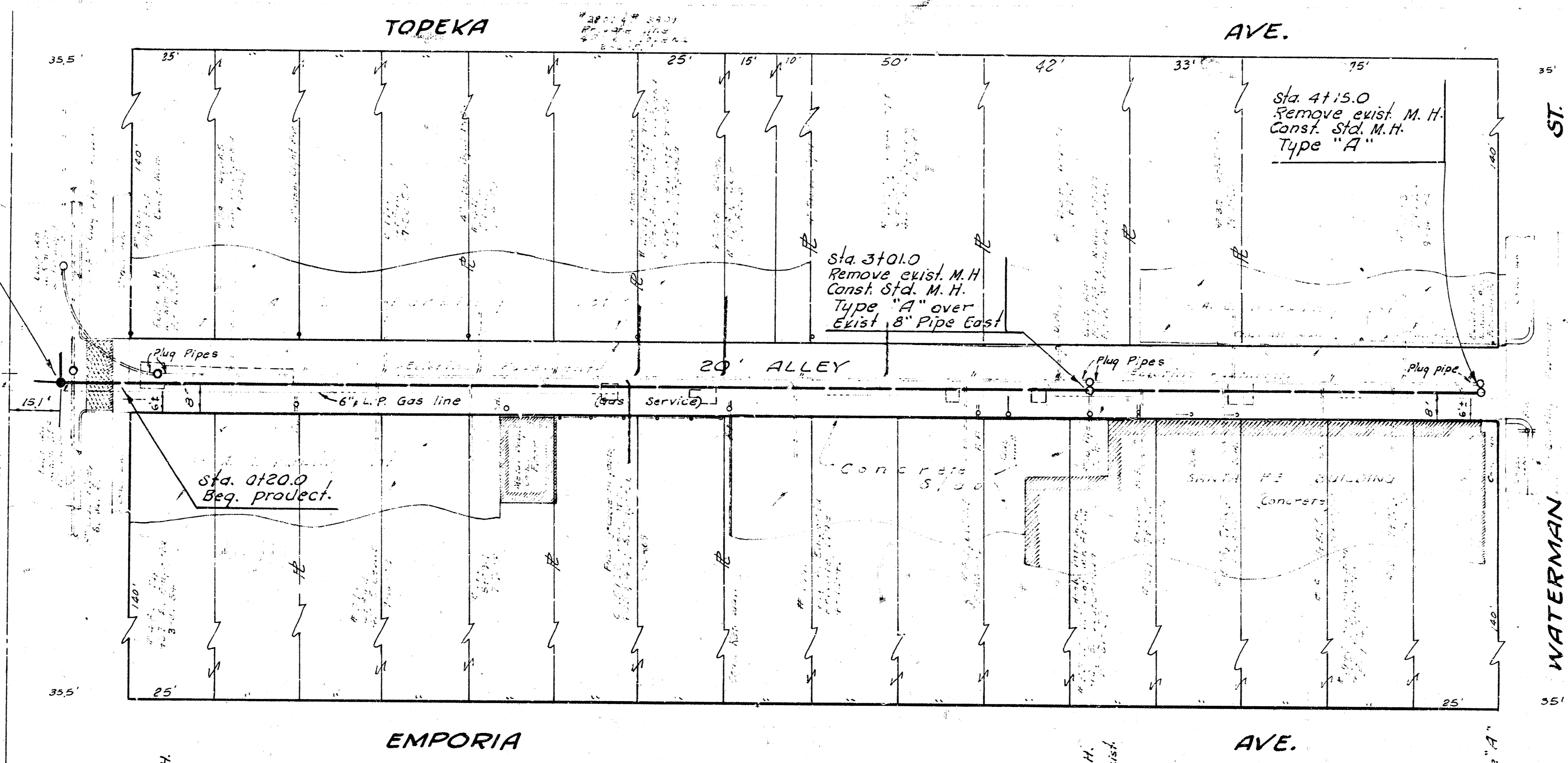
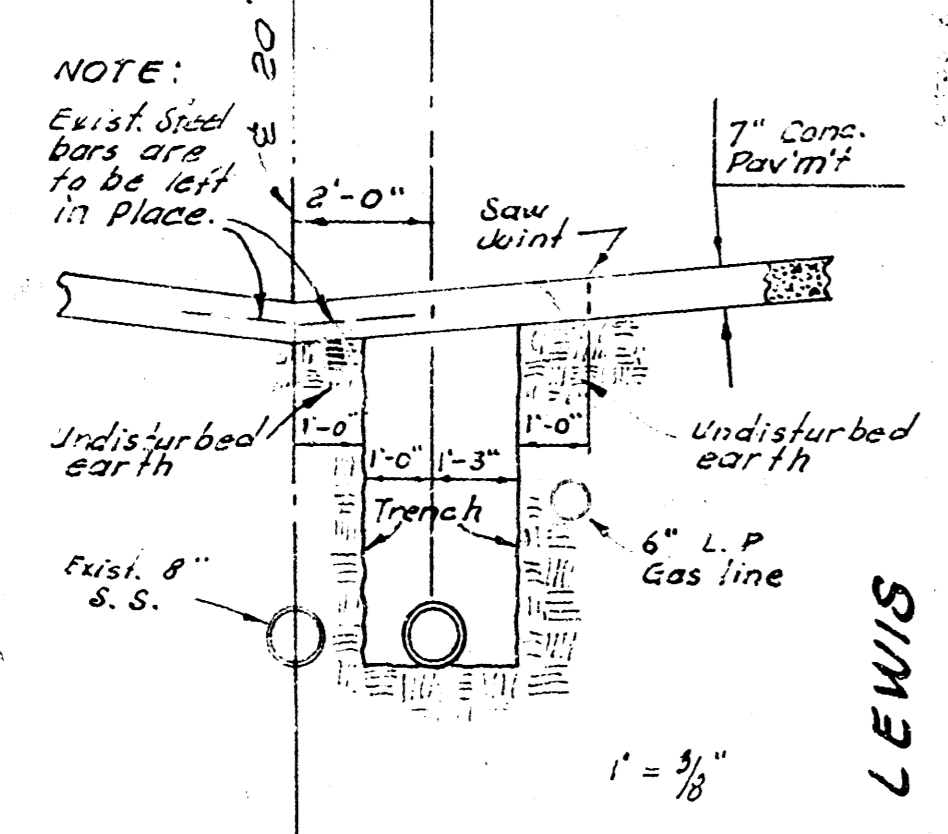

Scales  
 Plan 1" = 20'  
 Profile 1" = 20' Horiz.  
 1" = 1' Vert.

- B. M. 108.54 "C" in W. B. Carter center W. Radius Alley betw. Topeka and Emporia & Sidg. Waterman.
- B. M. 109.07 "D" E. Exit Fire Hydrant & W. Waterman & Emporia.
- B. M. 108.59 "E" 1st W. curb Alley Return betw. Topeka & Emporia & Sidg. Waterman.

**NOTE TO CONTRACTOR AND FIELD ENGR.**

1. Reconnect all existing service leads which are in use.
2. Plug all service leads east which are not in use.
3. Contractor to coordinate tapping of service connections with the city maintenance dept.
4. Pipe plugs used on 8" pipe shall be incidental to bid Price of M.H. Removed.
5. Contractor will be required to obtain permits for all service connections. Permits will be waived by Dept. of Public Works.

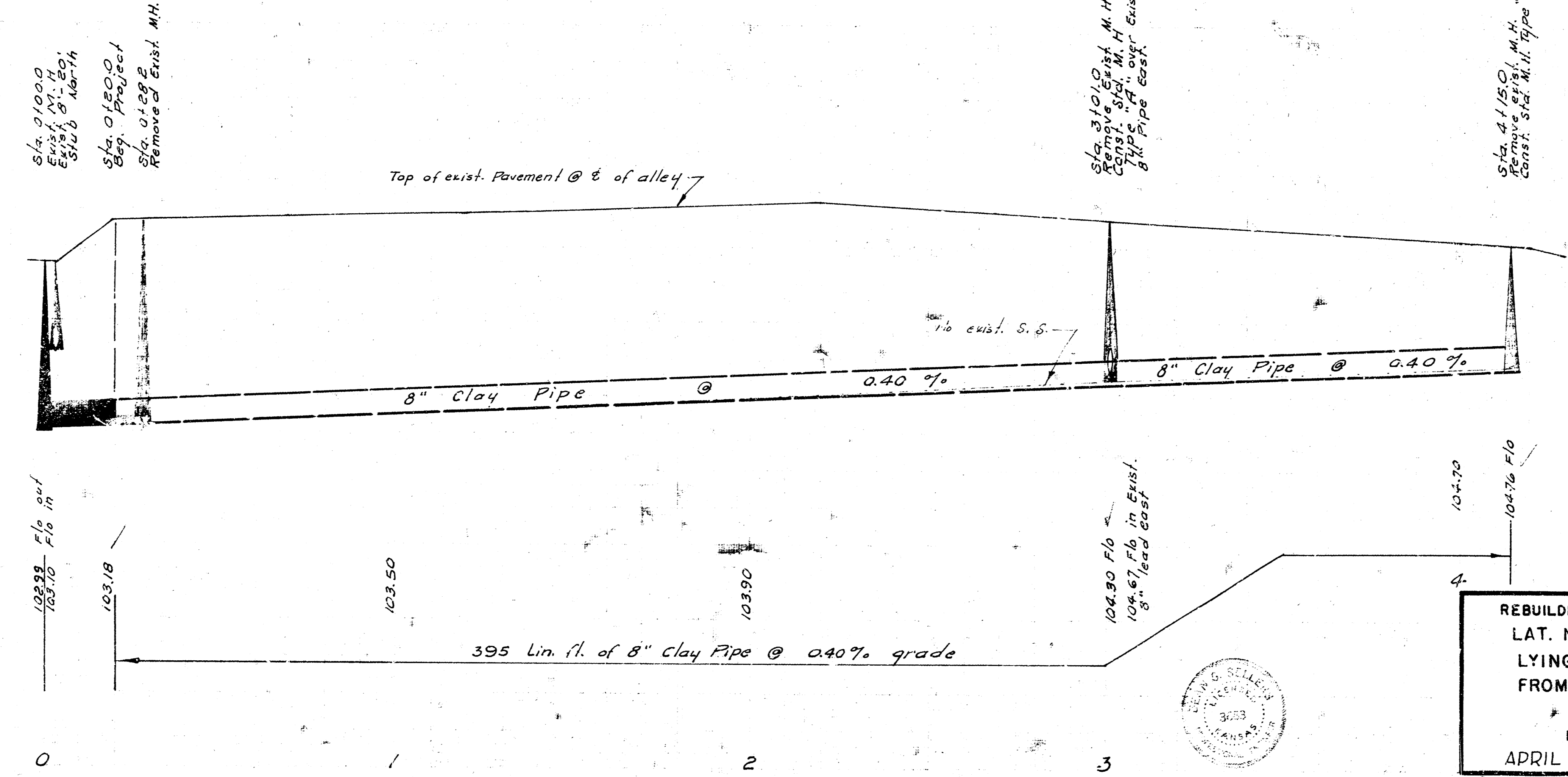

REBUILDING AND RECONSTRUCTION OF A PORTION OF  
 LAT. N OF EAST SUBMAIN B, S. S. NO. 1  
 LYING IN ALLEY BETW. TOPEKA & EMPORIA  
 FROM LEWIS ST. TO WATERMAN ST.  
 CITY OF WICHITA, KANSAS  
 R. W. LINN - CITY ENGINEER  
 APRIL 1972 PROJECT NO. DBKLS72020

