

THE CONTRACTOR SHALL BE RESPONSIBLE FOR OBTAINING PROPER PERMITS. THE CONTRACTOR SHALL BE RESPONSIBLE FOR ESTABLISHING AND MAINTAINING ALL NECESSARY TRAFFIC CONTROL MEASURES THROUGHOUT THE PROJECT. THE CONTRACTOR SHALL BE RESPONSIBLE FOR OBTAINING ALL NECESSARY PERMITS FROM THE CITY OF WICHITA AND THE KANSAS DEPARTMENT OF TRANSPORTATION. THE CONTRACTOR SHALL BE RESPONSIBLE FOR OBTAINING ALL NECESSARY PERMITS FROM THE KANSAS DEPARTMENT OF TRANSPORTATION. THE CONTRACTOR SHALL BE RESPONSIBLE FOR OBTAINING ALL NECESSARY PERMITS FROM THE KANSAS DEPARTMENT OF TRANSPORTATION.

SCALE PLAN 1"=20'
 PROFILE 1"=20' HORIZ.
 1"=5' VERT.

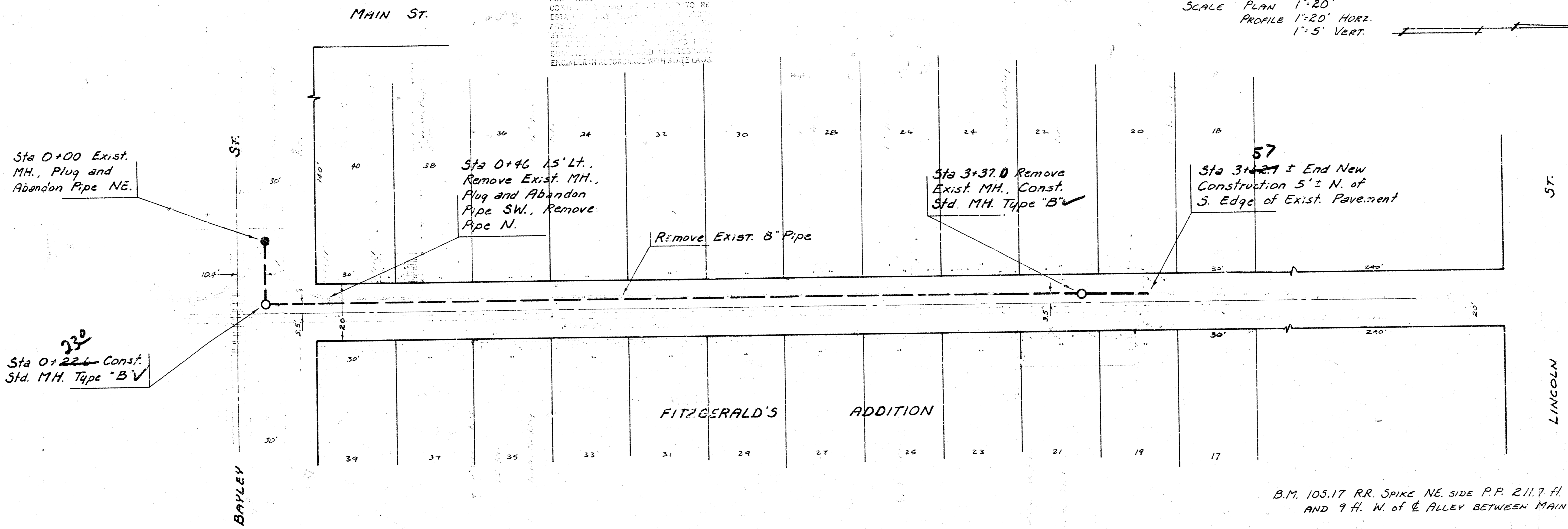

B.M. 105.17 RR. SPIKE NE. SIDE P.P. 211.7 Ft. N. of E. BAYLEY AND 9 Ft. N. of E. ALLEY BETWEEN MAIN AND MARKET.

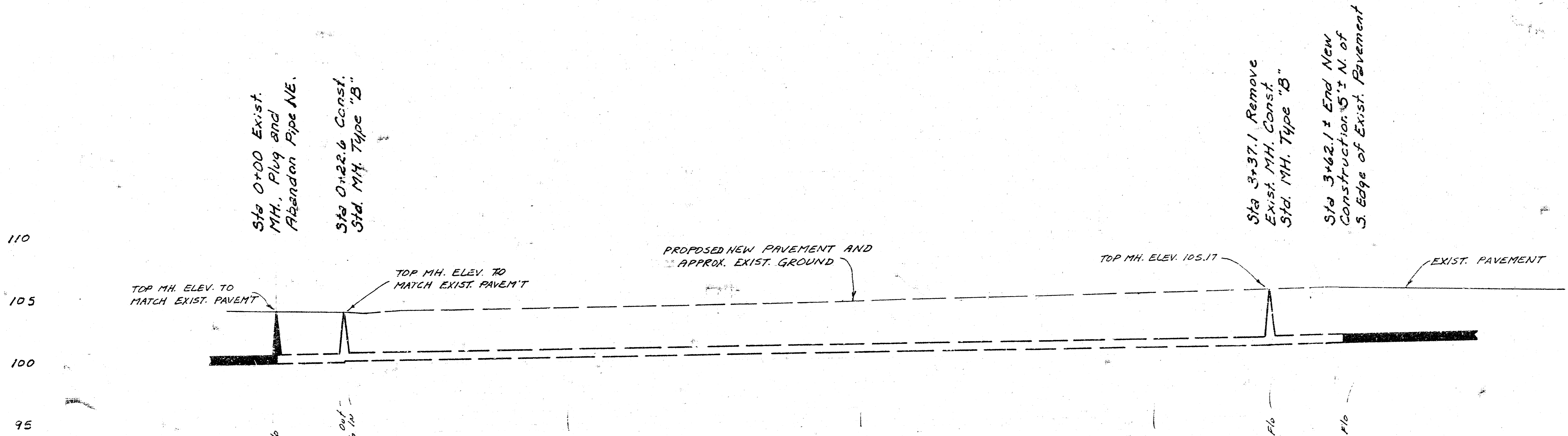

As Built
 JSL
 2/89

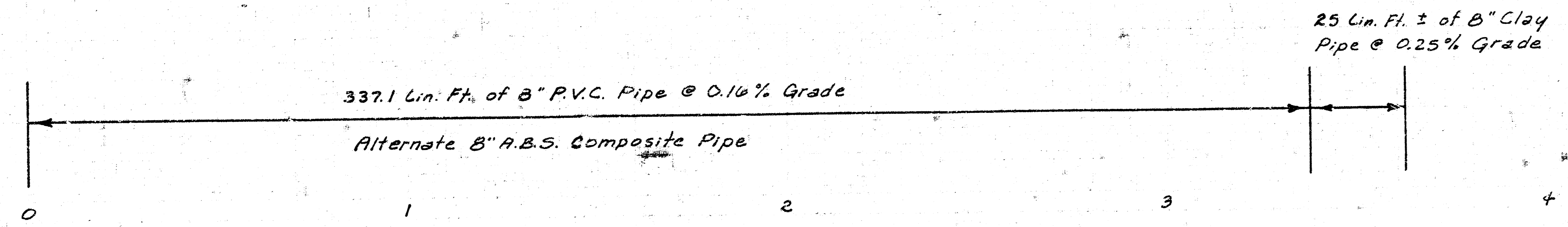

RECONSTRUCTION OF A PORTION OF LAT. N, EAST SUBMAIN A, S.S. NO. 1 IN THE ALLEY BETWEEN MAIN AND MARKET FROM BAYLEY TO LINCOLN CITY OF WICHITA, KANSAS
 R.W. BRUGGEMAN
 DIRECTOR OF ENGINEERING - CITY ENGINEER
 PROJ. NO. 542-80-245-80035-000-000-001