

Drawn by R. S. ...  
 Plan by ...  
 Checked by ...

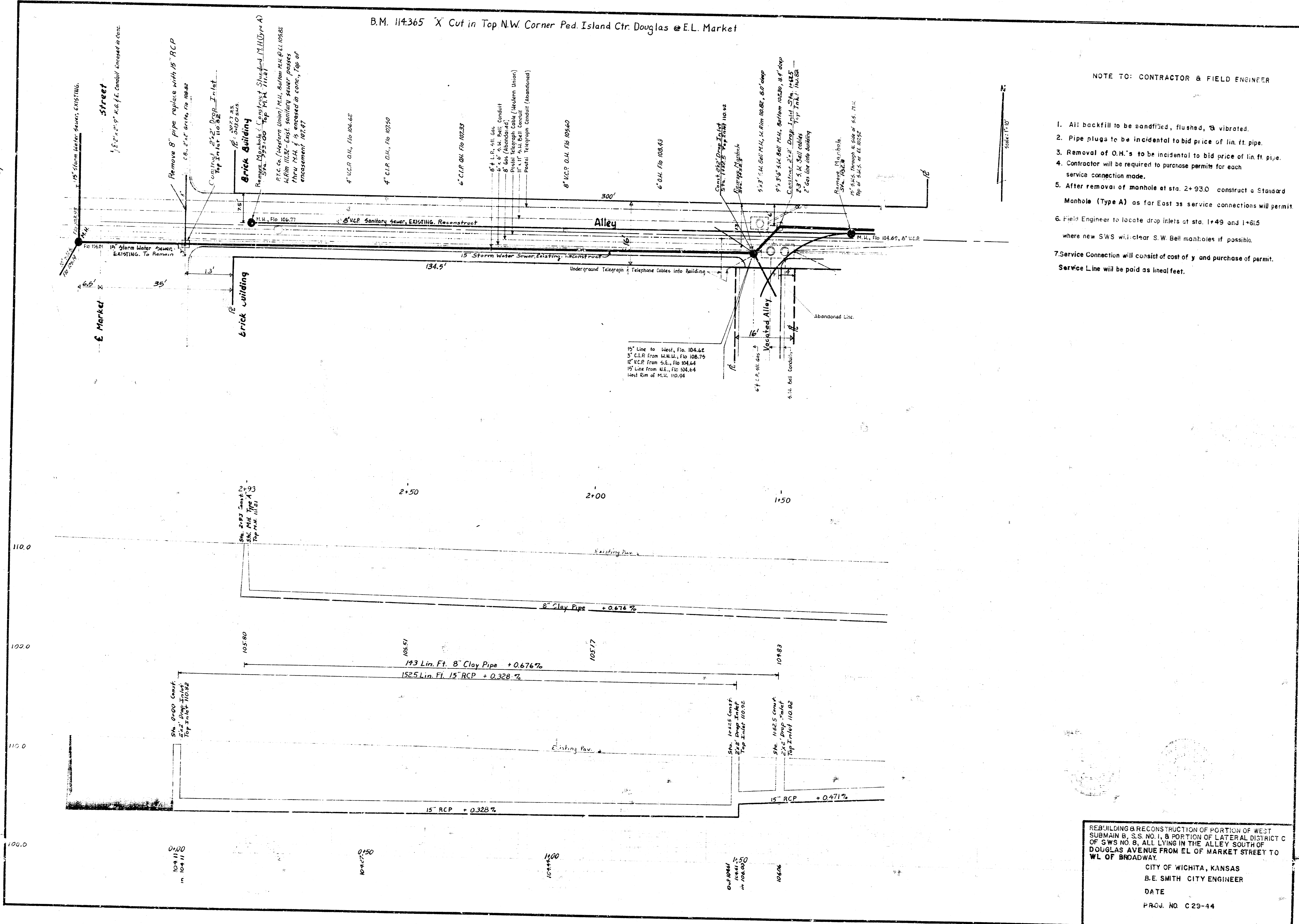

B.M. 114365 'X' Cut in Top N.W. Corner Ped. Island Ctr. Douglas @ E.L. Market

NOTE TO CONTRACTOR & FIELD ENGINEER

1. All backfill to be sandfilled, flushed, & vibrated.
2. Pipe plugs to be incidental to bid price of lin. ft. pipe.
3. Removal of O.H.'s to be incidental to bid price of lin. ft. pipe.
4. Contractor will be required to purchase permits for each service connection made.
5. After removal of manhole at sta. 2+93.0 construct a Standard Manhole (Type A) as far East as service connections will permit.
6. Field Engineer to locate drop inlets at sta. 1+49 and 1+61.5 where new SWS will clear S.W. Bell manholes if possible.
7. Service Connection will consist of cost of y and purchase of permit. Service Line will be paid as lineal feet.

REBUILDING & RECONSTRUCTION OF PORTION OF WEST SUBMAIN B, S.S. NO. 1, & PORTION OF LATERAL DISTRICT C OF SWS NO. 8, ALL LYING IN THE ALLEY SOUTH OF DOUGLAS AVENUE FROM EL OF MARKET STREET TO WL OF BROADWAY.  
 CITY OF WICHITA, KANSAS  
 B.E. SMITH CITY ENGINEER  
 DATE  
 PROJ. NO. C29-44

