

LAT 29, DIST. A, MAIN 12

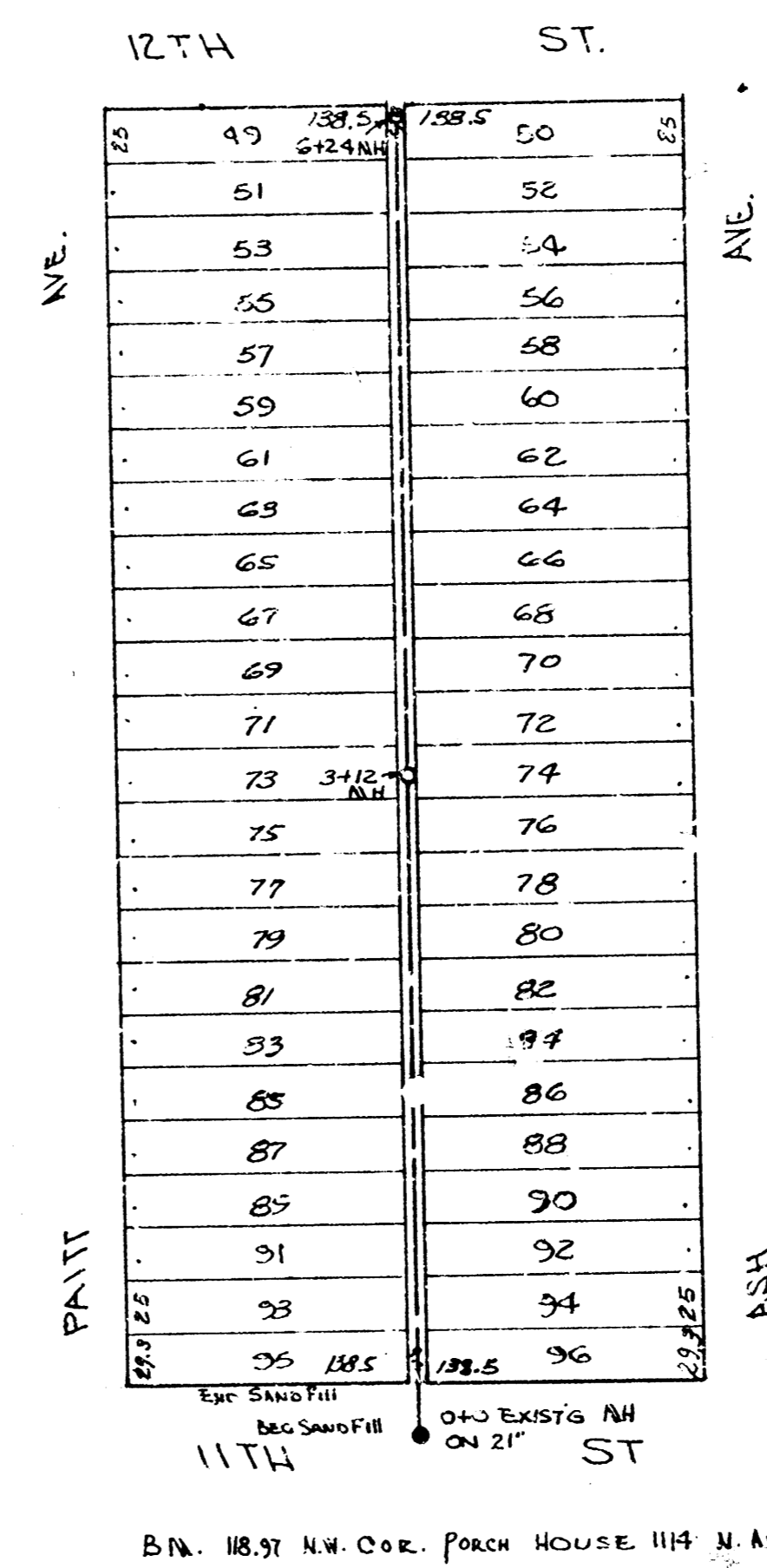

B.M. 10118 EXISTING N.W. COR. 1/200

NOTE: Buildings both sides of alley at Station 2150 making close working quarters. Approx. 30' may have to be handwork.

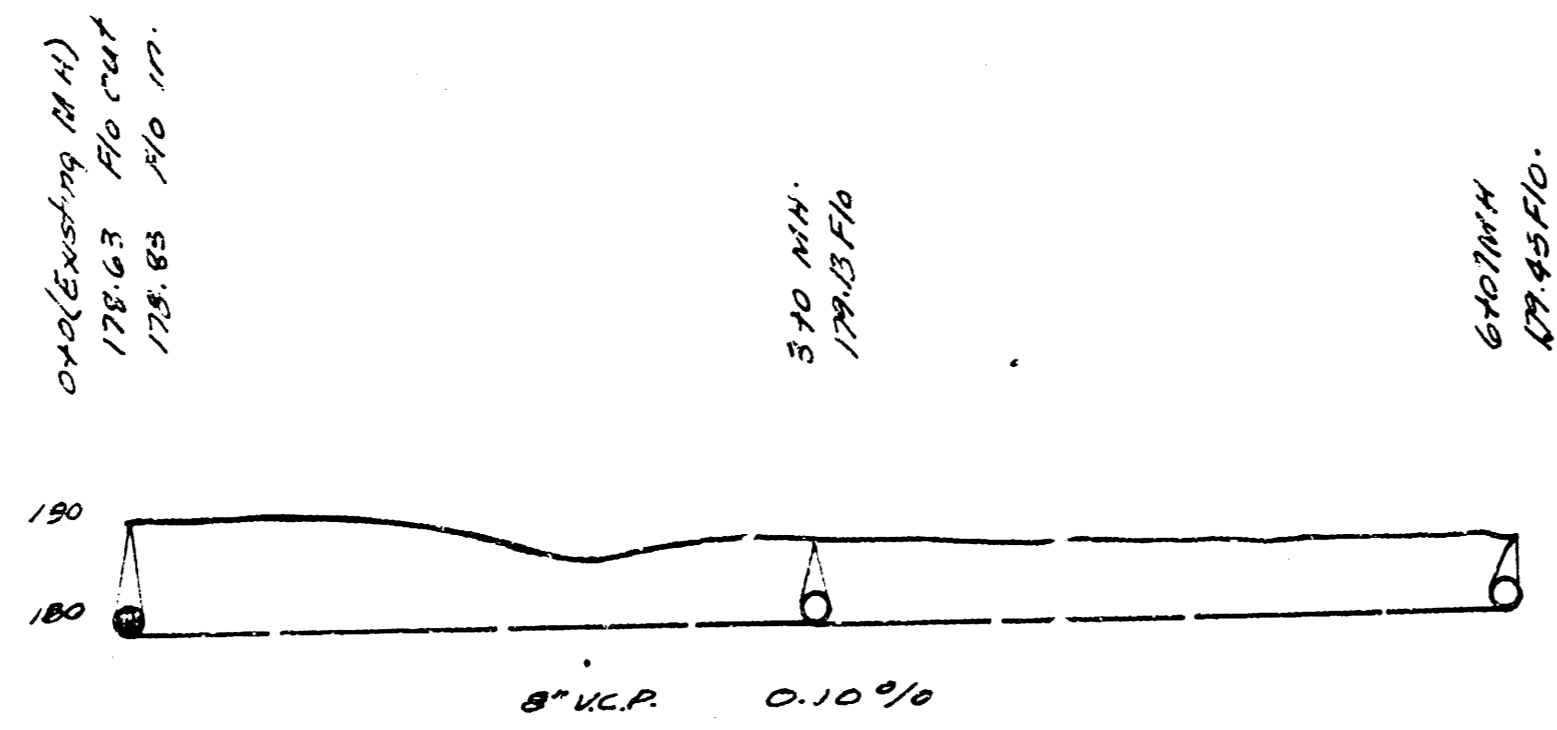
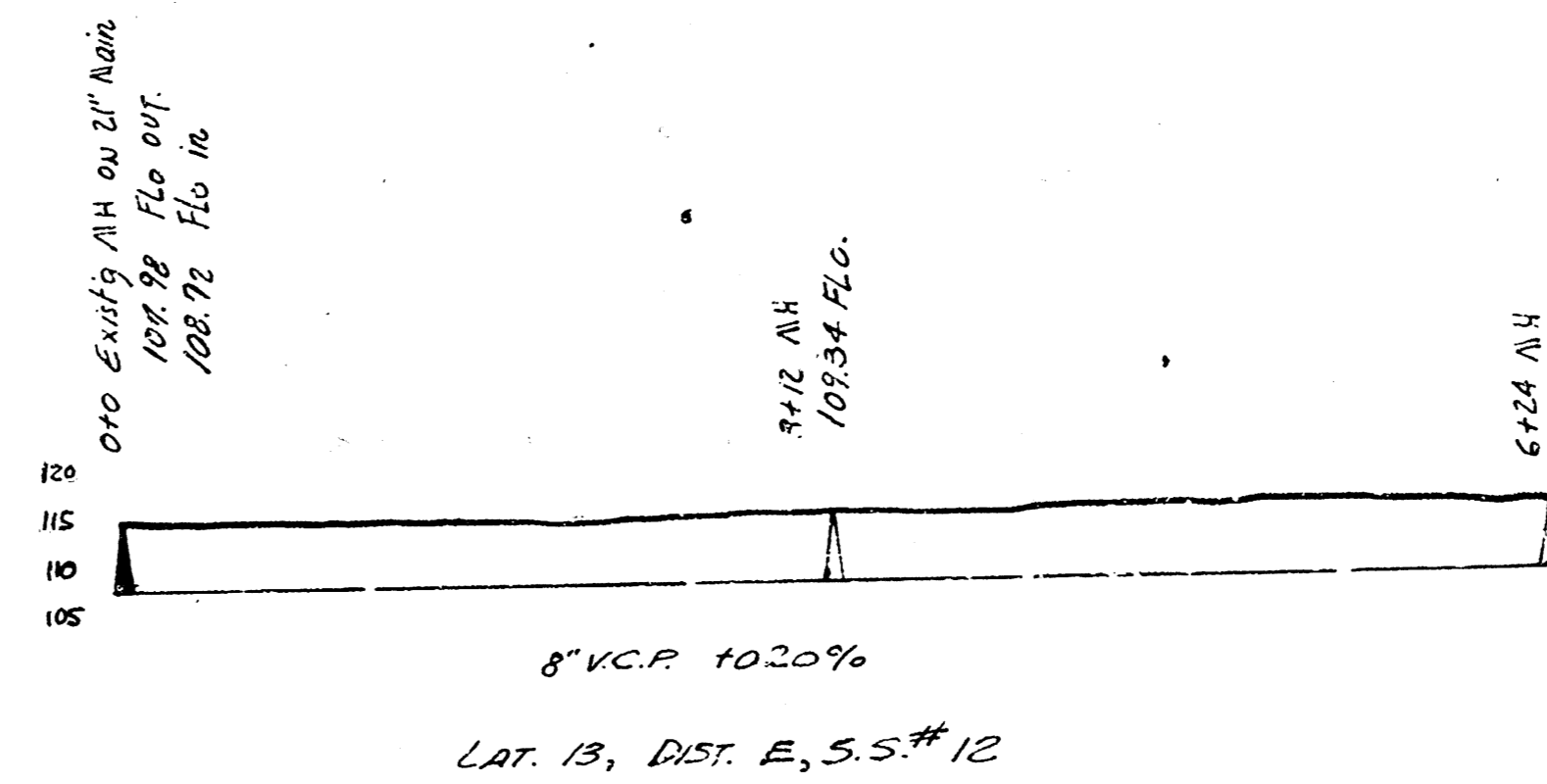

LAT. 13, DIST. E, S.S.#12

LAT. 29 DIST. A. MAIN 12
LAT. 13, DIST. E, S.S.#12
CITY OF WICHITA, KANSAS.
L.K. White ... City Engineer
Feb 1928 Proj. No. C27-30