

Plan, No. 1-3-68
Chicago

Note: Utility lines installed after construction began not shown on plan. The contractor shall consult with project engineer for location of recent established utility lines.

B.M. 14323 City St. N.E. Cor. Hillside & Central

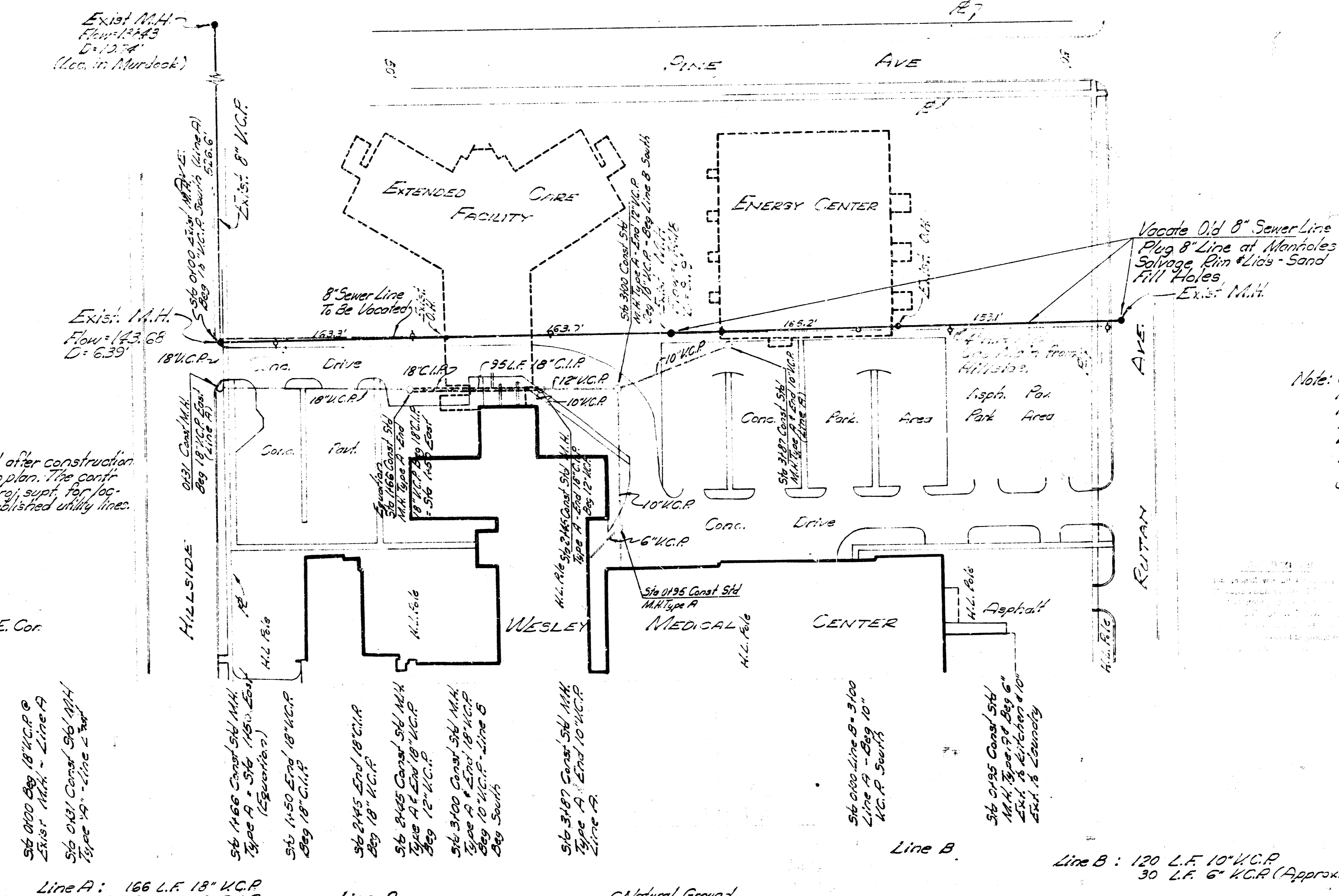

Note: Contractor shall salvage 2 manhole rings & lids which shall be turned to the City Materials Yard. Existing manholes not being used shall be removed approx. 12\"/>

Scale: 1\"/>

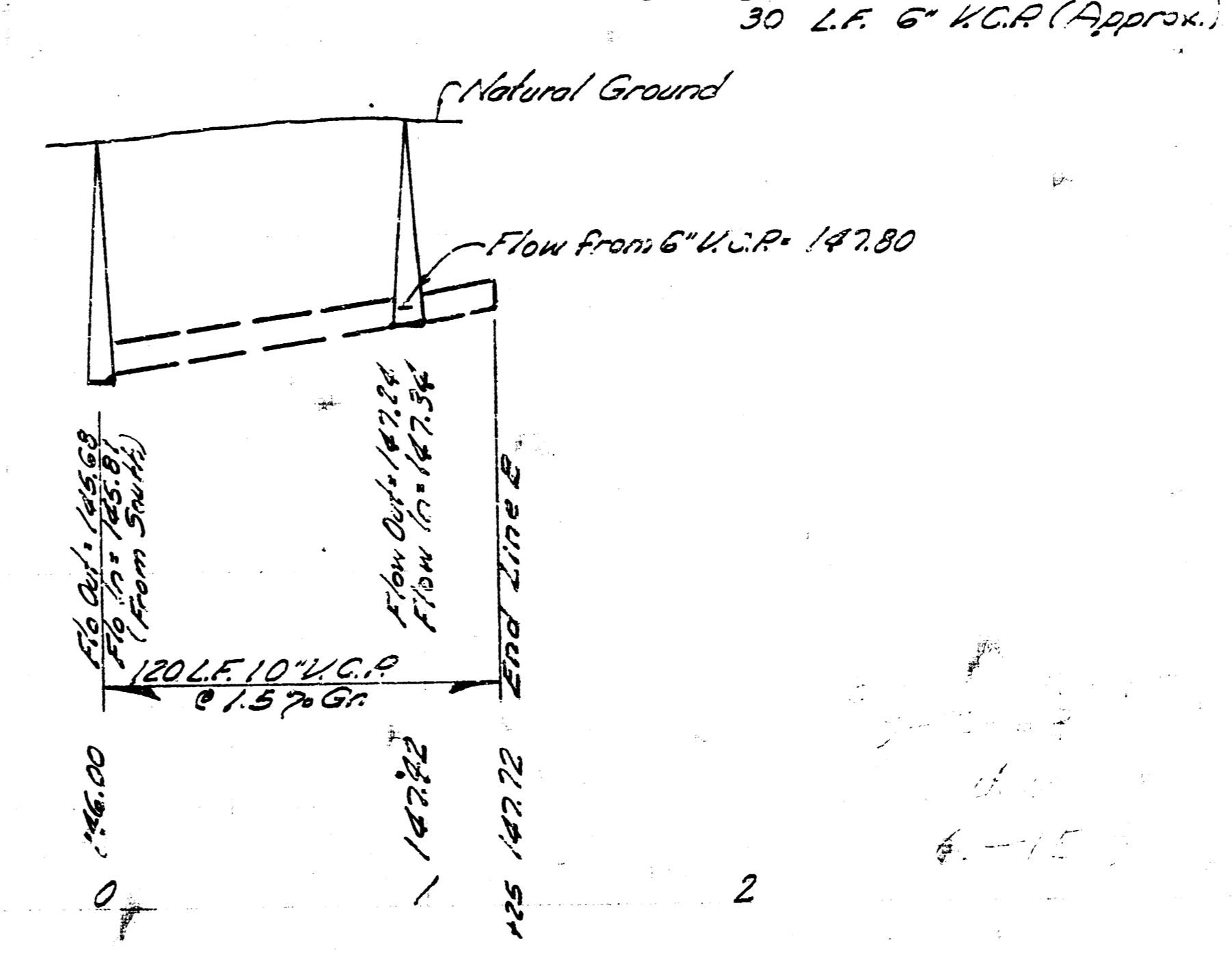
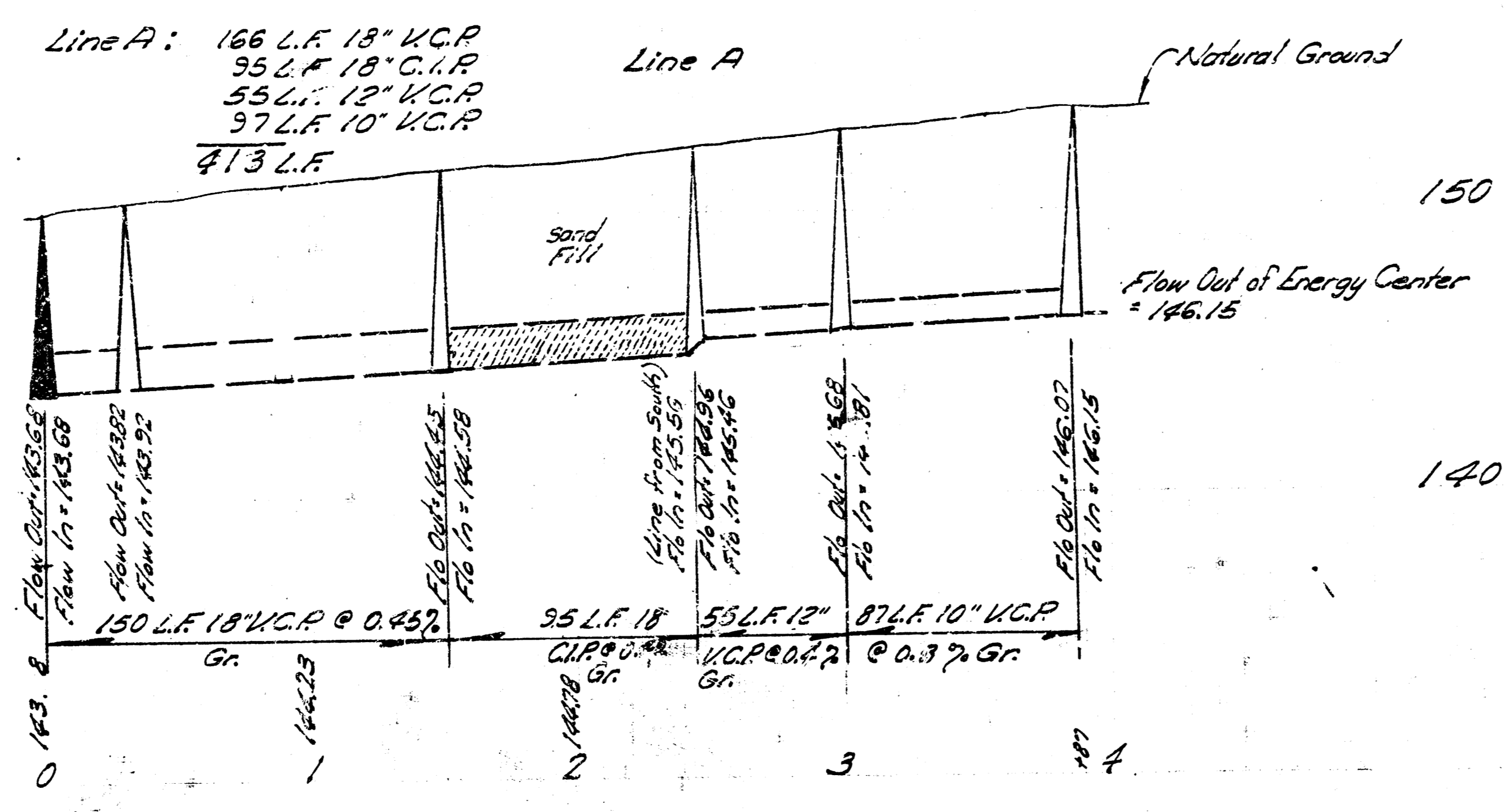

SANITARY SEWER RECONSTRUCTION
FOR WESLEY HOSPITAL
CITY OF WICHITA KANSAS
B.E. SMITH CITY ENGINEER
1968