

DISTRICT 1. S.S.No.12.

3.M.18557. S.M.S.No.18. Multi-Use. W. side Poplar + Orphe.

B.M. 10939 C in Corners N.W. Chautauqua + Orphe.

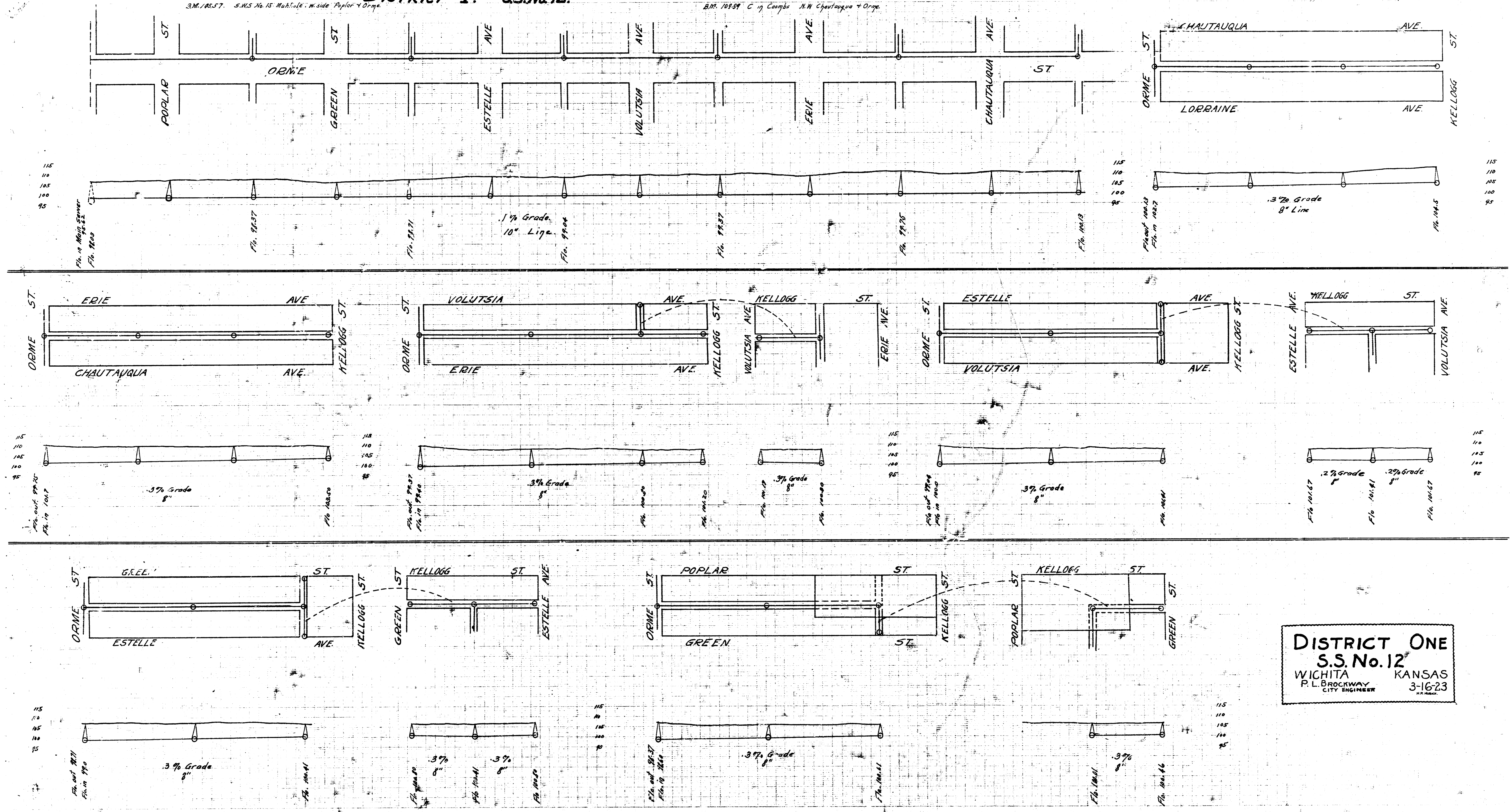

DISTRICT ONE
 S.S.No.12
 WICHITA KANSAS
 P.L.BROCKWAY
 CITY ENGINEER
 3-16-23