

B.M. Elev. 122.34 - 2" in LeFeve's C. of wk. So. S.W. cor. 15th & Grove

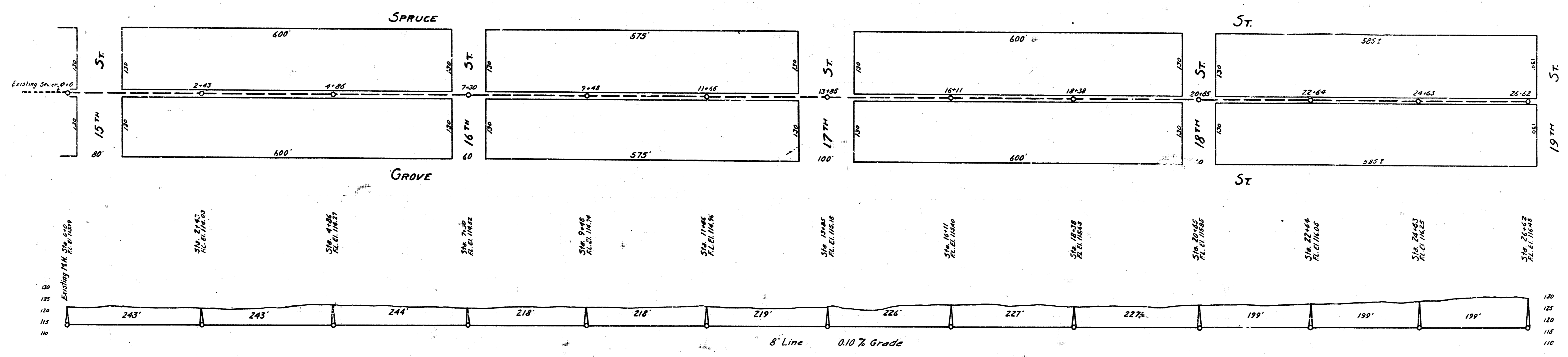

LAT. N, DIST. 0, S.S. #12

LAT. P, DIST. 6, S.S. #12

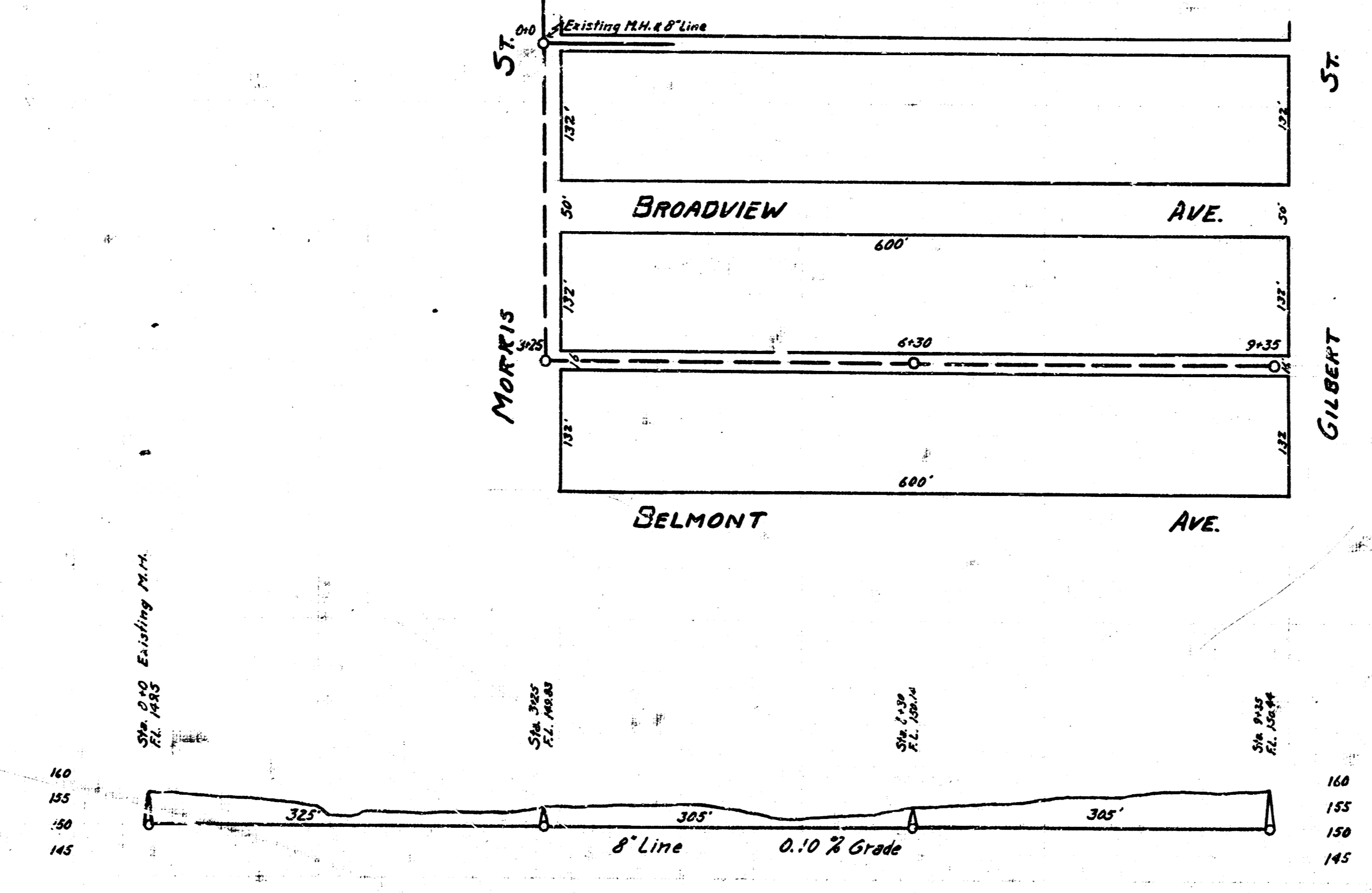

B.M. Elev. 152.62 South end of curb N.E. cor. Broadview & Morris
153.98 Spike in pole N.W. side Morris bet. Broadv. & Belmont

