

PAVING AND INCIDENTAL DRAINAGE IMPROVEMENTS

TO SERVE

84611

WEBB BUSINESS PARK

TOBEN ST. AND 40TH ST. NORTH - FROM 39TH ST. NORTH TO WEBB ROAD

OCA NO. 766197

CITY OF WICHITA PROJECT NO. 472-84611

CITY OF WICHITA, KANSAS

JAMES L. ARMOUR, P.E. - CITY ENGINEER

DEVELOPER CONTACT

MR. BENNIE M. LEE, JR.
WEBB BUSINESS PARK, L.L.C.
4603 S. SENECA
WICHITA, KS 67217
(316) 524-4622

INDEX OF SHEETS

1. TITLE SHEET
2. KEY MAP AND GENERAL NOTES
3. PLAT
4. TYPICAL PAVING SECTION-41' BK.-BK.
5. ENTRANCE TYPICAL SECTIONS
6. FOUR CORNER PLAN
7. SITE GRADING PLAN
- 8-12. PLAN/PROFILE-PAVING PLANS
13. VALLEY GUTTER PLAN
14. MISCELLANEOUS PAVING DETAILS
- 15-17. PLAN/PROFILE-SWS LINE NO. 1
18. PLAN/PROFILE-SWS LINE NO. 1A
19. PLAN/PROFILE-SWS LINE NOS. 1B AND 1C
20. PLAN/PROFILE-SWS LINE NOS. 1D AND 1E
21. STD. TYPE 1A CURB INLET (OPENING 5'-0")
22. STD. TYPE 1A CURB INLET (OPENING 10'-0")
23. PRECAST MANHOLE DETAILS
24. MANHOLE FRAME AND COVER DETAILS
25. RIPRAP AND MISCELLANEOUS DRAINAGE DETAILS
26. EROSION CONTROL PLAN
- 27-30. EROSION CONTROL DETAILS
31. SIGNING DETAILS
- 32-46. CROSS SECTIONS-STREET

EARTHWORK

EXCAVATION 7824 CU. YDS.
COMPACTED FILL 0 CU. YDS.
LOOSE FILL 578 CU. YDS.

PROJECT LENGTH = 2480 LIN. FT.

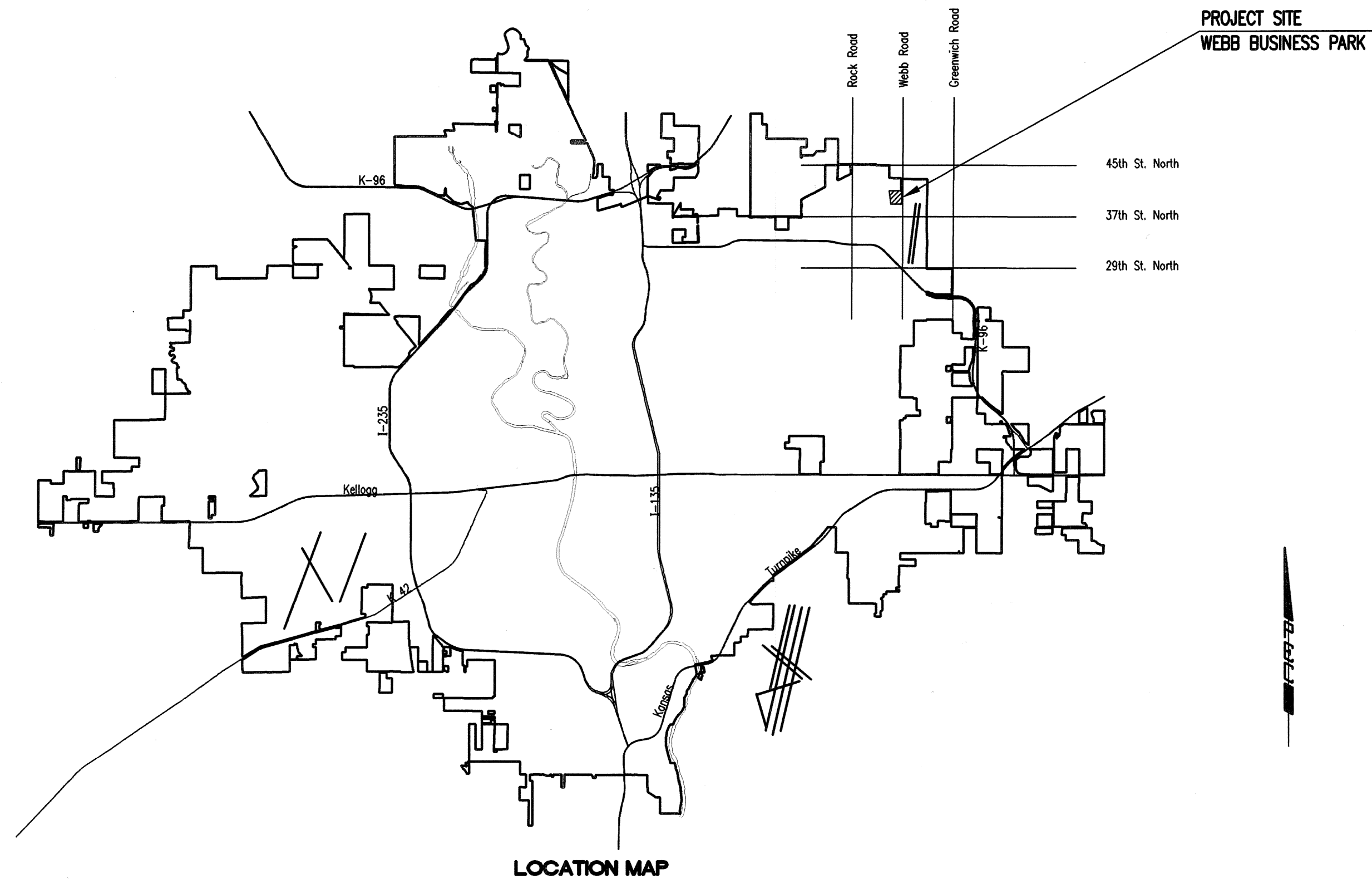

SUBDIVISION BENCH MARKS (SBM)				
NO.	STREET AND STATION	FROM C	DESCRIPTION	ELEVATION
1	TOBEN, STA. 13+78.40	20.50' LT.	P.T. OF CURVE	
2	TOBEN, STA. 17+88.40	20.50' LT.	P.C. OF CURVE	
3	40TH ST. N., STA. 22+67.49	20.50' LT.	P.T. OF CURVE	
4	40TH ST. N., STA. 28+94	20.50' LT.	NEXT TO INLET HOOKUP	
5	40TH ST. N., STA. 32+45.42	20.50' LT.	P.C. OF CURVE	

THE COST OF THE BENCH MARK DISC, INCLUDING INSTALLATION, SHALL BE INCIDENTAL TO THE CURB.

CONSTRUCTION SCHEDULE/SEQUENCE

THE CONTRACTOR FOR EACH OF THE FOLLOWING WEBB BUSINESS PARK PROJECTS SHALL COORDINATE THEIR EFFORTS WITH OTHER CONTRACTORS PERFORMING WORK IN THIS AREA SUCH THAT ANY NECESSARY SIMULTANEOUS CONSTRUCTION CAN PROCEED CONCURRENTLY WITHOUT CAUSING UNDUE DELAYS SO THAT CONSTRUCTION CAN BE COMPLETED WITHIN THE TIME FRAMES AS NOTED.

SANITARY SEWER (468-84430)
THE CONTRACTOR SHALL SEQUENCE HIS WORK TO COMPLETE, INCLUDING TESTING AND ACCEPTANCE, BY APRIL 30, 2008.

WATER DISTRIBUTION SYSTEM (448-90333)
THE CONTRACTOR SHALL COMPLETE WEBB BUSINESS PARK WATERLINE CONSTRUCTION BY MAY 16, 2008. THE CONTRACTOR SHALL COORDINATE INSTALLATION OF WATERLINES WITH THE STORM WATER DRAIN AND PAVING CONTRACTOR SO THAT STORM SEWERS CROSSING BELOW PROPOSED WATERLINES WILL BE INSTALLED PRIOR TO WATERLINE CONSTRUCTION.

STREETS/DRAINAGE (472-84611)
THE CONTRACTOR SHALL COMPLETE WEBB BUSINESS PARK STREETS CONSTRUCTION BY JULY 18, 2008.

STORM WATER DRAINAGE (468-84431)
THE CONTRACTOR SHALL COMPLETE WEBB BUSINESS PARK MASS GRADING CONSTRUCTION BY JUNE 4, 2008.

APRIL 2008

PLANS PREPARED BY
PROFESSIONAL ENGINEERING CONSULTANTS, P.A.
ENGINEERS
WICHITA, KANSAS

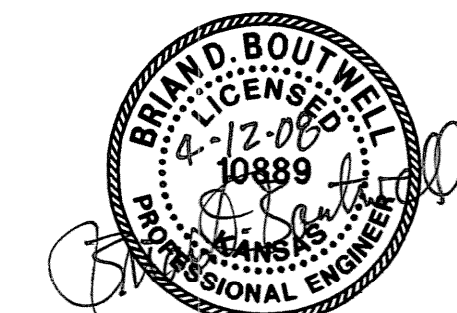

Saved 04-12-2008 10:47:46 AM by: BUS
 Plot Scale 1:1 04-12-2008 10:48:21 AM
 C:\2007\07593\000\07593-000-C-STRTITLE