

WATER VALVE BOX ELEVATIONS			
STREET	STATION	OFFSET	PROPOSED ELEVATION
TOBEN STREET	20+20.03	29.0' Rt.	216.4
40th St. N.	24+97.86	29.0' Rt.	221.4

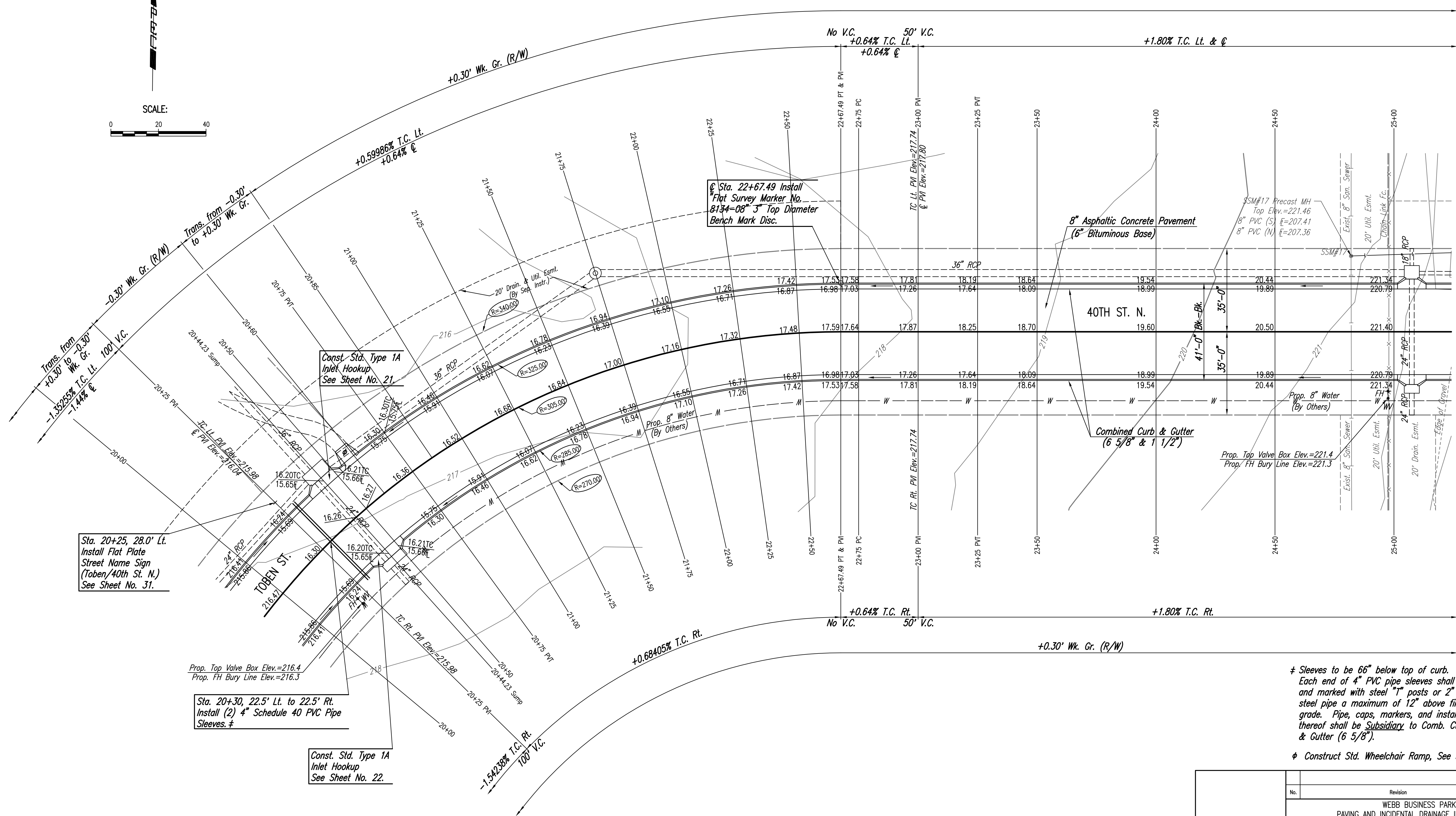
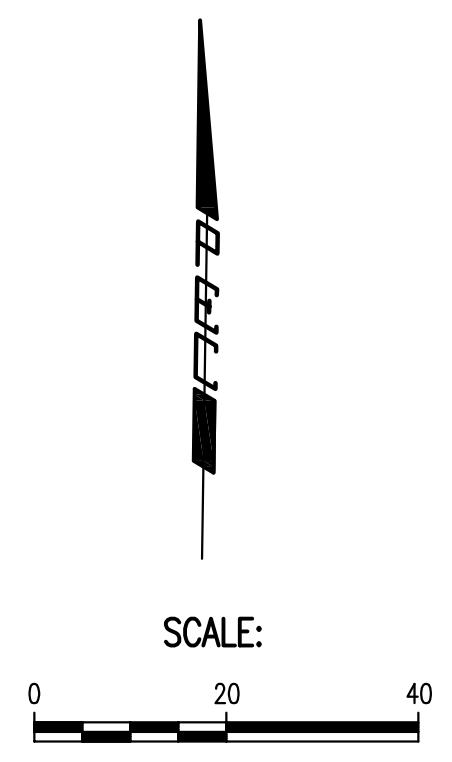

Sta. 20+25, 28.0' Lt.
Install Flat Plate
Street Name Sign
(Toben/40th St. N.)
See Sheet No. 31.

Prop. Top Valve Box Elev.=216.4
Prop. FH Bury Line Elev.=216.3

Sta. 20+30, 22.5' Lt. to 22.5' Rt.
Install (2) 4" Schedule 40 PVC Pipe
Sleeves. ‡

Const. Std. Type 1A
Inlet Hookup
See Sheet No. 22.

‡ Sta. 22+67.49 Install
Flat Survey Marker No.
8134-08 3" Top Diameter
Bench Mark Disc.

8" Asphaltic Concrete Pavement
(6" Bituminous Base)

Combined Curb & Gutter
(6 5/8" & 1 1/2")

S.S.M.#17 Precast MH
Top Elev.=221.46
8" PVC (S) E=207.41
8" PVC (N) E=207.36

Prop. 8" Water
(By Others)

Prop. Top Valve Box Elev.=221.4
Prop. FH Bury Line Elev.=221.3

‡ Sleeves to be 66" below top of curb.
Each end of 4" PVC pipe sleeves shall be capped
and marked with steel "T" posts or 2" dia.
steel pipe a maximum of 12" above finished
grade. Pipe, caps, markers, and installation
thereof shall be Subsidiary to Comb. Curb
& Gutter (6 5/8").

‡ Construct Std. Wheelchair Ramp, See Sheet No. 14

Sowed 04-12-2008 10:19:00 AM by BJS
 Plot Scale 1:20 04-14-2008 8:05:12 AM
 C:\2007\07593\000\07593-000-C-51A.2000-2500

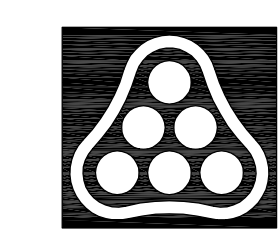

No.	Revision	By	Date
WEBB BUSINESS PARK PAVING AND INCIDENTAL DRAINAGE IMPROVEMENTS PAVING PLAN STA. 20+00 TO STA. 25+00 JAMES L. ARMOUR, P.E. - CITY ENGINEER CITY OF WICHITA PROJECT NO. 472-84611 Professional Engineering Consultants, P.A. 303 S. TOPEKA • WICHITA, KANSAS 67202 316-262-2691 • FAX 316-262-3003			
Designed by	BMM	Job No.	35-07593-000
Drawn by	BJS, TAT	Date	June 2007
			Sheet 10 of 46