

A = 35°36'30" L = 233.06' R = 375.00' T = 120.43'

STATION	CURVE TABLE BASED ON CL RADIUS		CHORD LENGTH		DEFLECTION		TOTAL DEFLECTION
	CL ARC	8' LT.	8' RT.	DEFLECTION	DEFLECTION		
2+47.37 P.C.C.							
2+50.00	2.63'	2.78'	2.63'	2.48'	0°12'03"		0°12'03"
2+75.00	25.00'	26.46'	25.00'	23.53'	1°54'35"		2°06'39"
3+00.00	25.00'	26.46'	25.00'	23.53'	1°54'35"		4°01'14"
3+25.00	25.00'	26.46'	25.00'	23.53'	1°54'35"		5°55'50"
3+50.00	25.00'	26.46'	25.00'	23.53'	1°54'35"		7°50'25"
3+75.00	25.00'	26.46'	25.00'	23.53'	1°54'35"		9°45'01"
4+00.00	25.00'	26.46'	25.00'	23.53'	1°54'35"		11°39'36"
4+25.00	25.00'	26.46'	25.00'	23.53'	1°54'35"		13°34'12"
4+41.16	16.16'	17.11'	16.16'	15.21'	1°14'04"		14°48'16"
4+45.35	4.79'	5.07'	4.79'	4.51'	0°21'57"		15°10'13"
4+50.00	4.05'	4.29'	4.05'	3.81'	0°18'34"		15°28'47"
4+75.00	25.00'	26.46'	25.00'	23.53'	1°54'35"		17°23'23"
4+80.43 P.T.	5.43'	5.74'	5.43'	5.11'	0°24'52"		17°48'15"
DEFLECTION/FOOT = .076394373 DEGREES					4.583662361 MINUTES		

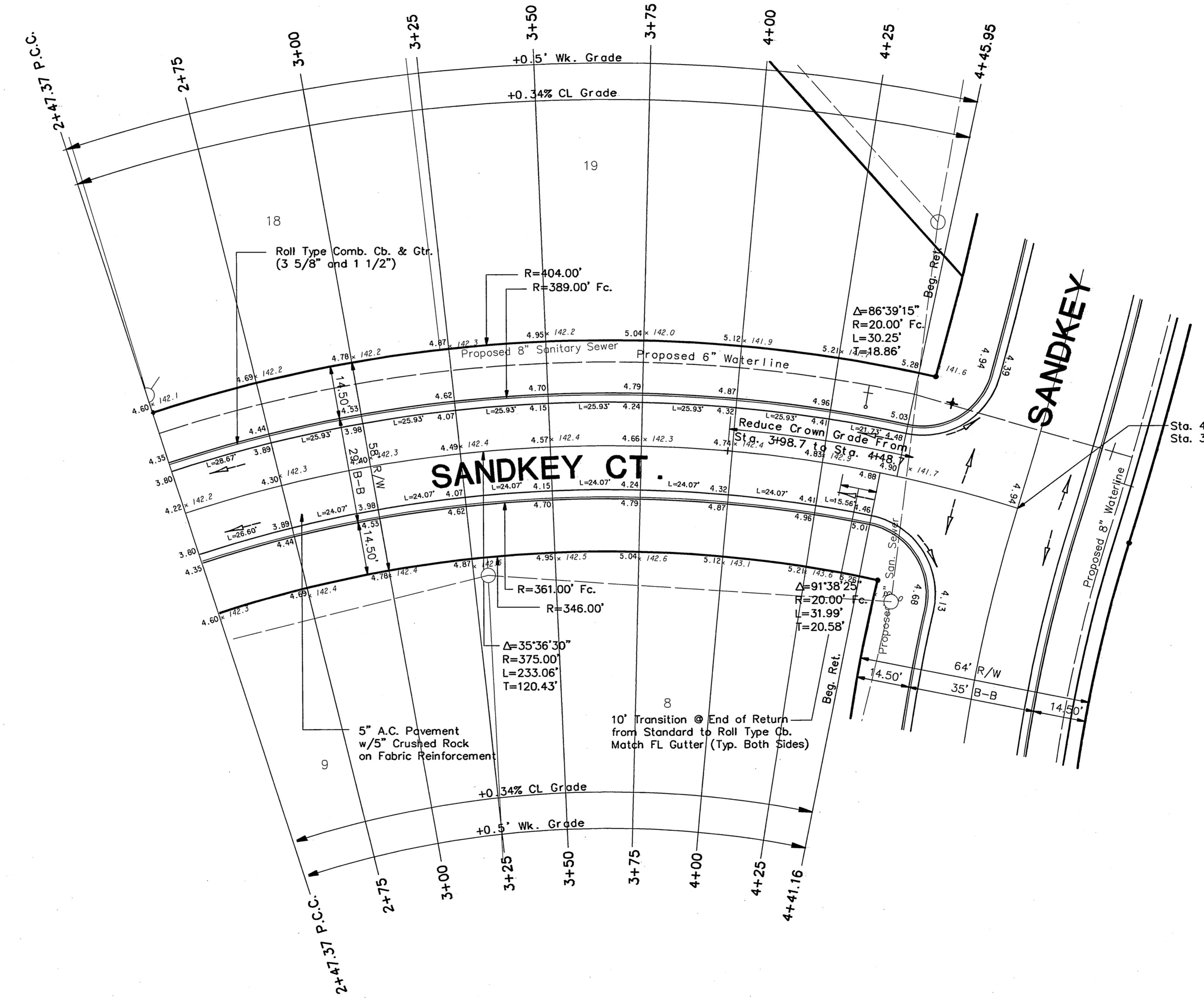

Sta. 4+80.42 CL Sandkey Ct. =
Sta. 32+44.32 CL Sandkey

STREET IMPROVEMENTS MORINGS NORTH ADDITION CITY OF WICHITA, KANSAS MICHAEL E. LINDEBAK, P.E. - CITY ENGINEER Project No. 468-82879 Index Code 764654	
POE & ASSOCIATES OF KANSAS, INC. CONSULTING ENGINEERS 5940 E. Central, Suite 200 Wichita, KS 67208 316/685-4114 Fax 316/685-4444	
DESIGNED BY: G. Miles	DRAWN BY: S. Schmidt
POE JOB NO.: 1665B	
DATE: June 1998	
Sheet	
17 of 48	

NOTE:
All top of curb grades are to top of combined curb and gutter. 0.25' must be subtracted from top of curb elevations for top of roll curb.