

BENCHMARKS:

135th St. W. & Pawnee—
City of Wichita Benchmark
Disc on SW Corner of
Concrete Base of High Line
Pole.
Elev. = 1359.65 NGVD29

119th St. W. & Pawnee—
City of Wichita Benchmark
Disc 0.5 miles S of Kellogg.
42.2' E of centerline & 6.4'
S of Power Pole.
Elev. = 1332.09 MSL

Scale: 1" = 20'
• = Iron

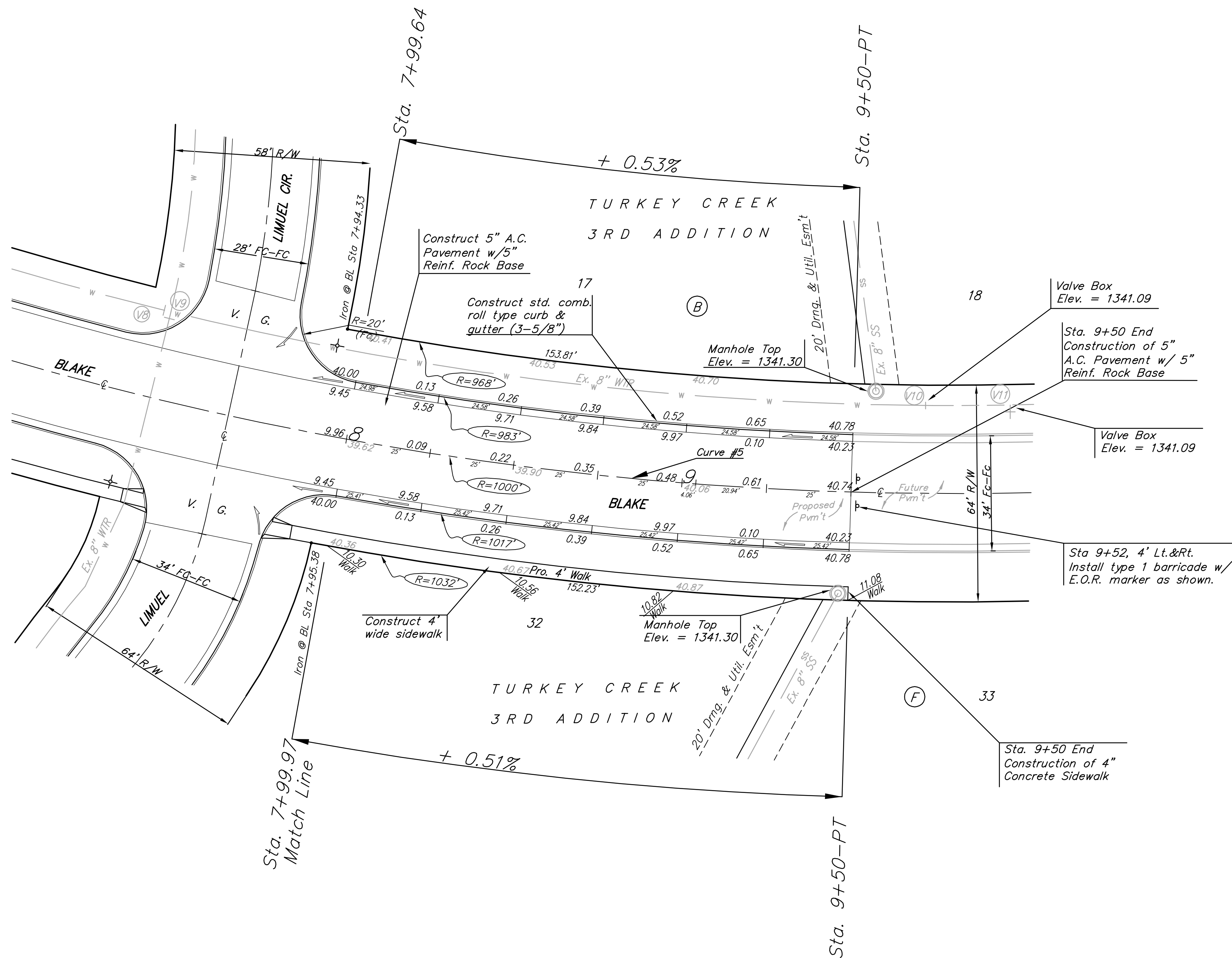

Curve #5
Curve Data Based on Centerline
Rad. = 1000' Delta = 50°00'01" Tangent = 466.31'
Arc = 448.48' L.C. = 845.24' Def./Ft. = 3.34465 Min.

Station	Face Chord Lengths			
	Arc	6' Left	Defl.	Total Defl.
5+04.75	-	-	0'00'00"	0'00'00"
5+25.00	20.25'	39.16'	1'07'44"	1'07'44"
5+50.00	25.00'	48.35'	1'23'37"	2'31'21"
5+75.00	25.00'	48.35'	1'23'37"	3'54'58"
6+00.00	25.00'	48.35'	1'23'37"	5'18'35"
6+25.00	25.00'	48.35'	1'23'37"	6'42'12"
6+50.00	25.00'	48.35'	1'23'37"	8'05'49"
6+75.00	25.00'	48.35'	1'23'37"	9'29'26"
7+00.00	25.00'	48.35'	1'23'37"	10'53'03"
7+25.00	25.00'	48.35'	1'23'37"	12'16'40"
7+28.50	3.50'	6.77'	0'11'42"	12'28'22"
7+29.00	0.50'	0.97'	0'01'40"	12'30'02"
7+50.00	21.00'	40.61'	1'10'15"	13'40'17"
7+64.37	14.37'	27.79'	0'48'03"	14'28'20"
7+75.00	10.63'	20.56'	0'35'33"	15'03'53"
7+99.64	24.64'	47.65'	1'22'25"	16'26'18"
7+99.97	0.33'	0.64'	0'01'06"	16'27'24"
8+00.00	0.03'	0.06'	0'00'06"	16'27'30"
8+25.00	25.00'	48.35'	1'23'37"	17'51'07"
8+50.00	25.00'	48.35'	1'23'37"	19'14'44"
8+75.00	25.00'	48.35'	1'23'37"	20'38'21"
9+00.00	25.00'	48.35'	1'23'37"	22'01'58"
9+25.00	25.00'	48.35'	1'23'37"	23'25'35"
9+50.00	25.00'	48.35'	1'23'37"	24'49'12"

Subdivision Bench Marks

Street & Station	Location Description	Elevation
Wheatland 3+63.01, 17.25' Lt.	Adjacent to Fire Hydrant at the east lot line of Lot 4 and Lot 5 on the E. End of Wheatland.	
Wheatland 11+11.75, 17.25' Lt.	Adjacent to Fire Hydrant at the east lot line of Lot 27 and Lot 28 on the W. End of Wheatland.	
Limuel 3+24.56, 17.77' Rt.	Adjacent to Fire Hydrant at the south lot line of 17 on the E. end of Limuel.	
Limuel Cir. 1+91.49, 14.25' Lt.	Adjacent to Fire Hydrant at the east lot line of Lot 15 and Lot 16 on the W. end of Limuel Cir.	
Wheatland Ct. 1+21.93, 14.25' Lt.	Adjacent to Fire Hydrant at the east lot line of Lot 137 and Lot 138 on the W. end of Wheatland Ct.	

WATER VALVE LOCATION TABLE

VALVE NUMBER	BASELINE STATION	OFFSET DISTANCE	OFFSET DIRECTION
V10	9+71.83	26'	Lt.
V11	9+97.50	26'	Lt.

Paving contractor will be responsible to operate all water valves on the project, in the presence of the inspector, to ensure accessibility to the valves, and that all valves are left in the "ON" position when the project is completed.

NOTE: ROLL TYPE CURB & GUTTER TO BE CONSTRUCTED ON THE PAVEMENT SHOWN ON THIS SHEET. TOP OF CURB ELEVATIONS ARE GIVEN FOR FULL HEIGHT CURB.

Baughman Turkey Creek 3rd Addition - Phase I
Blake
Sta. 7+99.97 to 9+50

Baughman Company, P.A. 315 Ella St. Wichita, KS 67211 F 316-262-7271 F 316-262-0149
ENGINEERING | SURVEYING | PLANNING | LANDSCAPE ARCHITECTURE

PROJECT NUMBER: 472-84486
DESIGN: MWS
DRAWN: JRW

REVISIONS:
APPROVED: MWS
DATE: 08/07

SCALE: Noted
SHEET: 11 OF 54

E:\Turkey creek 3rd\Phase 1\07-15-Str.dwg 07-07-E892