

**BENCHMARKS:**

135th St. W. & Pawnee—  
City of Wichita Benchmark  
Disc on SW Corner of  
Concrete Base of High Line  
Pole.  
Elev. = 1359.65 NGVD29

119th St. W. & Pawnee—  
City of Wichita Benchmark  
Disc 0.5 miles S of Kellogg.  
42.2' E of centerline & 6.4"  
S of Power Pole.  
Elev. = 1332.09 MSL

Scale: 1" = 20'  
• = Iron

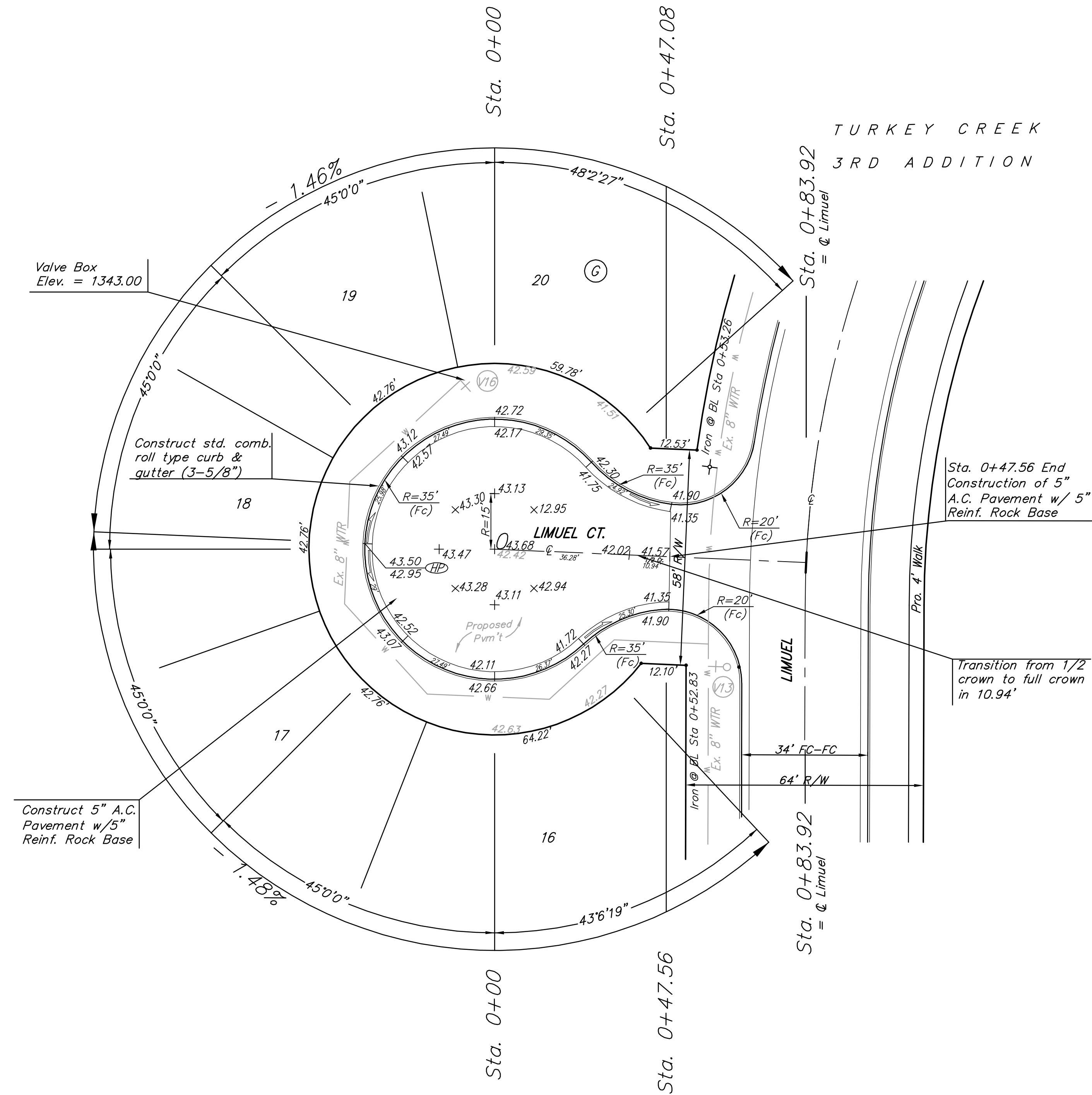

**WATER VALVE LOCATION TABLE**

VALVE NUMBER	BASELINE STATION	OFFSET DISTANCE	OFFSET DIRECTION
V16	-0+11.17	45.00'	Lt.

Paving contractor will be responsible to operate all water valves on the project, in the presence of the inspector, to ensure accessibility to the valves, and that all valves are left in the "ON" position when the project is completed.

**NOTE:** ROLL TYPE CURB & GUTTER TO BE CONSTRUCTED ON THE PAVEMENT SHOWN ON THIS SHEET. TOP OF CURB ELEVATIONS ARE GIVEN FOR FULL HEIGHT CURB.

	Turkey Creek 3rd Addition - Phase I
	Limuel Ct. Sta. 0+00 to 0+47.56
<small>Baughman Company, P.A. 315 Ella St. Wichita, KS 67211 F 316-262-7271 F 316-262-0149 ENGINEERING   SURVEYING   PLANNING   LANDSCAPE ARCHITECTURE</small>	
PROJECT NUMBER 472-84486	DESIGN MWS DRAWN JRW
REVISIONS:	APPROVED MWS DATE 08/07
	SCALE Noted SHEET
	<b>13 OF 54</b>
<small>E:\Turkey creek 3rd\Phase 1\07-15-Str.dwg 07-07-E892</small>	