

BENCHMARKS:

135th St. W. & Pawnee—
City of Wichita Benchmark
Disc on SW Corner of
Concrete Base of High Line
Pole.
Elev. = 1359.65 NGVD29

119th St. W. & Pawnee—
City of Wichita Benchmark
Disc 0.5 miles S of Kellogg.
42.2' E of centerline & 6.4"
S of Power Pole.
Elev. = 1332.09 MSL

Scale: 1" = 20'
• = Iron

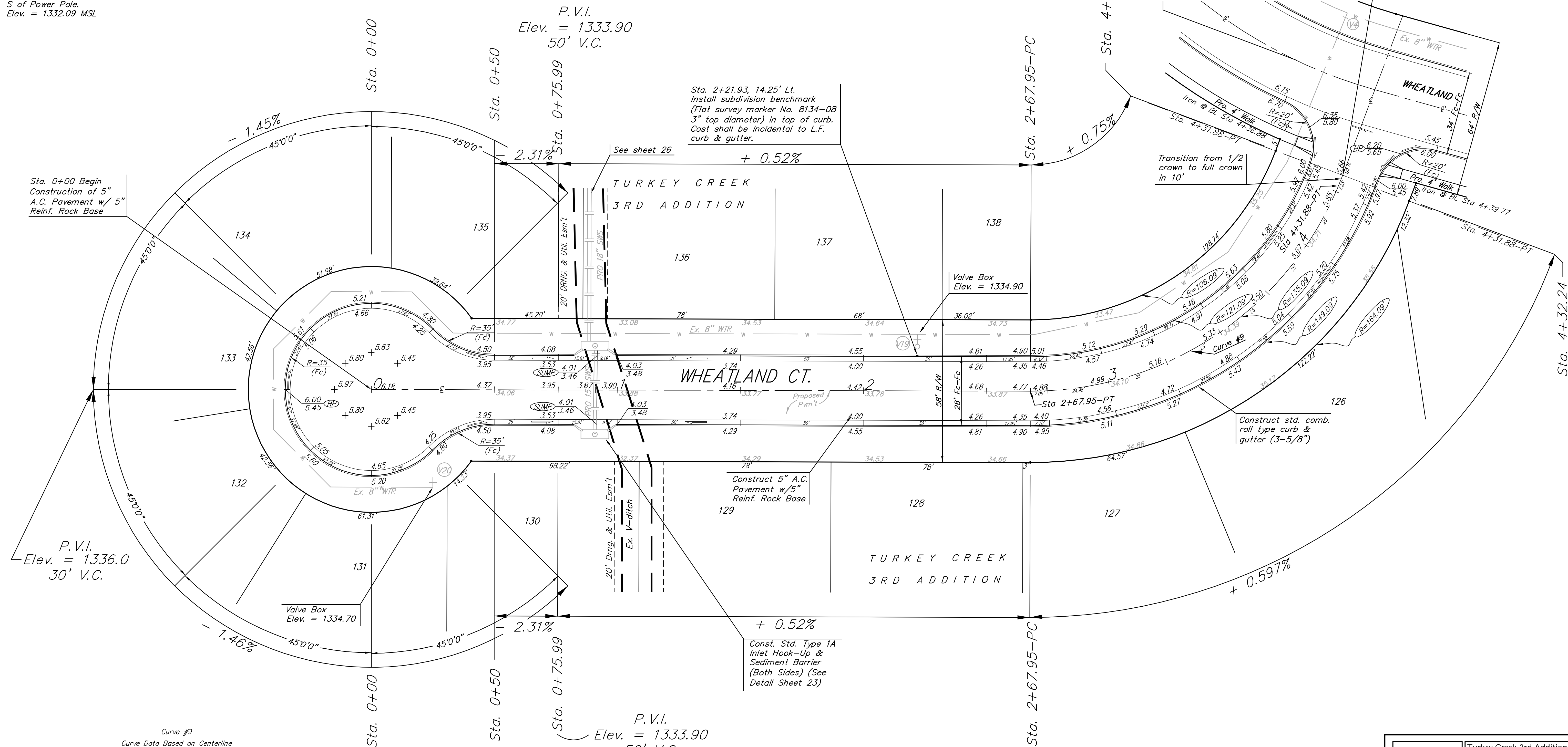

Curve #9
Curve Data Based on Centerline
Rad. = 135.09' Delta = 69°31'32" Tangent = 93.76'
Arc = 163.93' L.C. = 154.05' Def./Fl. = 12.72352 Min.

Station	Arc	6' Left	6' Right	Defl.	Total Defl.
2+67.95	-	-	-	0°00'00"	0°00'00"
2+75.00	7.05'	6.74'	7.36'	1°29'42"	1°29'42"
3+00.00	25.00'	23.85'	26.07'	5°18'05"	6°47'47"
3+25.00	25.00'	23.85'	26.07'	5°18'06"	12°05'53"
3+50.00	25.00'	23.85'	26.07'	5°18'05"	17°23'58"
3+75.00	25.00'	23.85'	26.07'	5°18'05"	22°42'03"
4+00.00	25.00'	23.85'	26.07'	5°18'05"	28°00'08"
4+25.00	25.00'	23.85'	26.07'	5°18'06"	33°18'14"
4+31.88	6.88'	6.57'	7.18'	1°27'32"	34°45'46"

WATER VALVE LOCATION TABLE

VALVE NUMBER	BASELINE STATION	OFFSET DISTANCE	OFFSET DIRECTION
V19	2+21.93	23.00'	Lt.
V20	0+25.12	39.73'	Rt.

Paving contractor will be responsible to operate all water valves on the project, in the presence of the inspector, to ensure accessibility to the valves, and that all valves are left in the "ON" position when the project is completed.

NOTE:
ROLL TYPE CURB & GUTTER TO BE CONSTRUCTED ON THE PAVEMENT SHOWN ON THIS SHEET. TOP OF CURB ELEVATIONS ARE GIVEN FOR FULL HEIGHT CURB.

	Turkey Creek 3rd Addition - Phase I
	Wheatland Ct. Sta. 0+00 to 4+32.24
<small>Baughman Company, P.A. 315 Ella St. Wichita, KS 67211 P 316-262-7271 F 316-262-0149 ENGINEERING SURVEYING PLANNING LANDSCAPE ARCHITECTURE</small>	
PROJECT NUMBER 472-84486	DESIGN MWS DRAWN JRJV
REVISIONS:	APPROVED MWS DATE 08/07
SCALE Noted SHEET <h1 style="margin: 0;">15 OF 54</h1>	
<small>E:\Turkey creek 3rd\Phase 1\07-15-Str.dwg 07-07-E992</small>	