

PLAN	CHECKED	CHECKED	BY	DATE
------	---------	---------	----	------

PROFILE	CHECKED	CHECKED	BY	DATE
---------	---------	---------	----	------

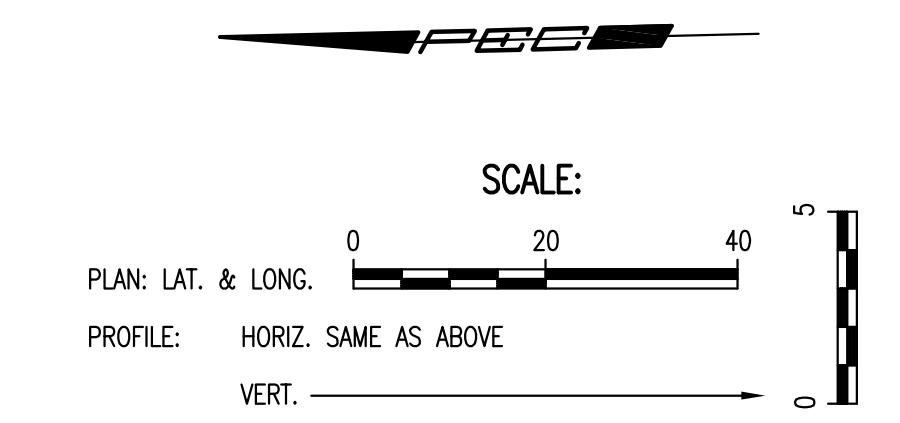
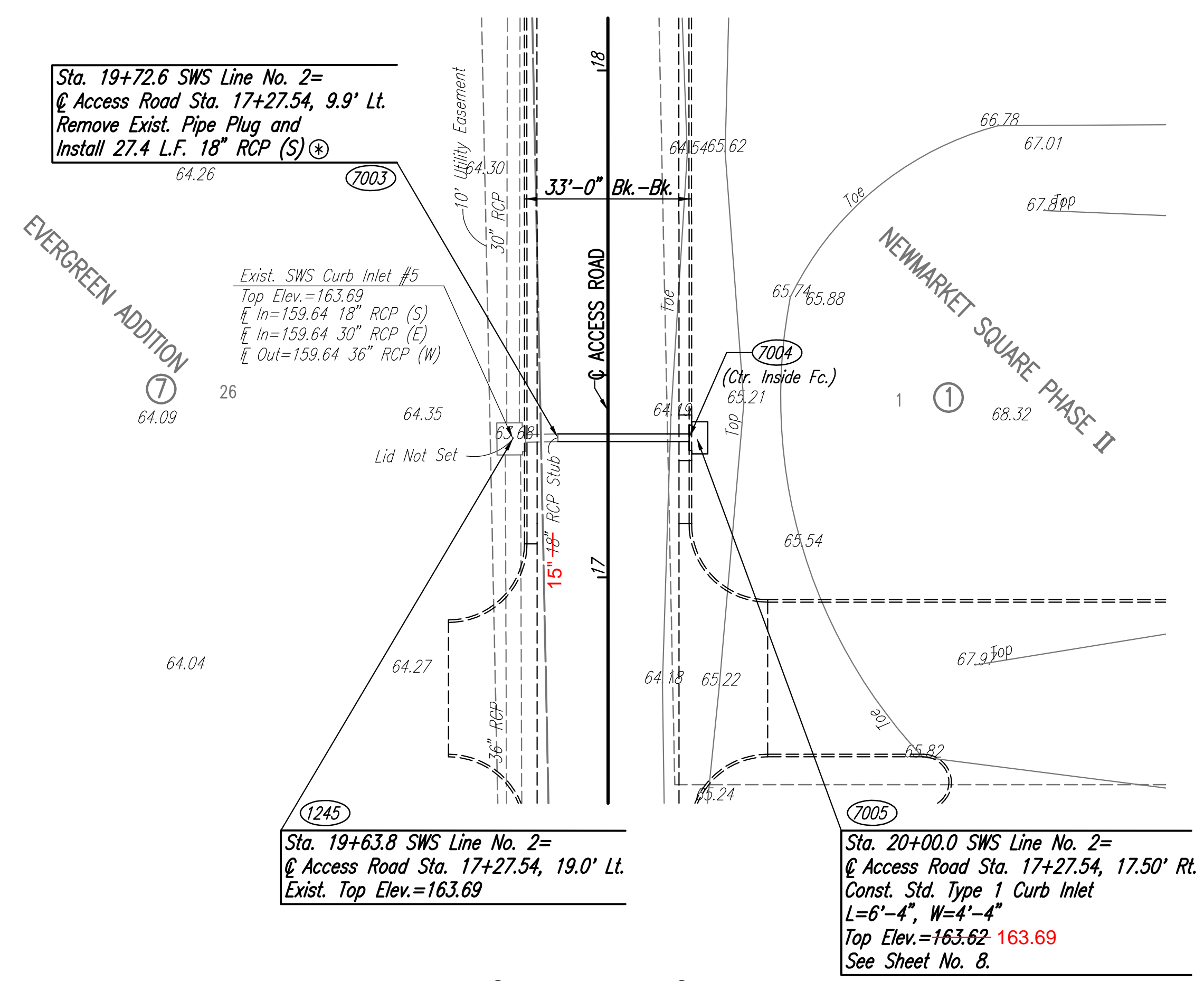

COORDINATE LIST		
POINT	NORTH	EAST
1245	7,406.5238	4,413.6002
7003	7,397.6412	4,413.5947
7004	7,371.7740	4,412.9728
7005	7,370.2745	4,412.9368

Ⓢ PRIOR TO BEGINNING CONSTRUCTION, THE CONTRACTOR SHALL EXCAVATE THE EXISTING 18" RCP AT STATION 19+72.6 TO VERIFY PIPE SIZE, TYPE, AND HORIZONTAL AND VERTICAL LOCATION. THE CONTRACTOR SHALL REPORT HIS FINDINGS TO THE ENGINEER SO THAT ANY NECESSARY PLAN MODIFICATIONS MAY BE MADE. ANY ADDITIONAL LABOR OR MATERIALS NECESSARY TO COMPLETE THE CONNECTION SHALL BE CONSIDERED SUBSIDIARY TO THE PROJECT.

ASBUILT - MAY 1, 2008

Saved: 02-19-2008 2:49:18 PM by: BJS  
 Plot Scale: 1/20 02-19-2008 3:44:42 PM by: BJS  
 C:\2007\07448\001\Site Civil\ACCESS ROAD\PRIVATE SWS\07448-001-C-SWS LINE 2

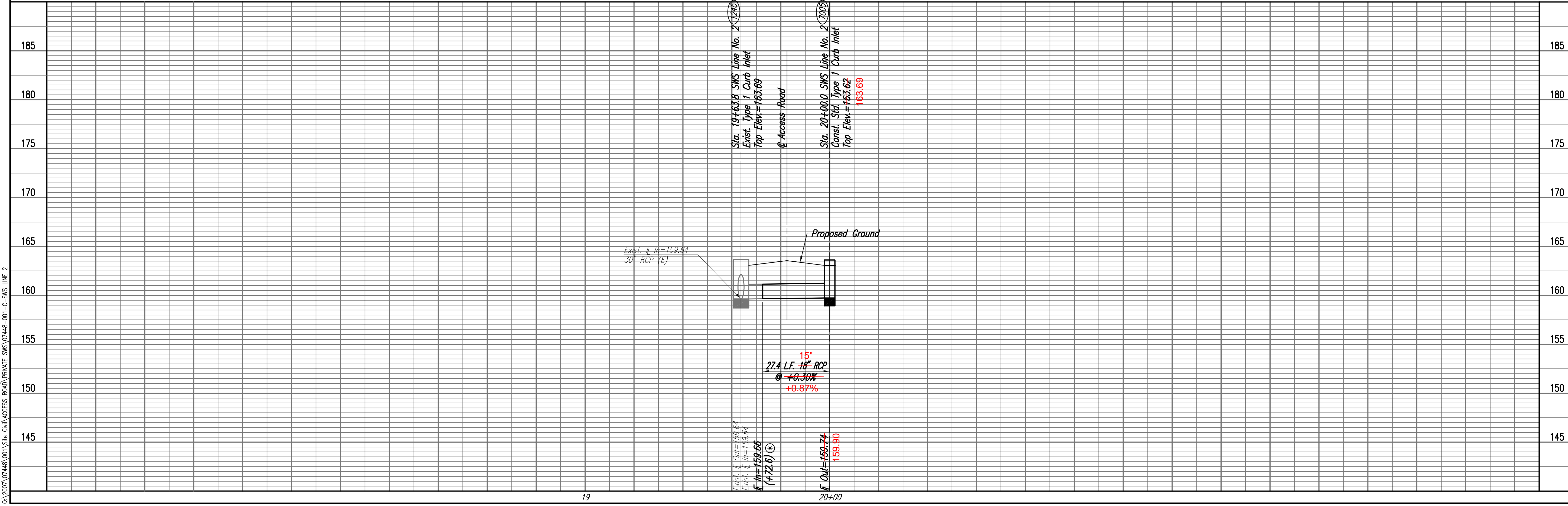

Professional Engineering Consultants, P.A.  
 303 S. TOPEKA, WICHITA, KANSAS 67202  
 316-262-2091 • FAX 316-262-3003

Job No. 35-07448-001 Date August 2007  
 Designed By BMM Drawn By BUS, FAT

NEWMARKET SQUARE-PHASE 2  
 PRIVATE STORM WATER SEWER IMPROVEMENTS  
**SWS LINE NO. 2**  
 JAMES L. ARMOUR, P.E. - CITY ENGINEER  
 CITY OF WICHITA PRIVATE PROJECT NO. 1830 PPS (607861)

Sheet 7 of 13