

STA. 10+65.7, LINE 1 =
REMOVE EXIST. 30" END
SECTION AND RIPRAP
CONST. 5' DIA. TYPE A
SHALLOW MANHOLE
MANHOLE TOP=1344.9

NOTES:
CONTRACTOR TO VERIFY THE
DEPTH AND LOCATION OF
EXISTING UTILITIES PRIOR TO
CONSTRUCTION.

PLAN LINE 1

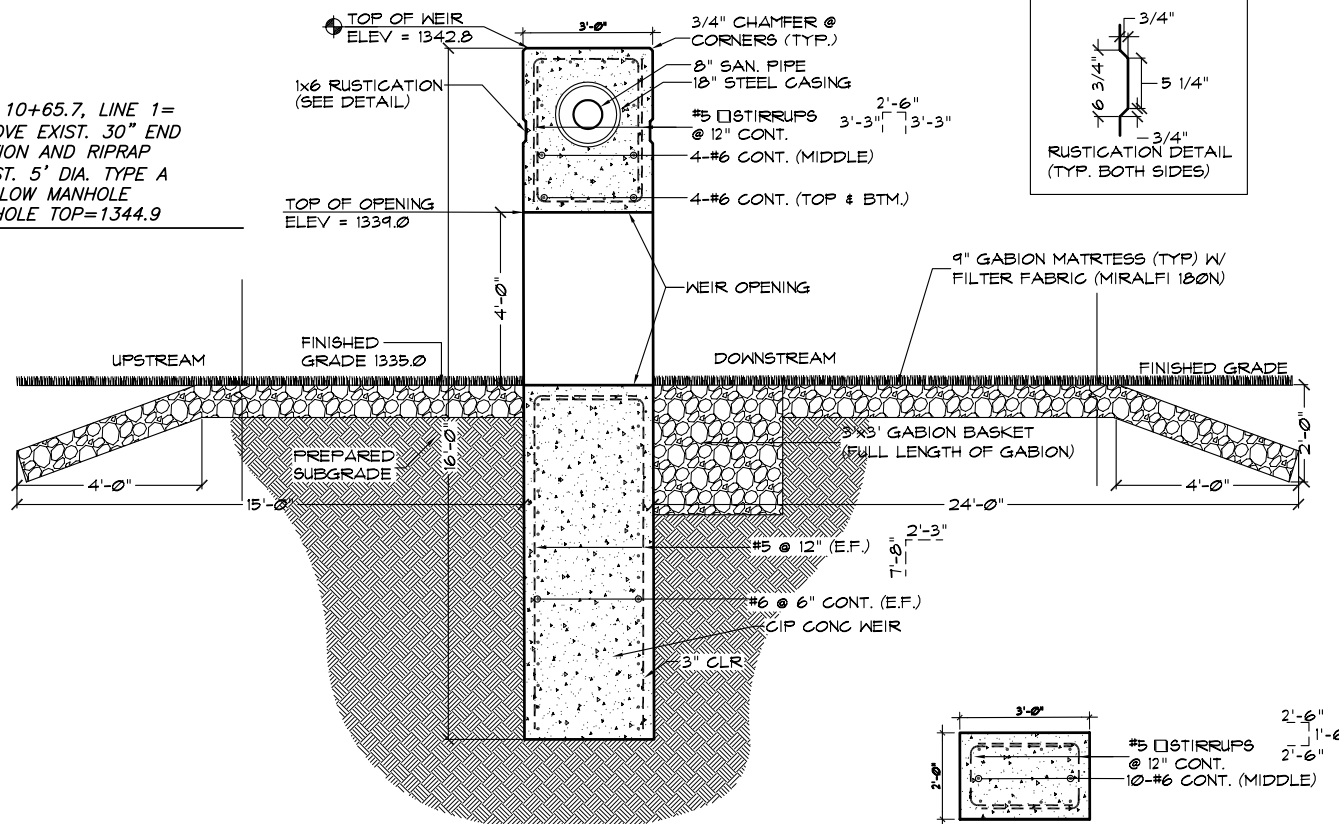

1 SECTION A
SCALE: 3/4" = 1'-0"

1 SECTION B
SCALE: 3/4" = 1'-0"

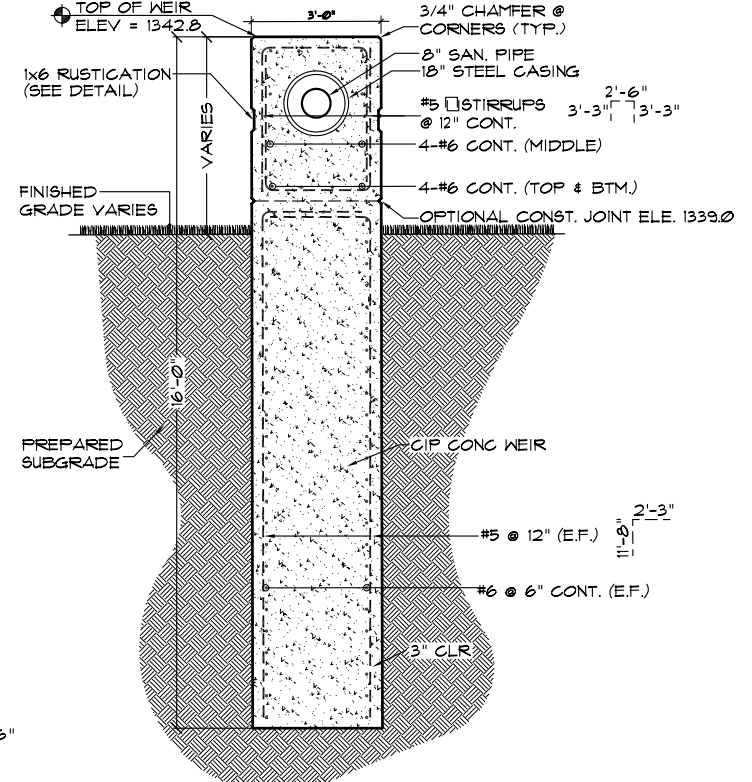

1 SECTION C
SCALE: 3/4" = 1'-0"

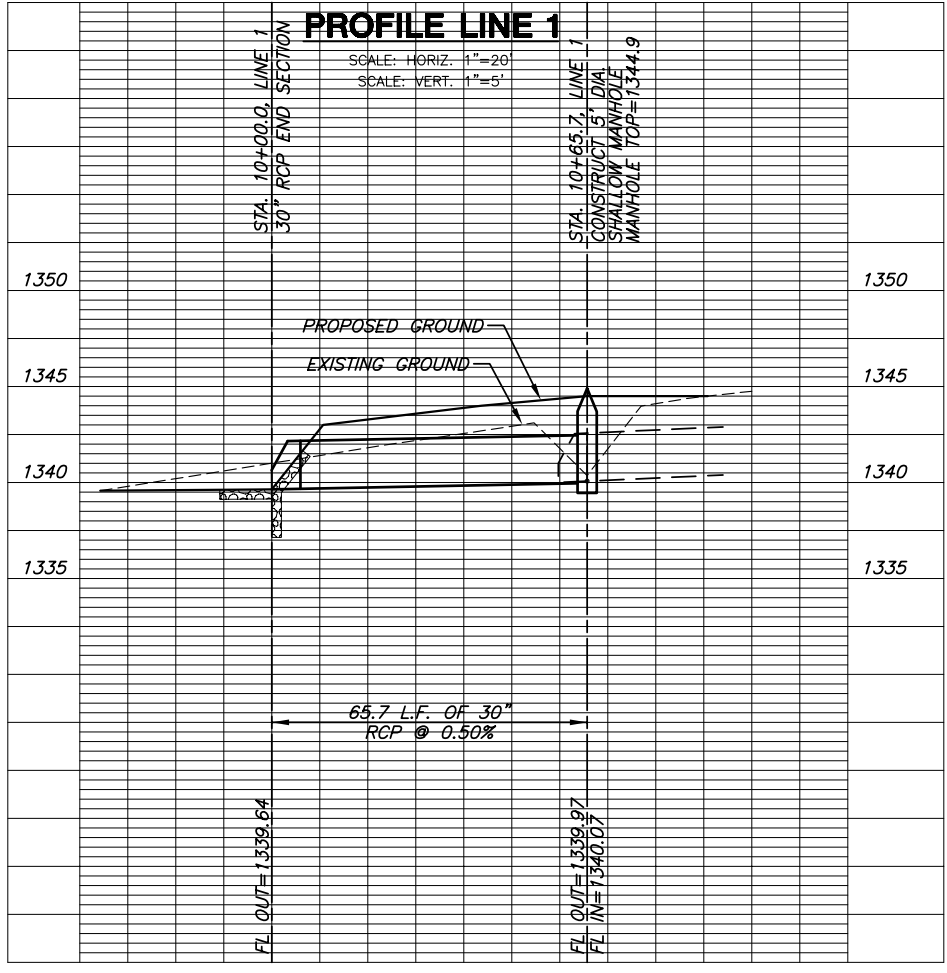

PROFILE LINE 1

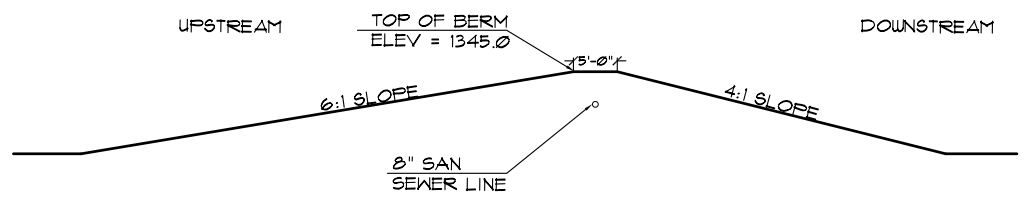

1 BERM SECTION D
SCALE: N/A

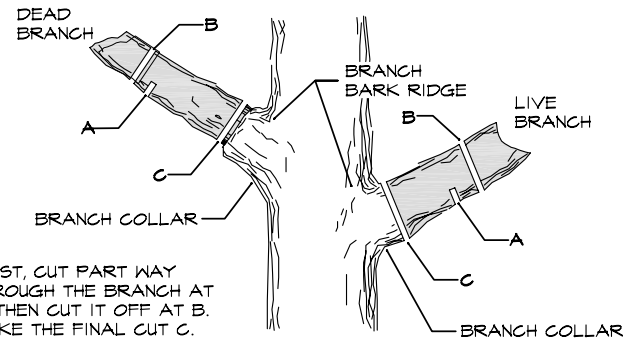

TREE TRIMMING DETAIL
NOT TO SCALE

GENERAL NOTES

- 1) CONCRETE SHALL HAVE A MINIMUM COMPRESSIVE STRENGTH OF 4,000 PSI AT 28 DAYS. CONTRACTOR SHALL SUBMIT CONCRETE MIX DESIGN TO ENGINEER FOR APPROVAL PRIOR TO CONSTRUCTION.
- 2) CONCRETE SHALL CONFORM TO THE CURRENT "ACI MANUAL OF CONCRETE PRACTICE".
- 3) CONCRETE COVER SHALL BE 3" IN BOTTOM OF FOOTING CAST AGAINST SOIL. ALL OTHER COVER SHALL BE 2".
- 4) PORTLAND CEMENT SHALL CONFORM TO ASTM C-150, TYPE I OR III.
- 5) AGGREGATE FOR NORMAL WEIGHT CONCRETE SHALL MEET ASTM C33.
- 6) REINFORCING SHALL MEET ASTM A615 OR GR 60.
- 7) FOOTINGS SHALL BEAR ON UNDISTURBED EARTH OR ENGINEERED FILL AT ELEVATIONS SHOWN ON DETAILS.
- 8) EARTHWORK SHALL BE CONSIDERED SUBSIDIARY TO HEADWALL CONSTRUCTION.
- 9) REBAR ANY SPLICES SHALL HAVE A 30 BAR DIA. OVERLAP.
- 10) GABIONS GABIONS AND MATTRESSES SHALL BE PVC COATED.
- 11) FILTER FABRIC GEOTEXTILE FILTER FABRIC SHALL BE TREVIRA SPUNBOUND # 1120 OR APPROVED EQUAL.

WEIR WALL
SHEET TITLE
468-84321
PROJECT NUMBER

DESIGN BY: MLP
DRAWN BY: MLP
CHECKED BY: GJA

ISSUED: February 2007
REVISED:

SHEET NO.
6 of 31