

Note A: Coordinate installation of storm sewer pipe and rip-rap in the pond with Regency Lakes Shopping Center Developer. (Contact George Laham, 292-3950)

STORM WATER SEWER LINE NO. 1

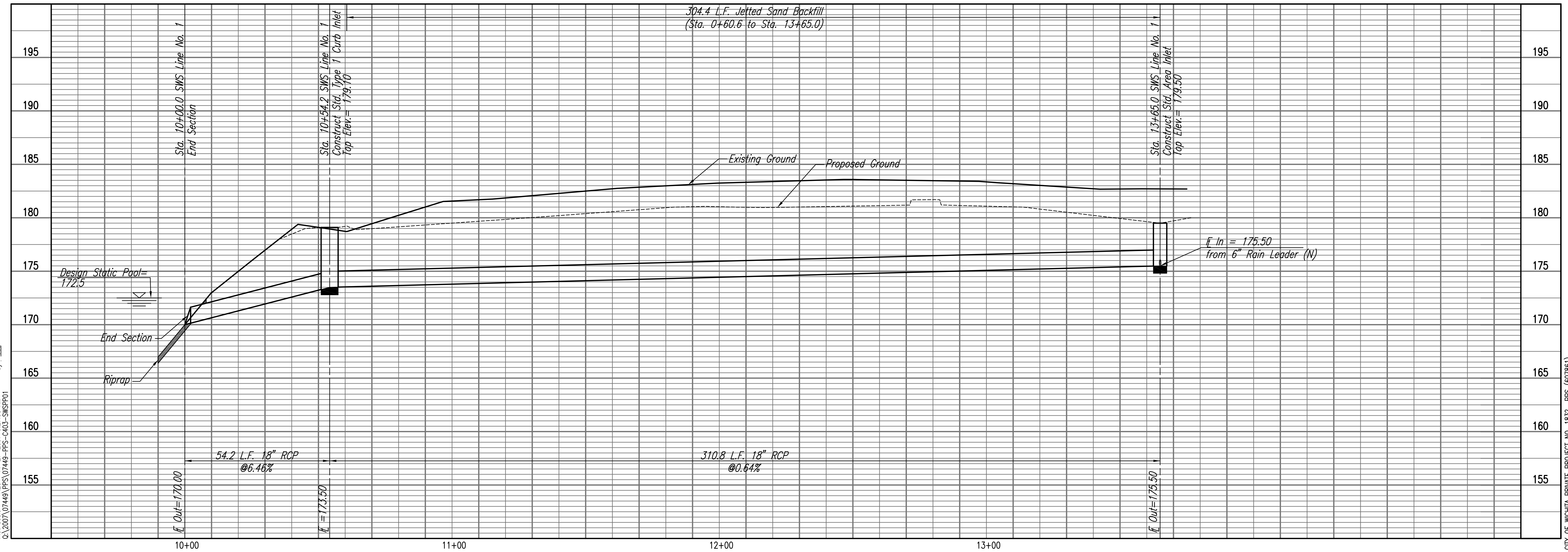

Saved 11-27-2007 8:33:16 AM by CSL  
 Proj. Scale: 1" = 20'-0"  
 2:20:07 (07/49) PPS (07/49) PPS-C403-303P001

NO.	ISSUED	DATE
3	PURPOSE	11-01-07
3	FOR PERMIT	11-21-07
	City of Wichita Private Plans	

**BROWNING & ASSOCIATES**  
 ARCHITECTURE  
 1305 E. WATERMAN, SUITE - B  
 WICHITA, KANSAS 67211  
 TEL 1-316-269-9001 FAX 1-316-269-9005

**Hampton Inn & Suites**  
 100 ROOM HOTEL  
 LOTS 7 & 8, BLOCK 1  
 REGENCY LAKES  
 COMMERCIAL 2ND  
 WICHITA, KANSAS  
 PROJECT NO. 0702-296-472

DRAWN	CHECKED
C&L	DK
SHEET TITLE	
STORM WATER SEWER LINE PLAN/PROFILE	
SHEET NUMBER	
C-403	
OF _____ SHEETS	

Professional Engineering Consultants, P.A.  
 803 S. TORREY, WICHITA, KANSAS 67202 - 316 262 2091  
 www.pcc.com • dfr.guerr@pcc.com

CITY OF WICHITA PRIVATE PROJECT NO. 1832 PPS (607861)