

PLACE 23 S.Y. HEAVY STONE RIP RAP AT OUTLET OF EXIST CULVERT AND 70 S.Y. NORTH AMERICAN GREEN P300 TURF REINFORCEMENT MAT OR APPROVED EQUAL.

PROP. CONCRETE WEIR. SEE DETAIL SHEET 6.

POND 1
 STATIC W.S. EL. = 1307.0
 100-YR W.S. EL. 1308.0
 NO-DESIGNED DETENTION

POND 2
 PEAK INFLOW = 148.9 CFS
 PEAK OUTFLOW = 128.6 CFS
 STATIC W.S. EL. = 1304.0
 100-YR W.S. EL. 1307.2

Point Table			
Point #	Northing	Easting	Desc
200	19211.63	20099.31	POND
201	19192.05	20064.41	
202	19151.39	20093.35	
203	19112.67	20117.83	
204	19045.91	20128.90	
205	19051.62	20196.82	
206	19108.17	20248.08	
207	19152.84	20209.09	
208	19182.25	20170.86	
209	19222.60	20143.66	
210	19015.18	20232.11	
211	18982.40	20265.90	
212	18934.80	20273.76	
213	18891.56	20287.06	
214	18838.15	20303.85	
215	18784.48	20322.25	
216	18772.62	20382.41	
217	18811.30	20424.81	
218	18864.80	20461.13	
219	18894.01	20450.62	
220	18905.27	20405.41	
221	18949.59	20391.61	
222	18996.17	20362.86	
223	19028.64	20322.24	
224	19067.94	20286.35	

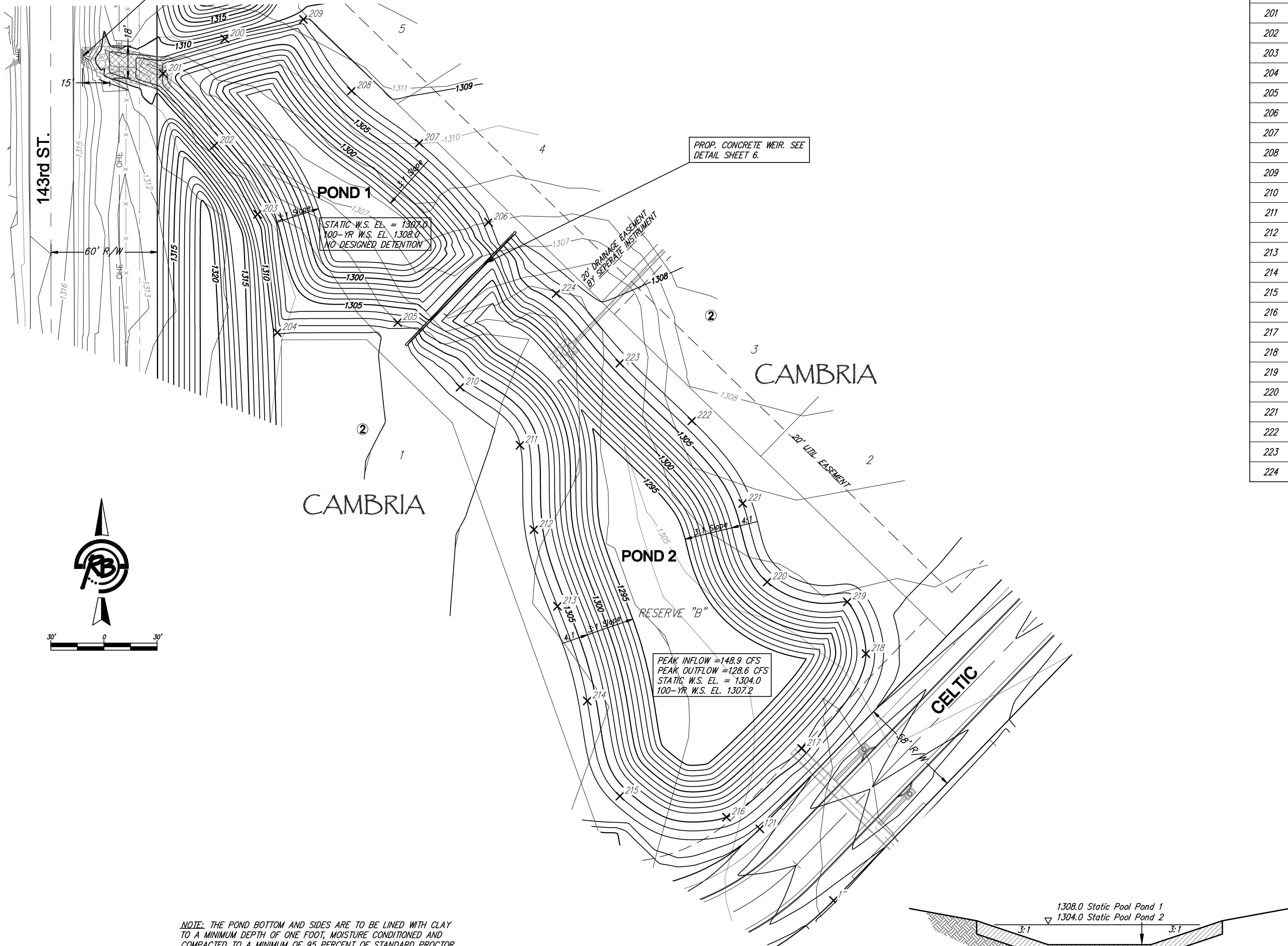

NOTE: THE POND BOTTOM AND SIDES ARE TO BE LINED WITH CLAY TO A MINIMUM DEPTH OF ONE FOOT, MOISTURE CONDITIONED AND COMPACTED TO A MINIMUM OF 95 PERCENT OF STANDARD PROCTOR DENSITY (ASTM D-698) FROM MINUS 3 TO PLUS 3 PERCENT OF OPTIMUM MOISTURE CONTENT. ON SITE CLAY IS SUITABLE FOR POND LINER. SOIL TO BE PAID AS "POND LINER C.Y."

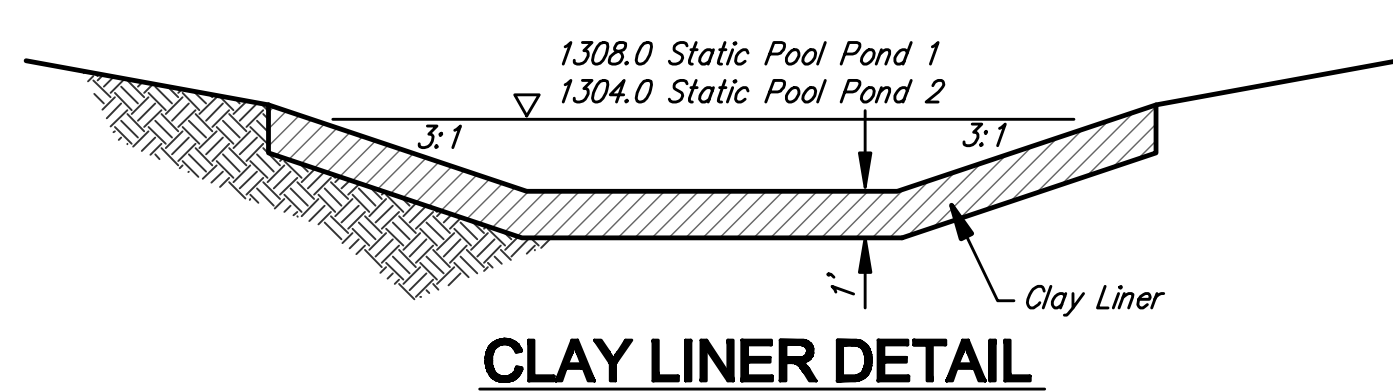

**CAMBRIA ADDITION
 POND 1 & 2 PLAN
 WICHITA, KANSAS**

Ruggles & Bohm, P.A.
 Engineering, Surveying, Land Planning
 834 North Main
 Wichita, Kansas 67203
 www.rbkansas.com
 (316) 264-8888
 (316) 264-8871 fax
 E-mail: info@rbohm.com

REVISION	AML	3190E
DESIGN	AML	
PERMIT		
CHECK		
		4
		23