

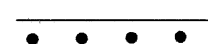



LEGEND

-  Silt Fence
-  Straw Bales
-  Inlet Protection
-  Construction Entrance
-  Permanent Seeding Area (See Landscape Plans for seeding specifications)

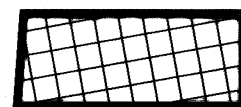

SECTION A-A
Scale 1"=5'

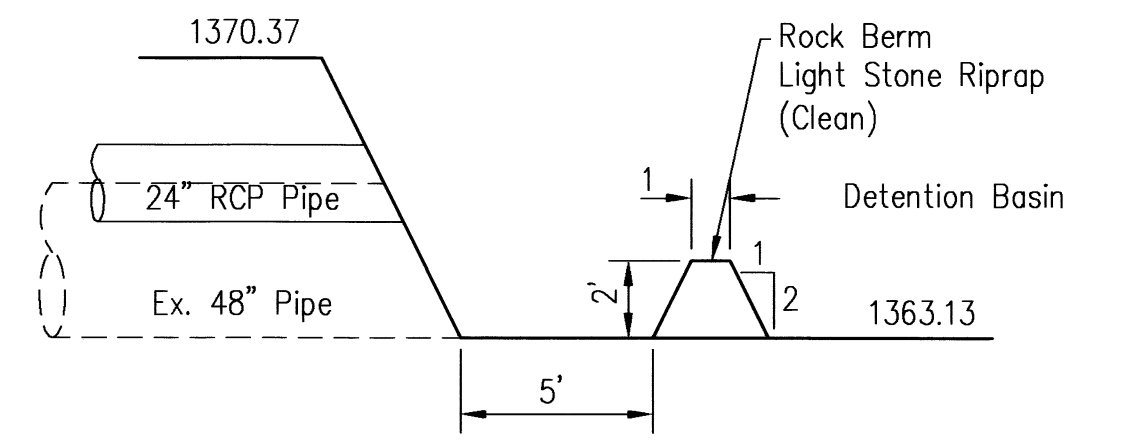
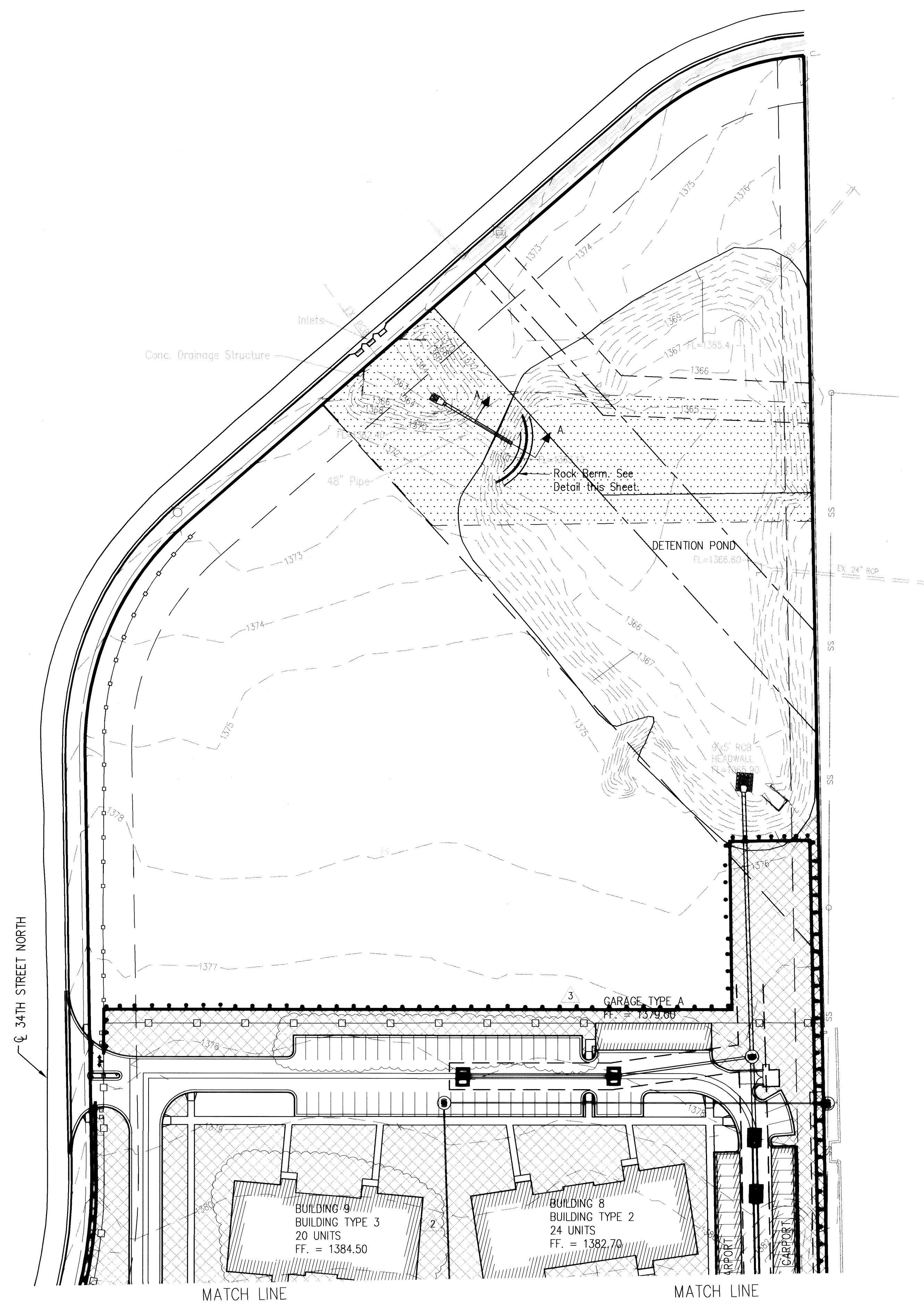
NOTE:
Rock berm to be constructed prior to disturbance of top soil.
Rock berm shall be removed at completion of project.

| No. | Date | By | Approved | Revision |
|-----|----------|-----|----------|----------------------------------|
| 1 | | | | |
| 2 | 11-09-07 | KJW | JRF | DELETED 3 GARAGES |
| 3 | 09-14-07 | KJW | JRF | BUILDING NUMBERING CLARIFICATION |

EROSION CONTROL
Inwood Apartments
Webber Group

POE & ASSOCIATES, INC.
CONSULTING ENGINEERS
5940 E. Central, Suite 200 ■ Wichita, KS 67208-4242
Phone 316/685-4114 ■ FAX 316/685-4444

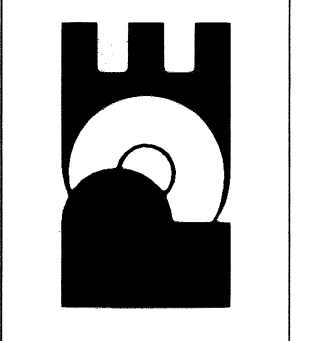

| | |
|--------------|-------|
| Engineer: | JRF |
| Designer: | KJW |
| Project No.: | 1909 |
| Date: | 12-07 |

P:\10000\Residential\InwoodApartments\Design\POE\DWG\10000\10000-0000-0000.dwg, E:\main\1, 12/20/07 10:42:33 AM