

SANITARY SEWER TO SERVE
RYAN STARKEY 6 BEDROOM HOME
 DOUGLAS AND ANNA
 LOT 1, BLOCK 1
 Kouri Addition
 1310 PPS (607861)
 CITY OF WICHITA, KANSAS

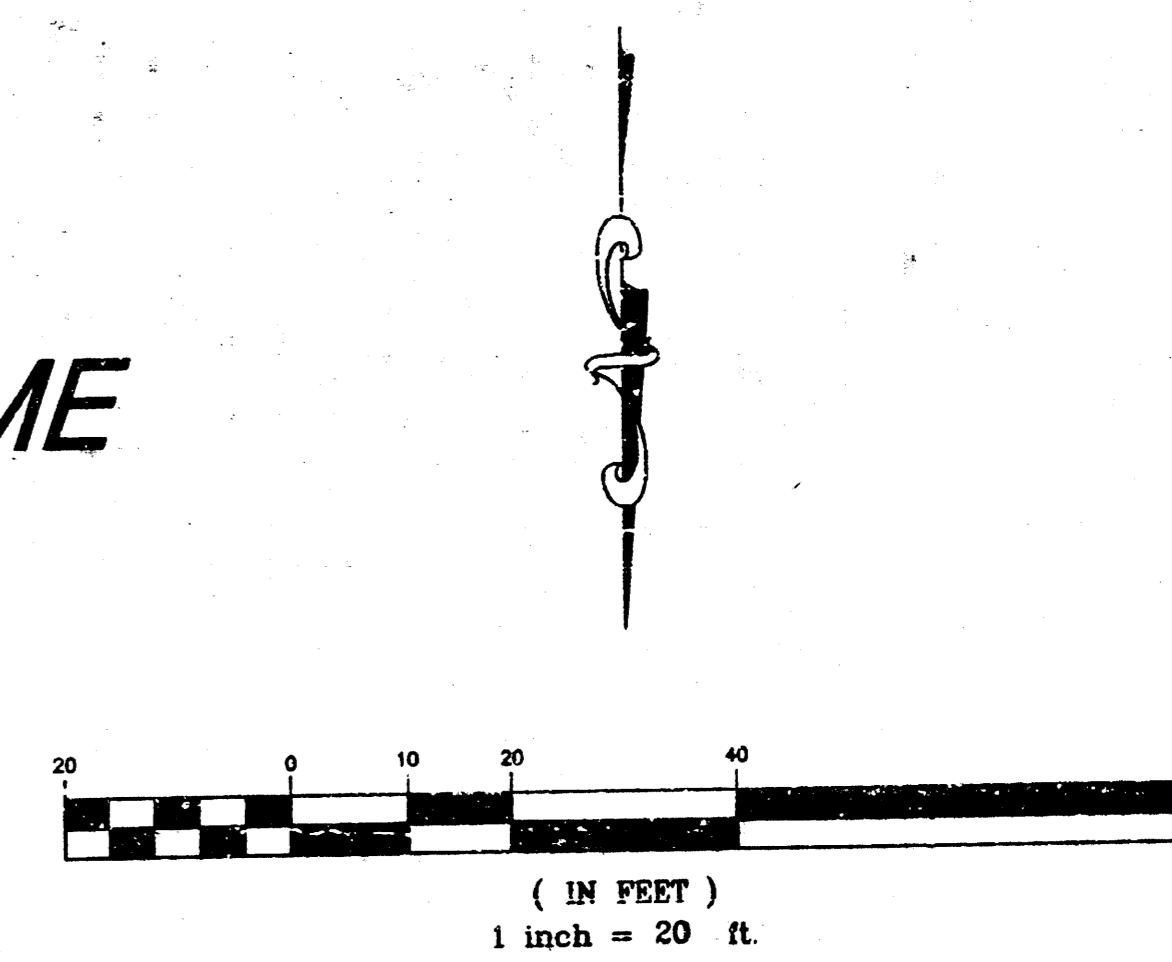

AS-BUILT
 3/27/03
 Date
 Signed

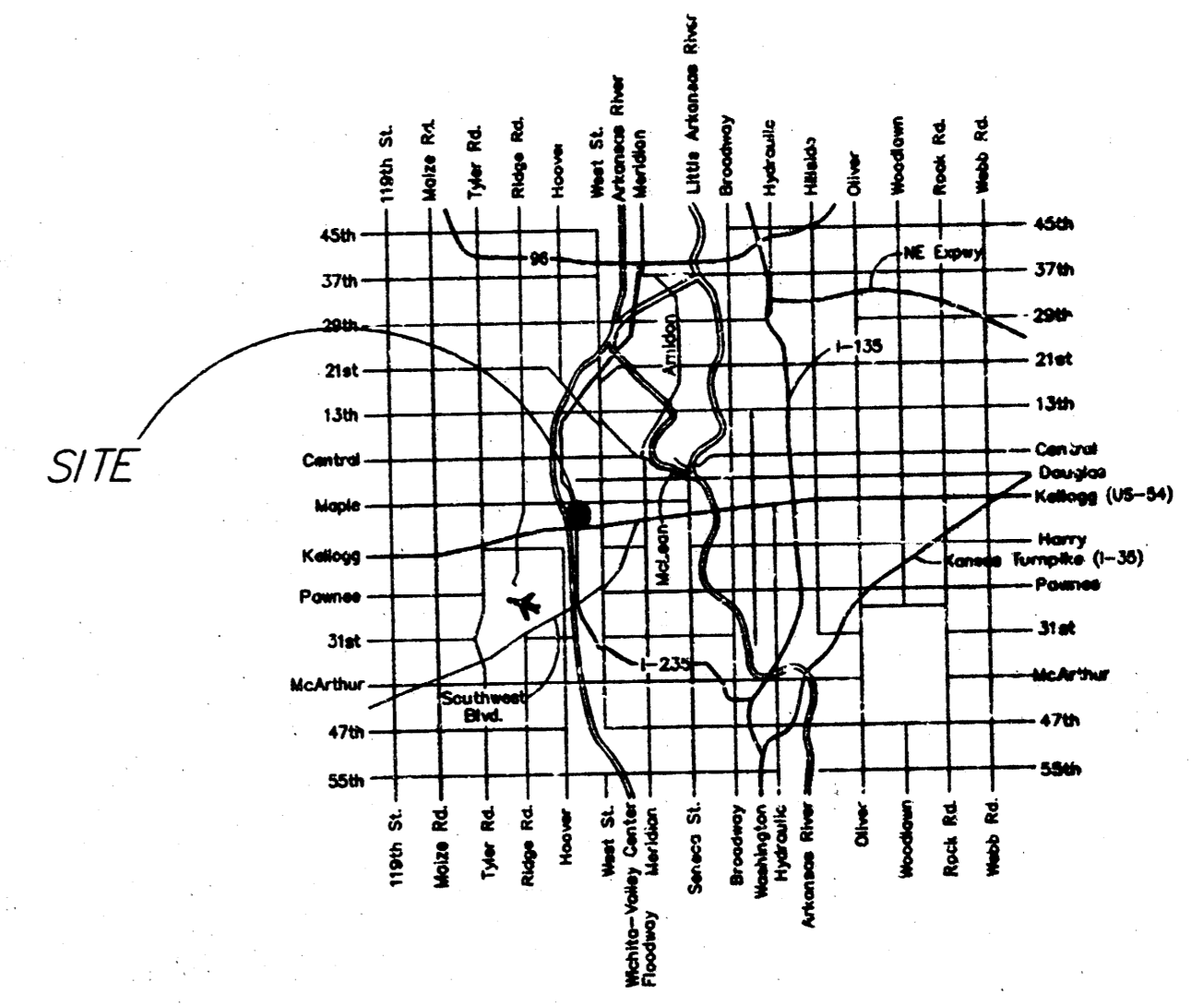
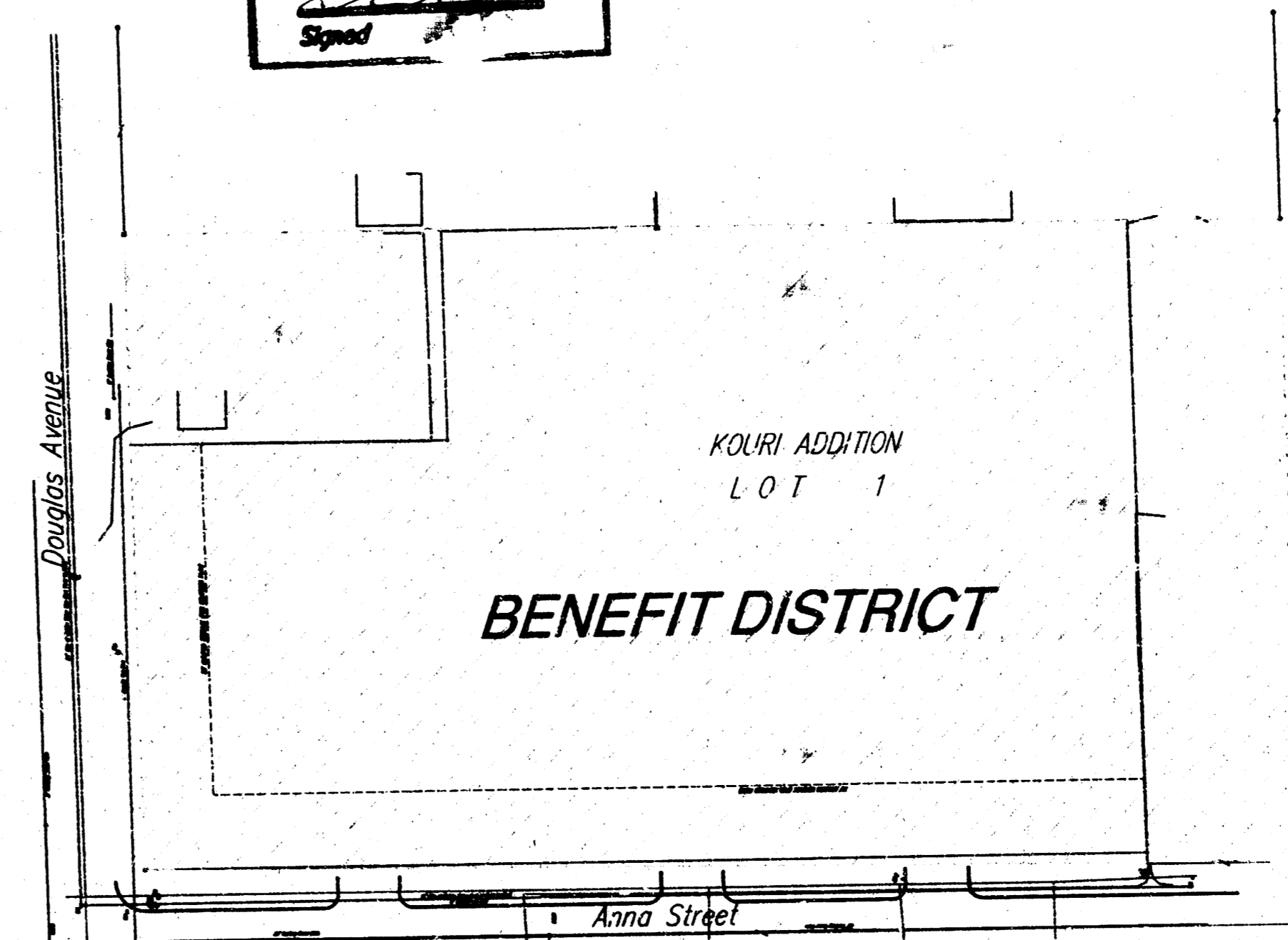

LOCATION MAP

APPROVED AS NOTED
 Sanitary Sewers VRH 1/29/03

NOTE TO CONTRACTORS
 Installation, inspection and testing for this project is to be provided by a Licensed Consulting Engineering Firm under contract with the Owner/Developer. Said inspection to be in accordance with the City of Wichita standard construction engineering practices and certified by a Licensed Professional Engineer. No work shall be performed in dedicated easements or public right-of-way by the Contractor without such inspection nor shall any work be commenced without written authorization by the City Engineer. All Construction and Materials shall comply with the City of Wichita Specifications and Standards (on file and available in the City Engineer's Office).

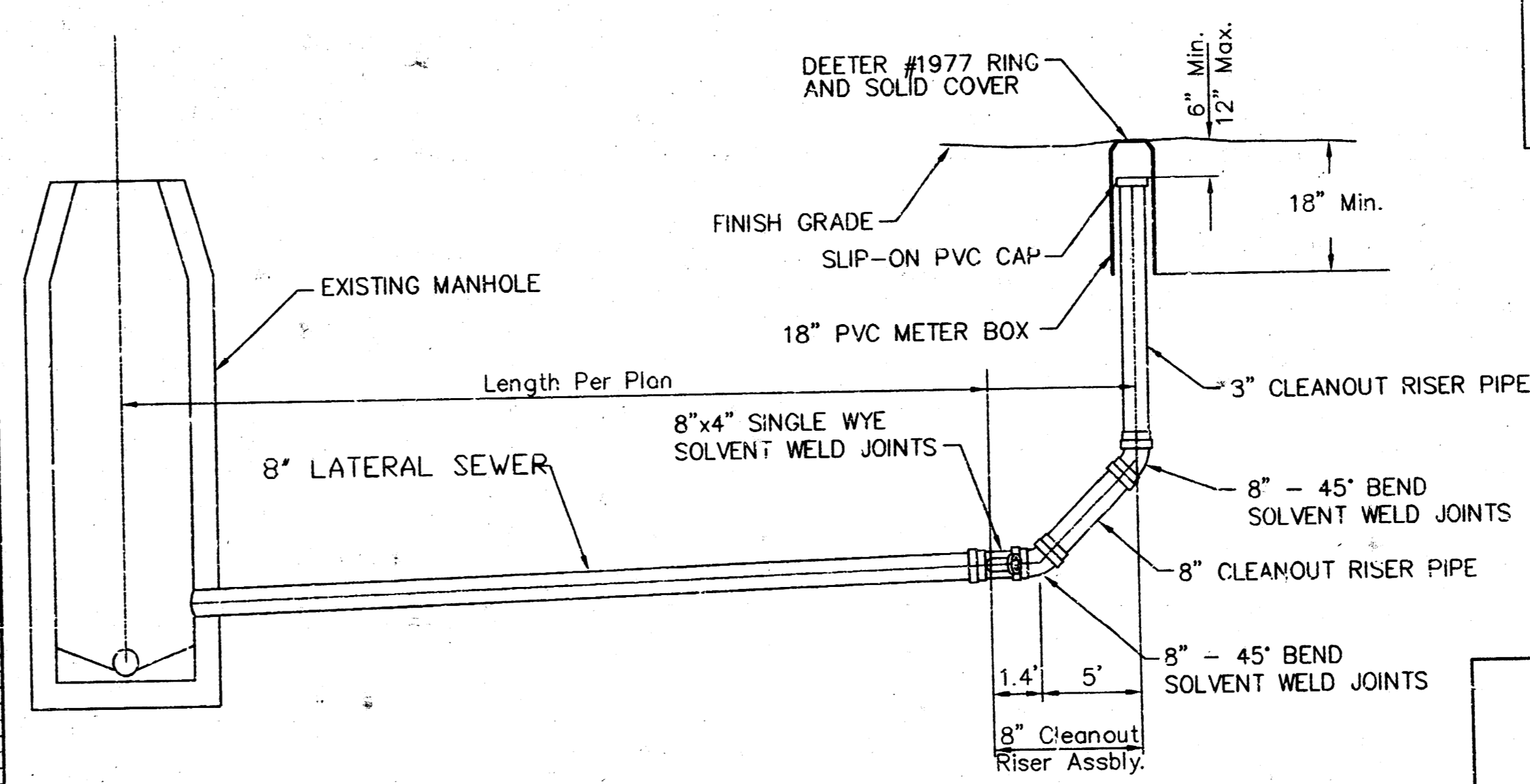

8" CLEANOUT RISER ASSEMBLY DETAIL

Cleanout to Serve
Ryan Starkey House
 Wichita Kansas

| | | | |
|-------------------------------------|-------------|------------------|------------|
| PROJECT NUMBER 1310 PPS (607861) | | | |
| KEM NO. 03001 | FILE PPS | DATE 01-23-02 | SHEET 1 |
| DESIGN KM | DRAWN BB | REVISED | OF 1 |

kemiller engineering
 516 S. Market, Wichita, KS 67202
 316/784-0242