

Easement Grading Cross-Section

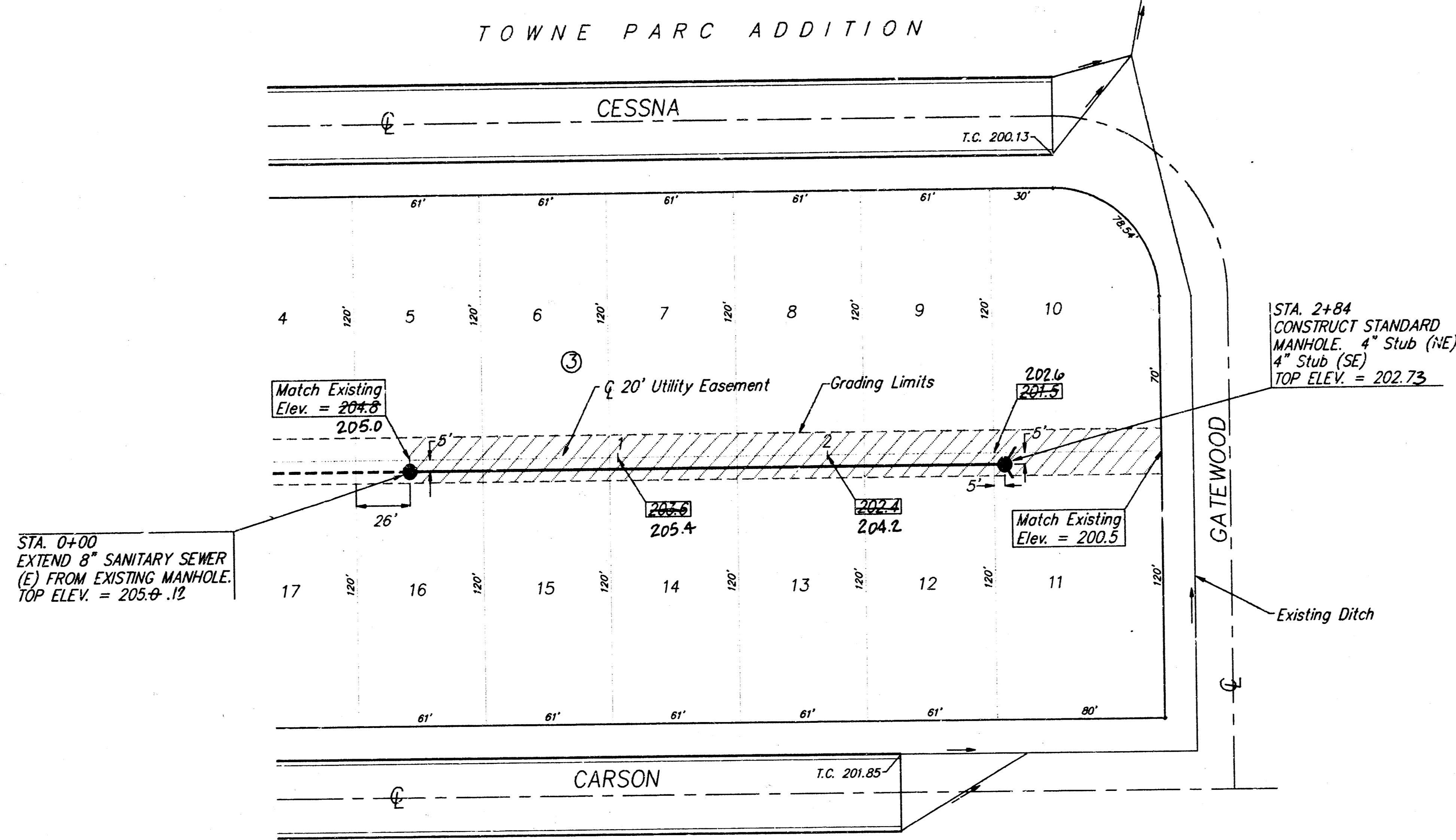

STA. 0+00
EXTEND 8" SANITARY SEWER
(E) FROM EXISTING MANHOLE.
TOP ELEV. = 205.0-12

STA. 2+84
CONSTRUCT STANDARD
MANHOLE. 4" Stub (NE)
4" Stub (SE)
TOP ELEV. = 202.73

BENCH MARKS: Standard City Disk 2 feet east and 48 feet south
of the N.W. Corner, N.E. Quarter, Section 5-8-2E
Elevation = 192.20 City Datum.

'a' Cut top of curb on the south side of Carson and
west R/W of Linden. Elevation = 201.71 City Datum.

APPROVED AS NOTED
BY CITY ENGINEER OF WICHITA

Sanitary Sewers VRH 1/7/92

Storm Sewers _____

Driveway Approaches _____

Water Mains _____

Paving _____

NOTE TO CONTRACTORS

Inspection and testing for this project is to be provided by a Licensed Consulting Engineering Firm under contract with the Owner/Developer. Said inspection to be in accordance with the City of Wichita standard construction engineering practices and certified by a Licensed Professional Engineer. No work shall be performed in dedicated easements or public right-of-way by the Contractor without such inspection nor shall any work be commenced without written authorization by the City Engineer.

SCALE: 1" = 40' Horizontal
1" = 5' Vertical
• = Iron

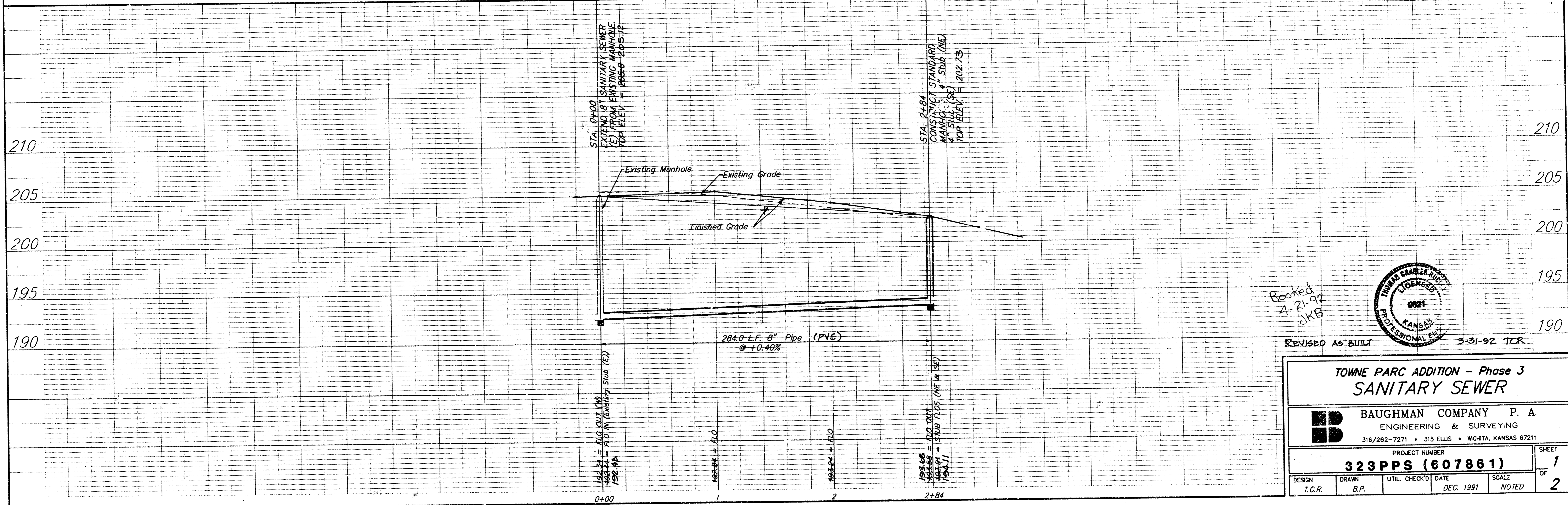

Revised
7-21-92
JKB

REVISIO AS BUILT 3-31-92 TCR

Professional Engineer Seal: THOMAS CHARLES BUCK, LICENSED PROFESSIONAL ENGINEER, KANSAS, 0021

TOWNE PARC ADDITION - Phase 3
SANITARY SEWER

BAUGHMAN COMPANY P. A.
ENGINEERING & SURVEYING
316/262-7271 • 315 ELLIS • WICHITA, KANSAS 67211

PROJECT NUMBER
323PPS (607861)

DESIGN: T.C.R. | DRAWN: B.P. | UTIL. CHECK'D: DATE: DEC. 1991 | SCALE: NOTED

SHEET 1 OF 2