

NOTE: ALTERNATE BENCH MARK 'M' IN MUELLER ON FIRE HYDRANT LOCATED AT SOUTH-WEST CORNER OF MURDOCK & VASSAR AVE. ELEV. = 161.29 CITY DATUM

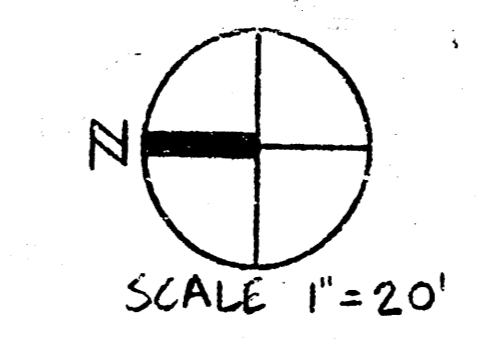
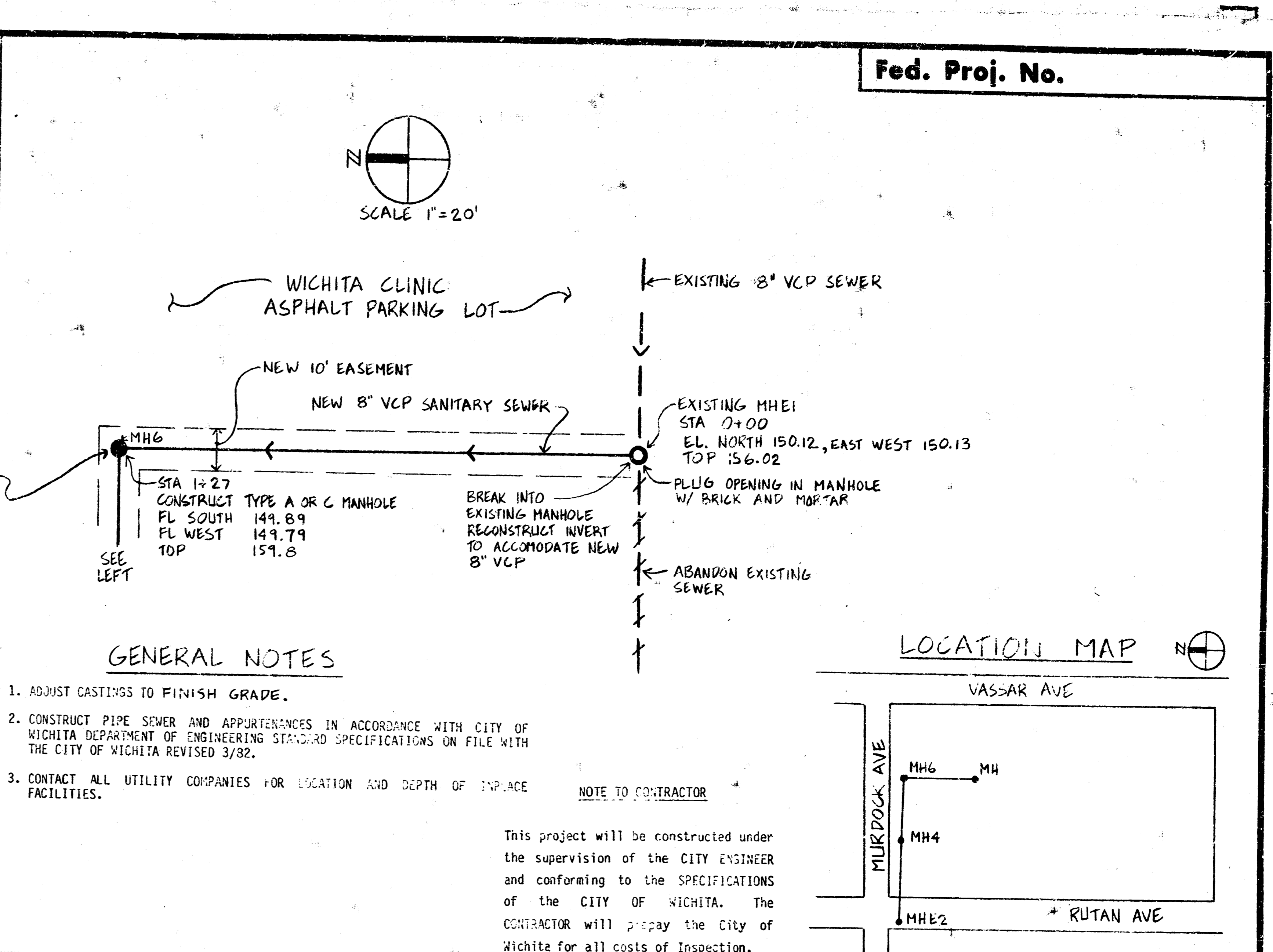
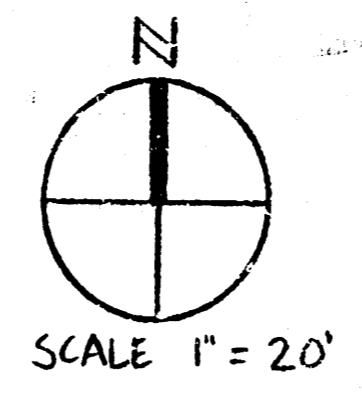

GENERAL NOTES

1. ADJUST CASTINGS TO FINISH GRADE.
2. CONSTRUCT PIPE SEWER AND APPURTENANCES IN ACCORDANCE WITH CITY OF WICHITA DEPARTMENT OF ENGINEERING STANDARD SPECIFICATIONS ON FILE WITH THE CITY OF WICHITA REVISED 3/82.
3. CONTACT ALL UTILITY COMPANIES FOR LOCATION AND DEPTH OF IN-PLACE FACILITIES.

NOTE TO CONTRACTOR
 This project will be constructed under the supervision of the CITY ENGINEER and conforming to the SPECIFICATIONS of the CITY OF WICHITA. The CONTRACTOR will pay the City of Wichita for all costs of inspection.

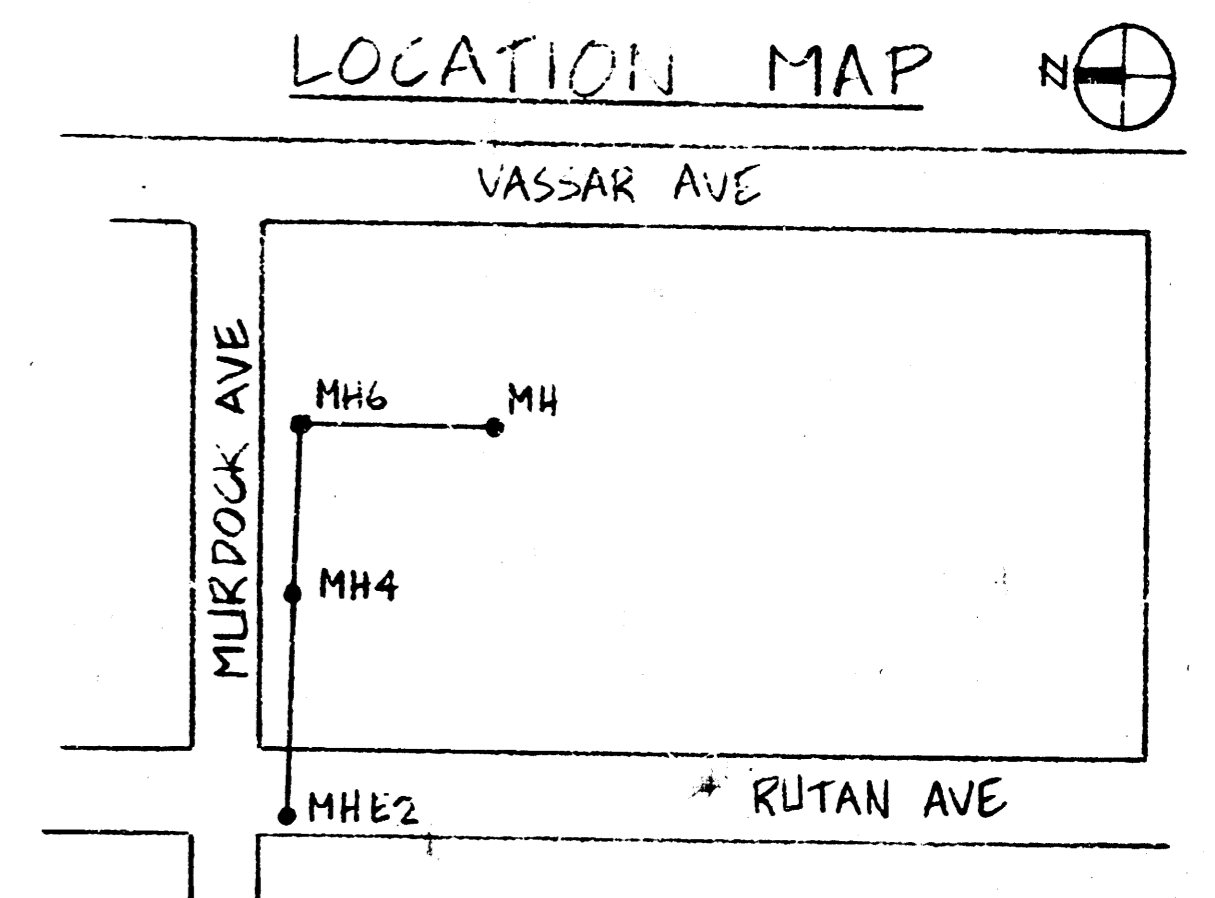

THE CONTRACTOR SHALL BE RESPONSIBLE FOR PRESERVING PROPERTY IRONS. THE CONTRACTOR SHALL BE REQUIRED TO RE-ESTABLISH ANY PROPERTY IRONS WHICH ARE DAMAGED OR DESTROYED BY HIS CONSTRUCTION OPERATIONS SUCH IRONS SHALL BE RE-ESTABLISHED BY A LICENSED LAND SURVEYOR OR A LICENSED PROFESSIONAL ENGINEER IN ACCORDANCE WITH STATE LAWS.

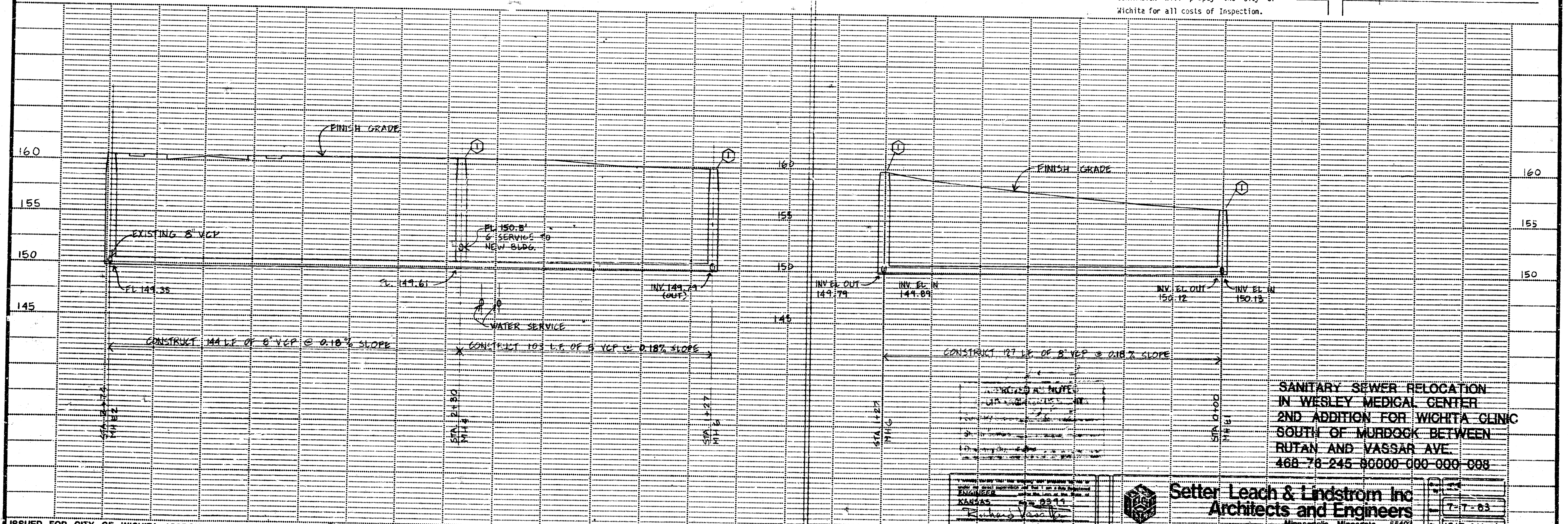

SANITARY SEWER RELOCATION IN WESLEY MEDICAL CENTER 2ND ADDITION FOR WICHITA CLINIC SOUTH OF MURDOCK BETWEEN RUTAN AND VASSAR AVE. 468-78-245 86000-000-000-008

PROF. A. NUTT
 ENGINEER
 KANSAS
 No. 8314
 Richard J. Vassallo



Setter Leach & Lindstrom Inc
 Architects and Engineers
 Minneapolis Minnesota 55403

ISSUED FOR CITY OF WICHITA APPROVAL 7-7-83
 REISSUED FOR CITY OF WICHITA APPROVAL 7-11-83

REISSUED FOR CITY OF WICHITA APPROVAL 7-16-83

WICHITA CLINIC SITE

State Proj. No.

SANITARY SEWER RELOCATION PLAN
 CITY OF WICHITA

Sheet No. 1A of 1 Sheets