

# Benchmarks

BM #4: COW BM North R/W of K-96 and West R/W of North Hoover Road, 6.9' ESE of PP, and 42.5' west of center line.  
Elev. = 1333.14 MSL (145.74 City Datum)

BM #5: Hoover and 37th St. N - COW Benchmark at SW corner of Intersection, 16.40' W of PP, 7.40' n of PP, 3.00' N of 4' high chain link fence, 15.20' WNW of chain link fence corner, 48.50' SW of Section corner Iron, 17.20' S of Centerline, 48.00' W of Centerline.  
Elev. = 1333.68

Reseed 900 L.F. According to General Note 13 as Measured Along the Water Line from Sta. 8+60 to Sta. 17+60.

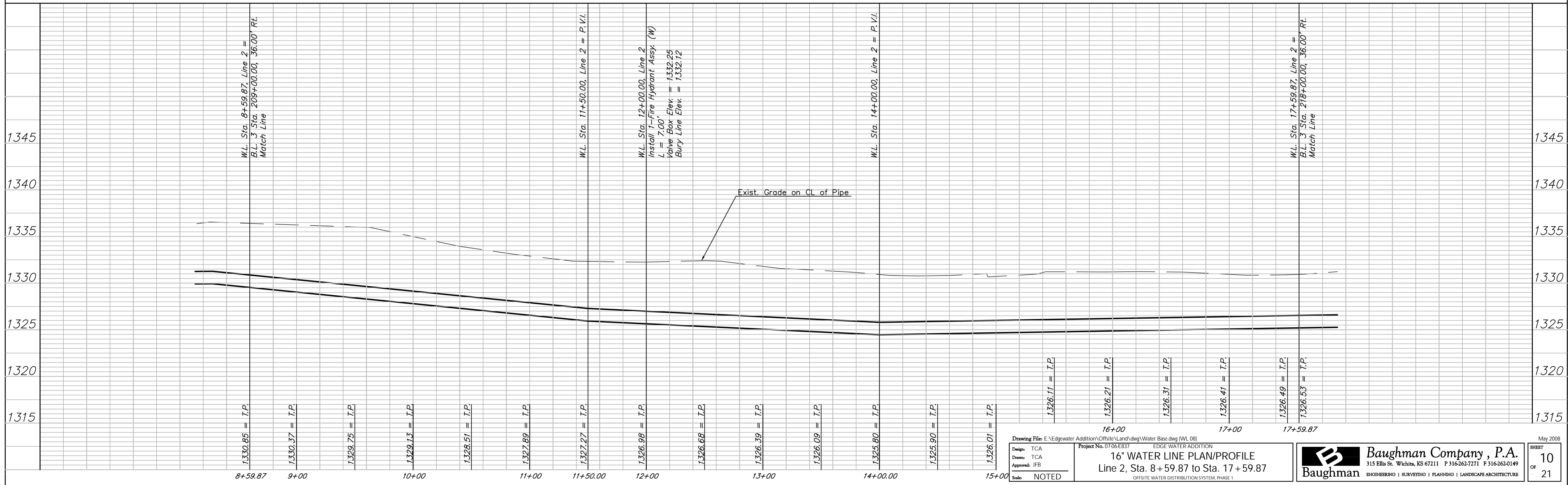
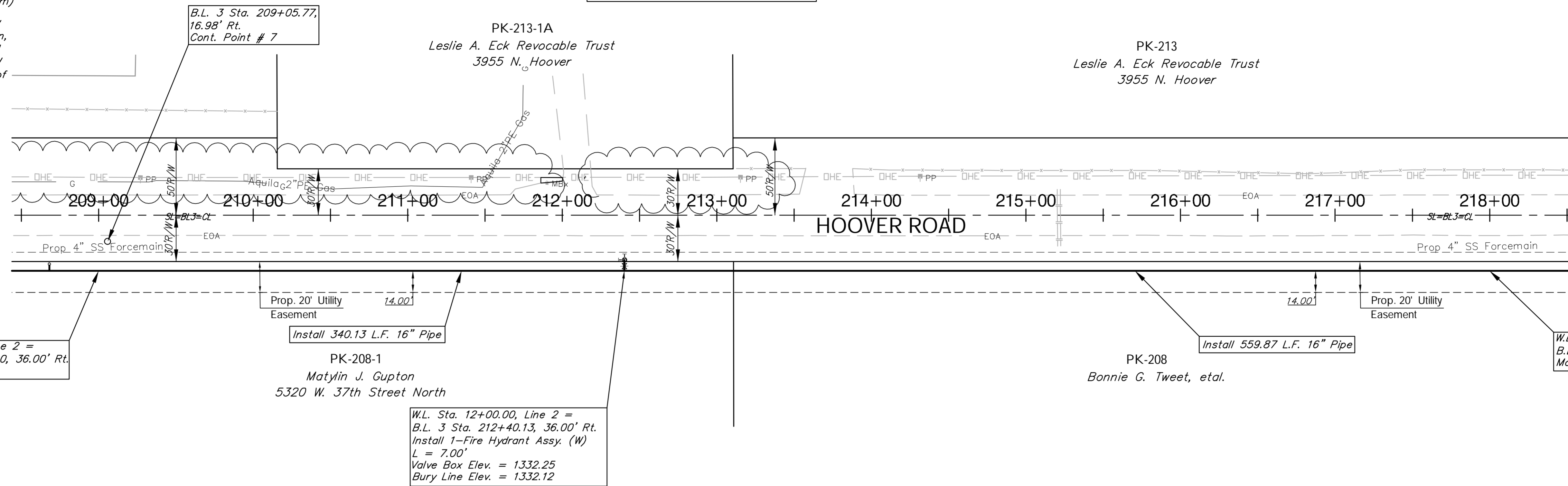
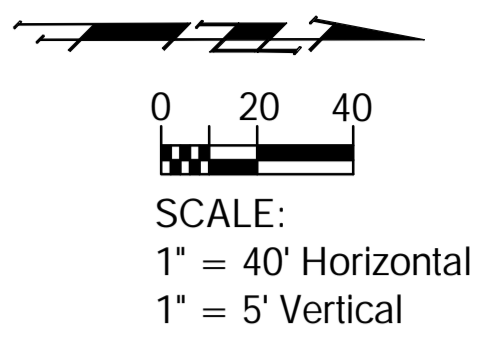

Drawing File: E:\Edgewater Addition\Offsite\Land\dwg\Water Base.dwg (WL 08)  
 Design: TCA  
 Drawn: TCA  
 Approved: JFB  
 Scale: NOTED  
 Project No. 0706-EB37  
 EDGE WATER ADDITION  
**16" WATER LINE PLAN/PROFILE**  
 Line 2, Sta. 8+59.87 to Sta. 17+59.87  
 OFFSITE WATER DISTRIBUTION SYSTEM, PHASE 1

**Baughman Company, P.A.**  
 315 Ellis St. Wichita, KS 67211 P 316-262-7171 F 316-262-0149  
 Baughman ENGINEERING | SURVEYING | PLANNING | LANDSCAPE ARCHITECTURE

May 2008  
 SHEET  
 OF 10  
 21